

REEF

LUXURY DEVELOPMENTS



ABOUT US

At REEF, we redefine luxury living in Dubai by blending innovation with practical solutions. Our commitment to excellence ensures high-quality, elegant homes that integrate thoughtful practices and timeless design. We create vibrant, connected communities that offer exceptional value.



Innovative Climate-Controlled Sunken Balcony

We take pride in introducing our trademark climate-controlled sunken balcony concept, an exclusive feature that sets us apart in the real estate market. As the sole patent holder, we are pioneering this innovative design to set new industry benchmarks.

AL FURJAN

Al Furjan is emerging as one of Dubai's most sought-after family communities and a top choice for both families and investors. Here are some key factors contributing to its growing appeal:

- **Promising Investment Opportunities:** A thriving real estate market with strong growth, offering you high returns and long-term investment security.
- **Family-Oriented:** A secure, family-friendly environment with parks, schools, and healthcare facilities.
- **Convenient Transport:** Direct access to major highways and Al Furjan Metro Station.
- **Wide Range of Amenities:** Community centers, pools, gyms, cycling tracks, and retail options.
- **Proximity to Key Areas:** Close to Jebel Ali Village, Discovery Gardens, and Ibn Battuta Mall.
- **Educational & Healthcare Facilities:** Nearby schools like The Arbor School and healthcare centers such as Medicentres.
- **Sustainable Living:** Green spaces, eco-friendly designs, and a 40 km cycling track network.
- **Global Connectivity:** A short drive to Al Maktoum International Airport, ensuring seamless access to global travel connections.

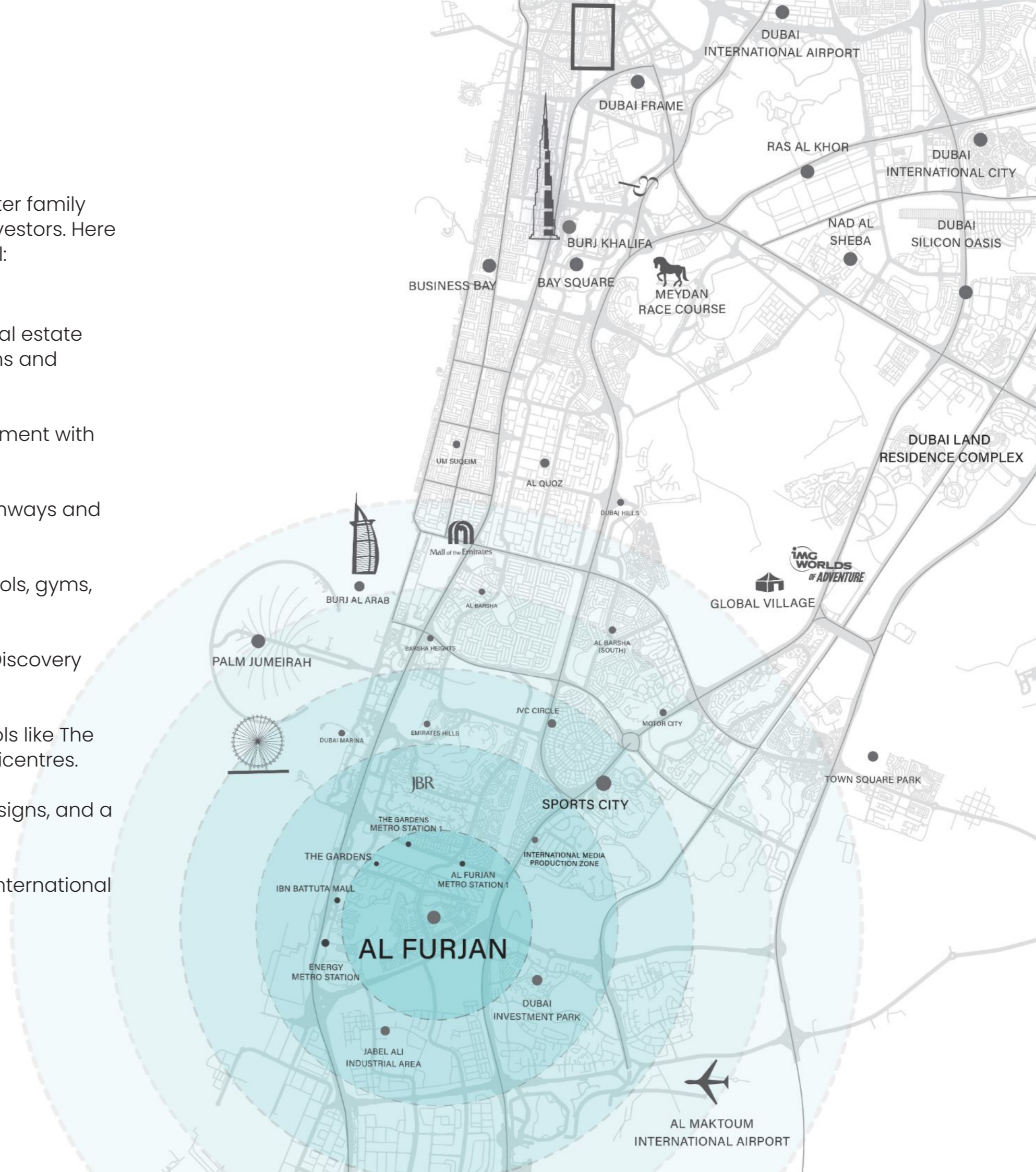

REEF AL FURJAN

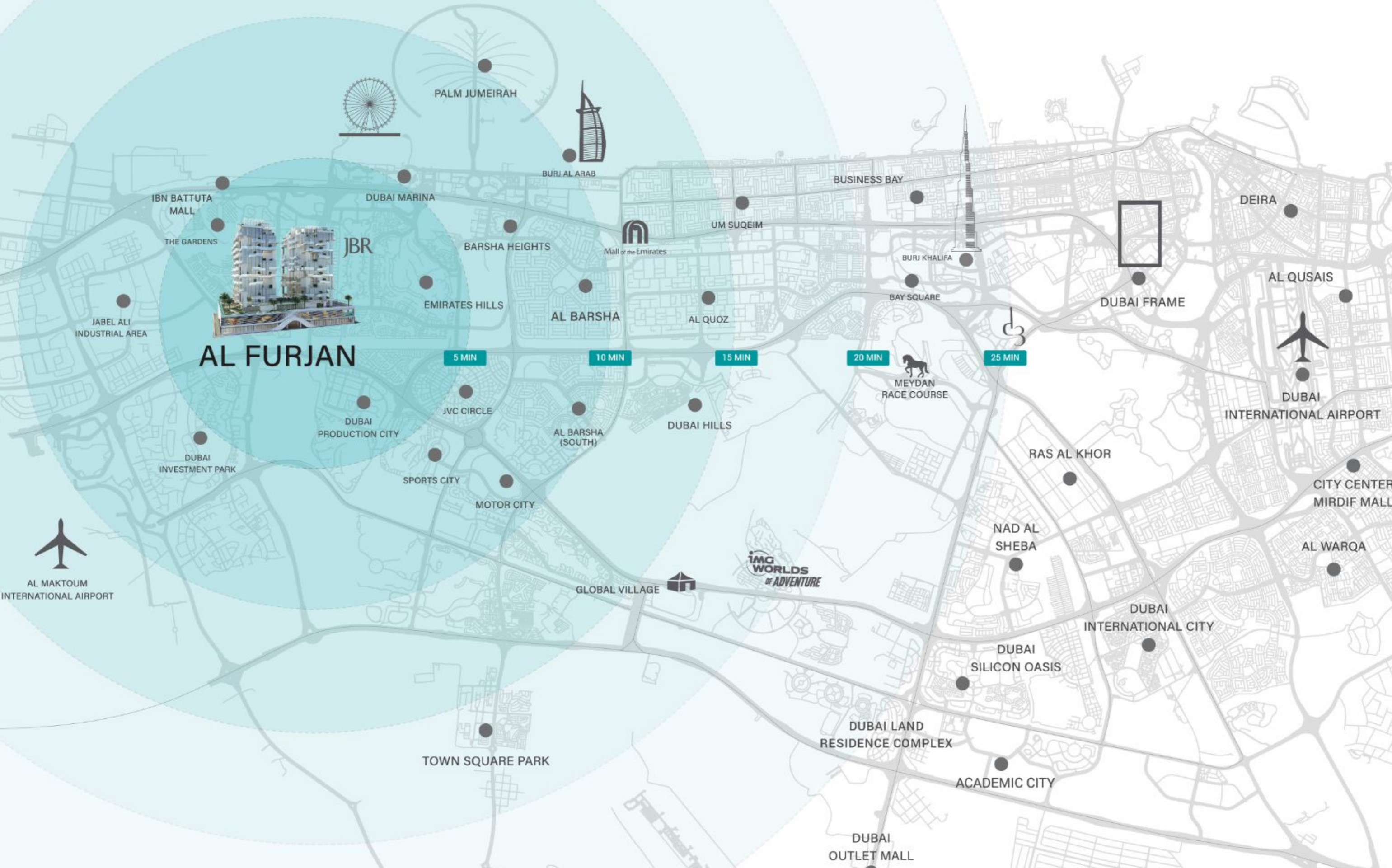

NEARBY LOCATIONS

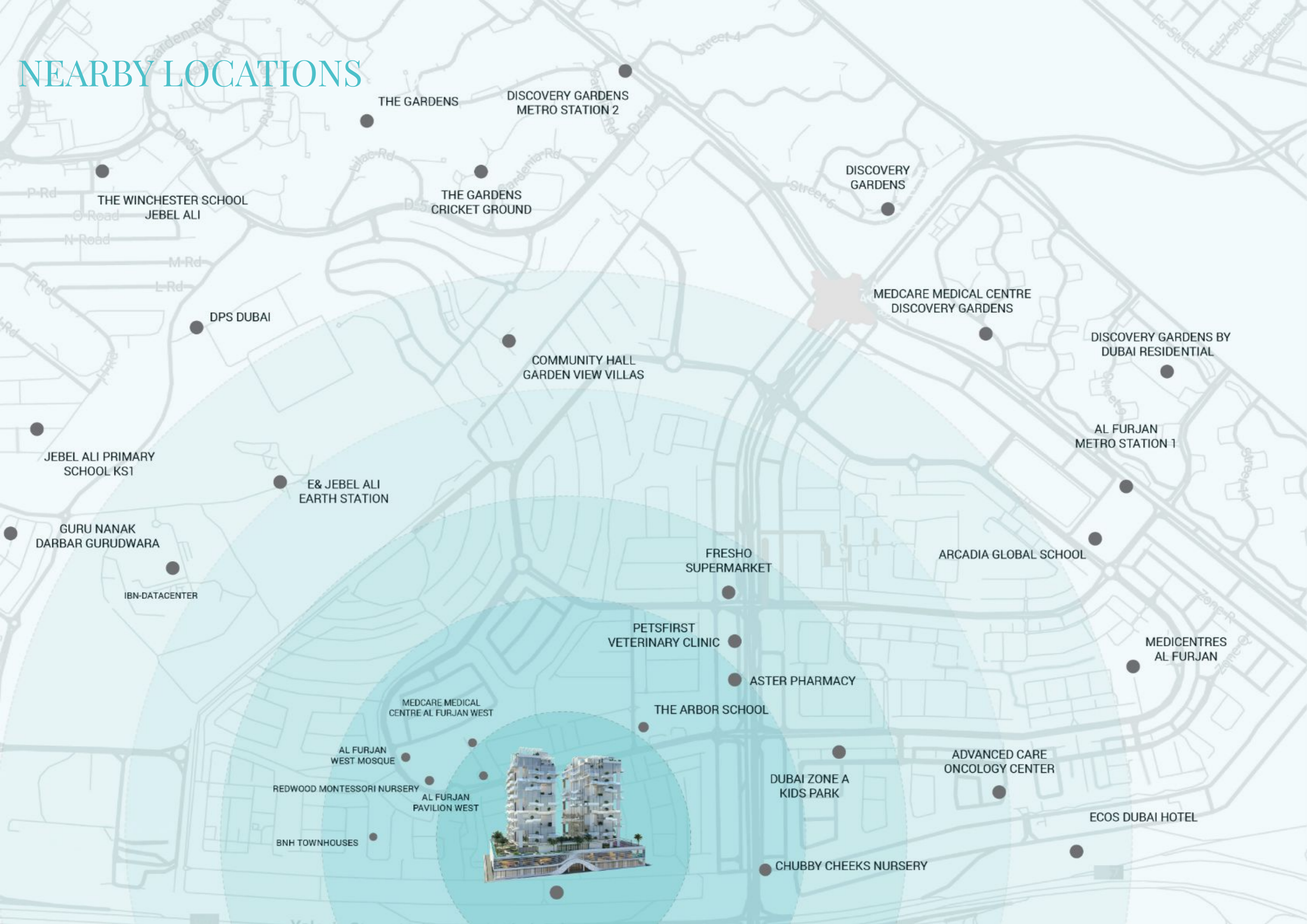

Inspire
Standard of Living



NEARBY LANDMARKS



PALM JUMEIRAH

20 mins



IBN BATTUTA MALL

10 mins



DUBAI MARINA

10 mins



AL MAKTOUM INTERNATIONAL
AIRPORT

15 mins



BURJ KHALIFA

25 mins



Mall of the Emirates

MALL OF EMIRATES

15 mins

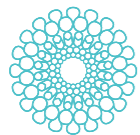

DUBAI EXPO CITY

10 mins



METRO CONNECTIVITY

5 mins





BUILDING CONFIGURATION

G+1P+12

TOTAL UNITS

142

ONE BEDROOM

108

TWO BEDROOM

20

THREE BEDROOM

4

FOUR BEDROOM VILLA

10



REEF
LIVING OFFSHORE



REEF
www.reef.ae

NARRATIVE



MINIMALIST STILL LIFE

The interior design concept, inspired by the beauty and intricate structure of coral reefs, seamlessly blends organic elements with contemporary design. This fusion creates a serene and inspiring space, fostering tranquility and creativity. The design celebrates nature's delicate wonders, offering a space that encourages a deep appreciation for our environment through thoughtful and engaging elements.



INTERIORS

LOBBY AREA

The expansive, light-filled lobby sets the stage for a life of elegance, where timeless design and refined craftsmanship come together in perfect harmony.





Lobby Area

CORRIDOR

Designed to inspire, every detail reflects the perfect balance of style and comfort.



2
1
3

1

Corridor

PODIUM PARADISE

Where Leisure Meets Elegance



AMENITIES



SWIMMING POOL



JACUZZI



KIDS POOL



SUNKEN SEATS

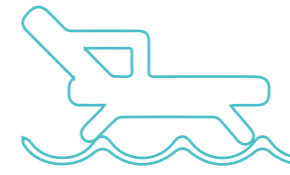

BAJA SHELF



DECKING AREA



VEGETABLE GARDEN



PICKLE BALL



SHADED SITTING AREA



ELECTRIC VEHICLE RECHARGE STATION



KIDS PLAY AREA

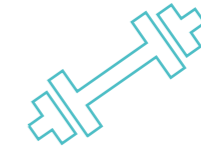

STATE OF THE ART GYM



BADMINTON AND VOLLEYBALL COURT



360 JOGGING TRACK



SITTING AREA



OPEN CINEMA



PRIVATE WINTER GARDEN



2X CRICKET PITCH



CO-WORKING SPACE



TENNIS AND PADDLE COURT



BASKETBALL COURT

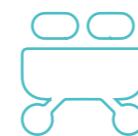

BBQ AREA



YOGA AREA

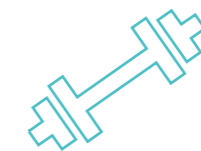

PRIVATE GYM

STATE-OF-THE ART GYM

A fully equipped, state-of-the-art gym designed for optimal performance, offering an exceptional workout experience in a modern and convenient environment.



GYM MODE

ON



Techno Gym



Pilates Area



Co-working Space



Co-working Space



Co-working Space



Co-working Space

SWIMMING POOL

A relaxing oasis, our expansive pool area blends luxury and relaxation with a serene beach pool, kids pool, infinity pool, Jacuzzi, Baja shelves, stylish deck, sun beds, and unique sunken seating for ultimate comfort and enjoyment.

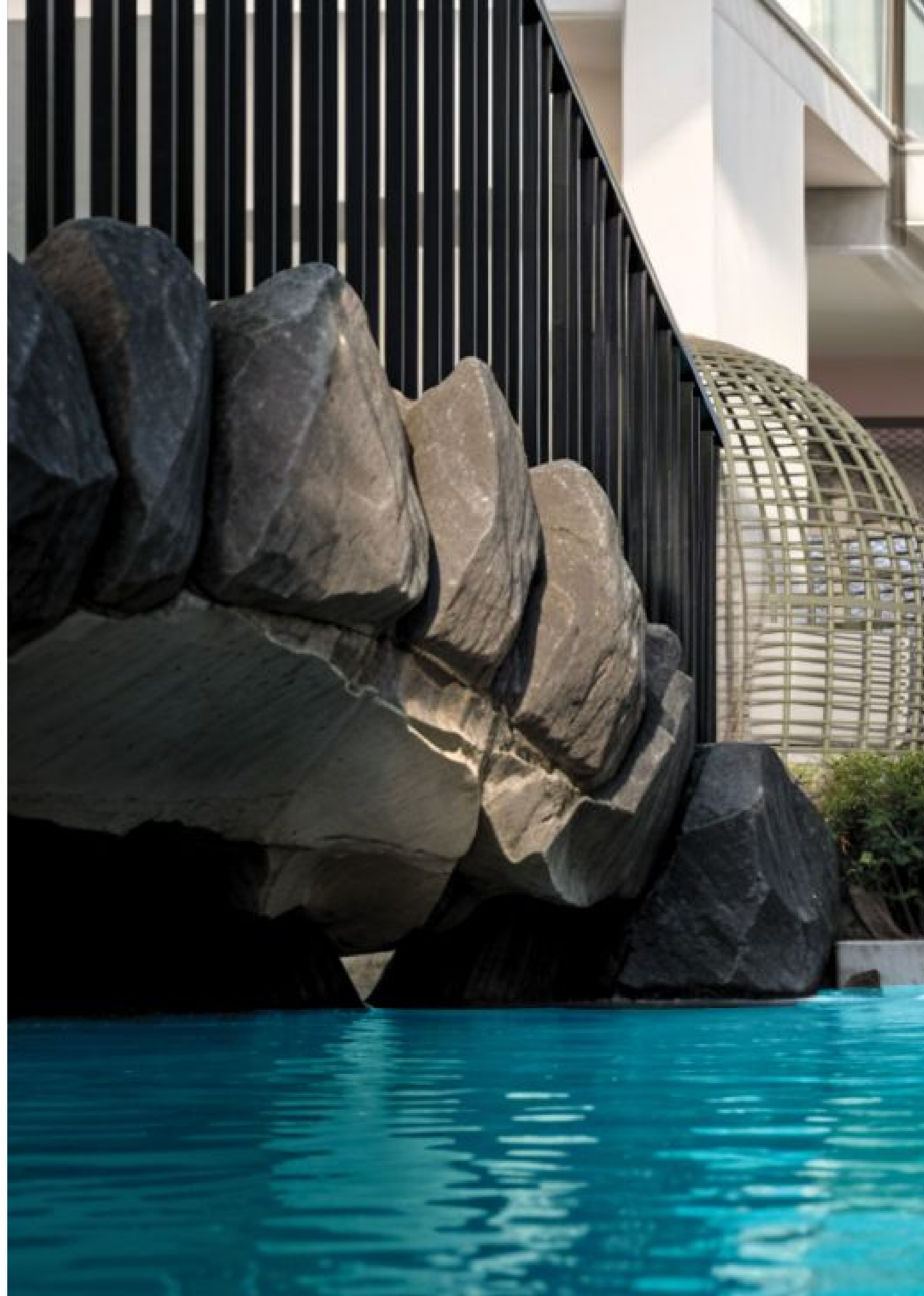



Swimming Pool



Swimming Pool



Kids Pool



BBQ Area



BBQ Area



Shaded Sitting Area



Shaded Sitting Area



Open Cinema



Vegetable Garden



Kids Playing Area



Yoga Area



Cricket Pitch



Basketball Court



Badminton Court

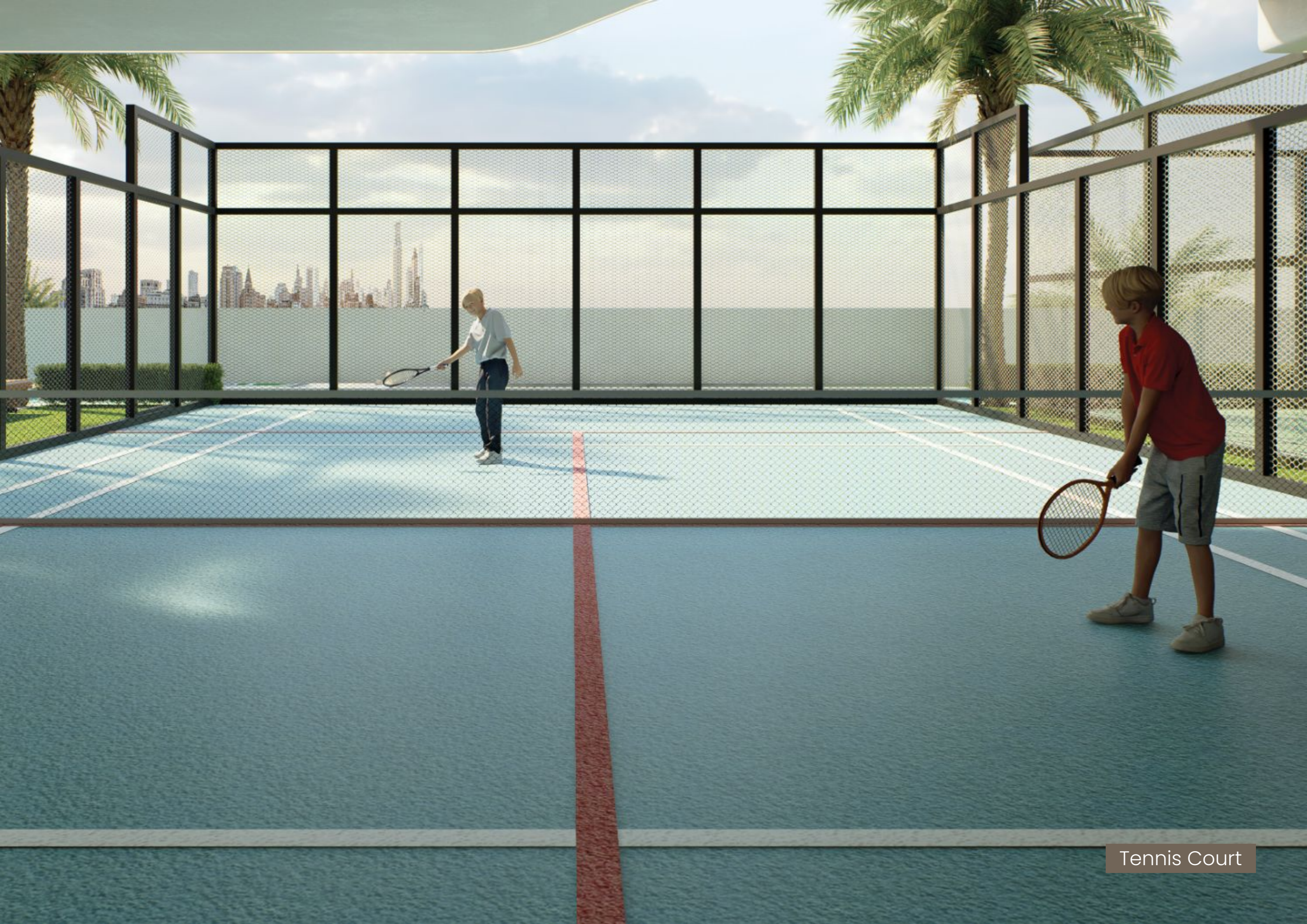

Tennis Court

ONE BEDROOM APARTMENTS

UNITS SIZE

APARTMENTS	UNITS	AREA SQ.FT	
		min	max
1 Bedroom	108	792	916.8



Living Area



Dinning Area



Kitchen



Master Bedroom



Climate-Controlled Sunken Balcony

TWO BEDROOM APARTMENTS

UNITS SIZE

APARTMENTS	UNITS	AREA SQ.FT	
		min	max
2 Bedroom	20	1338.3	1875.5



Living Area



Living Area



Kitchen



Kitchen



Master Bedroom



Bedroom



Climate-Controlled Sunken Balcony

THREE BEDROOM APARTMENTS

UNITS SIZE

APARTMENTS	UNITS	AREA SQ.FT	
		min	max
3 Bedroom	4	2022.2	2636



Living Area



Closed Kitchen



Master Bedroom



Bedroom



Bedroom

CLIMATE-CONTROLLED SUNKEN BALCONY

The unique, one-of-a-kind climate-controlled sunken balcony—an exclusive feature designed to maximize comfort and usability, offering a year-round space for relaxation.





Climate-Controlled Sunken Balcony

FOUR BEDROOM VILLA

UNITS SIZE

APARTMENTS	UNITS	AREA SQ.FT	
		min	max
4 Bedroom Villa	10	3424	3695



Living Area



Living Area



Living Area



Kitchen



Kitchen



Dinning Area



Pantry Area



Master Bedroom



Bedroom



Bedroom



Bedroom



Bedroom



Maid Room

REEF WINTER GARDEN

WHERE WINTER LIVES ALL YEAR LONG

REEF Winter Garden is a place where you will enter and have the winter season regardless of what season we are in! It is a special climate-controlled space where you can experience the beauty of winter no matter what time of year it is. This unique garden ensures a comfortable environment all year round, offering you an exceptional outdoor experience. Designed for relaxation and quality time, the REEF Winter Garden features a cozy seating area and a dedicated barbecue space, creating the perfect setting for gatherings with family and friends. Whether it's a sunny summer day or a cooler evening, you can always enjoy your Winter garden in complete comfort.





Winter Garden



Winter Garden



Winter Garden



Winter Garden



Winter Garden

REEF
LUXURY DEVELOPMENTS