

PRIVÉ

KEMER

Right in The Middle Of The City

Luxury in Nature

ŞENKAYA

PRIVÉ
KEMER

ŞENKAYA

ŞENKAYA



Made in
1995

Şenkaya was established in 1995 by Ferruh Şenkaya with a vision to design and produce innovations with a respectful approach towards humanity, the environment, the world, and ideas.

Türkiye



We built automotive plazas in various regions across Turkey, adhering to the standards of world-leading brands.

TÜRKİYE \$ BANKASI

VakıfBank

HALKBANK

In 2012, Şenkaya achieved a groundbreaking milestone by signing "100% Guarantee System" agreements with reputable and leading banks in the market, proving itself as one of the pioneering companies in the sector.



Between 1995 and 2000, in the Aegean Region, we created various residential projects with the majority in the form of housing complexes (sites) and we were followed as a prominent leader in the region.



Between 2001 and 2010, Şenkaya became the first company in Turkey to accomplish bulk foreign sales. During the same period, we also opened our Manchester branch, targeting not only British citizens but also other EU nationals. We developed numerous projects in Turkey's tourism centers and made significant contributions to the country's tourism industry by participating in various European fairs to promote these projects.

Gardenplanet
blueplanet
Parkplanet
PLATIN PLANET

Between 2012 and 2019, with its "Planet"-themed projects in Istanbul Kurtköy, Şenkaya became the most admired construction company in the region. Over the last 5 years, Şenkaya successfully delivered the keys of 1167 independent units to its customers in 4 different projects on time.



During the same years, we also constructed corporate office buildings, industrial facilities, and agricultural industrial structures for various companies.



In 2011, Şenkaya relocated its company headquarters to Istanbul and began enhancing its land inventory to develop brand residential projects.

PRIVÉ
KEMER

In 2020, Şenkaya added the land of Privé Kemer project, which will be constructed on approximately 48,000 square meters, to its inventory and began working on a high-end project in the upper segment.

ŞENKAYA

PRIVÉ

KEMER

Doğadaki lüks





Now, it is possible to lead a peaceful and comfortable life not by moving away from the city itself but from its chaos. Right in the heart of the city, within walking distance to Kemer Country Club, and close to a lush green forest, a serene and comfortable life awaits.

PRIVÉ

PRIVÉ
KEMER



Living in a community with distinguished neighbors, where cars do not roam, and all open spaces are integrated with landscaping, is now within your reach. Privé Kemer offers you and your family a brand new life with its elegant, modern, and low-rise architecture, life-enhancing and comfortable eco-friendly home technologies, security, and all other privileges.

Location



Project Map İstanbul

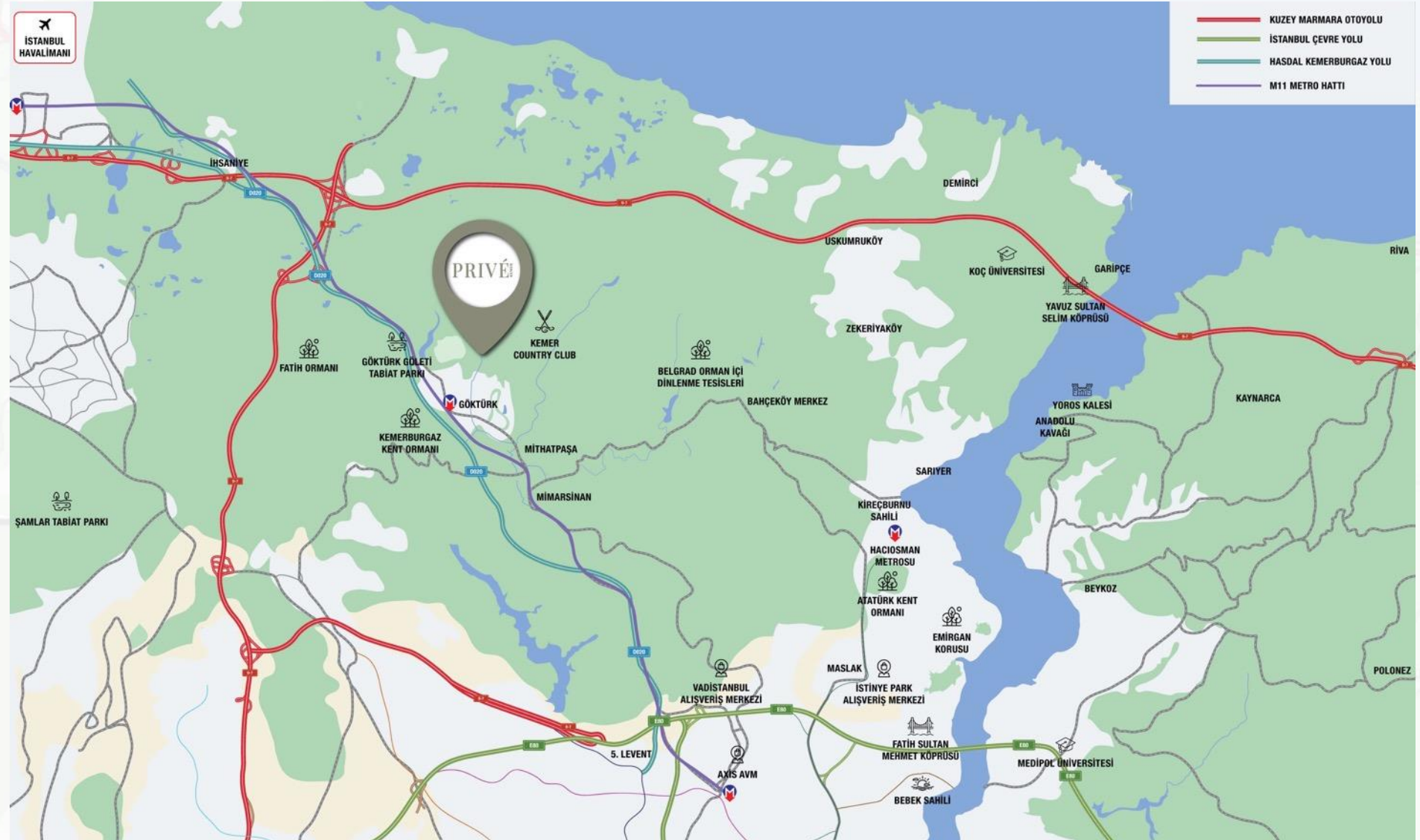

The former state of the project area.

PRIVÉ
KEMER



Göktürk neighborhood in Istanbul offers several advantages that set it apart from other neighborhoods in the city. Here are some key advantages:

- **Natural Beauty:** Göktürk is known for its picturesque and green surroundings. It is nestled amidst a lush forest, providing residents with a refreshing and peaceful environment away from the hustle and bustle of the city.
- **High-Quality Housing:** The neighborhood offers a range of high-quality residential properties, including modern apartments, villas, and houses, providing residents with comfortable and luxurious living spaces.
- **Excellent Infrastructure:** Göktürk has well-developed infrastructure with modern amenities and facilities. There are schools, hospitals, shopping centers, recreational areas, and sports facilities, making it a self-sufficient and convenient place to live.
- **Transportation Connectivity:** The neighborhood enjoys good transportation connectivity, with easy access to major roads and highways, allowing residents to reach other parts of Istanbul quickly and conveniently.

- **Family-Friendly:** Göktürk is considered a family-friendly neighborhood with a safe and secure environment. It attracts families due to its quality schools, parks, and recreational areas suitable for children.
- **Cultural and Social Activities:** The neighborhood offers various cultural and social activities, such as art events, concerts, and community gatherings, providing a vibrant and lively atmosphere for residents.
- **Investment Potential:** Göktürk has been gaining popularity as an attractive investment location. Property values have shown a positive trend over time, making it an appealing choice for real estate investors.
- **Cosmopolitan Community:** Due to its favorable living conditions, Göktürk attracts a diverse community of residents, creating a cosmopolitan and welcoming atmosphere.
- **Health and Wellness:** The area offers access to various health and wellness facilities, including fitness centers, spas, and wellness clinics, promoting a healthy lifestyle.
- **Recreational Opportunities:** The neighborhood's proximity to natural areas and forests allows residents to enjoy outdoor activities such as hiking, jogging, and picnicking.

Education

- Private Eyübođlu Preschool Primary School 10 dk
- Bahçeşehir College Göktürk 8 dk
- Hisar Schools 4 dk
- Private Göktürk Bilfen Preschool 13 dk
- Nejat Sabuncu Primary School 7 dk
- Dođa College Göktürk Campus 10 dk
- Mutlu Adımlar Preschool Kemerburgaz 10 dk
- Bahçeşehir University 7 dk

Health Centers

- Acıbadem Göktürk Medical Center 6 dk
- Tas Hospital 6 dk
- Florence Nightingale Medical Center 7 dk
- Göktürk Family Health Center 4 dk

Shopping

- CarrefourSA **7 dk**
- Migros **4 dk**
- File Market **3 dk**
- Starbucks **6 dk**
- Vadistanbul mall **15 dk**
- Axis Mall **20 dk**
- İstinye Park Mall **21 dk**

Main Arteries

- Göktürk Metro **5 dk**
- İstanbul airport **12 dk**
- Fatih Sultan Bridge **20 dk**
- Nişantaşı **23 dk**
- Bebek **25 dk**

Project Details



1. Phase

 13 Block

 165 Units

Delivery Date: 30.04.2024

2. Phase

 4 Block

 56 Units

Delivery Date :31.05.2025

The project area is 51,000 m². It consists of a total of 3 phases. It's a family conceived Project.

Within the project, it will not be possible to drive around by car; you will directly enter the closed parking area.

There is a 1.5 km walking path from the beginning of the 1st phase to the end of the 3rd phase.

In our project, surrounded by a forest on 3 sides, each apartment has a forest view.

The interior features of the apartments;

- The ceiling height is 3.1 meters in intermediate floor apartments and 3.4 meters in garden-level apartments.*
- The windows are floor-to-ceiling and have double-sided special insulation.*
- There is a floor heating system with combi boiler*
- The infrastructure for VRV air conditioning system is ready.*
- There is a Siemens branded 3-piece built-in set, including an oven, cooktop, and hood.*

Social Facilities

PRIVÉ
KEMER



Outdoor / Indoor Pool



Restaurant



Spa Center



Gym



Studio Rooms



Children's Playground



Walking Paths



Shuttle



Buggy



Indoor Parking













Exterior Images

PRIVÉ
KEMER









A large, modern multi-story apartment building with a courtyard and landscaping. The building features multiple levels with balconies and large windows. The courtyard in the foreground has a paved walkway, greenery, and a few people walking. The overall scene is bright and sunny.

Apartment Plans

Apartment Types

2. Phase / Delivery Date August 2024

2+1

PRIVÉ
KEMER

D3 BLOK 18 NO'LU DAİRE PLANI 101,18 m² / 2+1

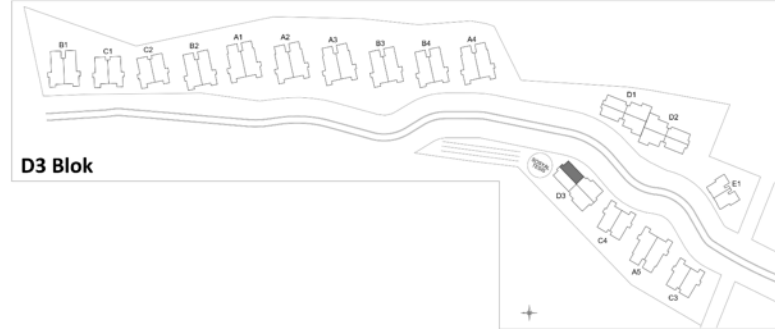

D3 Blok



D3 BLOK 4. KAT 18 NO'LU DAİRE

1. Salon	21,88 m ²
2. Mutfak	8,35 m ²
3. Antré	5,05 m ²
4. Hol	2,87 m ²
5. Banyo	3,88 m ²
6. Yatak Odası	9,46 m ²
7. Ebeveyn Suite	17,85 m ²
Ebv. Yatak Odası	13,93 m ²
Ebv. Banyo	3,92 m ²
8. Teras	5,05 m ²

NET ALAN 74,39 m²

TOPLAM BRÜT ALAN 101,18 m²

ŞENKAYA

Apartment Types

2. Phase / Delivery Date August 2024

2+1 Garden

PRIVÉ
KEMER

A5 BLOK 1 NO'LU DAİRE PLANI
253,19 m² / 2+1 Bahçe

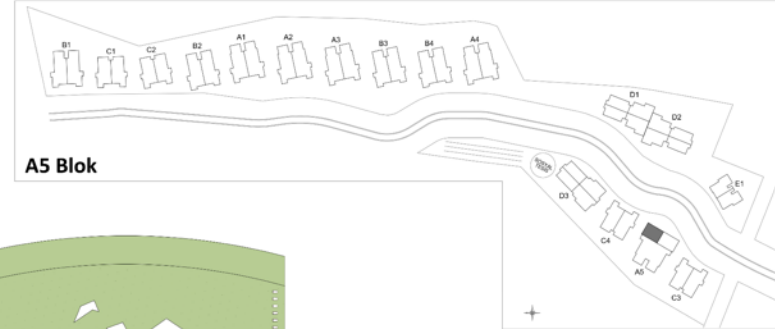

A5 Blok



A5 BLOK BAHÇE KAT 1 NO'LU DAİRE

1. Salon	42,60 m ²
2. Mutfak	13,14 m ²
3. Antre	9,44 m ²
4. Hol	3,55 m ²
5. İşlik	1,93 m ²
6. Banyo	4,78 m ²
7. Yatak Odası	12,58 m ²
8. Ebeveyn Suite	22,36 m ²
Ebv. Yatak Odası	17,77 m ²
Ebv. Banyo	4,59 m ²
9. Bahçe	100,16 m ²

NET ALAN 210,54 m²

TOPLAM BRÜT ALAN 253,19 m²

ŞENKAYA

Apartment Types

2. Phase / Delivery Date August 2024

3+1

PRIVÉ
KEMER

D3 BLOK 19 NO'LU DAİRE PLANI 145,01 m² / 3+1



D3 BLOK 4. KAT 19 NO'LU DAİRE

1. Salon	25,93 m ²
2. Mutfak	12,96 m ²
3. Antré	6,79 m ²
4. Hol	3,80 m ²
5. İşlik	1,28 m ²
6. Banyo	4,44 m ²
7. Yatak Odası	10,45 m ²
8. Yatak Odası	10,67 m ²
9. Ebeveyn Suite	22,16 m ²
Ebv. Yatak Odası	17,00 m ²
Ebv. Banyo	5,16 m ²
10. Teras	8,48 m ²

NET ALAN 106,96 m²

TOPLAM BRÜT ALAN 145,01 m²

ŞENKAYA

Apartment Types

2. Phase / Delivery Date August 2024

3+1 Terrace

PRIVÉ
KEMER

C4 BLOK 10 NO'LU DAİRE PLANI 188,13 m² / 3+1 Teras

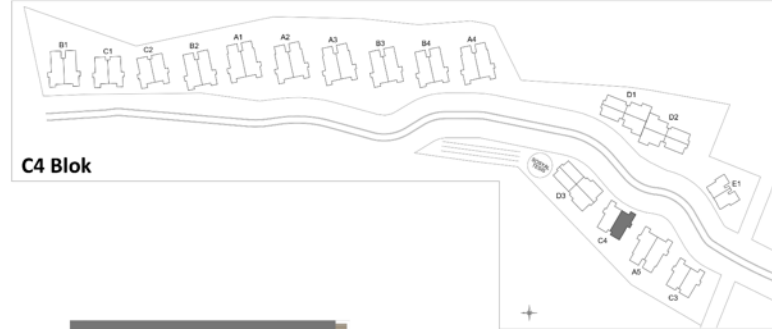

C4 Blok



C4 BLOK 3. KAT 10 NO'LU DAİRE

1. Salon	36,49 m ²
2. Mutfak	14,95 m ²
3. Antré	9,76 m ²
4. Hol	5,57 m ²
5. İşlik	0,84 m ²
6. Misafir WC	2,86 m ²
7. Banyo	4,77 m ²
8. Yatak Odası	12,05 m ²
9. Yatak Odası	12,62 m ²
10. Ebeveyn Suite	27,17 m ²
Ebv. Yatak Odası	15,16 m ²
Ebv. Giyinme Odası	6,25 m ²
Ebv. Banyo	5,76 m ²
11. Balkon	1,11 m ²
12. Teras	10,84 m ²

NET ALAN 139,03 m²

TOPLAM BRÜT ALAN 188,13 m²

ŞENKAYA

Apartment Types

2. Phase / Delivery Date August 2024

3+1 Terrace and Garden

PRIVÉ
KEMER

C3 BLOK 3 NO'LU DAİRE PLANI 346,37 m² / 3+1 Teras-Bahçe

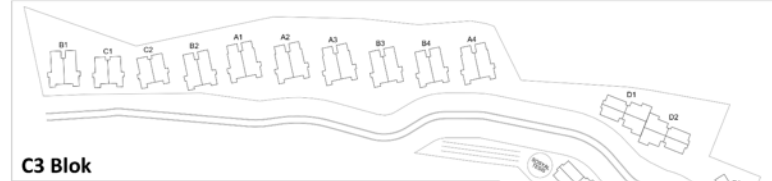

C3 BLOK ZEMİN KAT 3 NO'LU DAİRE

1. Salon	40,35 m ²
2. Mutfak	14,95 m ²
3. Antre	9,77 m ²
4. Hol	5,57 m ²
5. İşlik	0,84 m ²
6. Misafir WC	2,86 m ²
7. Banyo	4,38 m ²
8. Yatak Odası	12,05 m ²
9. Yatak Odası	12,62 m ²
10. Ebeveyn Suite	25,22 m ²
Ebv. Yatak Odası	15,17 m ²
Ebv. Giyinme Odası	5,19 m ²
Ebv. Banyo	4,86 m ²
11. Teras	73,62 m ²
12. Bahçe	94,45 m ²

NET ALAN 296,68 m²

TOPLAM BRÜT ALAN 346,37 m²

ŞENKAYA

Apartment Types

2. Phase / Delivery Date August 2024

4,5+1 Terrace and Garden

PRIVÉ
KEMER

A5 BLOK 3 NO'LU DAİRE PLANI 395,63 m² / 4,5+1 Teras-Bahçe

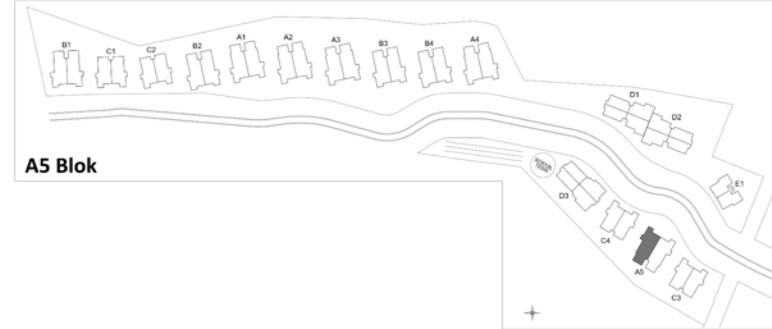

A5 Blok



A5 BLOK ZEMİN KAT 3 NO'LU DAİRE

1. Salon	43,62 m ²
2. Mutfak	15,72 m ²
3. Antre	9,21 m ²
4. Hol	8,20 m ²
5. Misafir WC	2,83 m ²
6. Banyo	4,67 m ²
7. Yardımcı Odası	7,47 m ²
Yatak Odası	5,13 m ²
Banyo	2,34 m ²
8. TV/Çalışma Odası	10,17 m ²
9. Yatak Odası	11,29 m ²
10. Yatak Odası	11,56 m ²
11. Ebeveyn Suite	25,23 m ²
Ebv. Yatak Odası	13,62 m ²
Ebv. Giyinme Odası	6,46 m ²
Ebv. Banyo	5,15 m ²
12. Teras	75,41 m ²
13. Bahçe	112,30 m ²

NET ALAN 337,68 m²

TOPLAM BRÜT ALAN 395,63 m²

ŞENKAYA

Apartment Types

2. Etap / Teslim Tarihi 2024 Yazı
5+1 Terrace

PRIVÉ
KEMER

A5 BLOK 6 NO'LU DAİRE PLANI 239,58 m² / 5+1 Teras

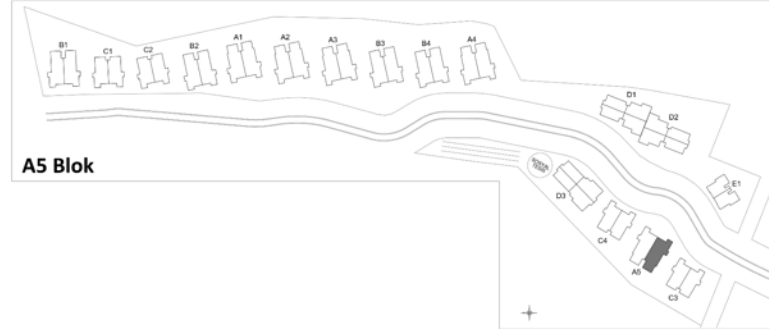

A5 BLOK 1. KAT 6 NO'LU DAİRE

1. Salon	39,07 m ²
2. Mutfak	15,72 m ²
3. Antre	9,31 m ²
4. Hol	8,20 m ²
5. Misafir WC	2,83 m ²
6. Banyo	4,67 m ²
7. Yardımcı Odası	11,43 m ²
Yatak Odası	9,09 m ²
Banyo	2,34 m ²
8. TV/Çalışma Odası	10,17 m ²
9. Yatak Odası	11,29 m ²
10. Yatak Odası	11,90 m ²
11. Ebeveyn Suite	25,23 m ²
Ebv. Yatak Odası	13,62 m ²
Ebv. Giyinme Odası	6,46 m ²
Ebv. Banyo	5,15 m ²
12. Balkon	1,75 m ²
13. Balkon	5,40 m ²
14. Teras	24,72 m ²
NET ALAN	181,69 m²
TOPLAM BRÜT ALAN	239,58 m²

ŞENKAYA