

A woman with her hair in a bun, wearing a long, flowing white dress, is shown in profile from the chest up. She is holding a large, vibrant bouquet of flowers, including purple, orange, and white blooms. Behind her is a large, bright circular light that creates a soft glow. The background is a light, hazy sky.

SUPREME  
*Residence*

BY ■ uni<sup>o</sup>state





**ADD A SPLASH  
OF COLOR TO** *Your Life!*



*Be Joyful,  
Embrace  
Tranquility.*

**Elevate Your Life's  
Symphony!**







LIVE LIFE IN FULL  
*Spectrum!*





# About The Developer

■ **uniostate**

With over 28 years of experience, we  
redefine excellence in development,  
contracting, and innovation.  
Our iconic residential and commercial  
spaces inspire and elevate.



A woman in a black blazer and white scarf stands by the open door of a dark-colored car, smiling and talking to a man in a dark suit who is partially visible in the foreground. She is holding a large, structured brown leather handbag. The background shows a modern building with large windows.

# Your Satisfaction Our Priority

Customer satisfaction is at our core, building lasting relationships. Experience Uniestate and ignite your path to exceptional living.





# *Dubai;* **A Global Hub of Growth and Innovation**

Unleash your potential in Dubai, where commerce meets creativity. With a business-friendly environment, limitless opportunities await in this thriving city.

Enjoy tax benefits and a high-quality lifestyle amidst Dubai's vibrant tourism industry. Experience the extraordinary in Dubai, where innovation and prosperity thrive.





*Arjan*  
**WHERE LIFE  
FLOURISHES  
AND FORTUNES  
BLOOM**





# *Nature's Beauty* **at Your Doorstep**

Arjan is a stones throw away from world-renowned attractions such as the Dubai Miracle Garden, the largest flower garden globally, and the Dubai Butterfly Garden. Residents can enjoy the beauty of nature in their neighborhood.







# *Eat, Shop, Play*

## **The Arjan Lifestyle**

Arjan residents enjoy a vast array and ever-growing range of dining and shopping experiences, as well as a variety of leisure activities nearby. Supreme Residence will also benefit from community parks & green belts a short walk away.







## **Access to Top-Quality Education**

In Arjan, families enjoy the advantage of residing near some of Dubai's finest schools, providing exceptional educational opportunities for children. With proximity to renowned educational institutions, parents can rest assured that their children will receive a top-notch education close to home.



# Medical Hub

Arjan is strategically located close to a vibrant health, wellness and medical community. With Hospitals, Laboratories and healthcare businesses dominant in the area, there is high demand for quality residential property, adding to Arjan's investment potential.







*Prosperity  
Awaits*

## **Lucrative Investment**

With its strategic location and rapid growth, Arjan presents a wealth of lucrative investment opportunities.

At Supreme Residence, smart investors can seize the chance to achieve excellent yields and capital appreciation.



Welcome to  
SUPREME  
*Residence*

BY ■ UNIOstate







*Elegant  
Bliss*

**Embrace a  
Kaleidoscope of  
Colors**

Step into the boundless vibrancy of Supreme Residence and embrace the elegance of stylish living. From dazzling interiors to vibrant facilities, every moment is a stroke of brilliance.







## **Unparalleled Convenience at Supreme Residence Ideal Location**

Located between the Umm Suqeim Road and the Sheikh Mohammed Bin Zayed Road, Arjan offers a strategic location with seamless connectivity to major roadways. Residents enjoy the convenience of hassle-free commuting, thanks to the easy accessibility of these arterial routes, allowing you to explore Dubai's wonders.







# Strategic Location



## Shopping Malls

My City Center	5 Minutes
Dubai Hills	10 Minutes
Mall of The Emirates	15 Minutes

## Attractions

Dubai Hills Golf Club	15 Minutes
Downtown Dubai	20 Minutes
JBR Beach	22 Minutes

## Schools

Nord Angila International School	5 Minutes
Australian International School	5 Minutes
Safa Community School	5 Minutes
Repton School Al Barsha	8 Minutes
GEMS National School	8 Minutes
Brighton College Dubai	8 Minutes
Bloom World Academy	8 Minutes
Kings' School Al Barsha	10 Minutes

## Hospital

Mediclinic Parkview Hospital	5 Minutes
Neuro Spinal Hospital	7 Minutes
Saudi German Specialty Hospitals	12 Minutes

## Airport

Dubai International Airport	25 minutes
Al Maktoum International Airport	25 Minutes





**Investment  
Brilliance Shines  
*Bright!***





LUNOSTATE  
SUPREME RESIDENCE







# Aqua Cinema

Experience pure bliss at our wonderful swimming pool, where you can relax and rejuvenate. Immerse yourself in the refreshing waters while enjoying a captivating cinema screen, creating a truly enchanting ambiance. Indulge in the perfect blend of relaxation and entertainment, making every moment at our pool a memorable one.







# *Achieve* **Fitness Goals**

Indulge in your fitness journey with our well-equipped gym and exclusive activity area designed for residents. Discover the perfect space to unwind and pursue your wellness goals.







# Delight Corner

Create lasting memories with family and friends in our dedicated barbecue area, designed to enhance your enjoyment within the prestigious Supreme Residence building. Indulge in a delightful day of grilling and relaxation as you savor delicious meals amidst a welcoming atmosphere.









# *Tranquility* Zone

Unwind and socialize in the Supreme Residence's serene fountain area, featuring beautiful seating arrangements for a memorable time with friends and family.

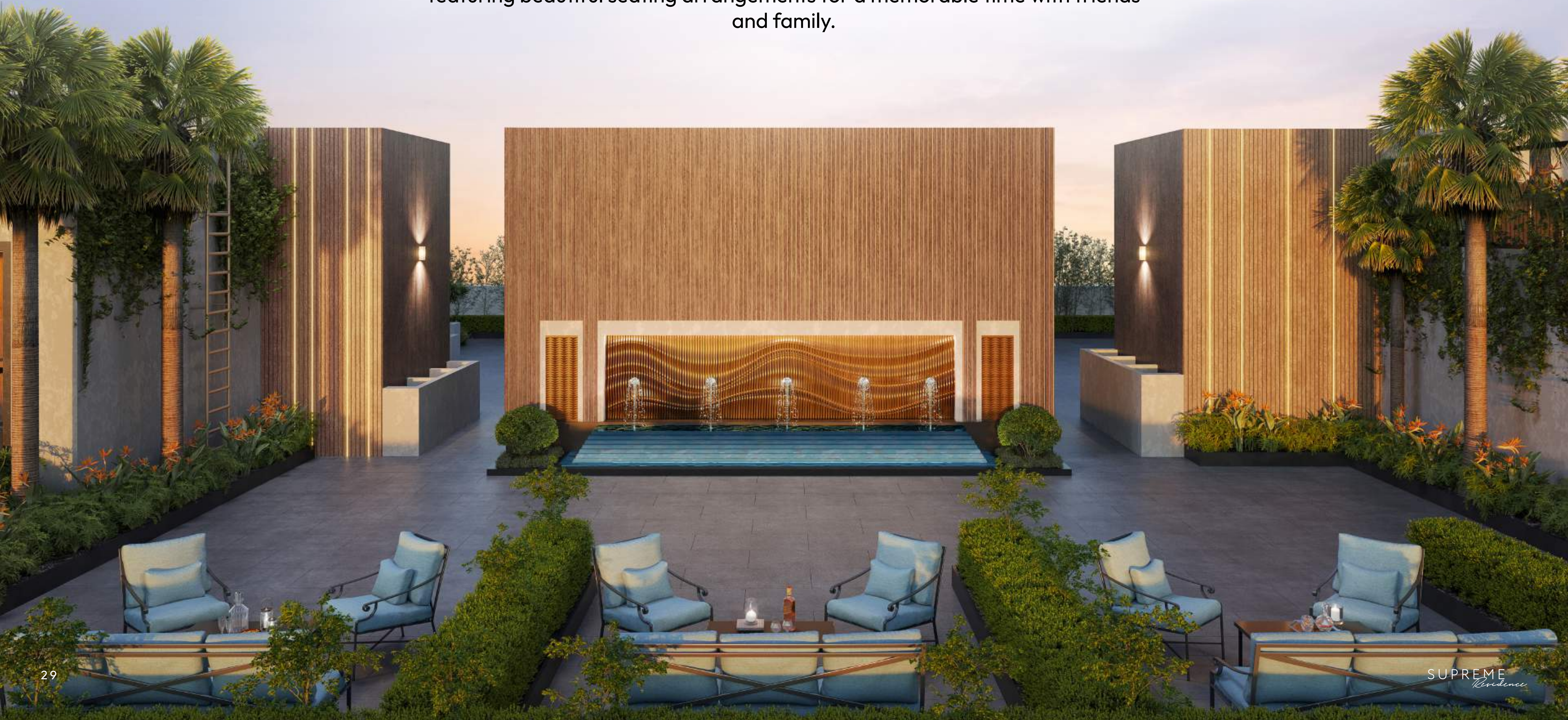





# APARTMENTS



*Spacious  
and Modern  
Living:*

**Studios,  
1 & 2 Bedrooms**















*Ready to  
Welcome:*  
**Handover  
Approaching**

Ready for Handover: Q4 2023









## 5-Year Payment Plan

Maximizing Returns for Investors!





# FLOOR PLANS





# Floor Plate

**(1-6 Floors)**

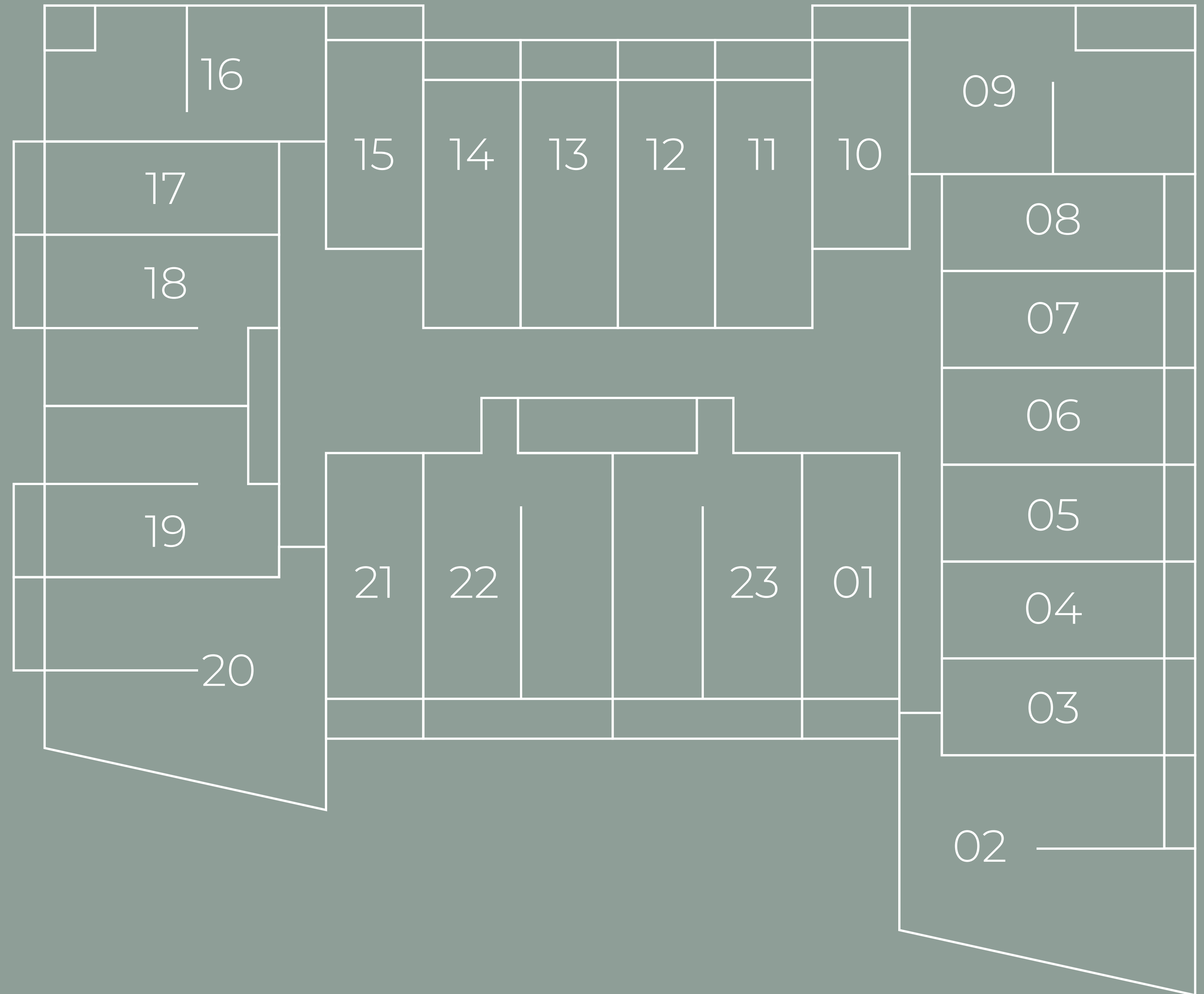





# 01 Studio

## Unit Details

Unit Series: 01  
 Unit Type: Studio  
 Size: 488 sq.ft.

## Location in Building

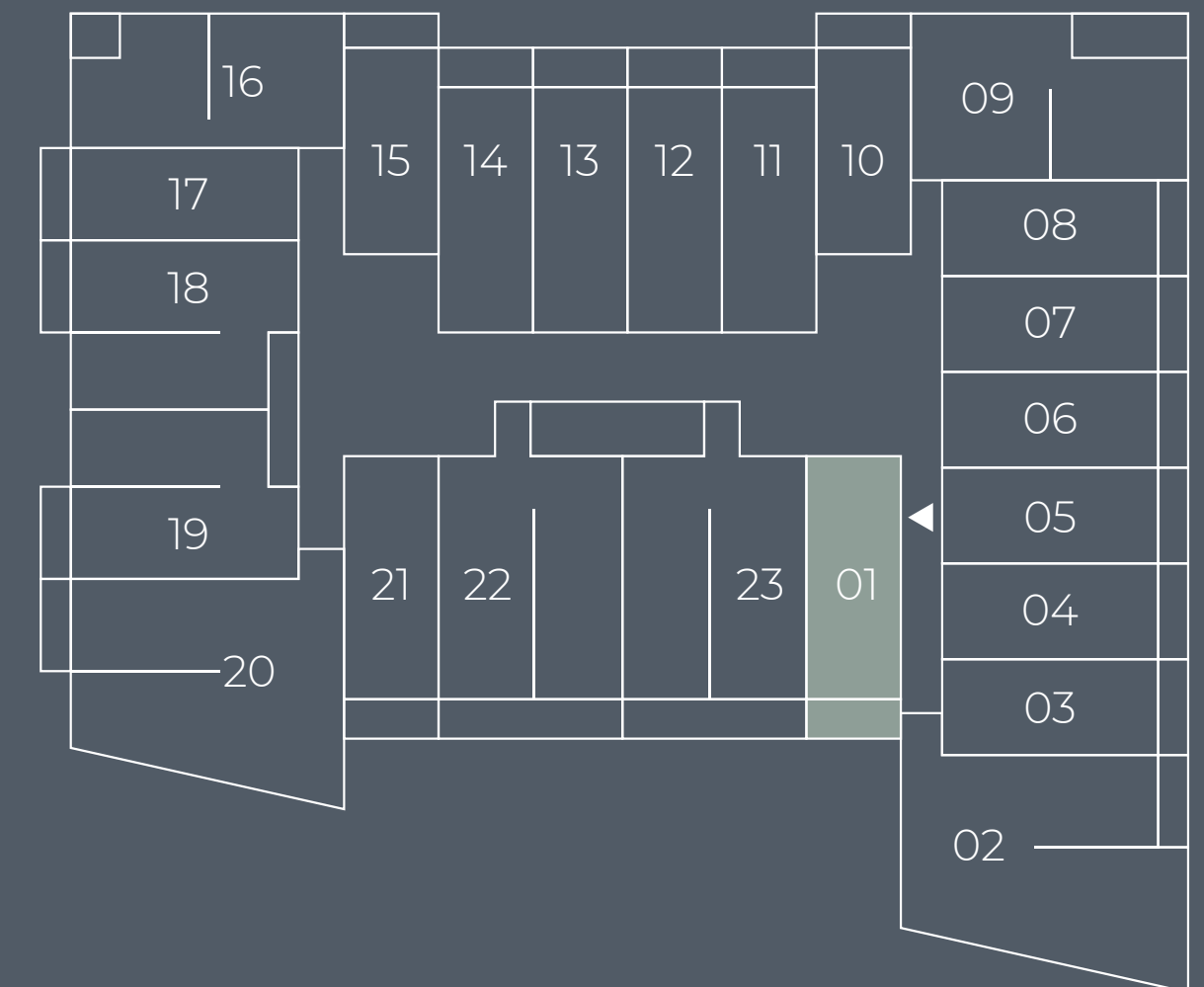





# 02

## 2 Bedrooms

### Unit Details

Unit Series: 02  
 Unit Type: 2 bedrooms  
 Size: 1,197 sq.ft.

### Location in Building

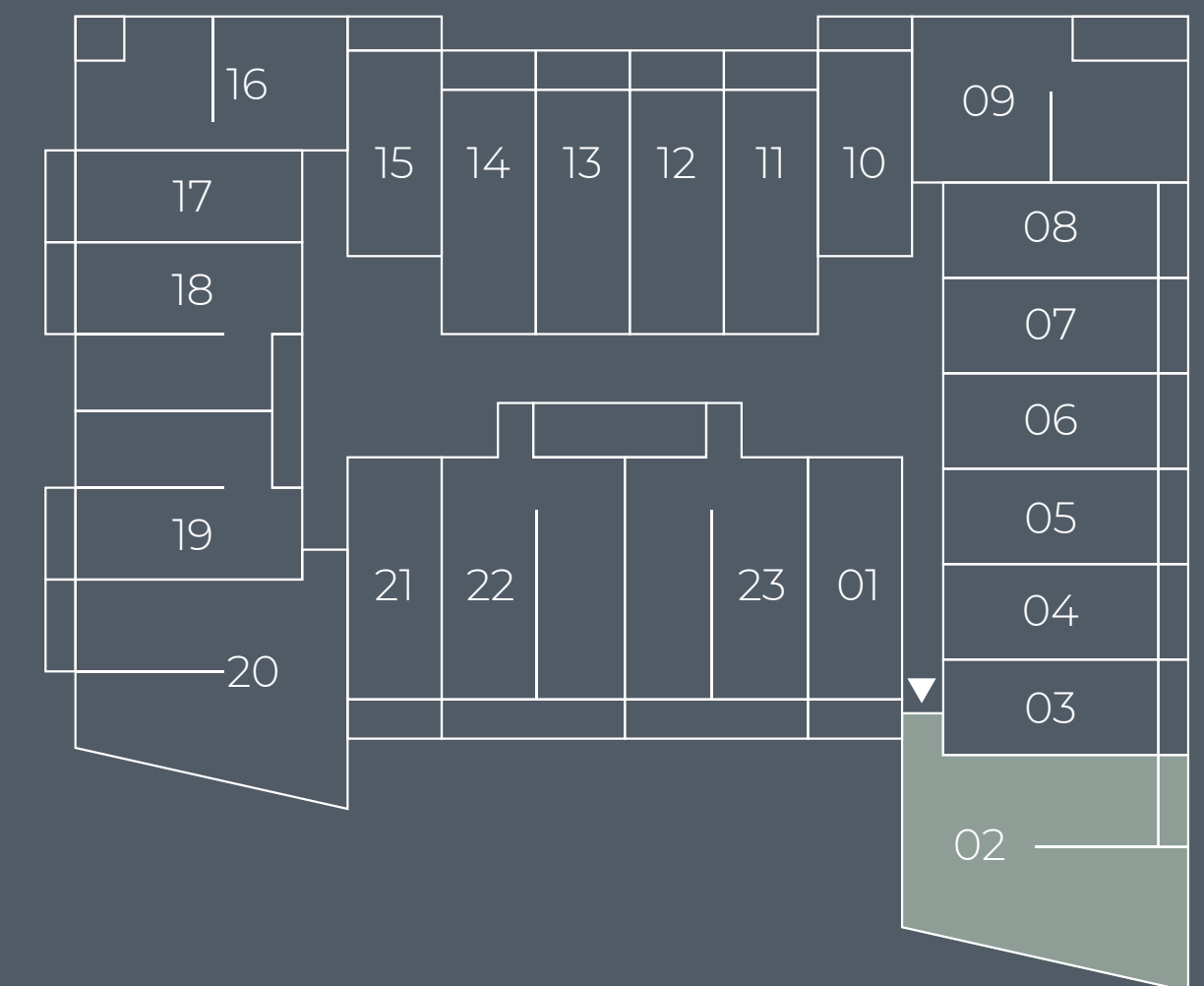



# 03 Studio

## Unit Details

Unit Series: 03  
Unit Type: Studio  
Size: 450 sq.ft.

## Location in Building

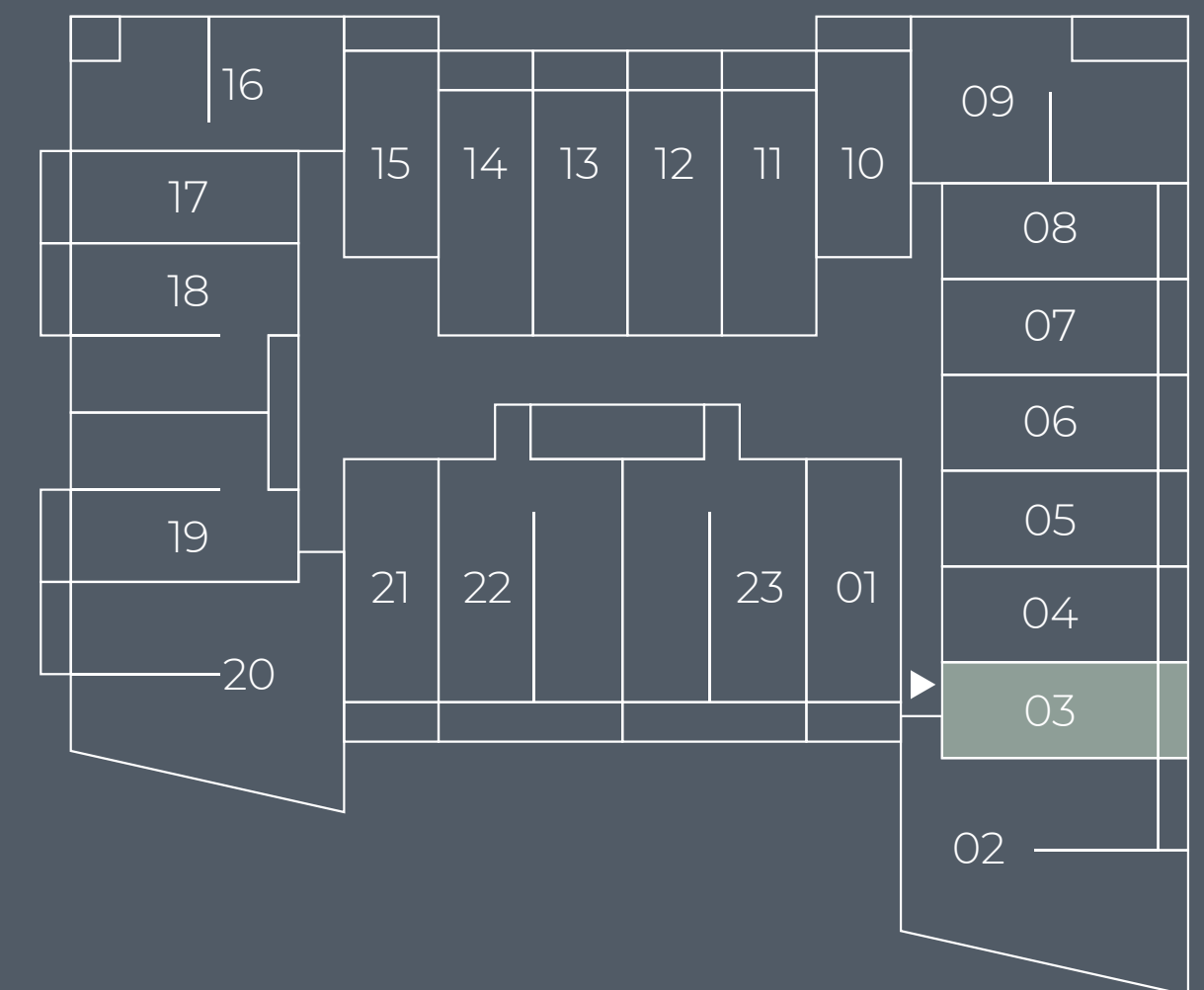



# 04 Studio

## Unit Details

Unit Series: 04  
 Unit Type: Studio  
 Size: 452 sq.ft.

## Location in Building

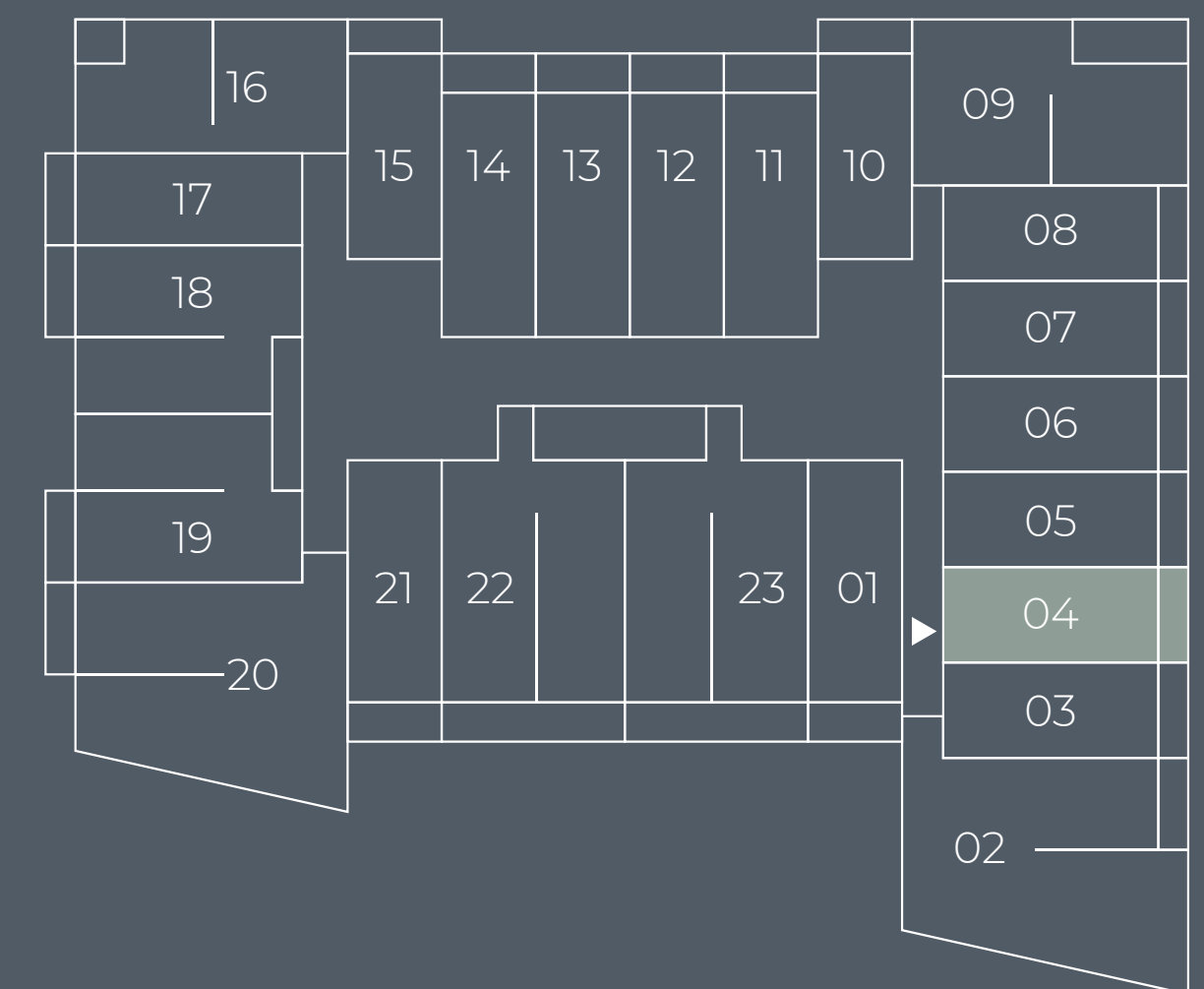



# 05 Studio

## Unit Details

Unit Series: 05  
Unit Type: Studio  
Size: 451 sq.ft.

## Location in Building

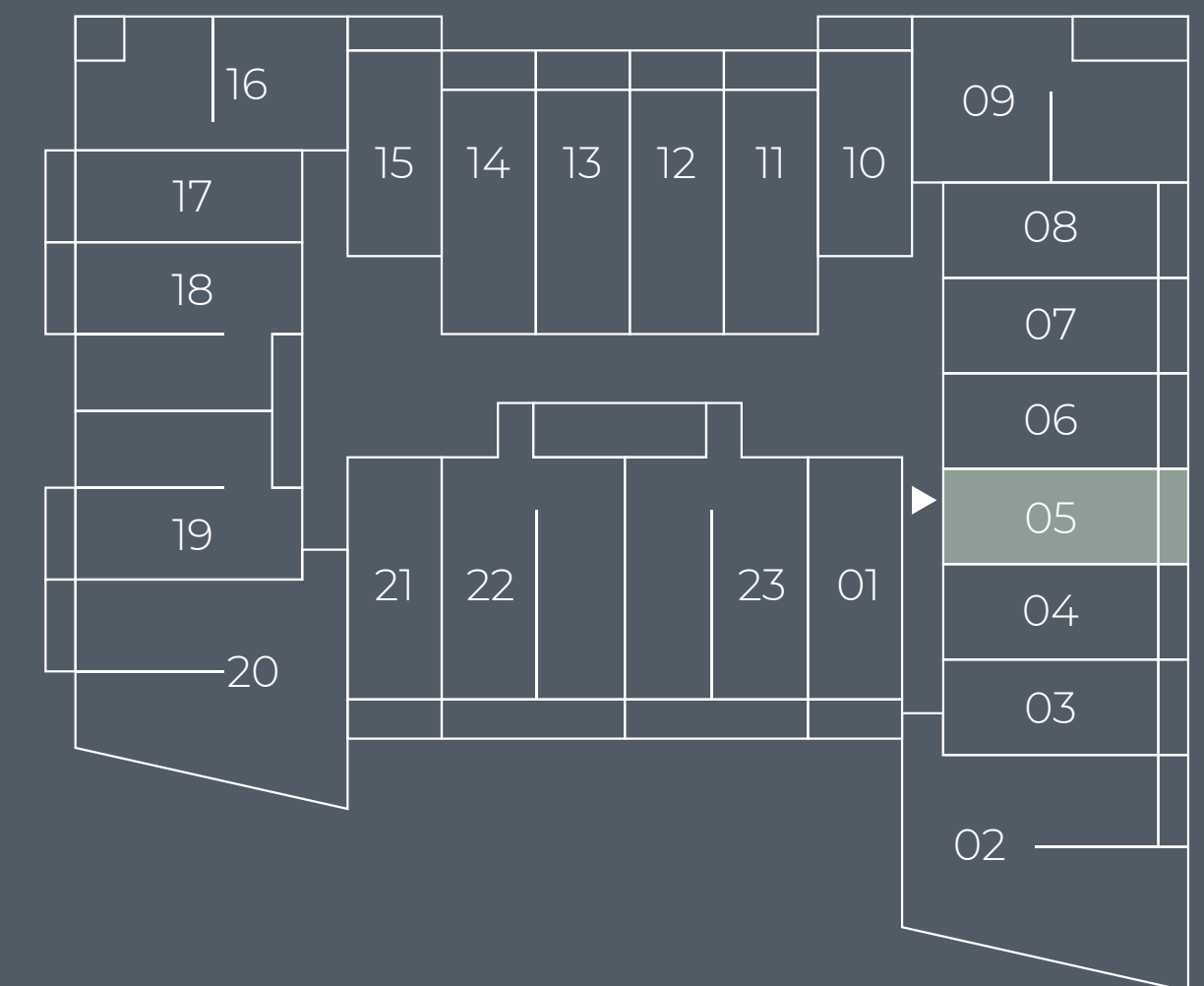



# 06 Studio

## Unit Details

Unit Series: 06  
Unit Type: Studio  
Size: 451 sq.ft.

## Location in Building

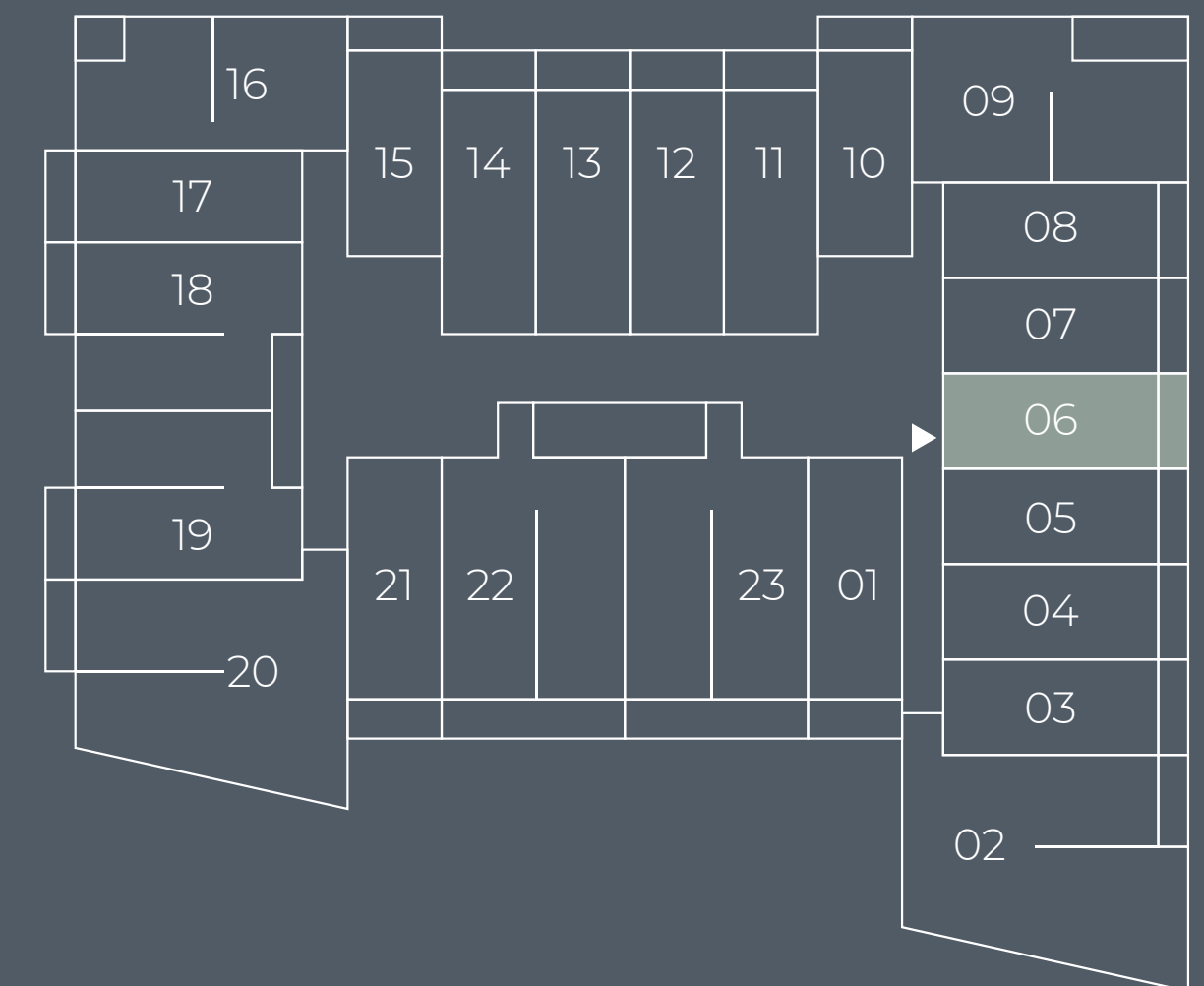



# 07 Studio

## Unit Details

Unit Series: 07  
Unit Type: Studio  
Size: 449 sq.ft.

## Location in Building

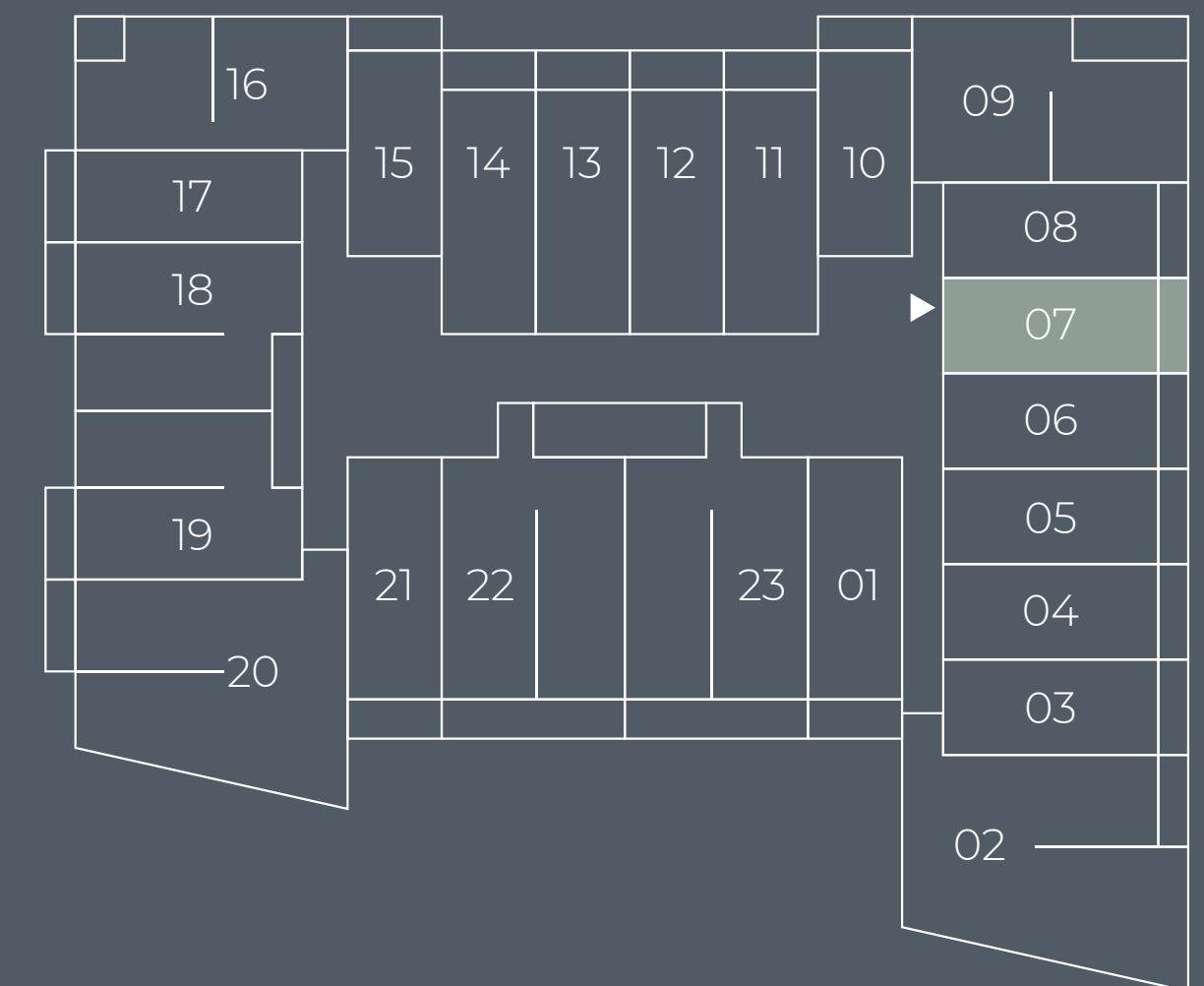



# 08 Studio

## Unit Details

Unit Series: 08  
 Unit Type: Studio  
 Size: 448 sq.ft.

## Location in Building

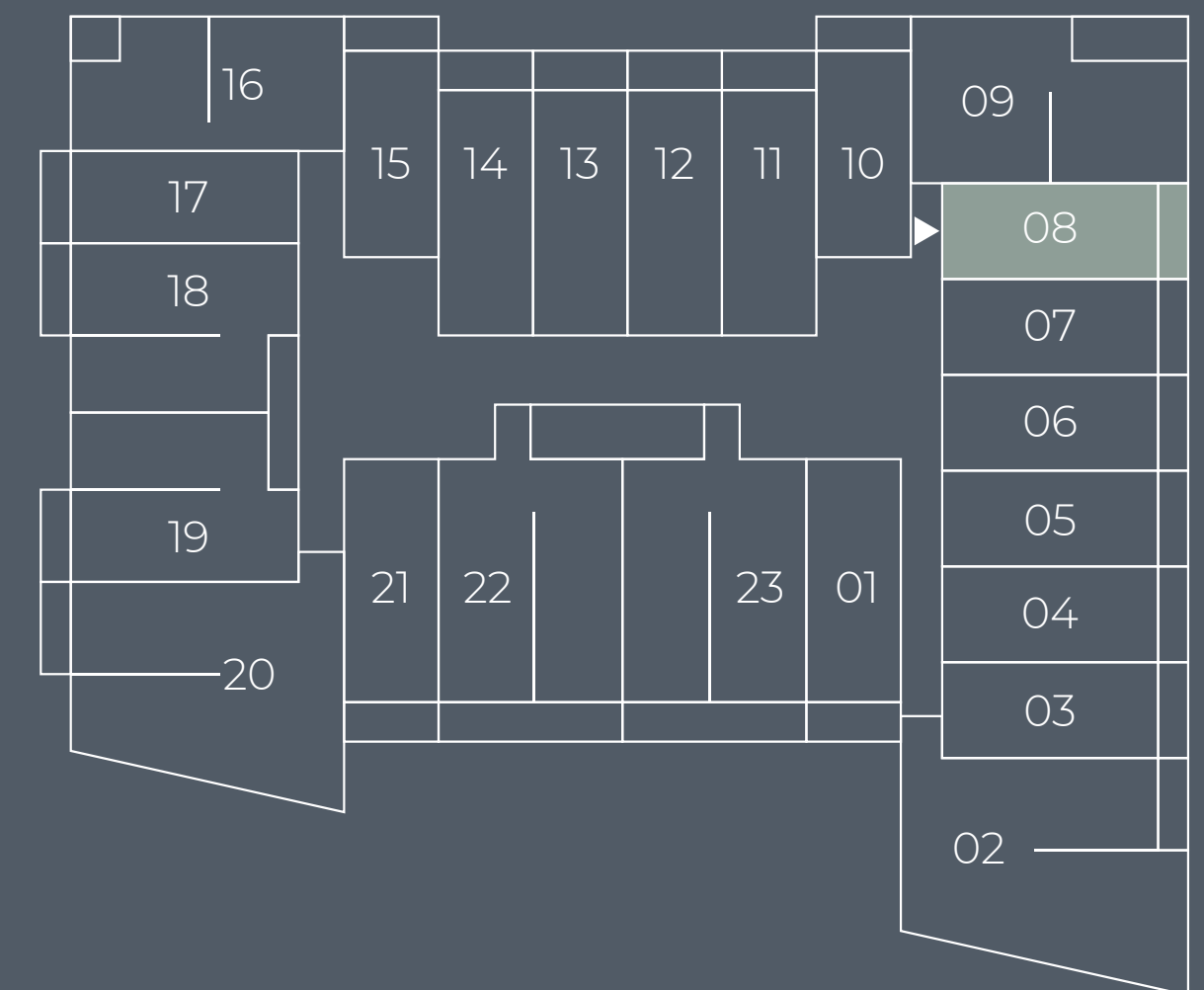



# 09

## 1 Bedroom

### Unit Details

Unit Series: 09  
 Unit Type: 1 bedroom  
 Size: 928 sq.ft.

### Location in Building

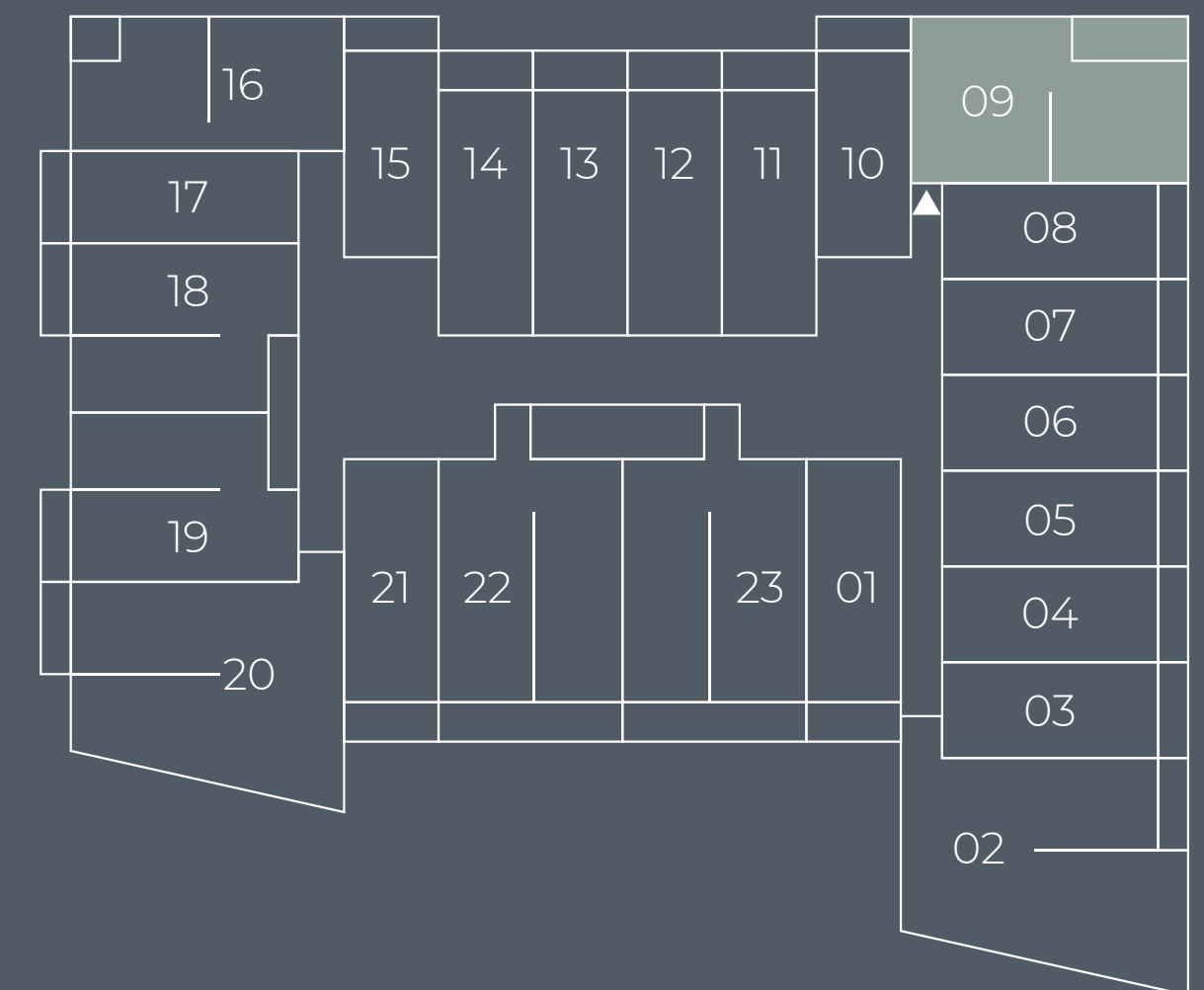





# 10 Studio

## Unit Details

Unit Series: 10  
 Unit Type: Studio  
 Size: 430 sq.ft.

## Location in Building

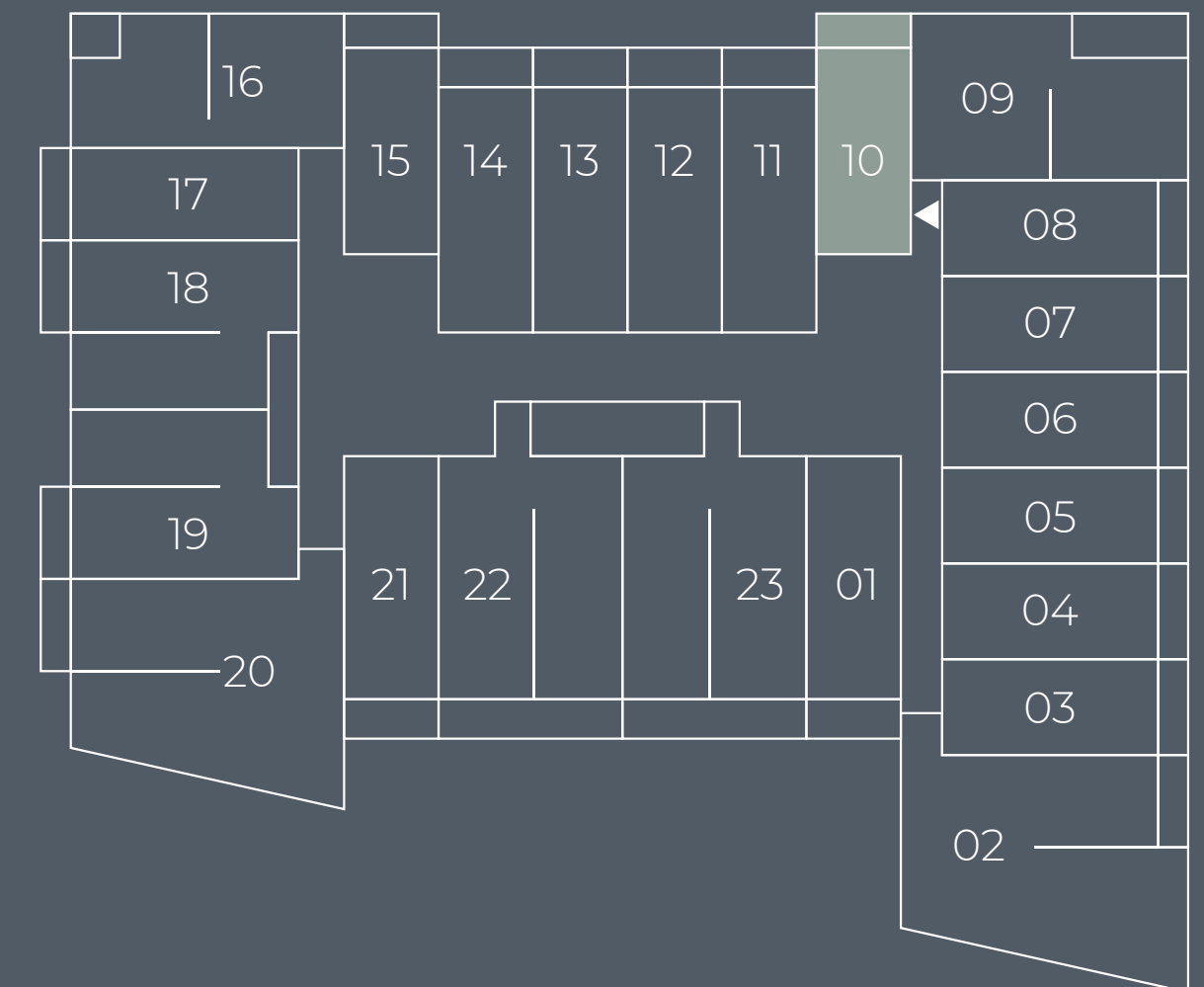





# 11 Studio

## Unit Details

Unit Series: 11  
 Unit Type: Studio  
 Size: 510 sq.ft.

## Location in Building

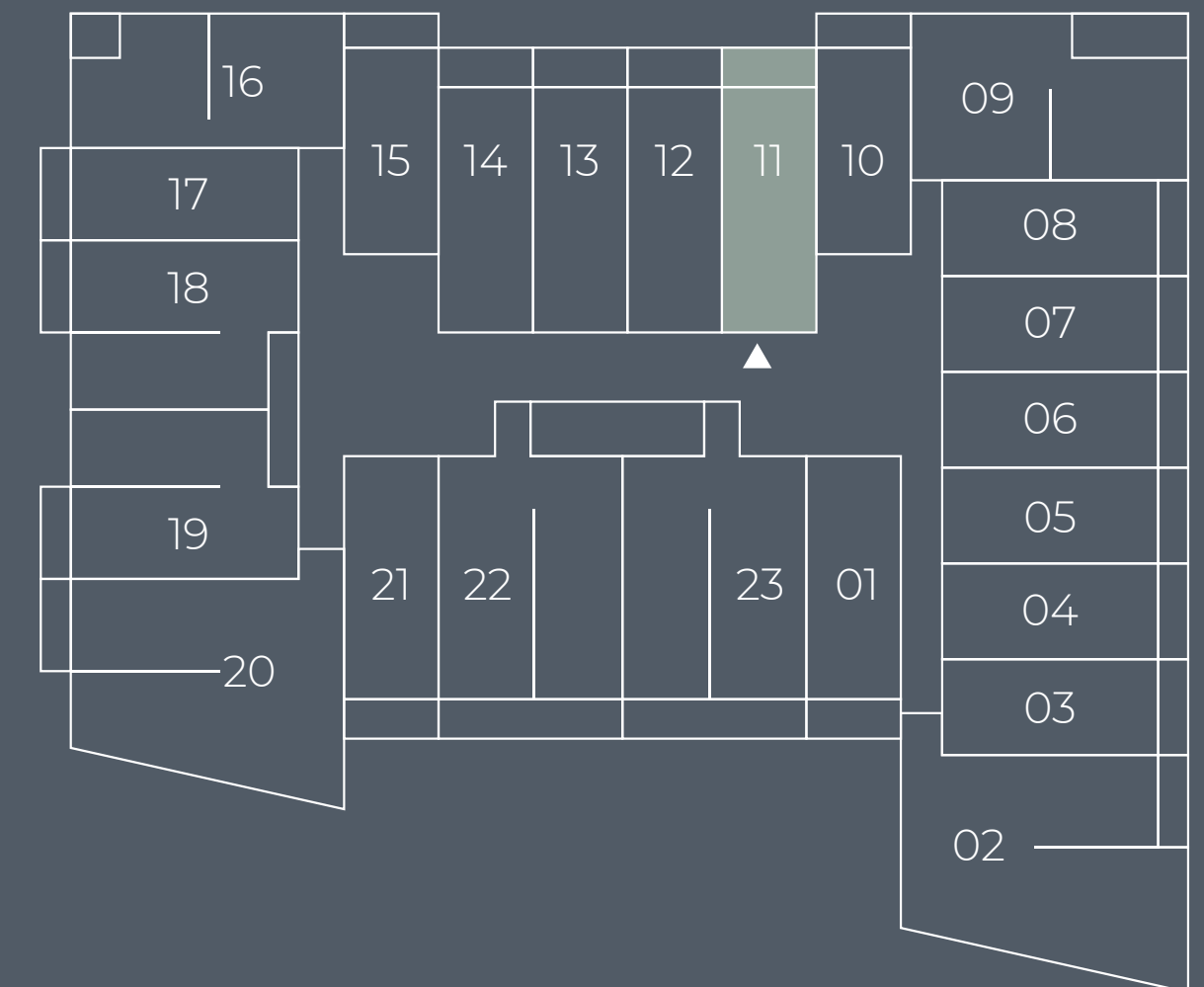





# 12 Studio

## Unit Details

Unit Series: 12  
Unit Type: Studio  
Size: 507 sq.ft.

## Location in Building

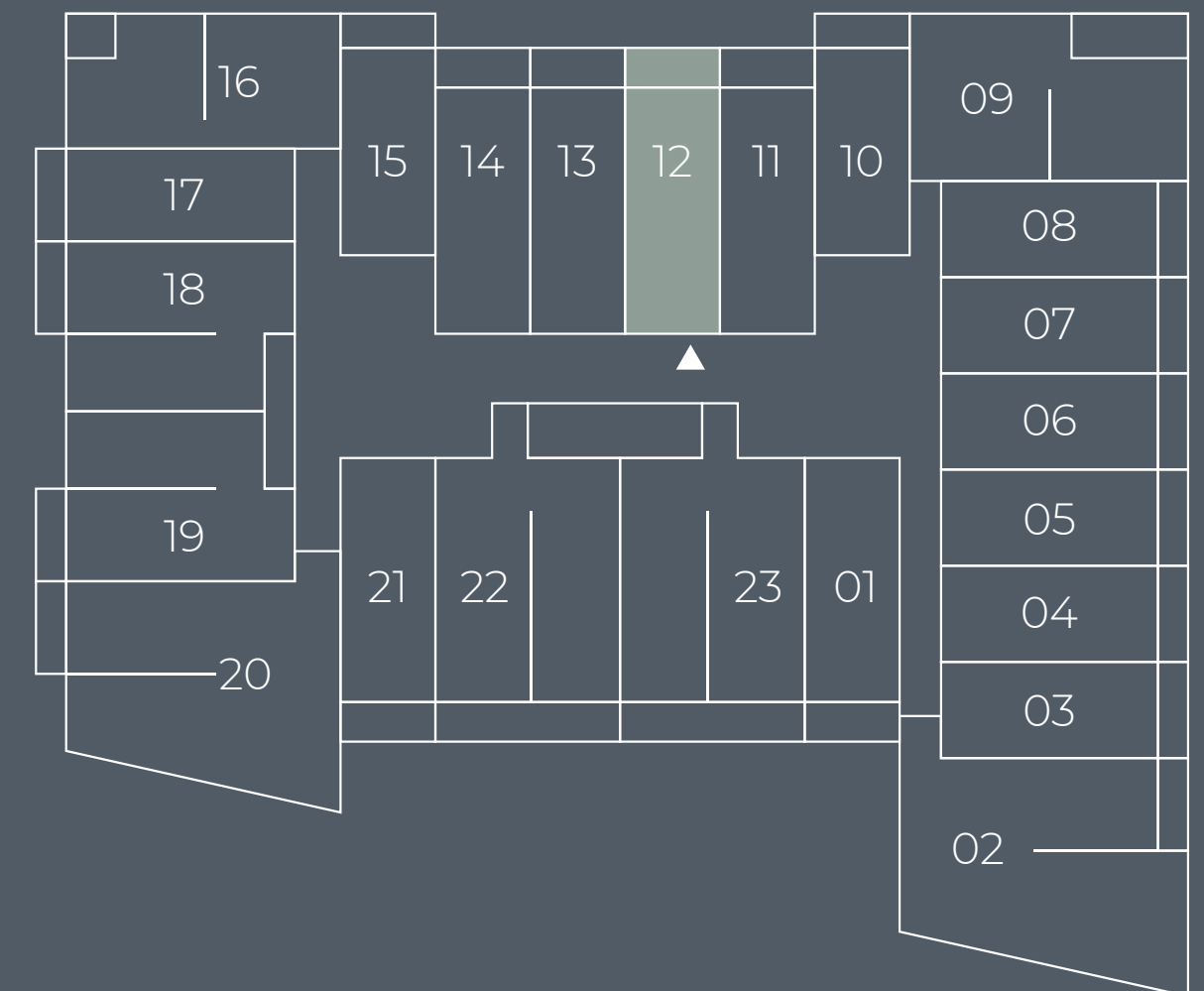





# 13 Studio

## Unit Details

Unit Series: 13  
Unit Type: Studio  
Size: 506 sq.ft.

## Location in Building

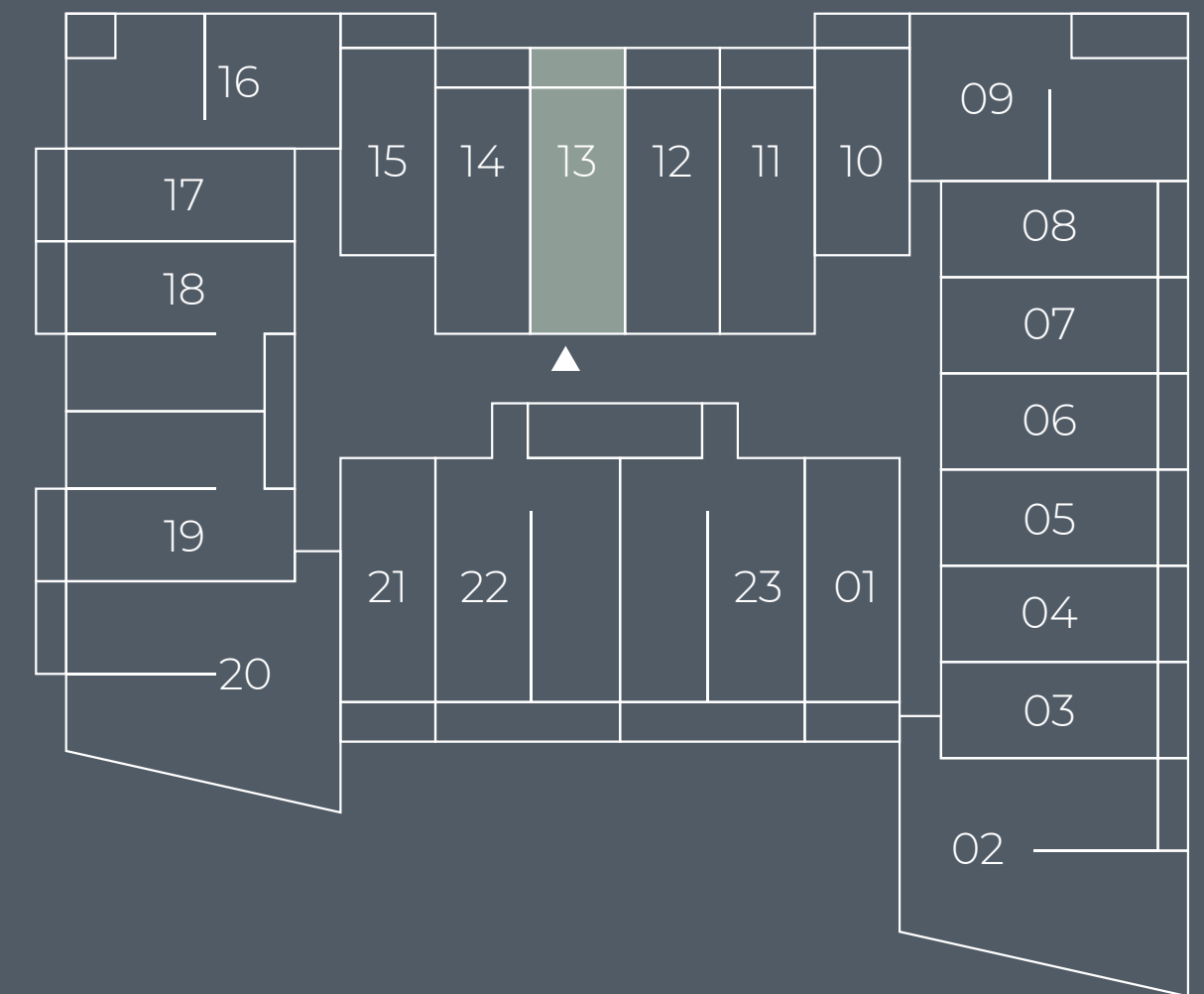





# 14 Studio

## Unit Details

Unit Series: 14  
 Unit Type: Studio  
 Size: 509 sq.ft.

## Location in Building

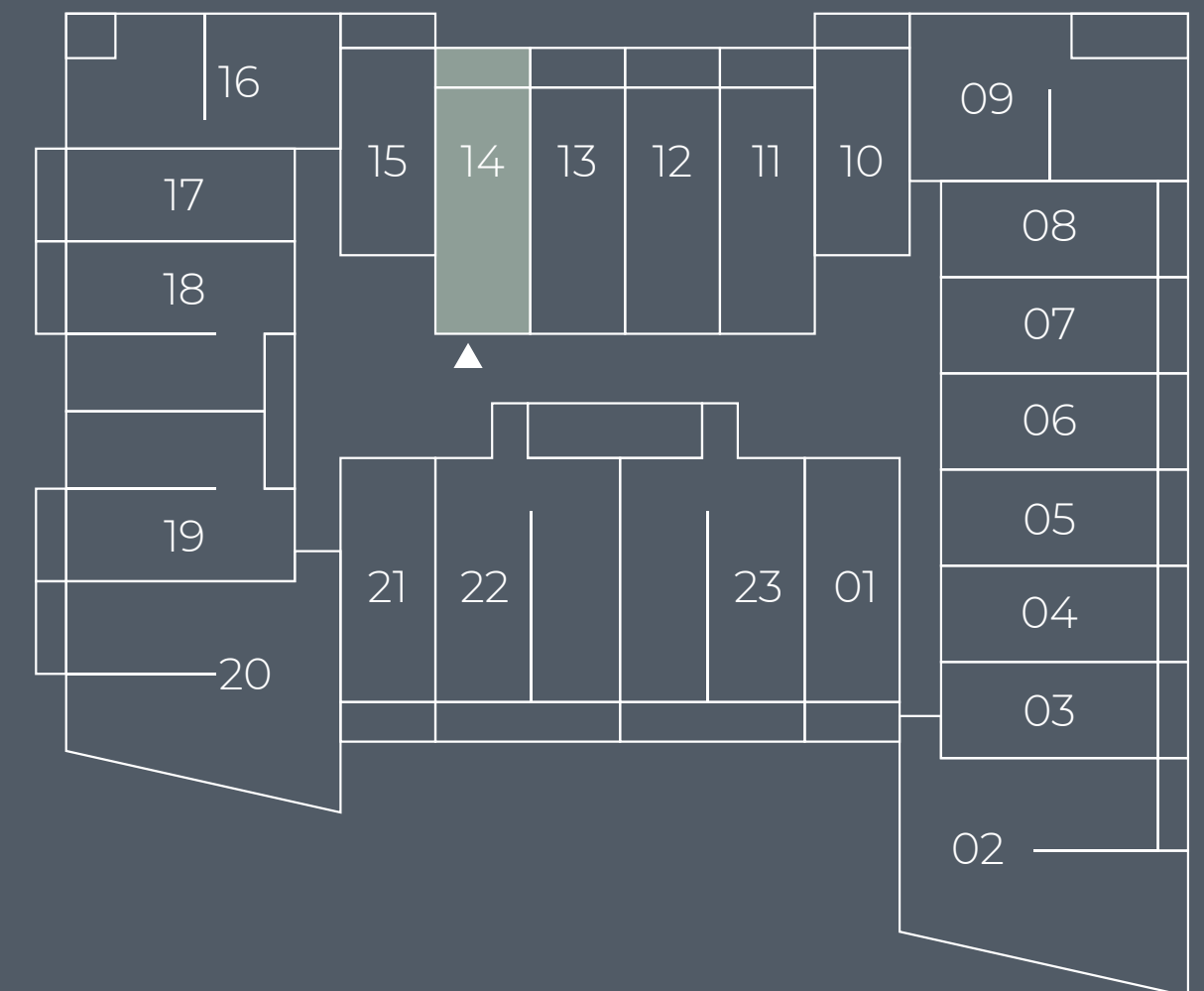





# 15 Studio

## Unit Details

Unit Series: 15  
Unit Type: Studio  
Size: 436 sq.ft.

## Location in Building

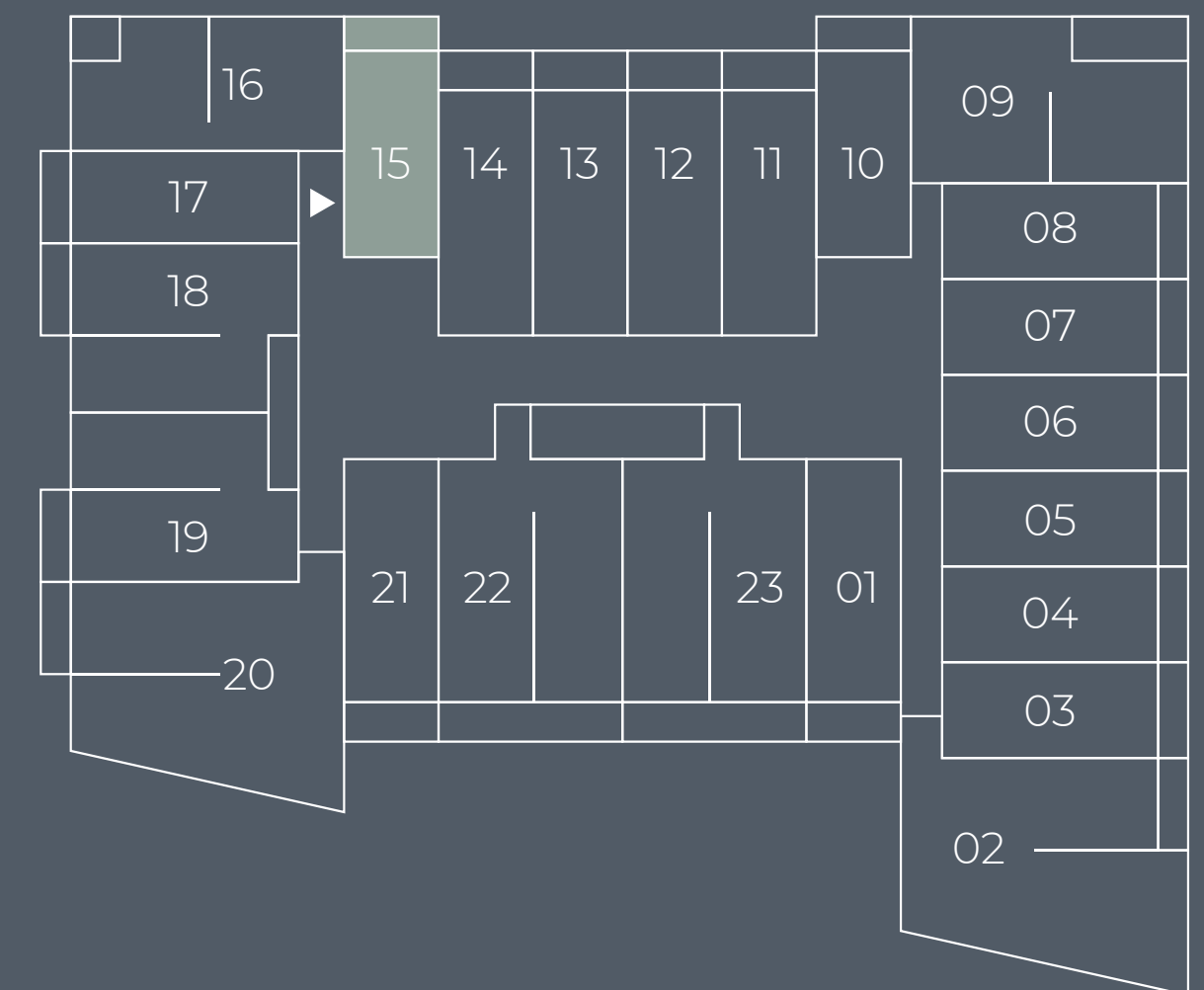



# 16

## 1 Bedroom

### Unit Details

Unit Series: 16  
 Unit Type: 1 bedroom  
 Size: 731 sq.ft.

### Location in Building

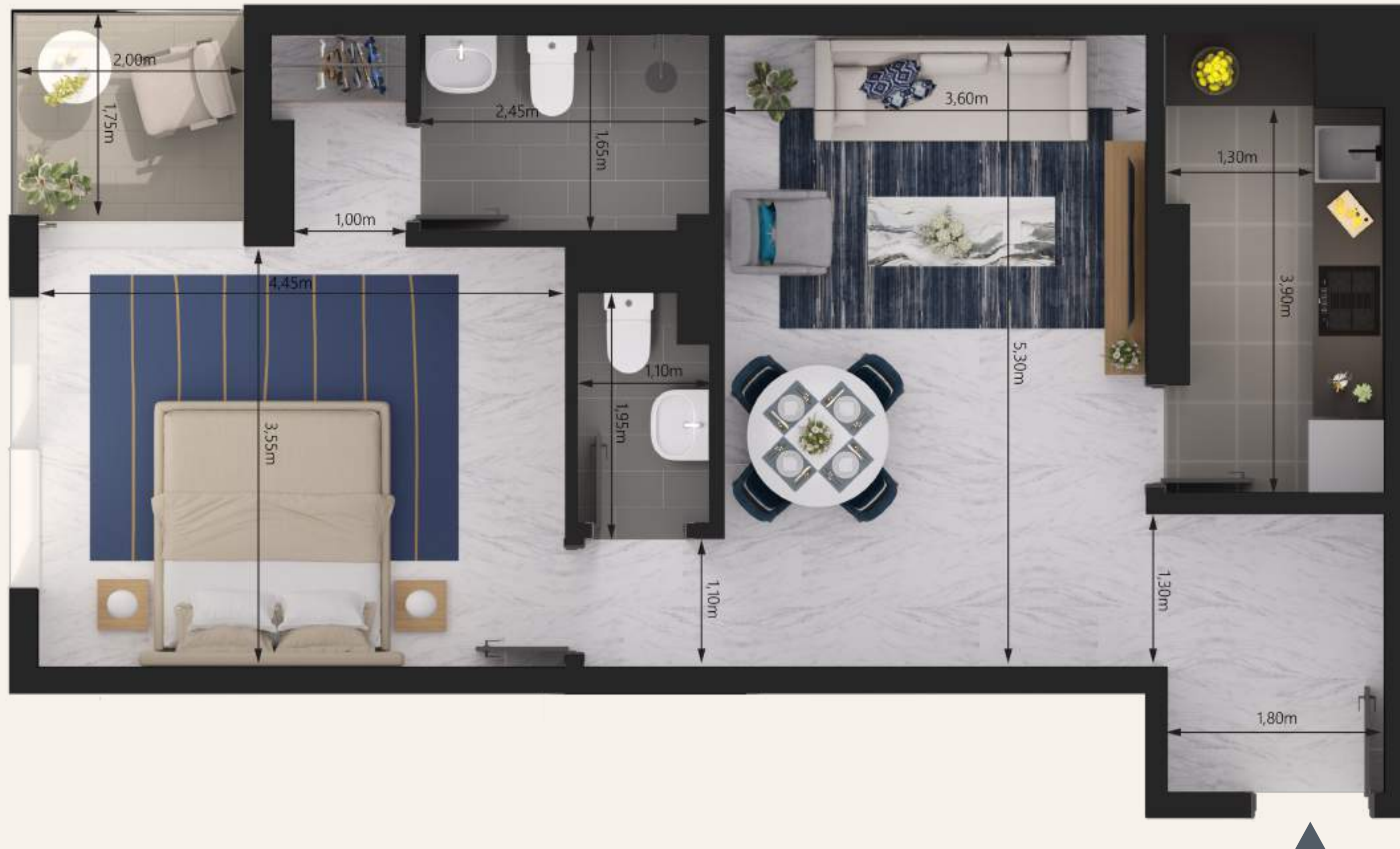
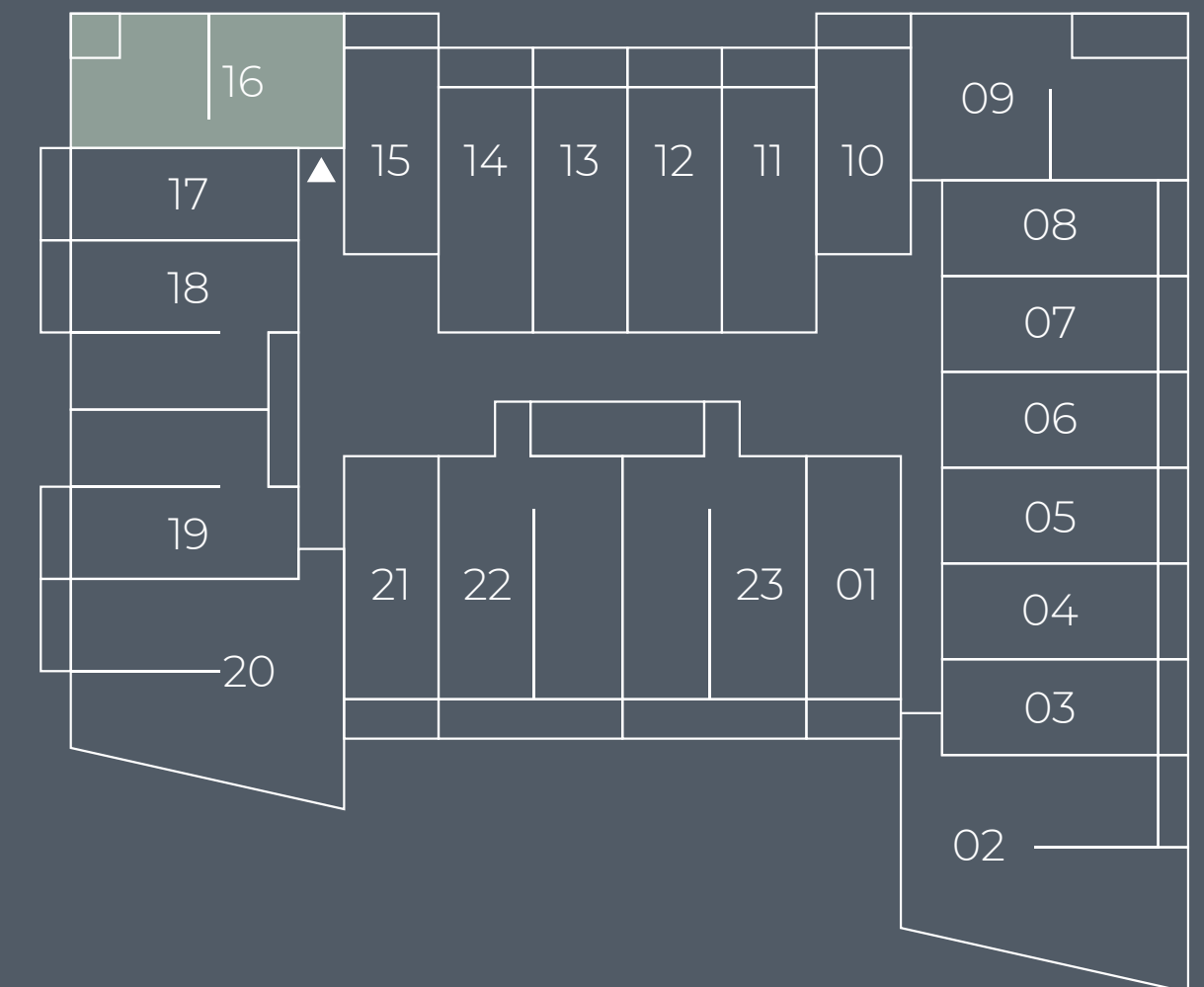



# 17 Studio

## Unit Details

Unit Series: 17  
 Unit Type: Studio  
 Size: 470 sq.ft.

## Location in Building

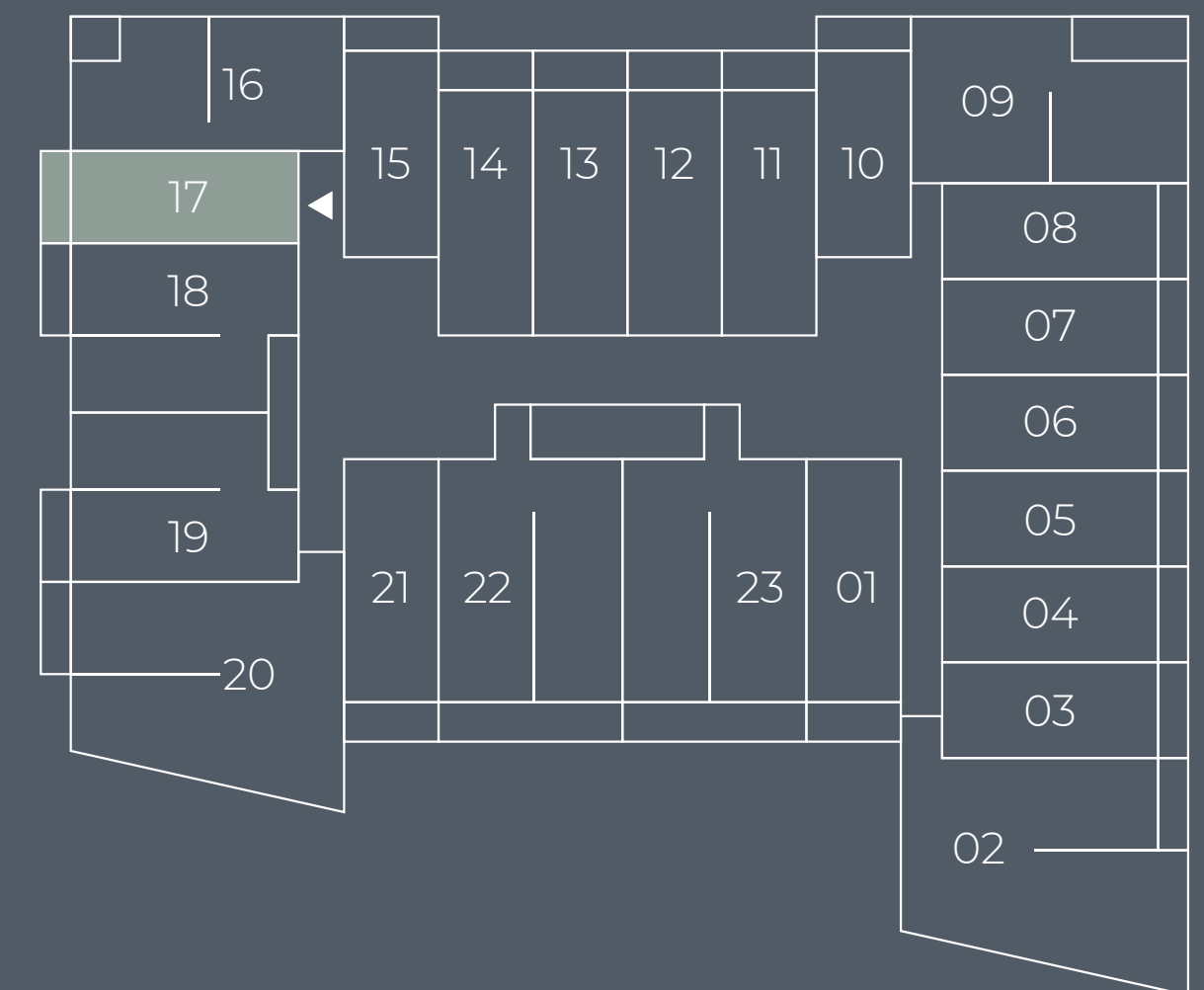





18

# 1 Bedroom

## Unit Details

Unit Series: 18  
 Unit Type: 1 bedroom  
 Size: 730 sq.ft.

## Location in Building

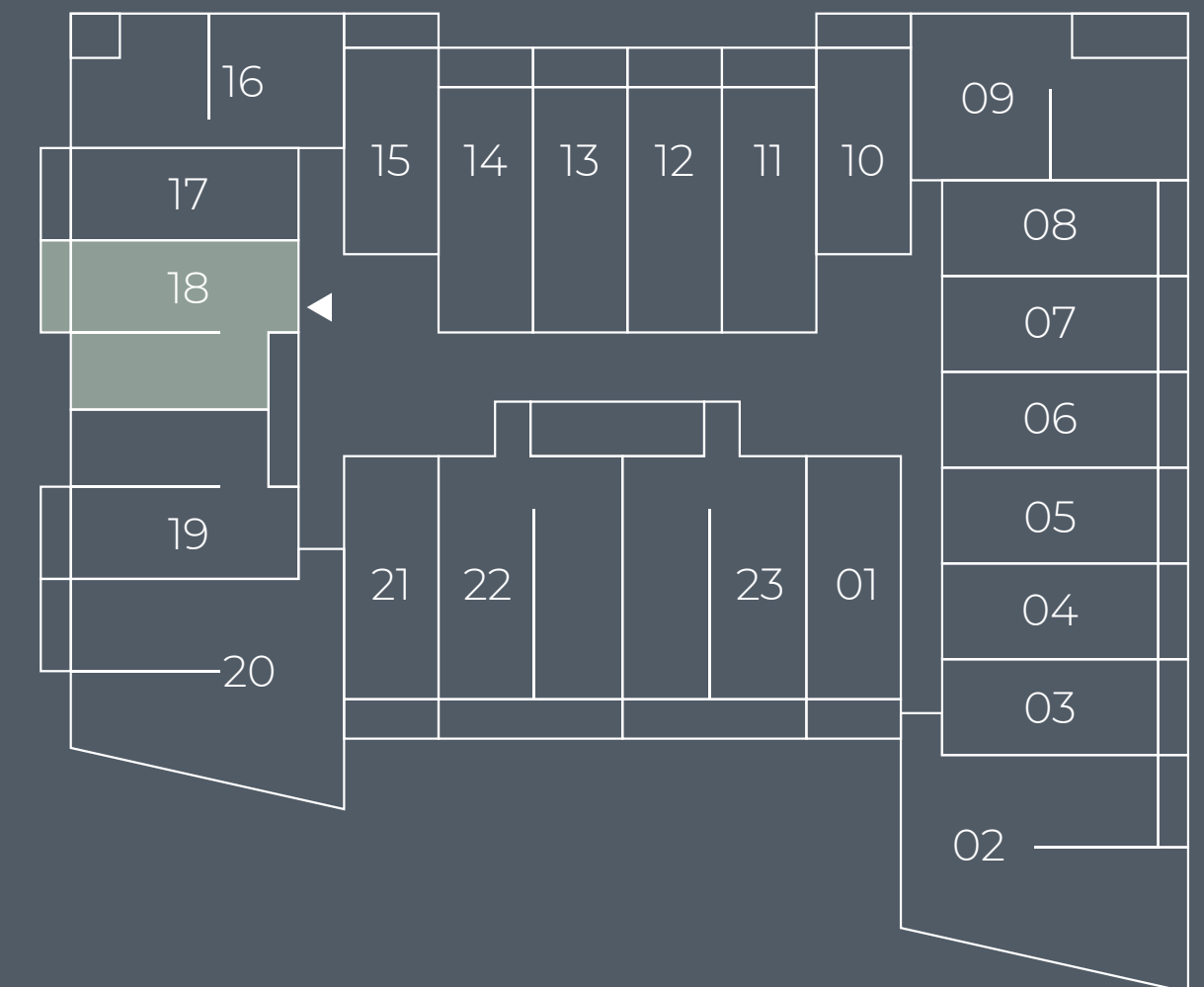





# 19

## 1 Bedroom

### Unit Details

Unit Series: 19  
 Unit Type: 1 bedroom  
 Size: 733 sq.ft.

### Location in Building

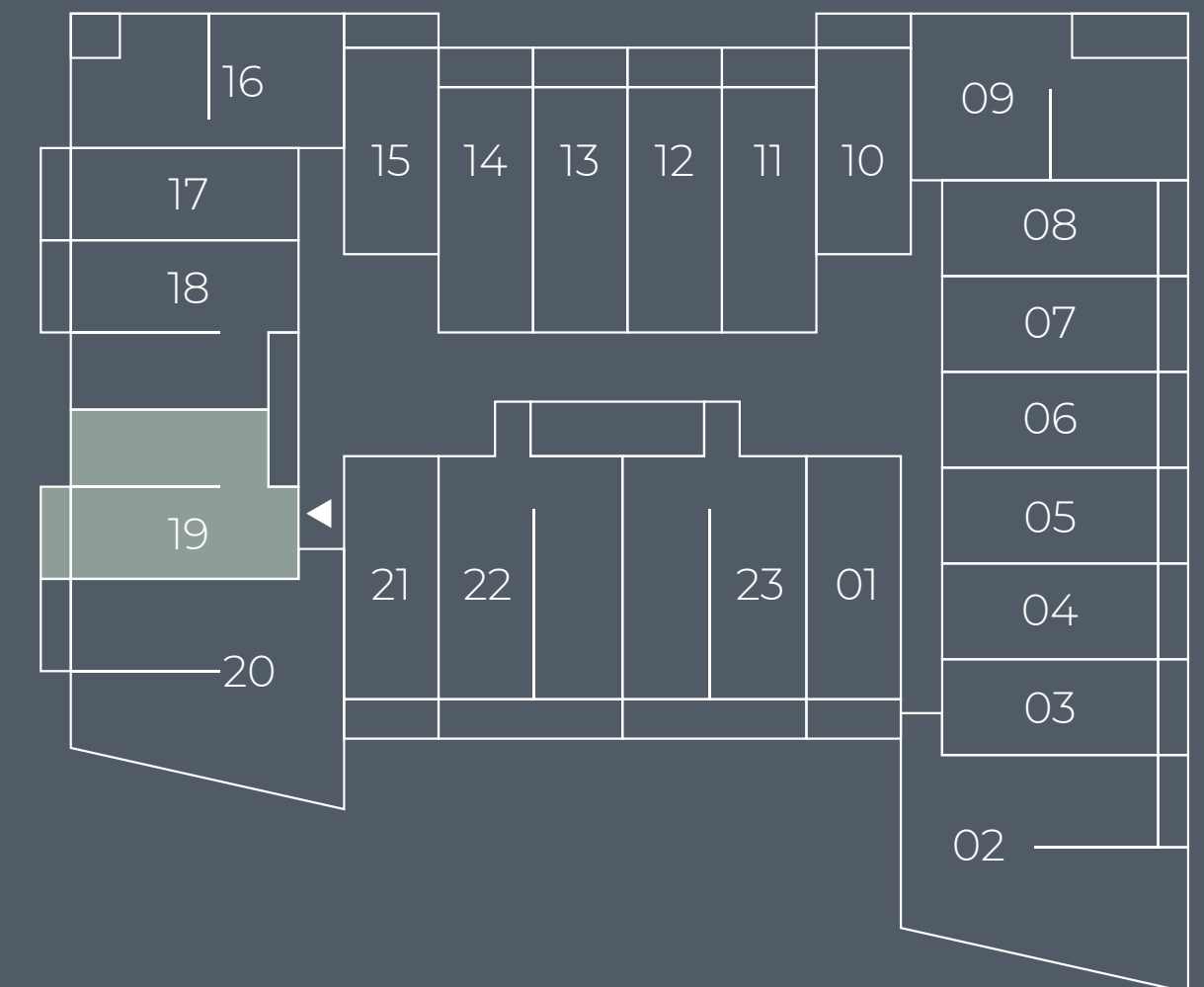





# 20

## 2 Bedrooms

### Unit Details

Unit Series: 20  
 Unit Type: 2 bedrooms  
 Size: 1,127 sq.ft.

### Location in Building

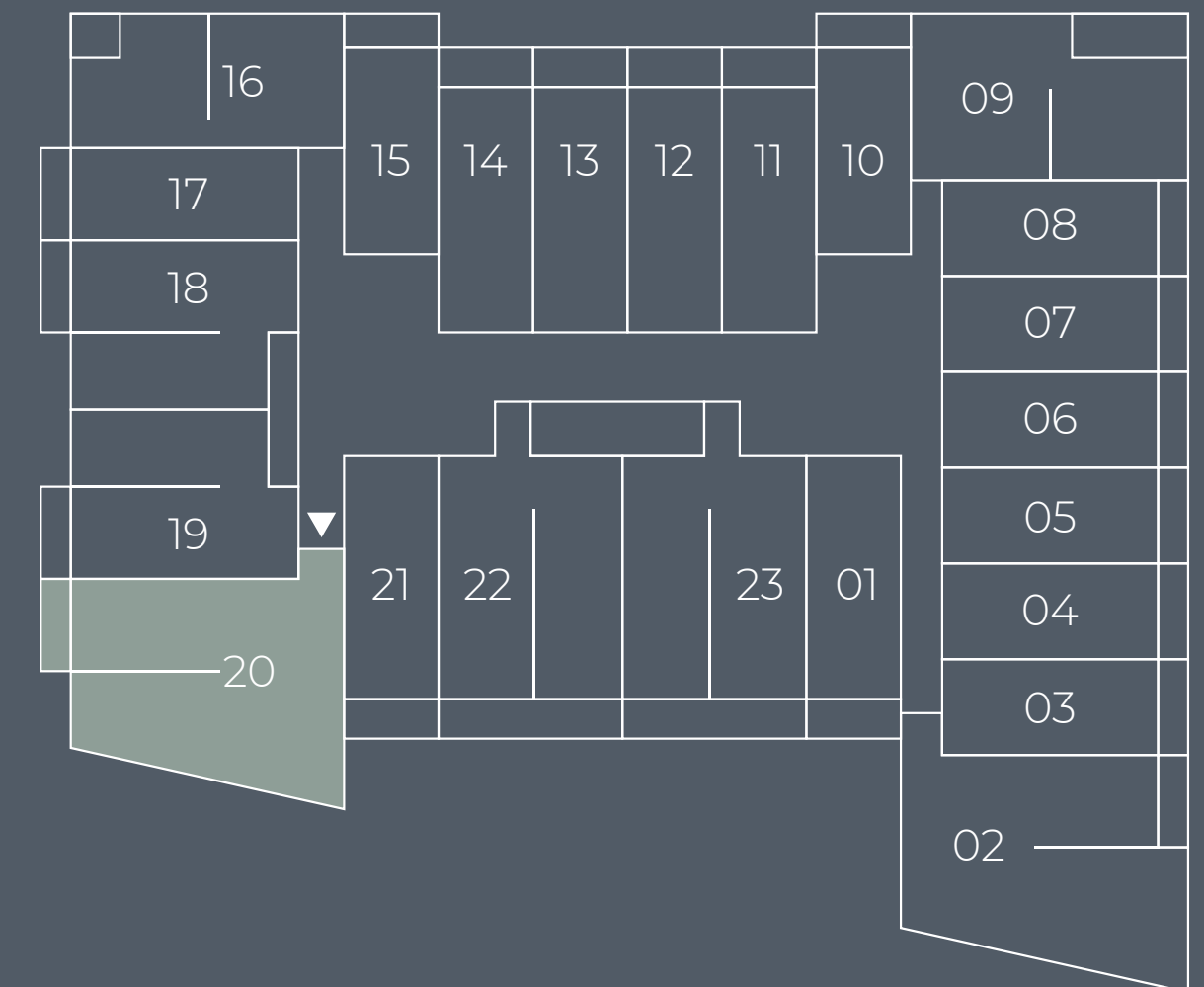





# 21 Studio

## Unit Details

Unit Series: 21  
 Unit Type: Studio  
 Size: 508 sq.ft.

## Location in Building

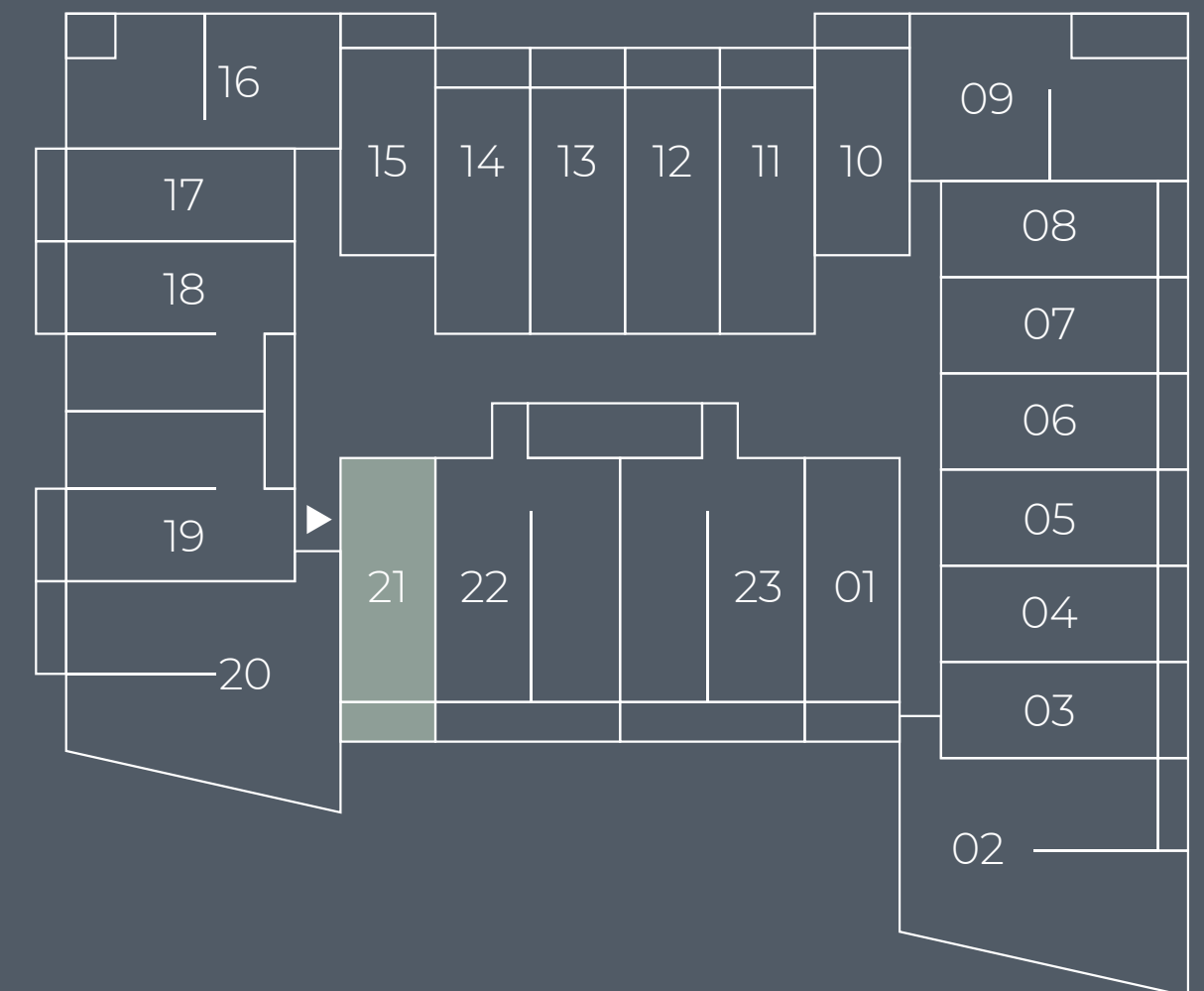





# 22

## 1 Bedroom

### Unit Details

Unit Series: 22  
 Unit Type: 1 bedroom  
 Size: 984 sq.ft.

### Location in Building

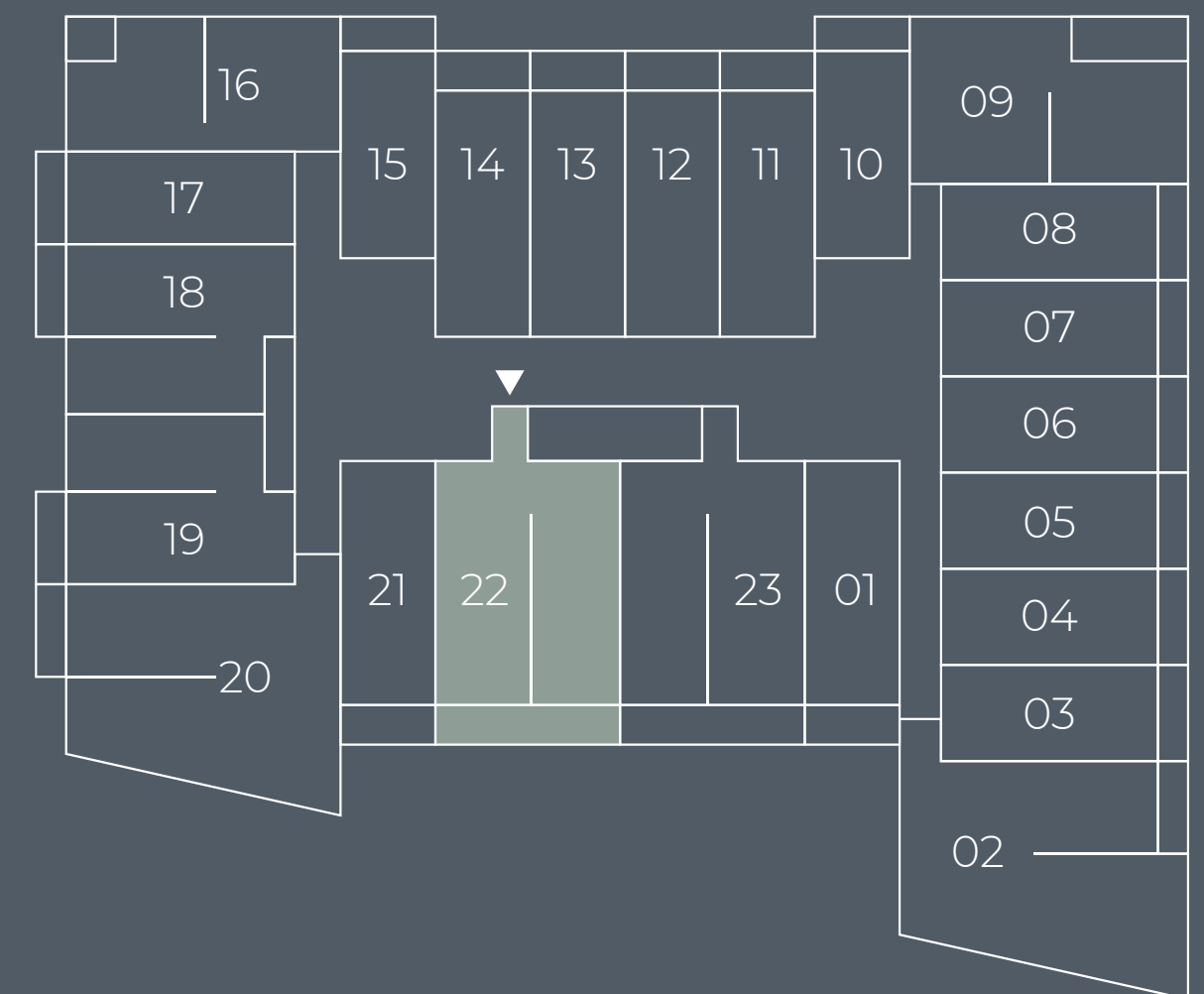





# 23

## 1 Bedroom

### Unit Details

Unit Series: 23  
 Unit Type: 1 bedroom  
 Size: 990 sq.ft.

### Location in Building

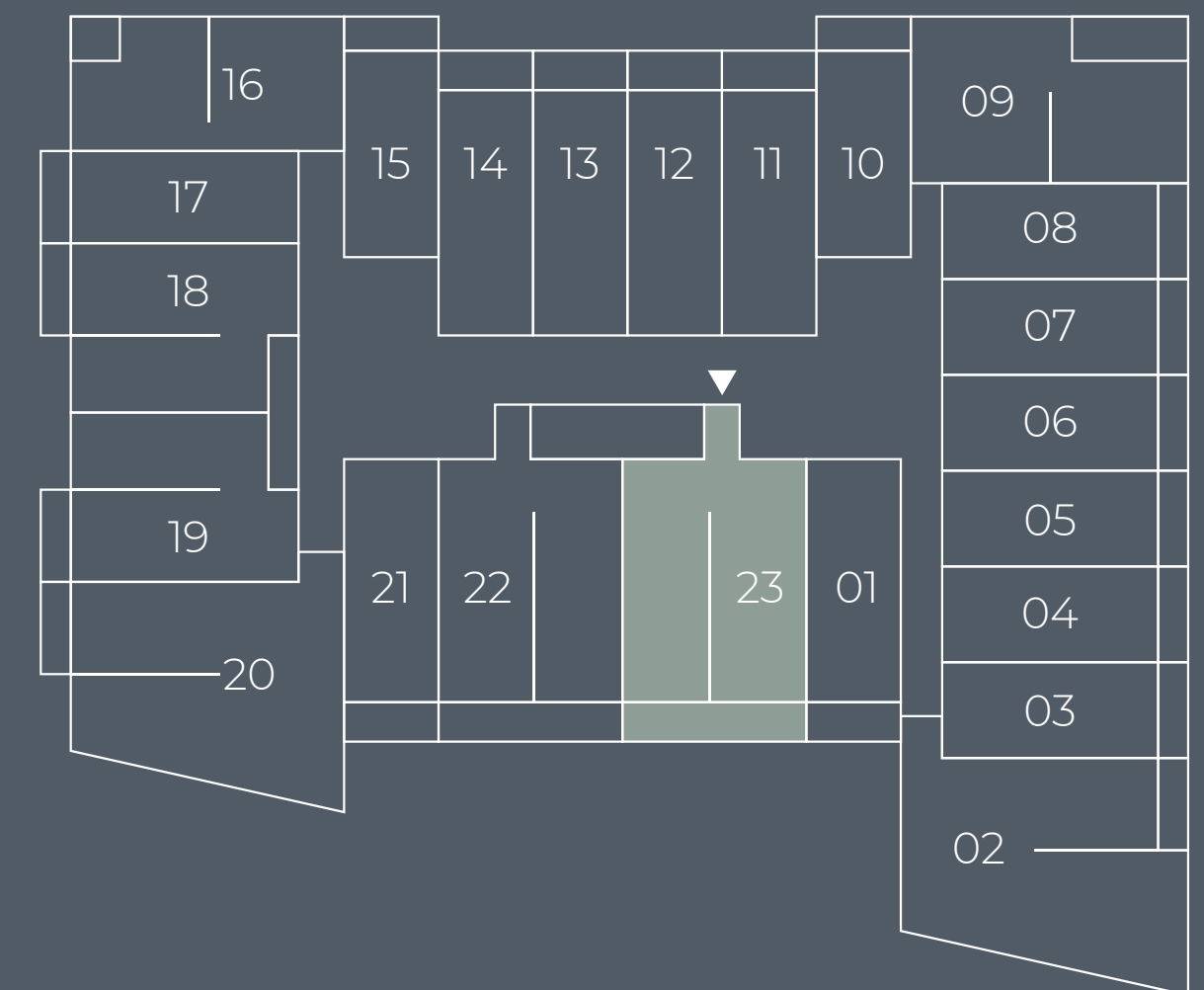



SUPREME  
*Residence*

BY ■ UNIOstate

*Find Serenity,*  
**Radiate Joy**

[www.uniestate.com](http://www.uniestate.com)

409 , Building 4, Emaar Business Park ,  
Dubai, UAE