

More information at:
rise-residences.com

STUDIO

Unit 103

425 Sq.ft

DIMENSIONS

- ① **INTERNAL AREA:** 351.66 Sq.Ft. (32.67 Sq.M.)
- ② **BALCONY AREA:** 73.63 Sq.Ft. (6.84 Sq.M.)
- ③ **TOTAL AREA:** 425.28 Sq.Ft. (39.51 Sq.M.)

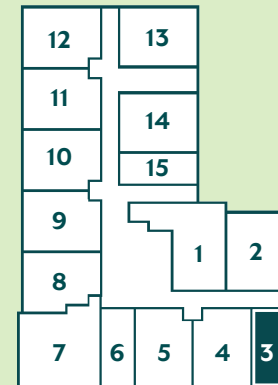

1. All dimensions are in imperial and metric, and measured to structural elements and exclude wall finishes and construction tolerances. 2. All materials, dimensions, and drawings are approximate only. 3. Information is subject to change without notice at developer's absolute discretion. 4. Actual area may vary from the stated area. 5. Drawings not to scale. 6. All images used are for illustrative purposes only and do not represent the actual size, features, specifications, fittings, and furnishings. 7. The developer reserves the right to make revisions / alterations, at its absolute discretion, without any liability whatsoever.

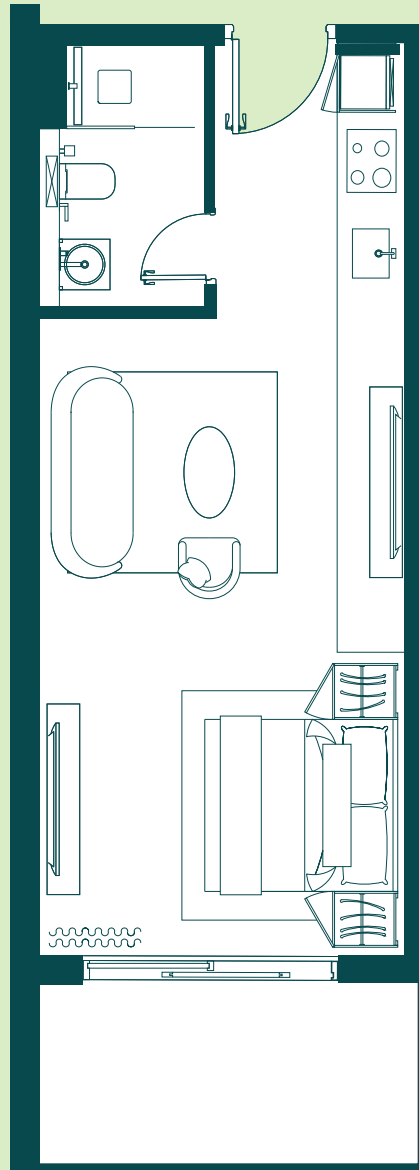

STUDIO

Unit 106

425 Sq.ft

DIMENSIONS

- ① **INTERNAL AREA:** 351.01 Sq.Ft. (32.61 Sq.M.)
- ② **BALCONY AREA:** 74.38 Sq.Ft. (6.91 Sq.M.)
- ③ **TOTAL AREA:** 425.39 Sq.Ft. (39.52 Sq.M.)

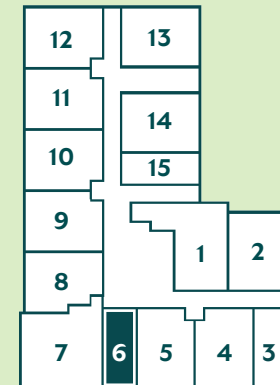

1. All dimensions are in imperial and metric, and measured to structural elements and exclude wall finishes and construction tolerances. 2. All materials, dimensions, and drawings are approximate only. 3. Information is subject to change without notice at developer's absolute discretion. 4. Actual area may vary from the stated area. 5. Drawings not to scale. 6. All images used are for illustrative purposes only and do not represent the actual size, features, specifications, fittings, and furnishings. 7. The developer reserves the right to make revisions / alterations, at its absolute discretion, without any liability whatsoever.

More information at:
rise-residences.com

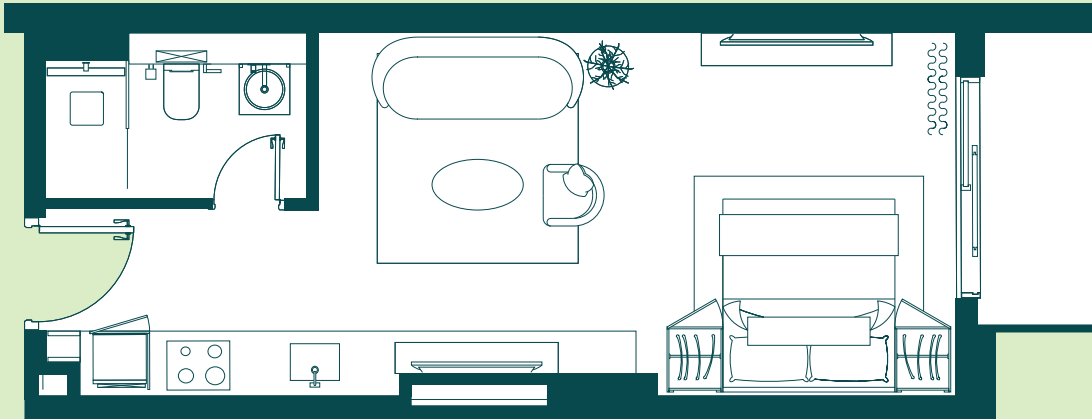

STUDIO

Unit 115

409 Sq.ft

DIMENSIONS

- ❶ **INTERNAL AREA:** 342.94 Sq.Ft. (31.86 Sq.M.)
- ❷ **BALCONY AREA:** 65.88 Sq.Ft. (6.12 Sq.M.)
- ❸ **TOTAL AREA:** 408.81 Sq.Ft. (37.98 Sq.M.)

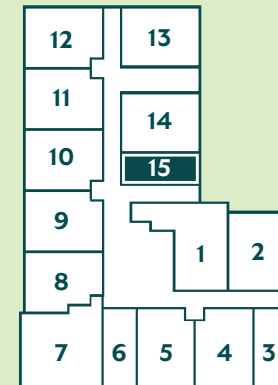

1. All dimensions are in imperial and metric, and measured to structural elements and exclude wall finishes and construction tolerances. 2. All materials, dimensions, and drawings are approximate only. 3. Information is subject to change without notice at developer's absolute discretion. 4. Actual area may vary from the stated area. 5. Drawings not to scale. 6. All images used are for illustrative purposes only and do not represent the actual size, features, specifications, fittings, and furnishings. 7. The developer reserves the right to make revisions / alterations, at its absolute discretion, without any liability whatsoever.

More information at:
rise-residences.com

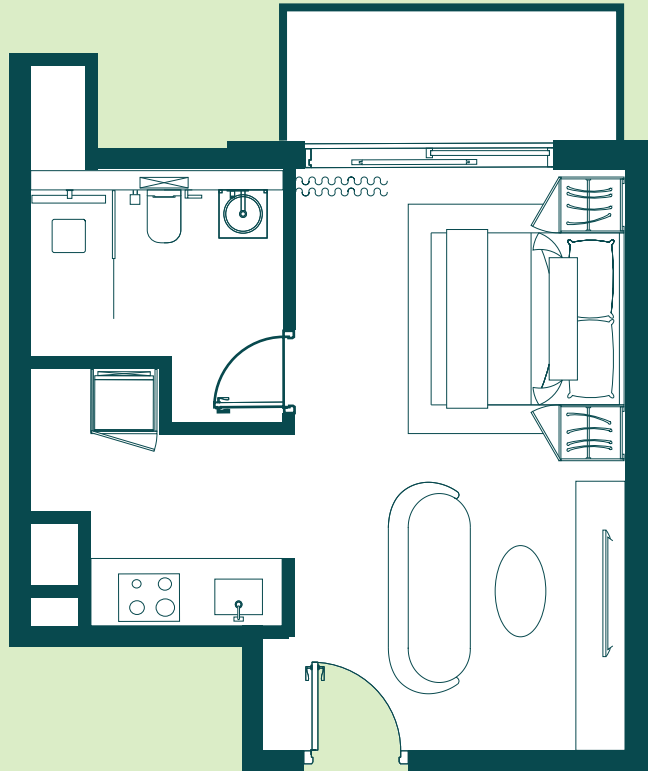

STUDIO

Unit 201/901

400 Sq.ft

DIMENSIONS

- ❶ **INTERNAL AREA:** 339.49 Sq.Ft. (31.54 Sq.M.)
- ❷ **BALCONY AREA:** 60.92 Sq.Ft. (5.66 Sq.M.)
- ❸ **TOTAL AREA:** 400.42 Sq.Ft. (37.20 Sq.M.)

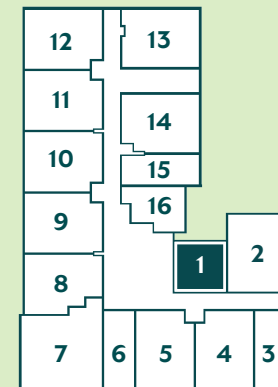

More information at:
rise-residences.com

1. All dimensions are in imperial and metric, and measured to structural elements and exclude wall finishes and construction tolerances. 2. All materials, dimensions, and drawings are approximate only. 3. Information is subject to change without notice at developer's absolute discretion. 4. Actual area may vary from the stated area. 5. Drawings not to scale. 6. All images used are for illustrative purposes only and do not represent the actual size, features, specifications, fittings, and furnishings. 7. The developer reserves the right to make revisions / alterations, at its absolute discretion, without any liability whatsoever.

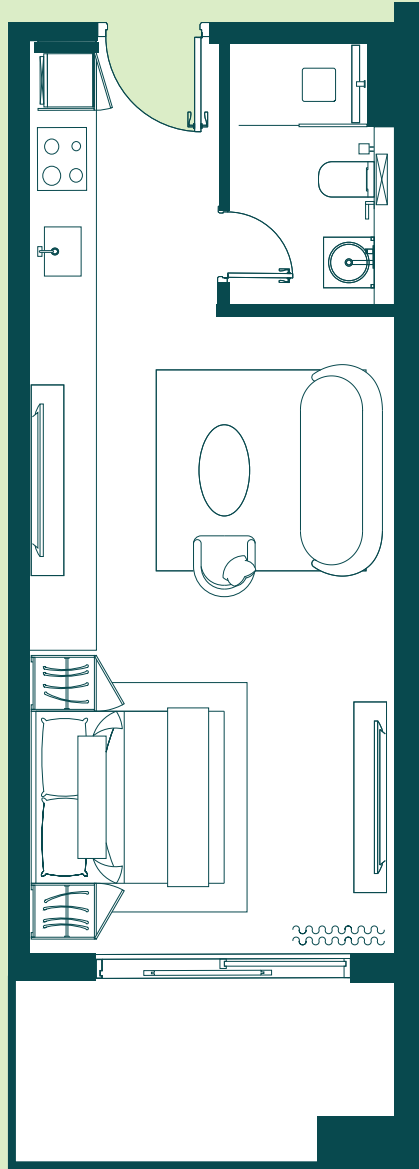

More information at:
rise-residences.com

STUDIO

Unit 203/903

432 Sq.ft

DIMENSIONS

- ① **INTERNAL AREA:** 351.66 Sq.Ft. (32.67 Sq.M.)
- ② **BALCONY AREA:** 79.87 Sq.Ft. (7.42 Sq.M.)
- ③ **TOTAL AREA:** 431.53 Sq.Ft. (40.09 Sq.M.)

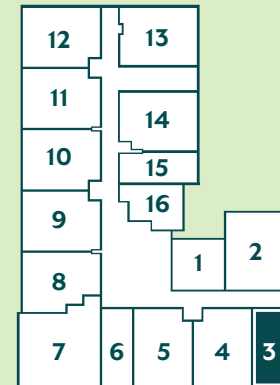

1. All dimensions are in imperial and metric, and measured to structural elements and exclude wall finishes and construction tolerances. 2. All materials, dimensions, and drawings are approximate only. 3. Information is subject to change without notice at developer's absolute discretion. 4. Actual area may vary from the stated area. 5. Drawings not to scale. 6. All images used are for illustrative purposes only and do not represent the actual size, features, specifications, fittings, and furnishings. 7. The developer reserves the right to make revisions / alterations, at its absolute discretion, without any liability whatsoever.

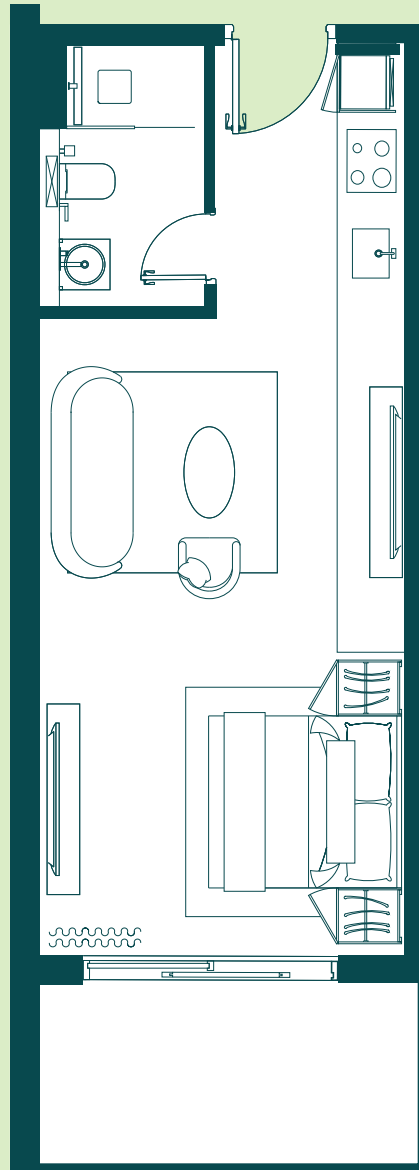

STUDIO

Unit 206/906

418 Sq.ft

DIMENSIONS

- ① **INTERNAL AREA:** 351.01 Sq.Ft. (32.61 Sq.M.)
- ② **BALCONY AREA:** 67.38 Sq.Ft. (6.26 Sq.M.)
- ③ **TOTAL AREA:** 418.39 Sq.Ft. (38.87 Sq.M.)

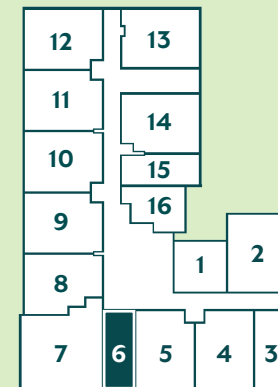

1. All dimensions are in imperial and metric, and measured to structural elements and exclude wall finishes and construction tolerances. 2. All materials, dimensions, and drawings are approximate only. 3. Information is subject to change without notice at developer's absolute discretion. 4. Actual area may vary from the stated area. 5. Drawings not to scale. 6. All images used are for illustrative purposes only and do not represent the actual size, features, specifications, fittings, and furnishings. 7. The developer reserves the right to make revisions / alterations, at its absolute discretion, without any liability whatsoever.

More information at:
rise-residences.com



STUDIO

Unit 215/915

405 Sq.ft

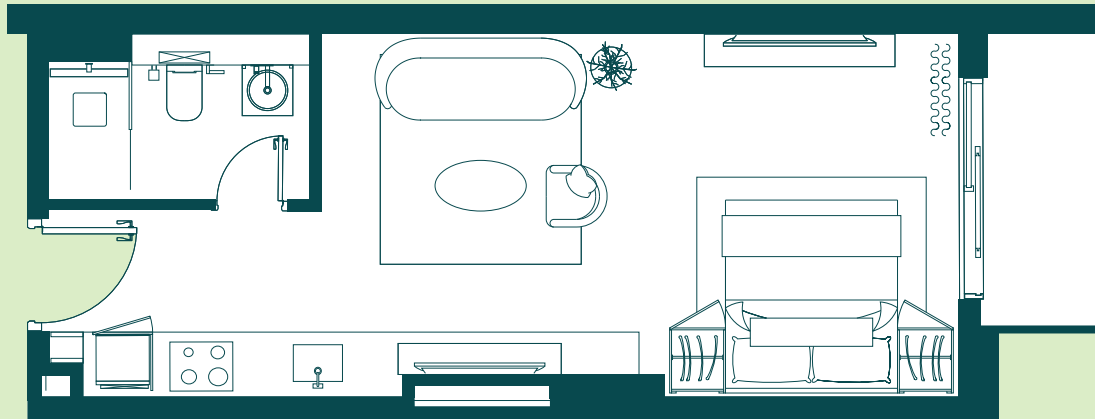

DIMENSIONS

- ❶ **INTERNAL AREA:** 342.94 Sq.Ft. (31.86 Sq.M.)
- ❷ **BALCONY AREA:** 62.22 Sq.Ft. (5.78 Sq.M.)
- ❸ **TOTAL AREA:** 405.15 Sq.Ft. (37.64 Sq.M.)

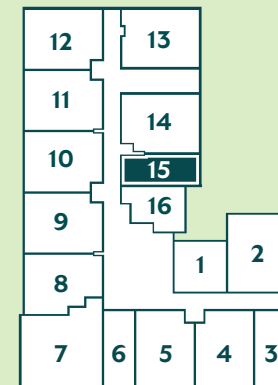

More information at:
rise-residences.com

1. All dimensions are in imperial and metric, and measured to structural elements and exclude wall finishes and construction tolerances. 2. All materials, dimensions, and drawings are approximate only. 3. Information is subject to change without notice at developer's absolute discretion. 4. Actual area may vary from the stated area. 5. Drawings not to scale. 6. All images used are for illustrative purposes only and do not represent the actual size, features, specifications, fittings, and furnishings. 7. The developer reserves the right to make revisions / alterations, at its absolute discretion, without any liability whatsoever.

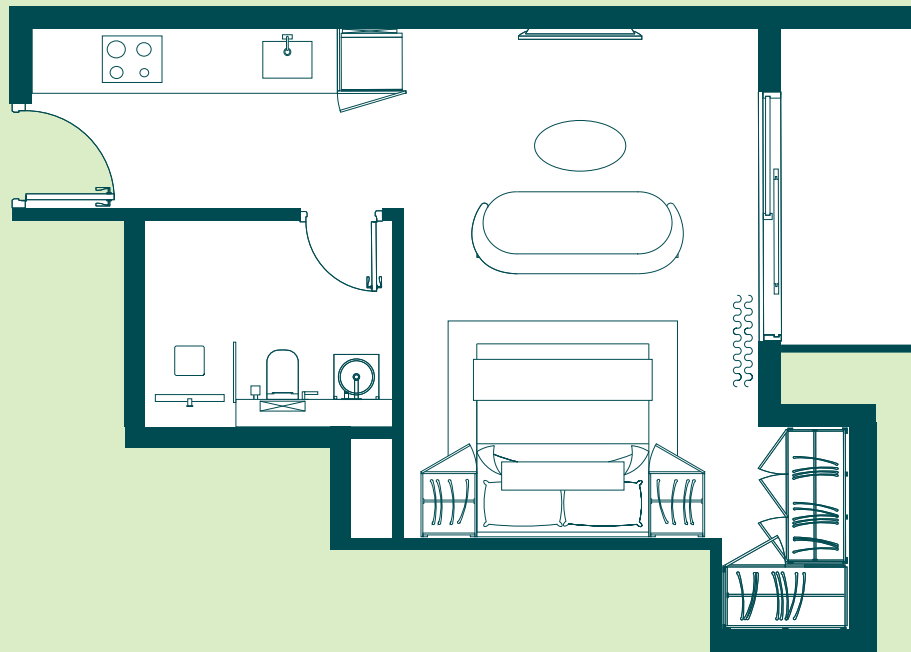

STUDIO

Unit 216/916

425 Sq.ft

DIMENSIONS

- ❶ **INTERNAL AREA:** 367.7 Sq.Ft. (34.16 Sq.M.)
- ❷ **BALCONY AREA:** 56.94 Sq.Ft. (5.29 Sq.M.)
- ❸ **TOTAL AREA:** 424.64 Sq.Ft. (39.45 Sq.M.)

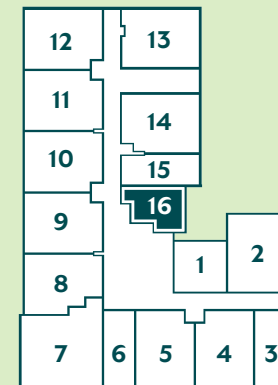

1. All dimensions are in imperial and metric, and measured to structural elements and exclude wall finishes and construction tolerances. 2. All materials, dimensions, and drawings are approximate only. 3. Information is subject to change without notice at developer's absolute discretion. 4. Actual area may vary from the stated area. 5. Drawings not to scale. 6. All images used are for illustrative purposes only and do not represent the actual size, features, specifications, fittings, and furnishings. 7. The developer reserves the right to make revisions / alterations, at its absolute discretion, without any liability whatsoever.

More information at:
rise-residences.com

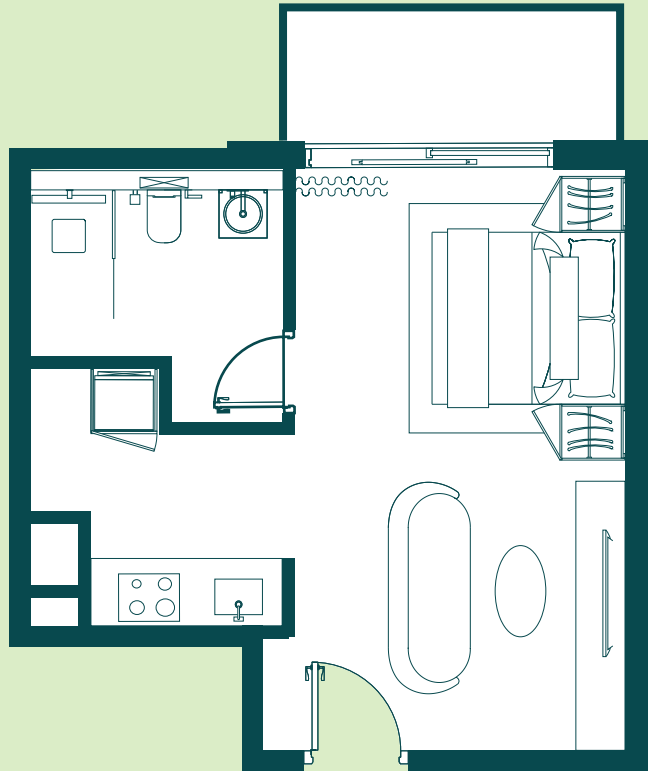

STUDIO

Unit 1001/1101 400 Sq.ft

DIMENSIONS

- ❶ **INTERNAL AREA:** 339.49 Sq.Ft. (31.54 Sq.M.)
- ❷ **BALCONY AREA:** 60.92 Sq.Ft. (5.66 Sq.M.)
- ❸ **TOTAL AREA:** 400.42 Sq.Ft. (37.20 Sq.M.)

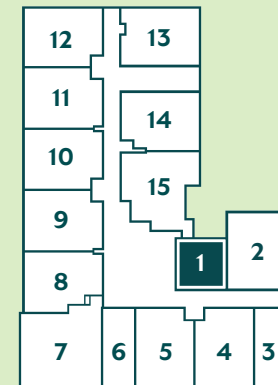

1. All dimensions are in imperial and metric, and measured to structural elements and exclude wall finishes and construction tolerances. 2. All materials, dimensions, and drawings are approximate only. 3. Information is subject to change without notice at developer's absolute discretion. 4. Actual area may vary from the stated area. 5. Drawings not to scale. 6. All images used are for illustrative purposes only and do not represent the actual size, features, specifications, fittings, and furnishings. 7. The developer reserves the right to make revisions / alterations, at its absolute discretion, without any liability whatsoever.

More information at:
rise-residences.com

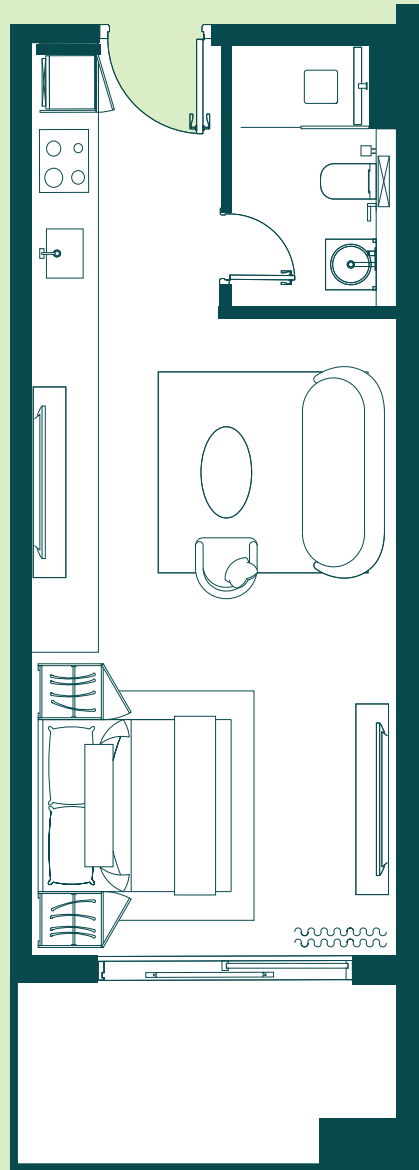

STUDIO

Unit 1003/1103

DIMENSIONS

- ① **INTERNAL AREA:** 351.66 Sq.Ft. (32.67 Sq.M.)
- ② **BALCONY AREA:** 79.87 Sq.Ft. (7.42 Sq.M.)
- ③ **TOTAL AREA:** 431.53 Sq.Ft. (40.09 Sq.M.)

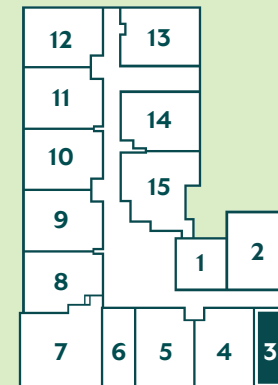

1. All dimensions are in imperial and metric, and measured to structural elements and exclude wall finishes and construction tolerances. 2. All materials, dimensions, and drawings are approximate only. 3. Information is subject to change without notice at developer's absolute discretion. 4. Actual area may vary from the stated area. 5. Drawings not to scale. 6. All images used are for illustrative purposes only and do not represent the actual size, features, specifications, fittings, and furnishings. 7. The developer reserves the right to make revisions / alterations, at its absolute discretion, without any liability whatsoever.

More information at:
rise-residences.com

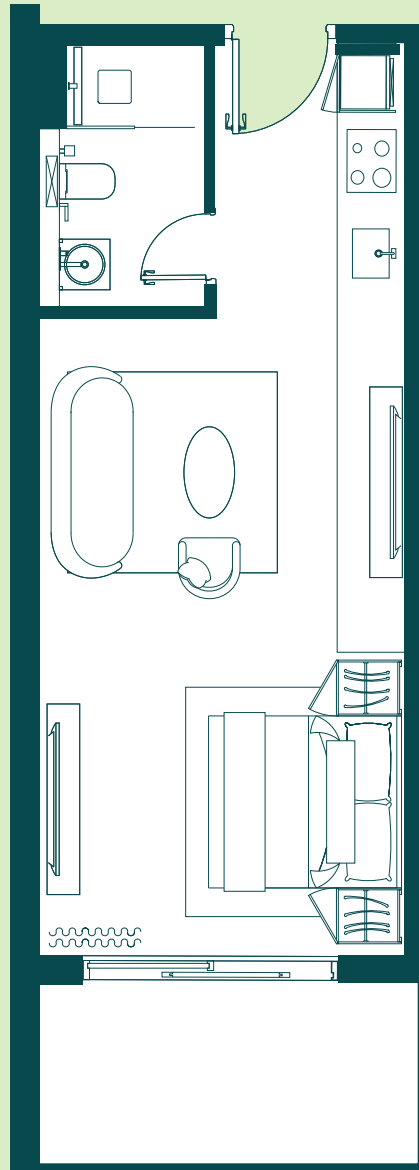

STUDIO

Unit 1006/1106 418 Sq.ft

DIMENSIONS

- ① **INTERNAL AREA:** 351.01 Sq.Ft. (32.61 Sq.M.)
- ② **BALCONY AREA:** 67.38 Sq.Ft. (6.26 Sq.M.)
- ③ **TOTAL AREA:** 418.39 Sq.Ft. (38.87 Sq.M.)

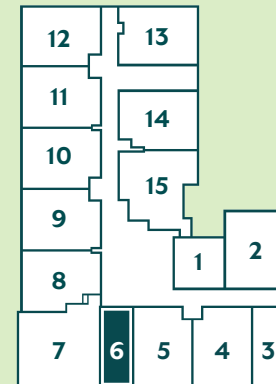

1. All dimensions are in imperial and metric, and measured to structural elements and exclude wall finishes and construction tolerances. 2. All materials, dimensions, and drawings are approximate only. 3. Information is subject to change without notice at developer's absolute discretion. 4. Actual area may vary from the stated area. 5. Drawings not to scale. 6. All images used are for illustrative purposes only and do not represent the actual size, features, specifications, fittings, and furnishings. 7. The developer reserves the right to make revisions / alterations, at its absolute discretion, without any liability whatsoever.

More information at:
rise-residences.com