

COASTAL
HAVEN



BY PRESTIGE HARBOUR



A New Era of Coastal Living

At Coastal Haven by Prestige Harbour, life unfolds like a coastal dream—breathtaking views of the Gulf, private pools that shimmer under the sun, and open spaces that embrace the sea breeze.



*Dubai Islands,
The Ultimate Island Address*

Coastal Haven by Prestige Harbour is located in Dubai Islands, a stunning collection of five interconnected islands spanning over 20 kilometers (about 12.43 mi) of Blue Flag-certified beaches, lush parks, and elite golf courses overlooking the Gulf. As part of Dubai's 2040 Urban Master Plan, this visionary destination offers a vacation-inspired lifestyle where turquoise waters, golden shores, and world-class amenities come together, making Coastal Haven by Prestige Harbour the epitome of coastal luxury.

Access to Dubai's Iconic Landmarks

Perfectly positioned in Dubai Islands, Coastal Haven by Prestige Harbour offers convenience and accessibility. With easy access to the city's iconic landmarks, world-class shopping destinations, and international airports, every destination is within reach.

**~30 MINS TO
PALM JUMEIRAH**



**~25 MINS TO
BURJ AL ARAB**



**~20 MINS TO
DUBAI MALL / BURJ KHALIFA**



**~3 MINS TO
DUBAI ISLANDS MALL**



**~15 MINS TO
AIRPORT**



Why Coastal Haven ?

Inspired by the timeless charm of island living, this enclave combines the elegance of old-world sophistication with modern luxury. Every detail, seen and unseen, speaks of effortless grace, creating an atmosphere where life is as extraordinary as the setting.

COASTAL
HAVEN



BY PRESTIGE HARBOUR

Unveil a Life of Prestige and Comfort

We have designed a lifestyle that is as effortless as it is elegant. Every detail, from the finest materials to the most innovative technologies, has been carefully considered to provide you with the ultimate in comfort and convenience.





Luxury by the Coast





PRESTIGE ONE
DEVELOPMENTS



A Dubai Islands Experience



Where Design meets Elegance and Serenity

Named for its prime location, every element of this residential project is designed to embrace its breathtaking wraparound views.

Building Configurations



ROOFTOP

FLOORS

PODIUM

GROUND

Building Elevations



The elevation of Coastal Haven by Prestige Harbour is a masterpiece of modern architecture, designed to complement the breathtaking surroundings of Dubai Islands.

Live in Waves

This project offers some of the most spectacular views in Dubai Islands including the unobstructed views of the harbour. From your residence, experience breathtaking panoramas stretching from east to west, where the beauty of the gulf and sky seamlessly blend.

Unmatched Experiences



Gulf View

Step onto your sunlit terraces overlooking turquoise waters of the Arabian Gulf, where the horizon feels infinite.



Resort Lifestyle

Framed by swaying palms and endless vistas, Coastal Haven by Prestige Harbour invites you into a resort-inspired enthralling world.



Pier Access

Whether you enjoy a peaceful boat ride or a leisurely stroll along the pier, this direct connection to the water enhances the serene atmosphere of your home.



Premium Amenities

Every amenity is thoughtfully crafted to elevate the coastal lifestyle. From private pools and entertainment venues to wellness and fitness hubs, each one is designed to provide an effortless, exclusive, and exceptional living experience.

Ground Floor Amenities

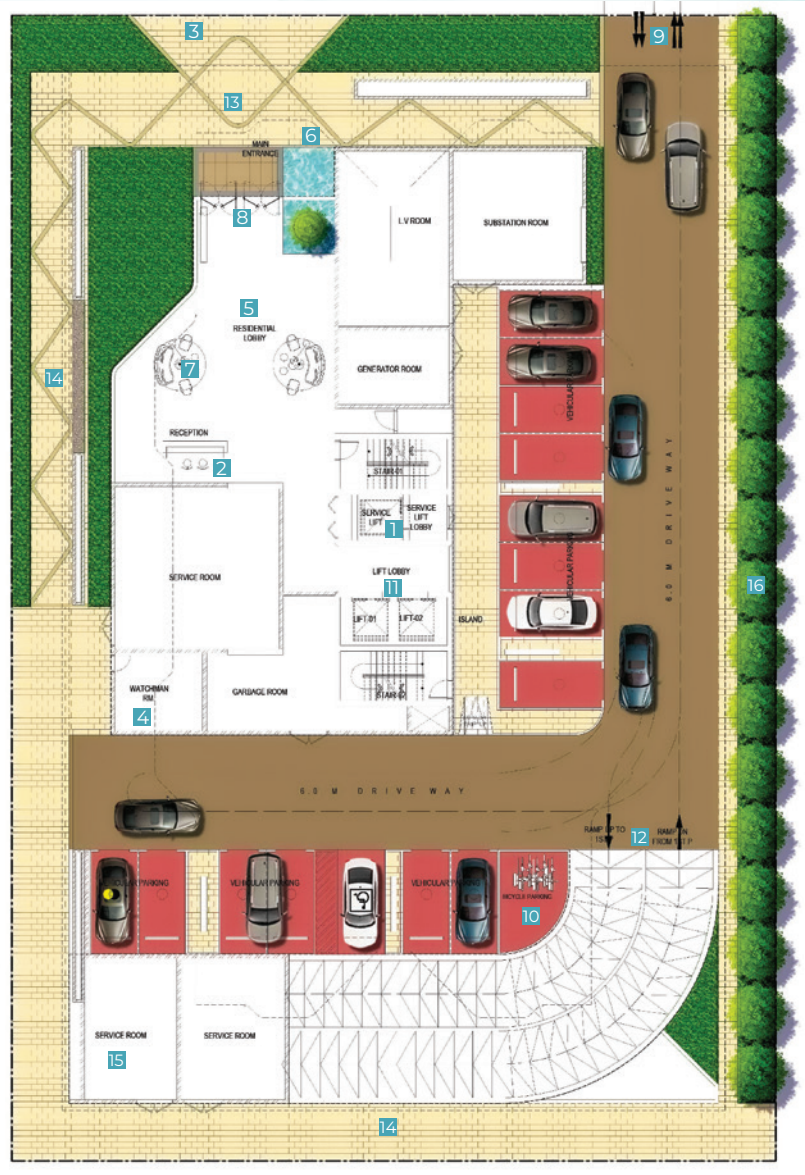

Concierge Assistance

Coastal Haven by Prestige Harbour offers a dedicated concierge service, providing unparalleled convenience and personalized assistance to its residents.



Promenade

Perfect for leisurely walks, morning jogs, or unwinding, the promenade is designed to complement your lifestyle.



Lobby Lounge

Designed to impress, this stunning space serves as both a grand welcome and a serene retreat.



Water Garden

Featuring flowing water features, lush greenery, and thoughtfully crafted landscapes, it provides a peaceful retreat for residents to relax and recharge.

- 1 SERVICE LIFT
- 2 CONCIERGE ASSISTANCE
- 3 PICK-UP/DROP-OFF
- 4 24/7 SECURITY

- 5 GRAND ENTRANCE LOBBY
- 6 WATER GARDEN
- 7 LOBBY LOUNGE
- 8 LOBBY ENTRANCE

- 9 VEHICLE ENTRANCE/EXIT
- 10 BIKE PARKING
- 11 LIFT LOBBY
- 12 ENTRANCE TO PARKING

- 13 PROMENADE
- 14 PEDESTRIAN PATH
- 15 SERVICE AREA
- 16 EDGE PLANTING

Podium Floor Amenities



- | | | | |
|----|---------------------------|----|------------------------|
| 1 | PRESTIGE OWNERS' LOUNGE | 5 | BASKETBALL COURT |
| 2 | THE CLUBHOUSE | 6 | PRESTIGE SPA |
| 3 | BADMINTON COURT | 7 | MALE CHANGING ROOM |
| 4 | TENNIS COURT | 8 | FEMALE CHANGING ROOM |
| 9 | LOCKER AREA | 13 | PRESTIGE WELLNESS AREA |
| 10 | PRESTIGE FITNESS CENTER | 14 | BILLIARDS TABLE |
| 11 | MALE TOILET | 15 | FOOSBALL TABLE |
| 12 | FEMALE TOILET | 16 | LIBRARY LOUNGE |
| 17 | LITTLE EXPLORERS' ZONE | 21 | JACUZZI |
| 18 | LIFT LOBBY | 22 | OUTDOOR GYM |
| 19 | INFINITY POOL | 23 | BBQ TERRACE |
| 20 | SUN DECK | 24 | OUTDOOR CINEMA |
| 25 | CHILDRENS' ADVENTURE PARK | 27 | MINIATURE GOLF COURSE |
| 26 | SPLASH ADVENTURE ZONE | 28 | WALKING PATH |





A Grand Lobby

Step into a space designed to greet you with understated elegance. Warm lighting, a refined reception, and comfortable seating create a welcoming ambiance for every visitor.



COASTAL HAVEN



BY PRESTIGE HARBOUR



Size Range & Unit Types

1-BEDROOM TYPE A **808 FT²**
1-BEDROOM TYPE B **808 FT²**
1-BEDROOM TYPE C **830 FT²**

2-BEDROOM TYPE A **1,202 FT²**
2-BEDROOM TYPE B **1,245 FT²**

3-BEDROOM TYPE A **1,659 FT²**
3-BEDROOM TYPE B **2,000 FT²**
3-BEDROOM TYPE C **2,031 FT²**
3-BEDROOM TYPE D **2,040 FT²**
3-BEDROOM TYPE E **1,922 FT²**

3-BEDROOM PENT. A **4,490 FT²**
3-BEDROOM PENT. B **4,492 FT²**









 **PRESTIGE ONE**
DEVELOPMENTS





Interiors

Inspired by the rhythm of the harbour, the interiors reflect a wave-like flow—serene yet lively, capturing the essence of coastal living. Natural tones and fluid designs come together to create spaces that feels both calming and dynamic.



1-Bedroom Apartments







2-Bedroom Apartments

TIGE ONE
DEVELOPMENTS





3-Bedroom Apartments





Penthouse











COASTAL
HAVEN



BY PRESTIGE HARBOUR

PRESTIGE ONE

Prestige One Developments stands tall as a global powerhouse in real estate development. Since our inception, we do more than build homes—we craft experiences where luxury intertwines with lifestyle. Having the customer, community, and design at the heart of its ethos, Prestige One Developments is a premier Dubai real estate developer dedicated to high-quality lifestyles and discerning buyers.

Please scan the code to
know about our
Terms and Conditions



prestigeone.ae

800 PRESTIGE



PRESTIGE ONE