

# MONTAGE

by KEYMAVENS

Exclusive Agency

ENGEL&VÖLKERS

## Introducing Montage—a curated living experience defined by thoughtful details and intentional design.

At Montage, it's not just about having a place to live—it's about how every detail combines to create something exceptional. With thoughtfully designed spaces and a focus on what truly matters, Montage offers a home where life flows seamlessly, proving it's greater than the sum of its parts.

### PROJECT DETAILS

- ◆ 1 & 2 bedroom freehold apartments
- ◆ Energy efficient tower designed to absorb maximum natural light
- ◆ Built-in closets & kitchens equipped with oven & stove
- ◆ Handover in Q4 2027

### UNIT MIX

APT.	UNITS	MIN. BUA	MAX. BUA	PRICE FROM
1-BR	158	632 sq.ft.	680 sq.ft.	AED 1.1M
2-BR	100	953 sq.ft.	996 sq.ft.	AED 1.6M

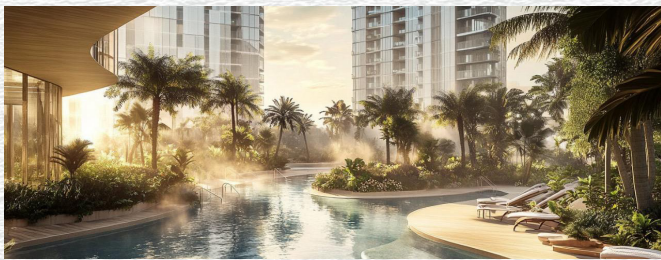

### AMENITIES

- ◆ Lagoon-style pool
- ◆ Cold plunge therapy
- ◆ Ice room
- ◆ 180-Degree relaxation room
- ◆ Red-light therapy
- ◆ Himalayan salt room
- ◆ Modern fitness centre
- ◆ Virtual reality room
- ◆ Oxygen room
- ◆ Portola Resort



Golden Mile Galleria 2, Mezzanine,  
Office 21, Palm Jumeirah, Dubai  
P.O.Box 17722 | ORN: 16081

+971 52 932 8933 | 800 3555  
dubai@engelvoelkers.com  
www.engelvoelkers.com/ae/en



### LOCATION

Al Jaddaf is a historically rich, high-growth waterfront community on Dubai Creek. With excellent transport links, including a metro station, upcoming train station and a growing real estate market, it is an attractive option for investors and residents alike.

### WALK TO

- 5 mins Al Jaddaf Metro Station
- 7 mins Al Jaddaf Waterfront Park

### DRIVE TO

- 5 mins Dubai Intl. Airport
- 10 mins Downtown Dubai



### ABOUT KEYMAVENS

KeyMavens is a Dubai-based boutique luxury developer conceptualizing, crafting, and managing high-end real estate with a hyper-focus on human experiences. We design with a purpose: to elevate well-being, enrich lives, and create unmatched value. Our projects combine quality and artistry, delivering spaces that resonate with the people who live in them.

### PAYMENT PLAN

- 10% On Booking Downpayment
- 10% 30 Days from Booking 2nd Instalment
- 5% Every 4 months
- 50% On Handover Expected Q4 2027

### ESCROW ACCOUNT

- Bank Name: Arab Bank For Investment And Foreign Trade
- Branch: Sheikh Zayed Road
- Account Name: MONTAGE COLLECTION
- Account No.: 994000057378
- Swift Code: ABINAEAXXX
- IBAN No.: AE250080000994000057378