



EXCLUSIVE APARTMENT PROJECT IN PHUKET

General characteristics of the project | Infrastructure | Location advantages | Available apartments



📍 KATA BEACH, PHUKET

Exclusive apartment project

5.030.000 - 26.560.000 THB

Apartments price

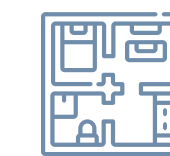

36.2 - 152.39 sq.m

Area



Q1 2026

Handover

The third phase of the Wekata condominium 300 meters from Kata Beach.

The main feature of the project is the eco-friendliness and spaciousness. Private swimming pools in some units.

Fixed income 7% p.a. for 5 years (with 100% payment) is applicable for flats up to 47 sq.m. Accrues 30 days after full payment. Personal use: 15 / 30 days high season / low season.

Rental Pool program for those who want to combine an investment with their own accommodation: 40% of the income to the investor, 60% - to the management company (all expenses are on the share of MC). Projected profit: **5-10%**. The profit is after the handover.

Installment until the end of construction with 35% down payment on low season investment. Deposit 100,000 THB.





Kata area. Phuket

Walking distance to a magnificent beach, highly developed tourist infrastructure and proximity to other popular areas of Phuket (Karon, Chalong) distinguish Wekata 3. The previous phases of the complex are already accepting tourists and apartment owners





Peculiarities and advantages of the complex

Unusual architecture



The conception of a complex as close to nature as possible that integrates the smoothness of the lines into the classic angular development of the tourist area.

Panoramic pools



The adjacent infrastructure limited in height makes it possible to realize open spaces on the roofs of the buildings.

In the third phase, popular bars and pools with panoramic views are also implemented.





Peculiarities and advantages of the complex



Spacious gym

With a partial sea view it has been designed with the preferences of both: simple connoisseurs of a healthy lifestyle and more demanding athletes.



Play area and kids club

Guests with children have always been one of the most important landmarks for the developer. The complex provides a cozy play area and a kids club.





Peculiarities and advantages of the complex



Premium Service

The cafes and restaurants arrangement has spacious halls with high ceilings and panoramic windows. Maximum service with no need to leave the complex



Hotel management

The hotel will be managed by Hotels9. The class of the hotel is 4 stars but only 5-minute walk to Kata Beach separates it from the highest category.





Exclusive premium design



The interior design of apartments in the project is developing at the peak of its price range. In fact, it offers **a completely premium class within an affordable budget.**

Due to the optimization of space 2 bedroom apartments offer comparable comfort of a villa and apartments equipped with **a private pool** even surpass it in comfort.

Fully functional kitchens, living area and isolated rooms will be sufficiently convenient for **both family vacations and long-term rentals** or permanent stay of the apartment owners.





Exclusive premium design



Particular emphasis is put on the **one bedroom apartments**. A small family or just a couple of travelers accommodation is **radically surpasses the ordinary hotel room in comfort** .

Studio apartments comparatively small and have become an absolute classic of Phuket are also included in the pool of apartments. Due to well-developed ergonomic solutions apartments of this type have enough space despite their modest size.

The common balance of the apartment types and modern furnishing solutions **are the competitive advantage of the project in the Kata area of Phuket**. In the current circumstances the complex can be called the only one of its kind in this location in Phuket.

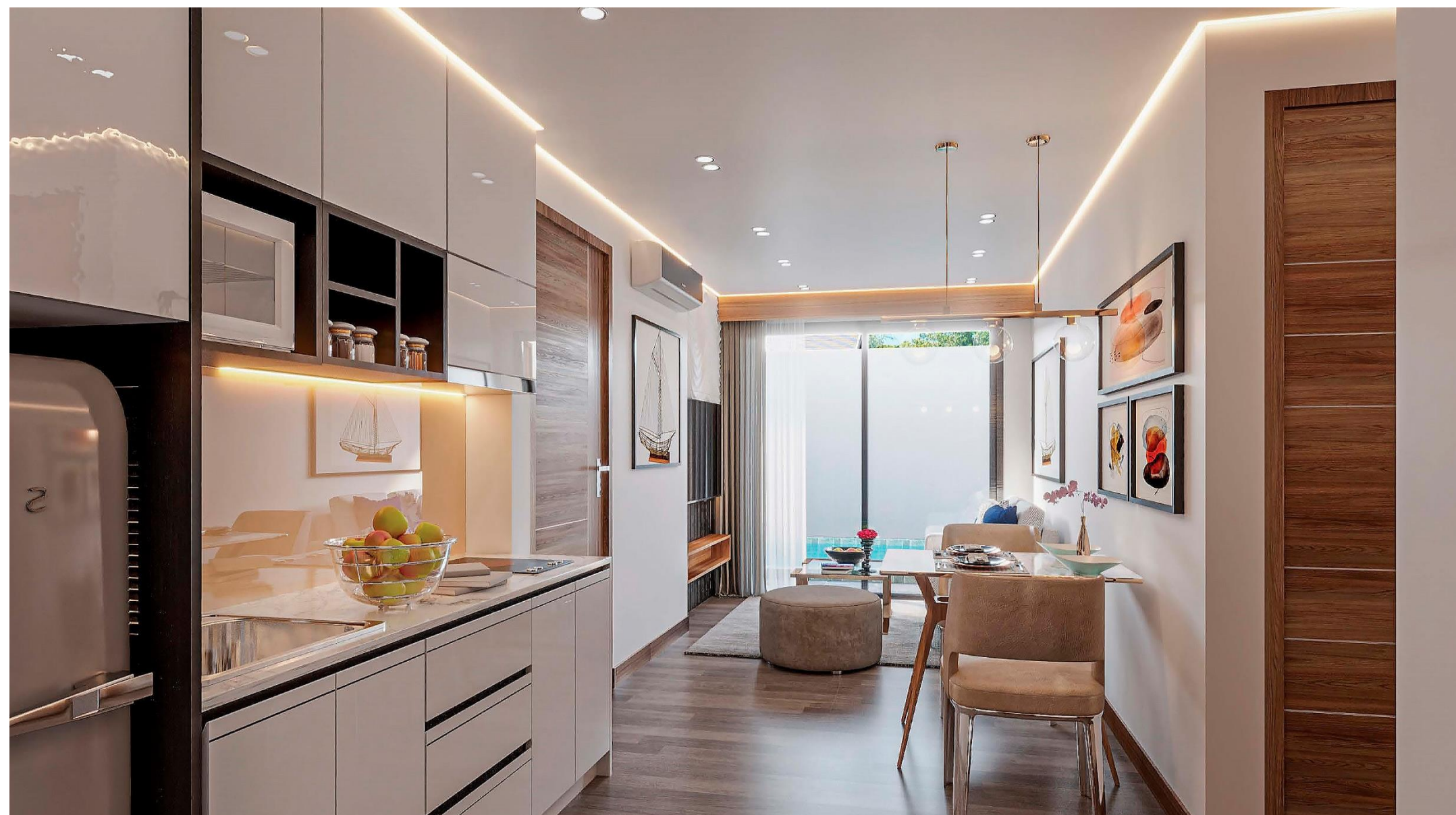

Floor plan

■ Exclusive apartment project in Phuket





3

FLOOR



4

FLOOR



5 FLOOR



6 FLOOR

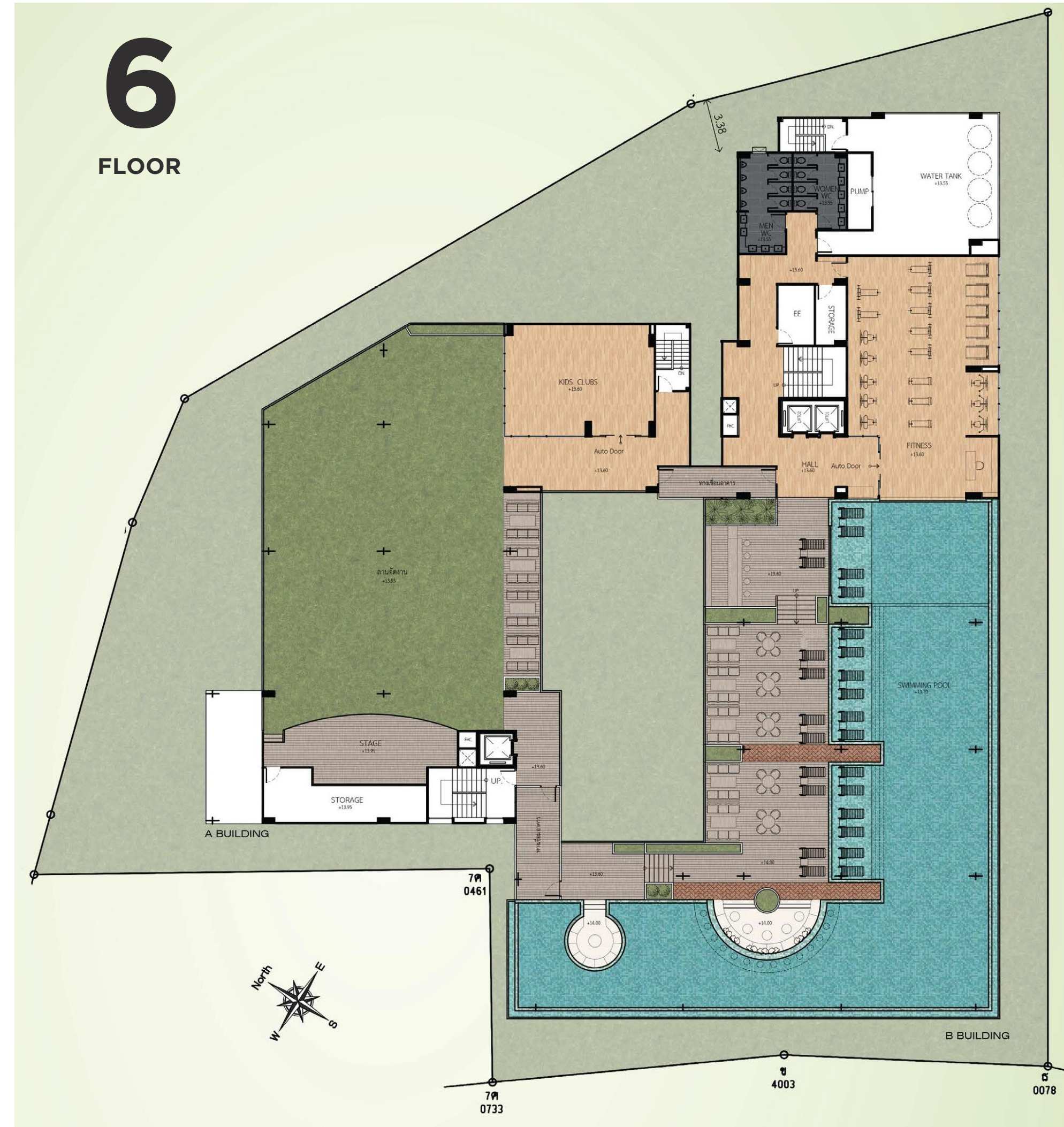

Available layouts

- Exclusive apartment project in Phuket



Apartment Type E

5.030.000 THB

Starting price

36.2 sq.m

Area



Studio

Bedroom



1

Bathroom



Apartment Type G

6.814.500 THB

Starting price

47 sq.m

Area



1
Bathroom



1
Bathroom



15



Apartment Type D

9.300.000 THB

Starting price

64.2 sq.m

Area



1
Bedroom



1
Bathroom



Apartment Type C

7.660.000 THB

Starting price

52.9 sq.m

Area

2
Bedroom

2
Bathroom



Apartment Type B

15.140.000 THB

Starting price

87.1 sq.m

Area

 **2**
Bedroom

 **2**
Bathroom

 Private
Pool



18



Apartment Type A

24.730.000 THB

Starting price

142.3 sq.m

Area

 **2**
Bedroom

 **2**
Bathroom

 Private
Pool



Apartment Type F

SOLD OUT

4.600.000 THB

Starting price

33 sq.m

Area



Studio

Bedroom



1

Bathroom



20



Apartment Type K

SOLD OUT

5.800.000 THB

Starting price

37 sq.m

Area

 **1**
Bedroom

 **1**
Bathroom



Apartment Type J

SOLD OUT

5.381.000 THB

Starting price

43 sq.m

Area



1
Bedroom



1
Bathroom



22



Apartment Type L

SOLD OUT

4.609.500 THB

Starting price

31 sq.m

Area



Studio

Bedroom



1

Bathroom



Apartment Type I

SOLD OUT

5.338.000 THB

Starting price

42.7 sq.m

Area



1
Bedroom



1
Bathroom



24



Apartment Type H

SOLD OUT

6.641.000 THB

Starting price

53.3 sq.m

Area



1
Bedroom



1
Bathroom



25









Additional expenses & payment schedule

■ Exclusive apartment project in Phuket



Additional expenses



 60 THB SQ.M Service per month Annual payment	 500 THB SQ.M Capital Improvement Fund One-time payment	 INCLUDED IN PRICE Furniture Package
 1.25 % Leasehold registration One-time payment	 2.25 % Freehold registration Registration fee - 350.000 THB One-time payment	 5.000 THB Installation of water and electricity meters One-time payment

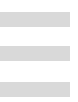

Payment schedule

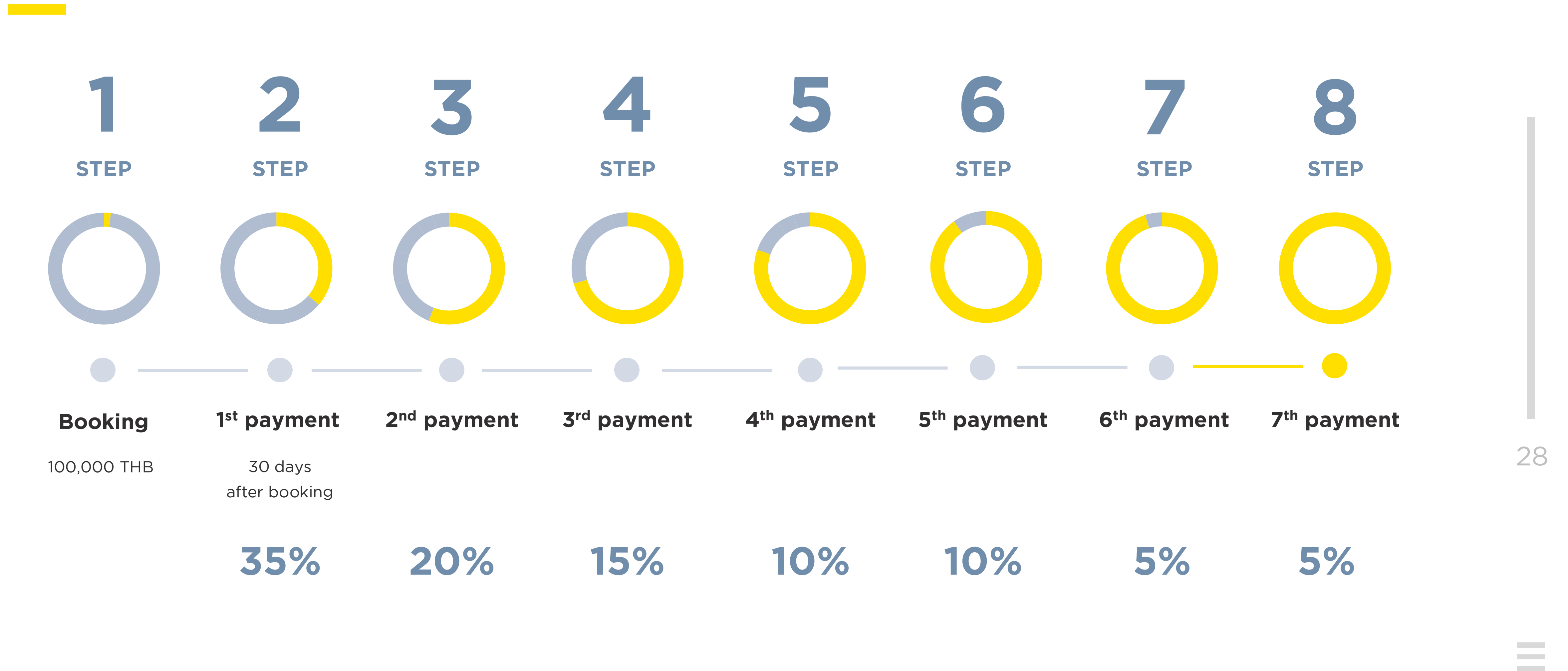



EXCLUSIVE APARTMENT PROJECT IN PHUKET
