



SOBHA ONE

SOBHA
REALTY



ONE
THE JOURNEY BEGINS

ONE that brings you
closer to nature



A place where you can take
one day at a time



ONE

BE ONESELF

It's one of a kind, like you



ONE

BEST THAT LIFE HAS TO OFFER

One where the world is
close yet far away

THE POWER OF ONE



*When imagination and vision
come together Life meets style.*

City and nature hum together,
Work & play find a balance and become One

ONE WAY: YOUR WAY

The best places are hidden in plain sight

Near the vital Ras Al Khor Road, Sobha One is a little world tucked away. Look to the north at the calming waters of the Creek as they look back. Further north in the skyline with panoramic views of The Burj Khalifa, Creek Tower to the Northeast and Downtown to the West.



ARRIVE & DEPART WITH GRACE

Sobha One is right near two new interchanges on Ras Al Khor Road. So, getting home has never been faster. With exits in both the West and East, a new planned metro line behind Sobha One, soar where you need to be on your terms.





LIVING BY THE WATER

Imagine waking up each morning next to serene water. The sun glints off the water, casting a sparkling path across the ripples. A light breeze blows, rustling the leaves of the nearby trees.

It's yours to stroll down the pathway or sit peacefully watching the calm waters. Go on, spend lazy weekends lounging near the water, reading, and soaking up the sun.



ONE POINT OF VIEW: YOURS

With a canvas spread over 1.5 million square feet, its breathtaking views as far as your eye can see. Look around to views of Golf Course, calm water, iconic Burj Khalifa & Downtown. Every glance sets a different mood.



ONE

SPACE

Sobha One spreads its tapestry over five interlinked towers. Rising from 30 stories tall and hitting a crescendo of 65 stories, it's one note after another that sings in chorus with the skyline

With 1 to 4 bedroom apartments & 2 to 4 bedroom Duplex, it's a world of its own.



ONE FOR ALL
ALL FOR ONE



*Life is too short to settle for anything less than
the best. At Sobha One, luxury living is a
natural choice.*

TEE OFF IN STYLE

The first of its kind in Dubai, a world class Pitch and Putt golf course featuring 18 holes of golf, each meticulously designed.

It is the perfect way to unwind after a long day at work. After all, there's nothing like sinking a long putt on a sun-drenched fairway. The clubhouse is appointed with upscale amenities and a patio overlooking the greens.



DINE BY THE WATERS

The food & beverage esplanade that borders the calm waters is also a feast for the palate to suit every taste and time.

Spread over almost half a kilometer, it offers fine restaurants for an intimate dinner, quick catch-up over a cup of coffee, or a power lunch.



SKY GARDEN

Rise high above and look at the stars. Soak in the stunning views of the city. Catch the sun rays when they rise and set. Do it all from the magnificent panoramic sky terrace in each tower



COURTYARD FOR THE SENSES



All the 5 Towers at Sobha One have interconnected four themed courtyards. As private outdoor retreats, these lush, landscaped spaces add to the overall aesthetic.

RELAX

In a fast-paced world, finding ways to relax is more important than ever. Take a leisurely stroll through the tree avenues, do yoga on the group decks, or stroll in the gardens. And when you need to refuel, enjoy a meal at the BBQ & dining areas or catch a movie under the stars on our cinema screen. There is something for everyone





REMEMBER

The family courtyard is a great way to spend quality time together. You can pack a picnic lunch and enjoy the beautiful weather. Or spending a day cooling off in the water, splashing with the little ones. So, come on down and make memories with your loved ones!





RECHARGE

We believe that fitness should be fun! That's why we've created a unique courtyard that combines the best of gyms with exciting new indoor and outdoor features from static bikes, treadmills, circuit training areas and battle ropes. So sweat it out and be the best version of yourself.





REFRESH

This themed courtyard is the way to do just that after a long day. Step into the pool area, and the stress of daily life melts away. Feel your muscles loosening and your mind clearing as you swim laps. Close your eyes and let the warm sun wash over you, lulling you into a state of relaxation.





SOBHA ONE



FLEXIBLE PAYMENT PLAN

60%

During Construction

40%

On Completion



Grand 1 to 4 Bedroom apartments

ONE

awaits you...

LOCATION MAP



- | | | | | |
|--|---|--|---|---|
| 
RAS AL KHOR
WILDLIFE SANCTUARY
05 MINUTES | 
MEYDAN
RACE COURSE
10 MINUTES | 
SOBHA HARTLAND &
2 INTERNATIONAL SCHOOLS
10 MINUTES | 
DUBAI INTERNATIONAL
AIRPORT
12 MINUTES | 
BUSINESS BAY
12 MINUTES |
| 
THE DUBAI MALL
15 MINUTES | 
BURJ KHALIFA &
DOWNTOWN DUBAI
15 MINUTES | 
DUBAI FRAME
15 MINUTES | 
DUBAI OPERA
15 MINUTES | 
PALM JUMEIRAH
25 MINUTES |

MASTER PLAN

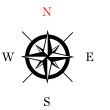

GROUND FLOOR

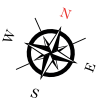
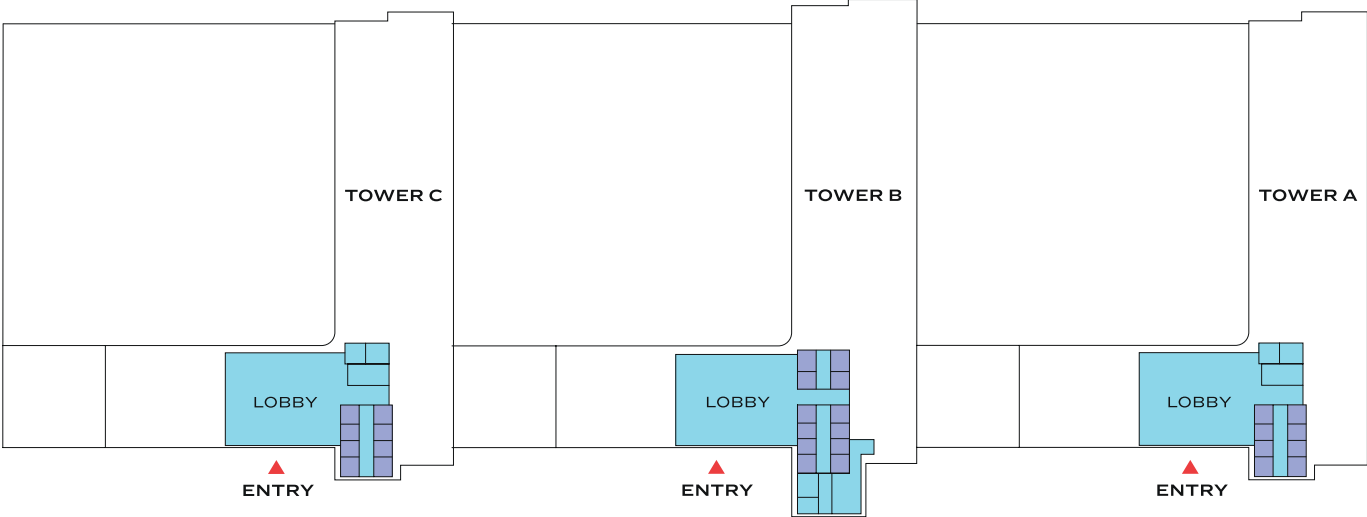

TOWER C
FLOOR PLAN LAYOUTS

FLOOR PLAN LAYOUT

TOWER C

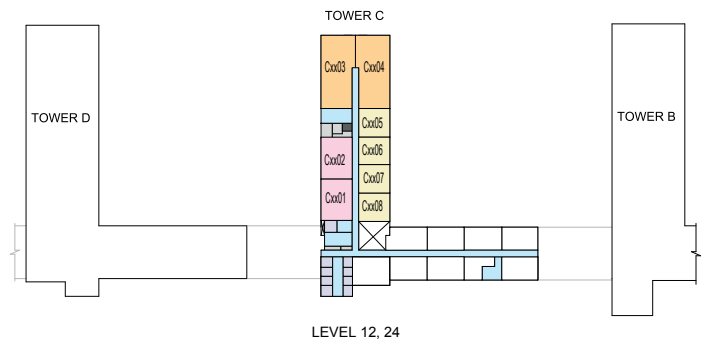
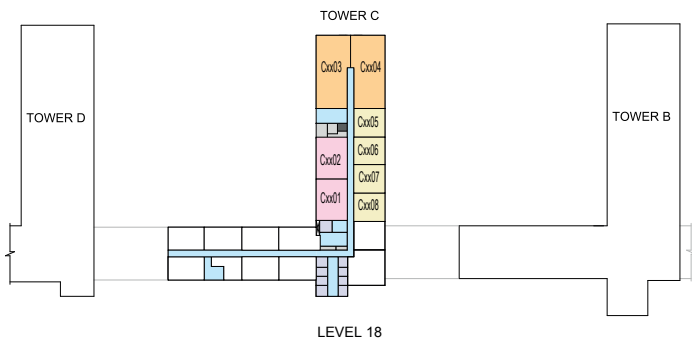
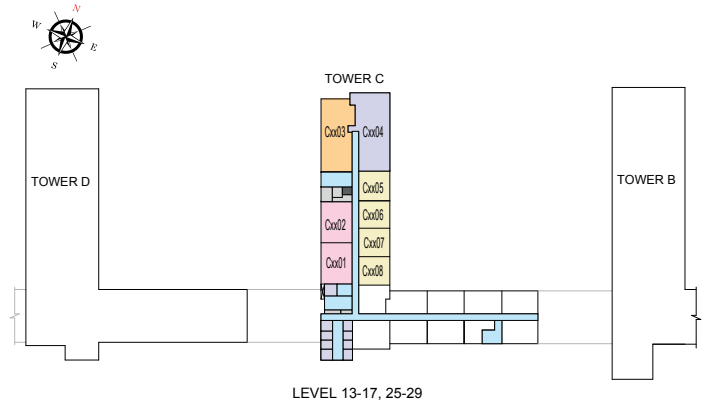
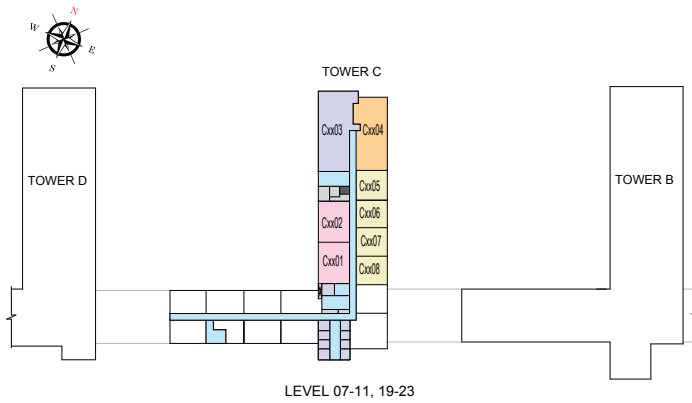

- 1 BED UNIT
- 3 BED UNIT
- LOBBIES, CORRIDORS & STAIRS
- LIFTS
- 2 BED UNIT
- SERVICES
- GARBAGE ROOM
- 4 BED UNIT

Disclaimer: 1. All dimensions are in metric, measured to wall finishes. 2. All materials, dimensions & drawings are approximate. 3. Information is subject to change without notice, at developer's absolute discretion. 4. Actual area may vary from the stated area. 5. Drawing are not to scale. 6. All images used are for illustrative purpose only and do not represent the actual size, features, specifications, fittings and furnishings. 7. The developer reserves the right to make revisions/ alterations, at its absolute discretion, without any liability whatsoever.

TOWER C
UNIT PLAN LAYOUTS

1 BEDROOM APARTMENT

TYPE A (with powder room + balcony)

TOTAL SALEABLE AREA

SUITE = 674.79 SQ.FT.
 BALCONY = 57.48 SQ.FT.
 TOTAL = 732.27 SQ.FT.

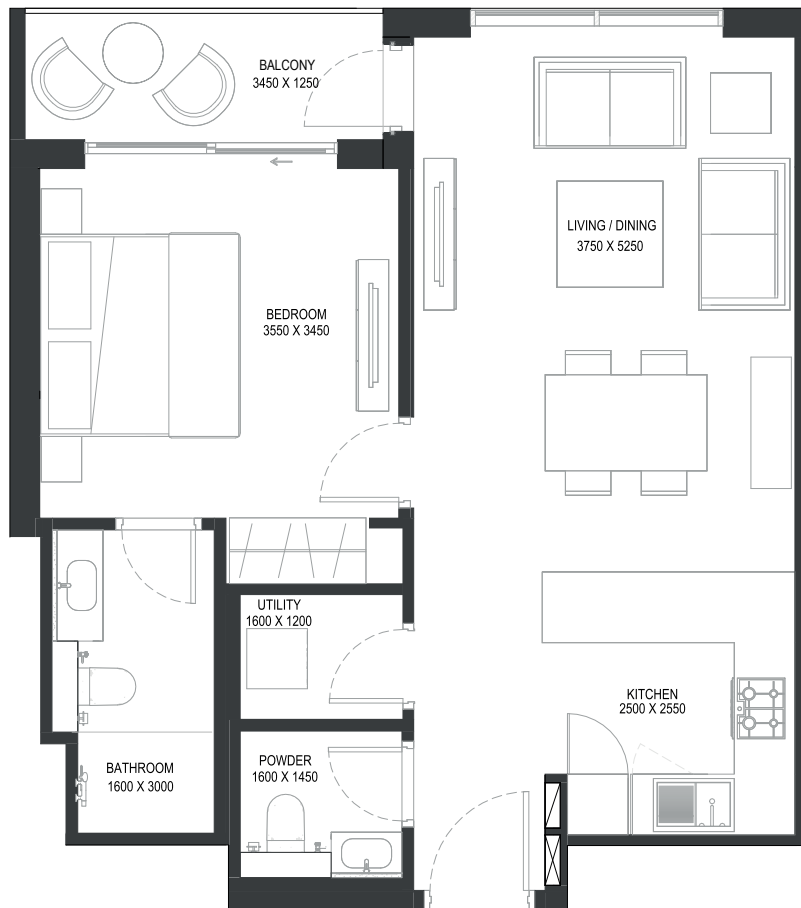
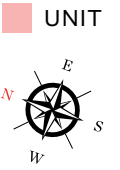
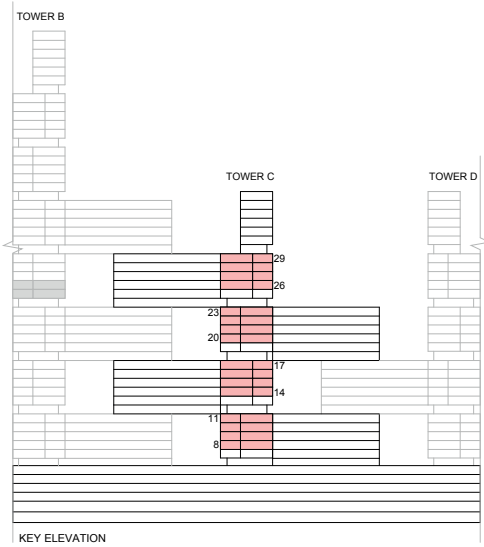

List of unit numbers with this unit plan:

VIEWS

Creek, Amenities

C805, C807, C905, C907, C1005, C1007, C1105, C1107

Creek, Golf Course, Amenities

C1405, C1407, C1505, C1507, C1605, C1607, C1705, C1707, C2005, C2007, C2105, C2107, C2205, C2207, C2305, C2307

Creek, Golf Course

C2605, C2607, C2705, C2707, C2805, C2807, C2905, C2907

Disclaimer: 1. All dimensions are in metric, measured to wall finishes. 2. All materials, dimensions & drawings are approximate. 3. Information is subject to change without notice, at developer's absolute discretion. 4. Actual area may vary from the stated area. 5. Drawing are not to scale. 6. All images used are for illustrative purpose only and do not represent the actual size, features, specifications, fittings and furnishings. 7. The developer reserves the right to make revisions/ alterations, at its absolute discretion, without any liability whatsoever.

1 BEDROOM APARTMENT

TYPE A (with powder room + balcony)

TOTAL SALEABLE AREA

SUITE = 674.79 SQ.FT.

BALCONY = 57.48 SQ.FT.

TOTAL = 732.27 SQ.FT.

 UNIT

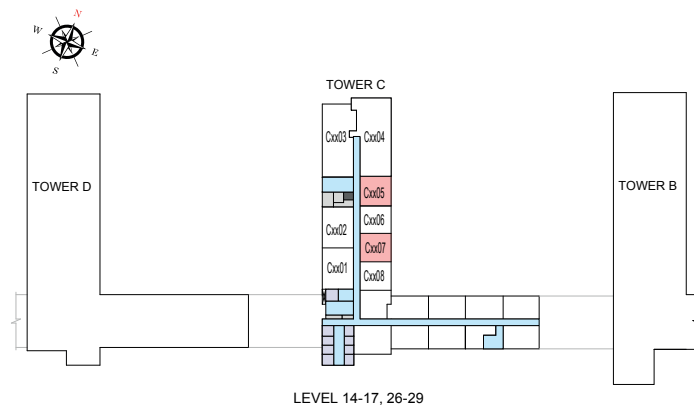
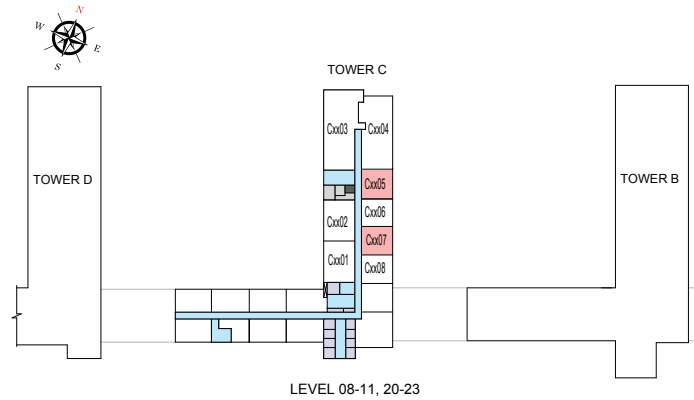

List of unit numbers with this unit plan:

VIEWS

Creek, Amenities

C805, C807, C905, C907, C1005, C1007, C1105, C1107

Creek, Golf Course, Amenities

C1405, C1407, C1505, C1507, C1605, C1607, C1705, C1707, C2005, C2007, C2105, C2107, C2205, C2207, C2305, C2307

Creek, Golf Course

C2605, C2607, C2705, C2707, C2805, C2807, C2905, C2907

Disclaimer: 1. All dimensions are in metric, measured to wall finishes. 2. All materials, dimensions & drawings are approximate. 3. Information is subject to change without notice, at developer's absolute discretion. 4. Actual area may vary from the stated area. 5. Drawing are not to scale. 6. All images used are for illustrative purpose only and do not represent the actual size, features, specifications, fittings and furnishings. 7. The developer reserves the right to make revisions/ alterations, at its absolute discretion, without any liability whatsoever.

1 BEDROOM APARTMENT

TYPE A (with powder room + balcony) VARIANT 1

TOTAL SALEABLE AREA

SUITE = 674.79 SQ.FT.

BALCONY = 57.48 SQ.FT.

TOTAL = 732.27 SQ.FT.

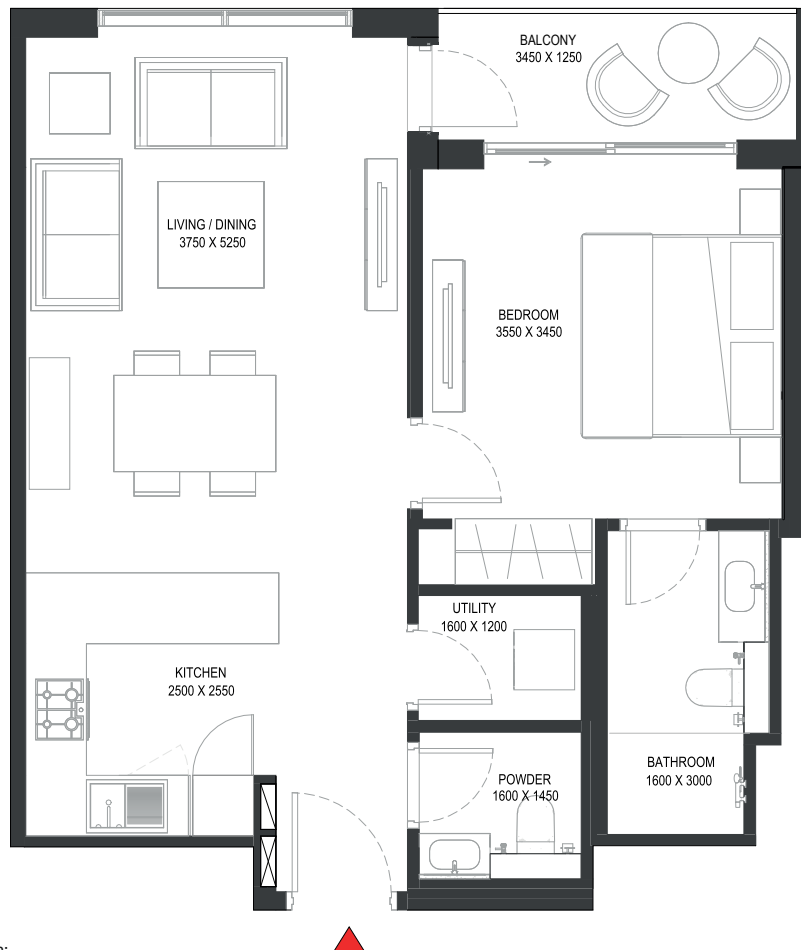
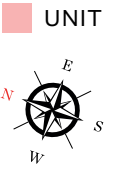
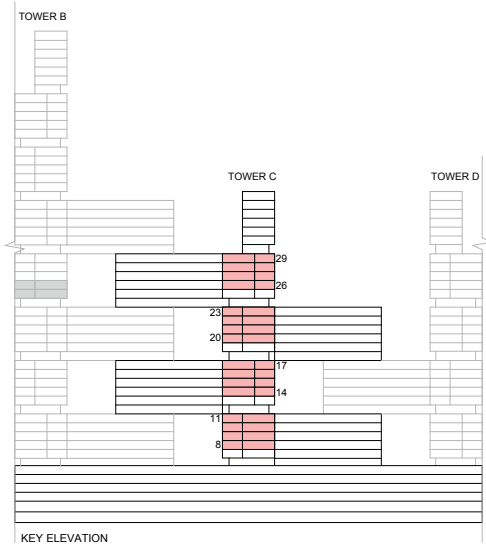

List of unit numbers with this unit plan:

VIEWS

Creek, Amenities

C806, C808, C906, C908, C1006, C1008, C1106, C1108

Creek, Golf Course, Amenities

C1406, C1408, C1506, C1508, C1606, C1608, C1706, C1708, C2006, C2008, C2106, C2108, C2206, C2208, C2306, C2308

Creek, Golf Course

C2606, C2608, C2706, C2708, C2806, C2808, C2906, C2908

Disclaimer: 1. All dimensions are in metric, measured to wall finishes. 2. All materials, dimensions & drawings are approximate. 3. Information is subject to change without notice, at developer's absolute discretion. 4. Actual area may vary from the stated area. 5. Drawing are not to scale. 6. All images used are for illustrative purpose only and do not represent the actual size, features, specifications, fittings and furnishings. 7. The developer reserves the right to make revisions/ alterations, at its absolute discretion, without any liability whatsoever.

1 BEDROOM APARTMENT

TYPE A (with powder room + balcony) VARIANT 1

TOTAL SALEABLE AREA

SUITE = 674.79 SQ.FT.

BALCONY = 57.48 SQ.FT.

TOTAL = 732.27 SQ.FT.

 UNIT

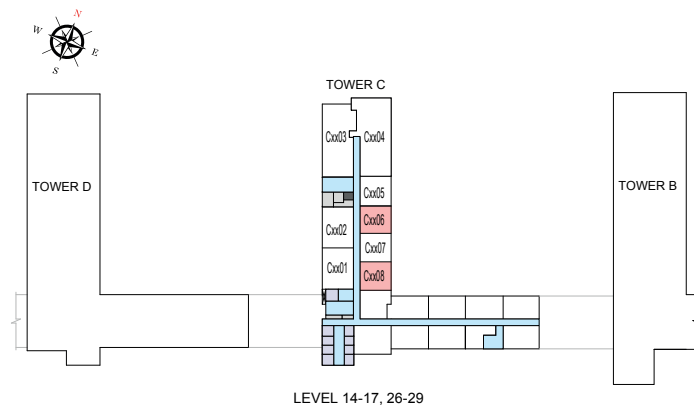
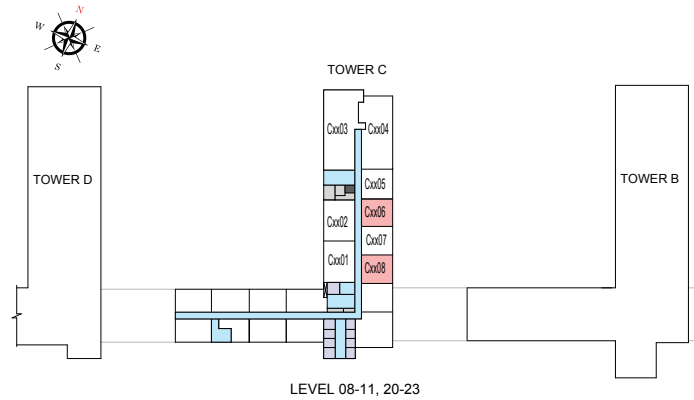

List of unit numbers with this unit plan:

VIEWS

Creek, Amenities

C806, C808, C906, C908, C1006, C1008, C1106, C1108

Creek, Golf Course, Amenities

C1406, C1408, C1506, C1508, C1606, C1608, C1706, C1708, C2006, C2008, C2106, C2108, C2206, C2208, C2306, C2308

Creek, Golf Course

C2606, C2608, C2706, C2708, C2806, C2808, C2906, C2908

Disclaimer: 1. All dimensions are in metric, measured to wall finishes. 2. All materials, dimensions & drawings are approximate. 3. Information is subject to change without notice, at developer's absolute discretion. 4. Actual area may vary from the stated area. 5. Drawing are not to scale. 6. All images used are for illustrative purpose only and do not represent the actual size, features, specifications, fittings and furnishings. 7. The developer reserves the right to make revisions/ alterations, at its absolute discretion, without any liability whatsoever.

1 BEDROOM APARTMENT

TYPE B (with powder room + yard)

TOTAL SALEABLE AREA

SUITE = 675.11 SQ.FT.

YARD = 132.72 SQ.FT.

TOTAL = 807.83 SQ.FT.

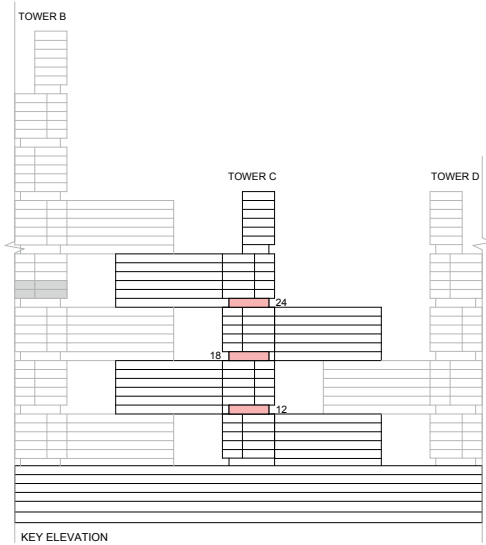

UNIT

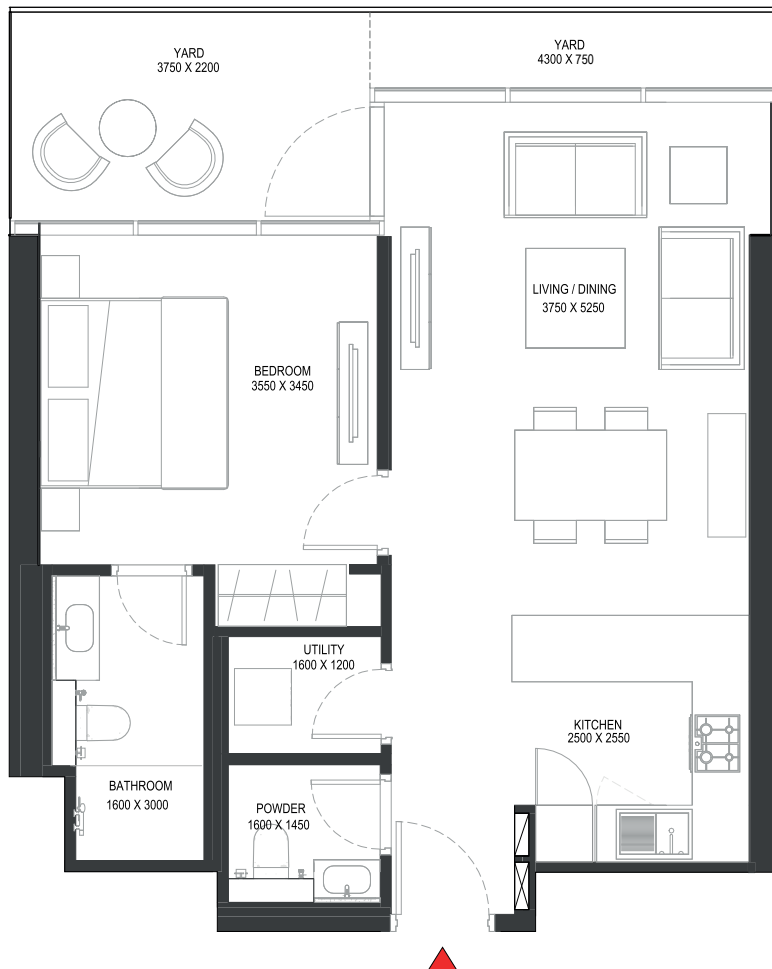
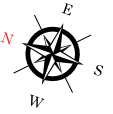

List of unit numbers with this unit plan:

VIEWS

Creek, Amenities

C1205, C1207

Creek, Golf Course, Amenities

C1805, C1807, C2405, C2407

Disclaimer: 1. All dimensions are in metric, measured to wall finishes. 2. All materials, dimensions & drawings are approximate. 3. Information is subject to change without notice, at developer's absolute discretion. 4. Actual area may vary from the stated area. 5. Drawing are not to scale. 6. All images used are for illustrative purpose only and do not represent the actual size, features, specifications, fittings and furnishings. 7. The developer reserves the right to make revisions/ alterations, at its absolute discretion, without any liability whatsoever.

1 BEDROOM APARTMENT

TYPE B (with powder room + yard)

TOTAL SALEABLE AREA

SUITE = 675.11 SQ.FT.

YARD = 132.72 SQ.FT.

TOTAL = 807.83 SQ.FT.

 UNIT

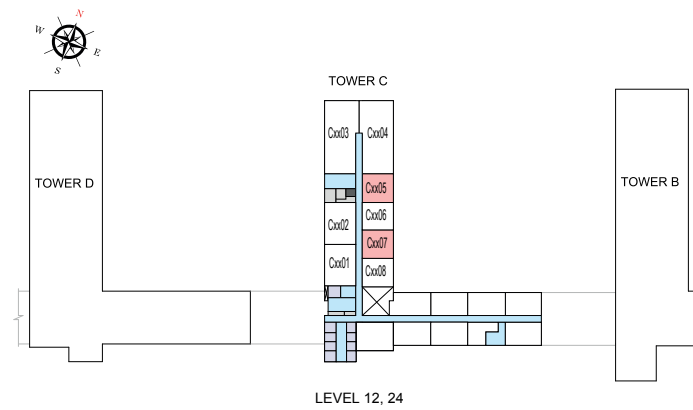
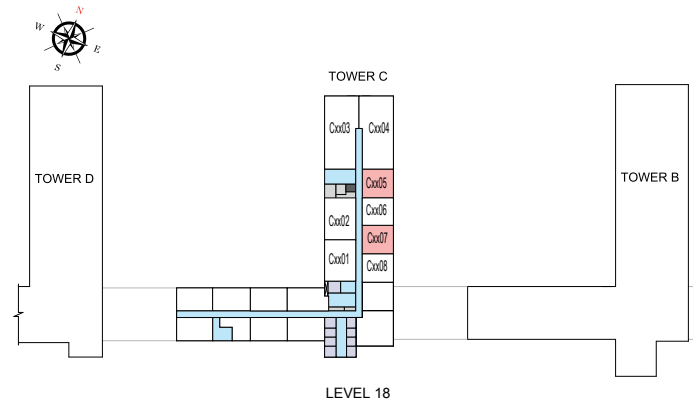

List of unit numbers with this unit plan:

VIEWS

Creek, Amenities

C1205, C1207

Creek, Golf Course, Amenities

C1805, C1807, C2405, C2407

Disclaimer: 1. All dimensions are in metric, measured to wall finishes. 2. All materials, dimensions & drawings are approximate. 3. Information is subject to change without notice, at developer's absolute discretion. 4. Actual area may vary from the stated area. 5. Drawing are not to scale. 6. All images used are for illustrative purpose only and do not represent the actual size, features, specifications, fittings and furnishings. 7. The developer reserves the right to make revisions/ alterations, at its absolute discretion, without any liability whatsoever.

1 BEDROOM APARTMENT

TYPE B (with powder room + balcony) VARIANT 1

TOTAL SALEABLE AREA

SUITE = 675.11 SQ.FT.

BALCONY = 132.72 SQ.FT.

TOTAL = 807.83 SQ.FT.

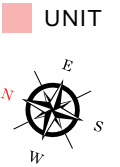
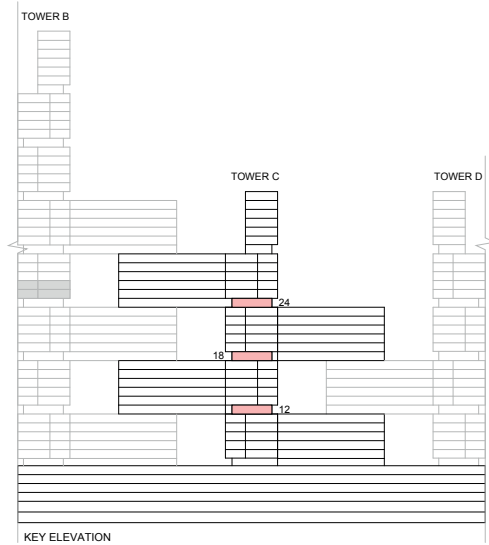

List of unit numbers with this unit plan:

VIEWS

Creek, Amenities

C1206, C1208

Creek, Golf Course, Amenities

C1806, C1808, C2406, C2408

Disclaimer: 1. All dimensions are in metric, measured to wall finishes. 2. All materials, dimensions & drawings are approximate. 3. Information is subject to change without notice, at developer's absolute discretion. 4. Actual area may vary from the stated area. 5. Drawing are not to scale. 6. All images used are for illustrative purpose only and do not represent the actual size, features, specifications, fittings and furnishings. 7. The developer reserves the right to make revisions/ alterations, at its absolute discretion, without any liability whatsoever.

1 BEDROOM APARTMENT

TYPE B (with powder room + balcony) VARIANT 1

TOTAL SALEABLE AREA

SUITE = 675.11 SQ.FT.

BALCONY = 132.72 SQ.FT.

TOTAL = 807.83 SQ.FT.

UNIT

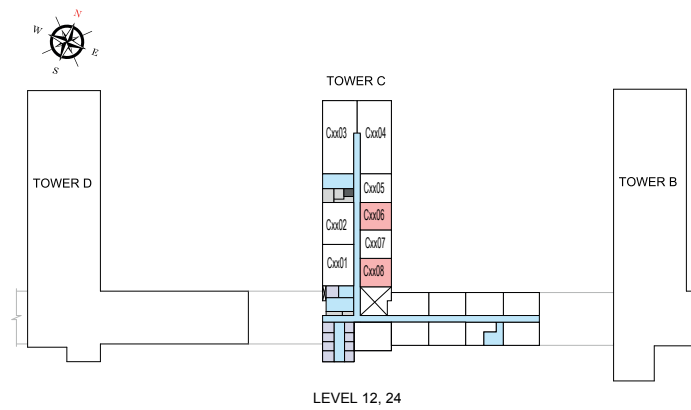
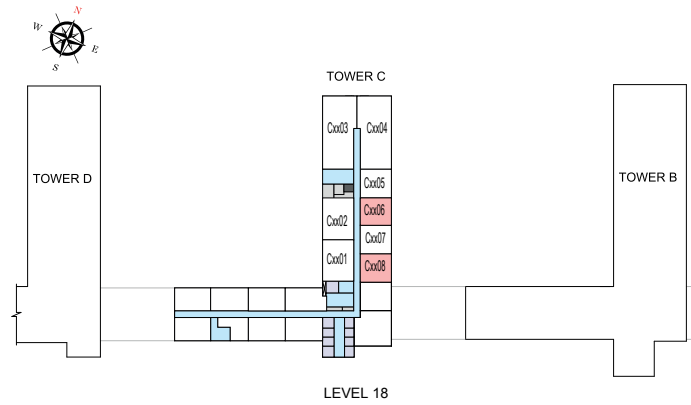

List of unit numbers with this unit plan:

VIEWS

Creek, Amenities

C1206, C1208

Creek, Golf Course, Amenities

C1806, C1808, C2406, C2408

Disclaimer: 1. All dimensions are in metric, measured to wall finishes. 2. All materials, dimensions & drawings are approximate. 3. Information is subject to change without notice, at developer's absolute discretion. 4. Actual area may vary from the stated area. 5. Drawing are not to scale. 6. All images used are for illustrative purpose only and do not represent the actual size, features, specifications, fittings and furnishings. 7. The developer reserves the right to make revisions/ alterations, at its absolute discretion, without any liability whatsoever.

1 BEDROOM APARTMENT

TYPE C (with powder room + yard)

TOTAL SALEABLE AREA

SUITE = 674.79 SQ.FT.

YARD = 133.04 SQ.FT.

TOTAL = 807.83 SQ.FT.

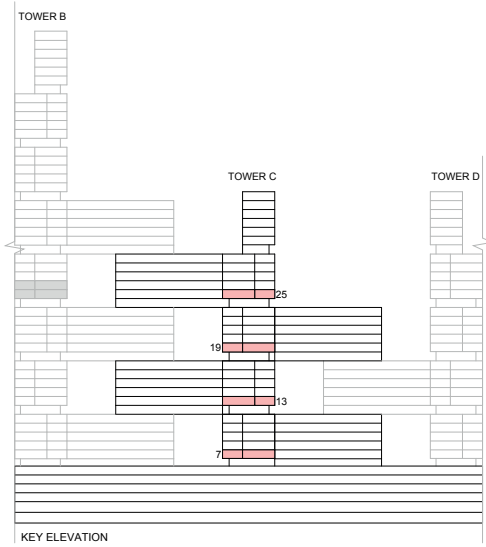

UNIT

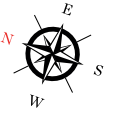

List of unit numbers with this unit plan:

VIEWS

Creek, Amenities
C705, C707

Creek, Golf Course, Amenities
C1305, C1307, C1905, C1907

Creek, Golf Course
C2505, C2507

Disclaimer: 1. All dimensions are in metric, measured to wall finishes. 2. All materials, dimensions & drawings are approximate. 3. Information is subject to change without notice, at developer's absolute discretion. 4. Actual area may vary from the stated area. 5. Drawing are not to scale. 6. All images used are for illustrative purpose only and do not represent the actual size, features, specifications, fittings and furnishings. 7. The developer reserves the right to make revisions/ alterations, at its absolute discretion, without any liability whatsoever.

1 BEDROOM APARTMENT

TYPE C (with powder room + yard)

TOTAL SALEABLE AREA

SUITE = 674.79 SQ.FT.

YARD = 133.04 SQ.FT.

TOTAL = 807.83 SQ.FT.

 UNIT

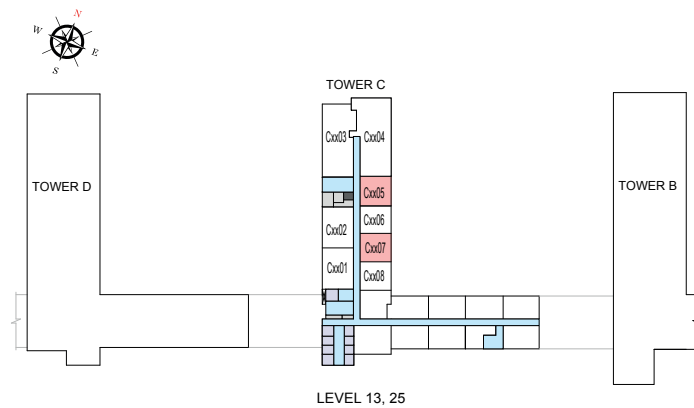
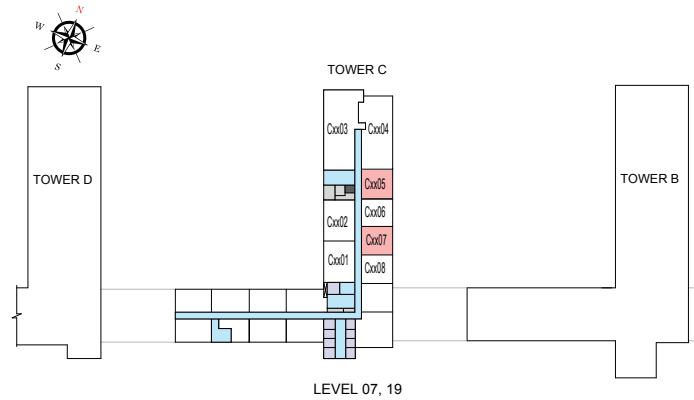

List of unit numbers with this unit plan:

VIEWS

Creek, Amenities
C705, C707

Creek, Golf Course, Amenities
C1305, C1307, C1905, C1907

Creek, Golf Course
C2505, C2507

Disclaimer: 1. All dimensions are in metric, measured to wall finishes. 2. All materials, dimensions & drawings are approximate. 3. Information is subject to change without notice, at developer's absolute discretion. 4. Actual area may vary from the stated area. 5. Drawing are not to scale. 6. All images used are for illustrative purpose only and do not represent the actual size, features, specifications, fittings and furnishings. 7. The developer reserves the right to make revisions/ alterations, at its absolute discretion, without any liability whatsoever.

1 BEDROOM APARTMENT

TYPE C (with powder room + yard) VARIANT 1

TOTAL SALEABLE AREA

SUITE = 674.79 SQ.FT.

YARD = 133.04 SQ.FT.

TOTAL = 807.83 SQ.FT.

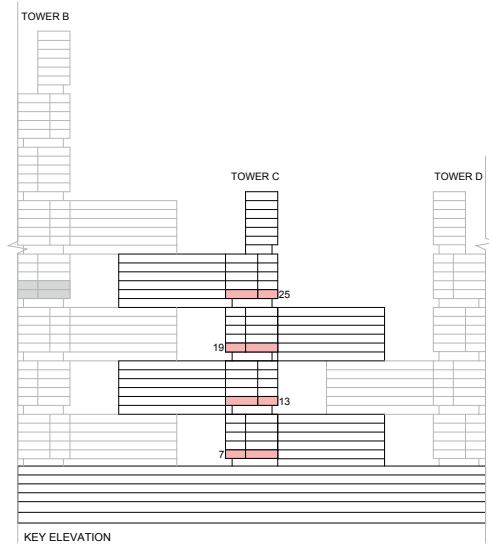

UNIT

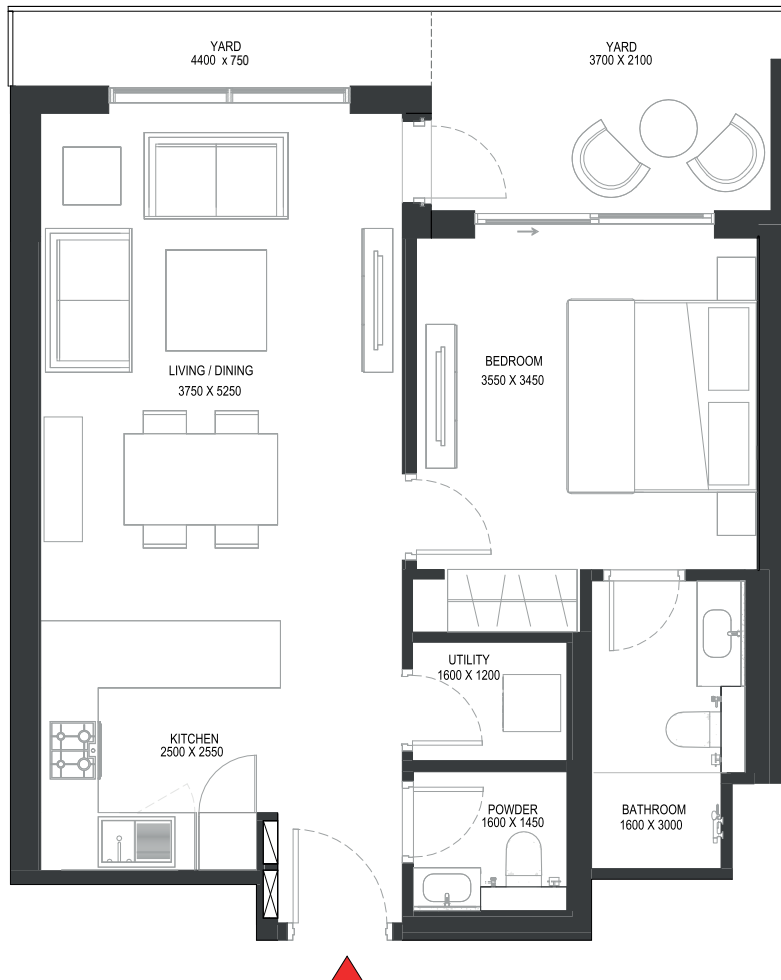
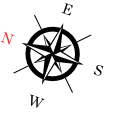

List of unit numbers with this unit plan:

VIEWS

Creek, Amenities
C706, C708

Creek, Golf Course, Amenities
C1306, C1308, C1906, C1908

Creek, Golf Course
C2506, C2508

Disclaimer: 1. All dimensions are in metric, measured to wall finishes. 2. All materials, dimensions & drawings are approximate. 3. Information is subject to change without notice, at developer's absolute discretion. 4. Actual area may vary from the stated area. 5. Drawing are not to scale. 6. All images used are for illustrative purpose only and do not represent the actual size, features, specifications, fittings and furnishings. 7. The developer reserves the right to make revisions/ alterations, at its absolute discretion, without any liability whatsoever.

1 BEDROOM APARTMENT

TYPE C (with powder room + yard) VARIANT 1

TOTAL SALEABLE AREA

SUITE = 674.79 SQ.FT.

YARD = 133.04 SQ.FT.

TOTAL = 807.83 SQ.FT.

UNIT

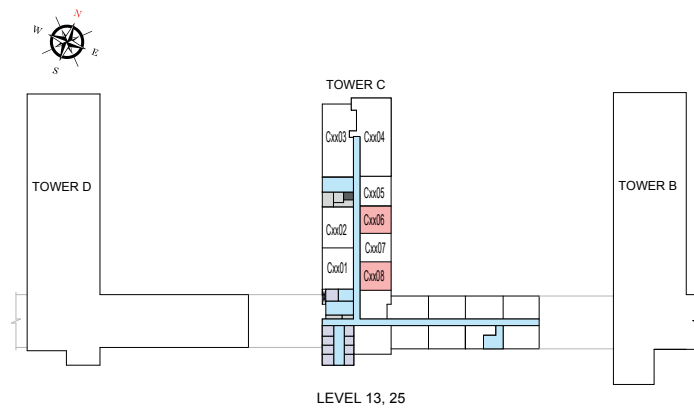
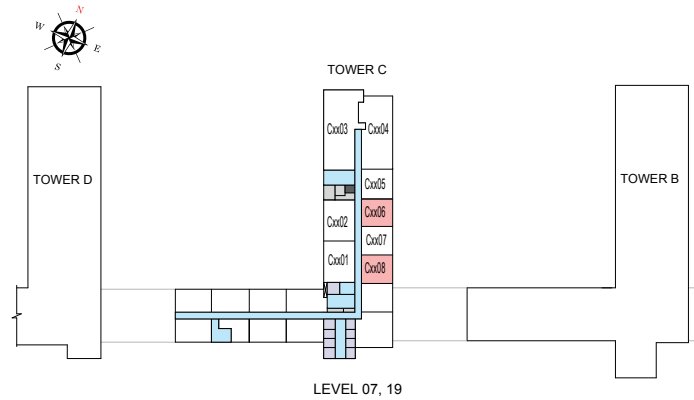

List of unit numbers with this unit plan:

VIEWS

Creek, Amenities
C706, C708

Creek, Golf Course, Amenities
C1306, C1308, C1906, C1908

Creek, Golf Course
C2506, C2508

Disclaimer: 1. All dimensions are in metric, measured to wall finishes. 2. All materials, dimensions & drawings are approximate. 3. Information is subject to change without notice, at developer's absolute discretion. 4. Actual area may vary from the stated area. 5. Drawing are not to scale. 6. All images used are for illustrative purpose only and do not represent the actual size, features, specifications, fittings and furnishings. 7. The developer reserves the right to make revisions/ alterations, at its absolute discretion, without any liability whatsoever.

2 BEDROOM APARTMENT

TYPE A (with powder room + balcony)

TOTAL SALEABLE AREA

SUITE = 1,034.63 SQ.FT.

BALCONY = 64.69 SQ.FT.

TOTAL = 1,099.32 SQ.FT.

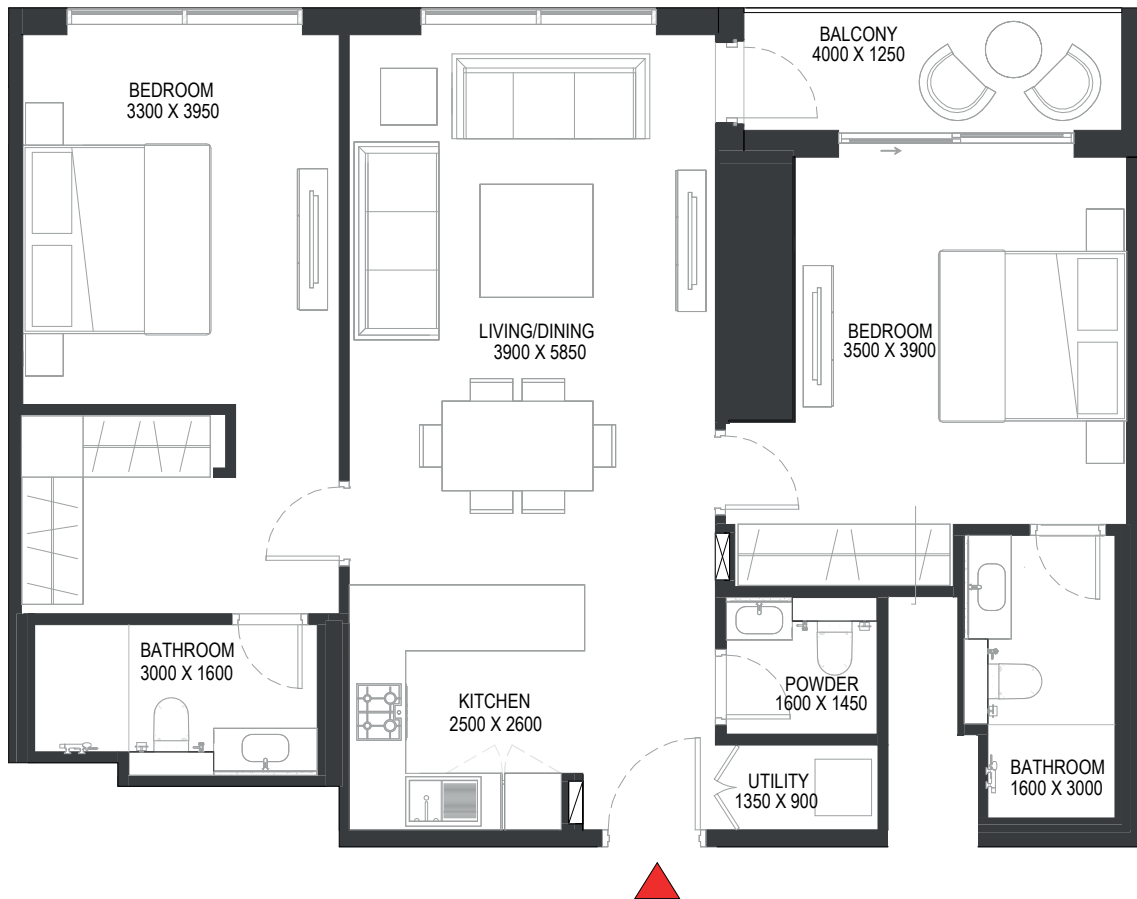
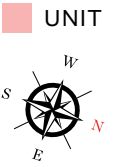
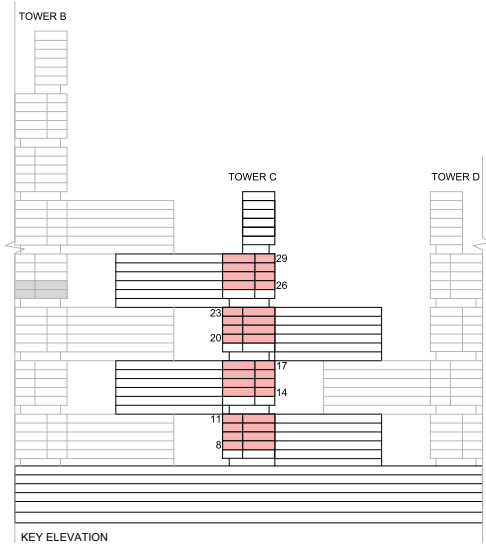

List of unit numbers with this unit plan:

VIEWS

Ras Al Khor, Amenities
C801, C901, C1001, C1101

Ras Al Khor, Golf Course, Amenities
C1401, C1501, C1601, C1701, C2001, C2101, C2201, C2301

Ras Al Khor, Golf Course
C2601, C2701, C2801, C2901

Disclaimer: 1. All dimensions are in metric, measured to wall finishes. 2. All materials, dimensions & drawings are approximate. 3. Information is subject to change without notice, at developer's absolute discretion. 4. Actual area may vary from the stated area. 5. Drawing are not to scale. 6. All images used are for illustrative purpose only and do not represent the actual size, features, specifications, fittings and furnishings. 7. The developer reserves the right to make revisions/ alterations, at its absolute discretion, without any liability whatsoever.

2 BEDROOM APARTMENT
TYPE A (with powder room + balcony)

TOTAL SALEABLE AREA

SUITE = 1,034.63 SQ.FT.
 BALCONY = 64.69 SQ.FT.
 TOTAL = 1,099.32 SQ.FT.

UNIT

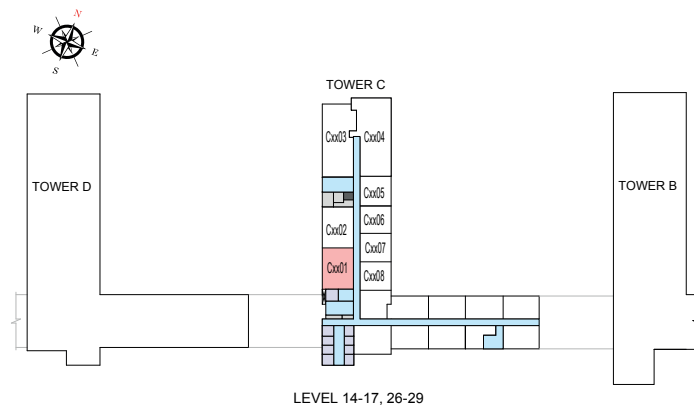
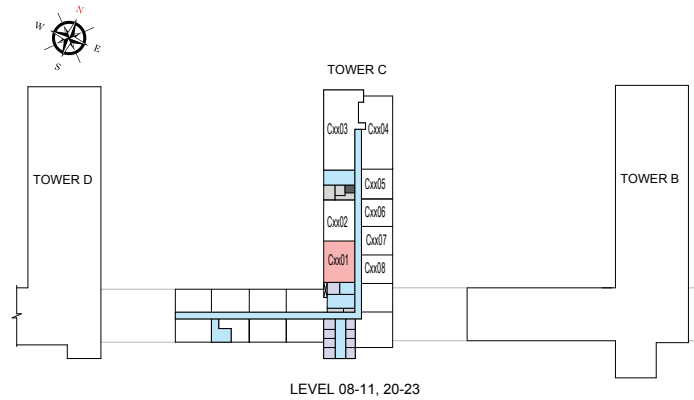

List of unit numbers with this unit plan:

VIEWS

Ras Al Khor, Amenities
 C801, C901, C1001, C1101

Ras Al Khor, Golf Course, Amenities
 C1401, C1501, C1601, C1701, C2001, C2101, C2201, C2301

Ras Al Khor, Golf Course
 C2601, C2701, C2801, C2901

Disclaimer: 1. All dimensions are in metric, measured to wall finishes. 2. All materials, dimensions & drawings are approximate. 3. Information is subject to change without notice, at developer's absolute discretion. 4. Actual area may vary from the stated area. 5. Drawing are not to scale. 6. All images used are for illustrative purpose only and do not represent the actual size, features, specifications, fittings and furnishings. 7. The developer reserves the right to make revisions/ alterations, at its absolute discretion, without any liability whatsoever.

2 BEDROOM APARTMENT

TYPE A (with powder room + balcony) VARIANT 1

TOTAL SALEABLE AREA

SUITE = 1,034.63 SQ.FT.

BALCONY = 64.69 SQ.FT.

TOTAL = 1,099.32 SQ.FT.

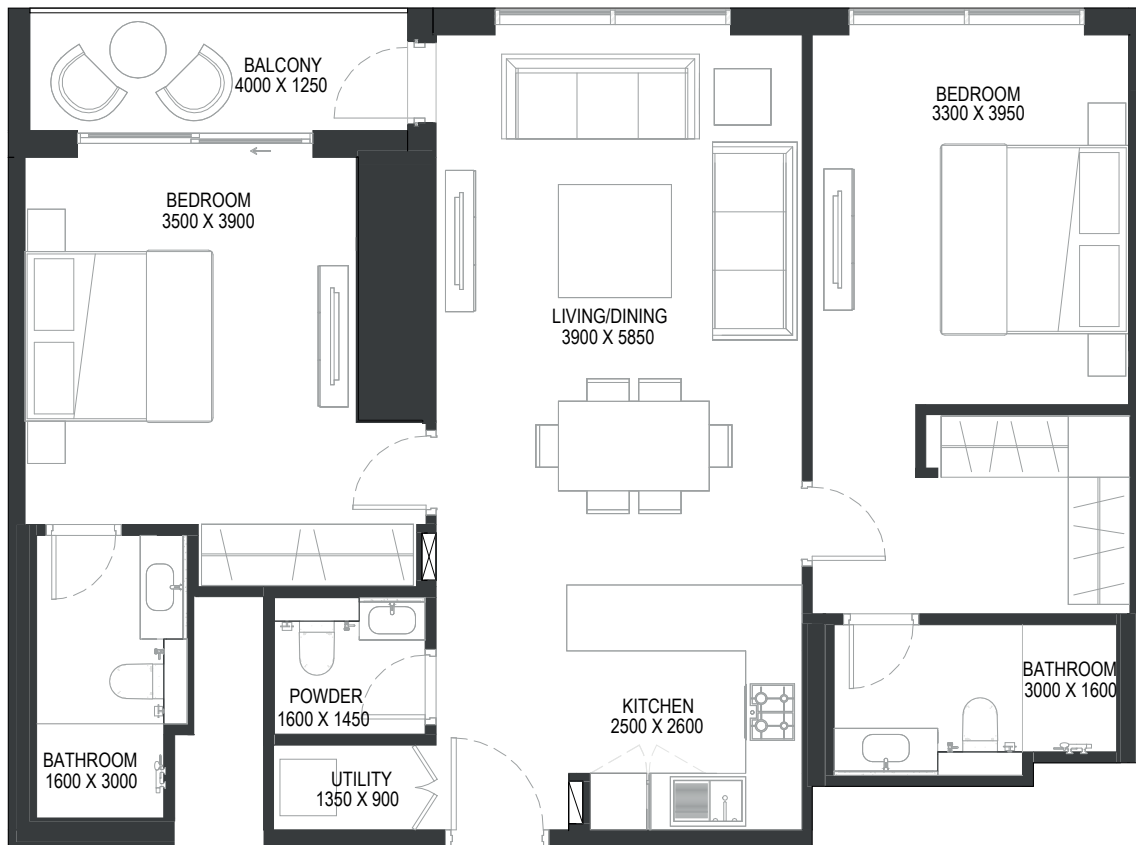
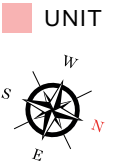
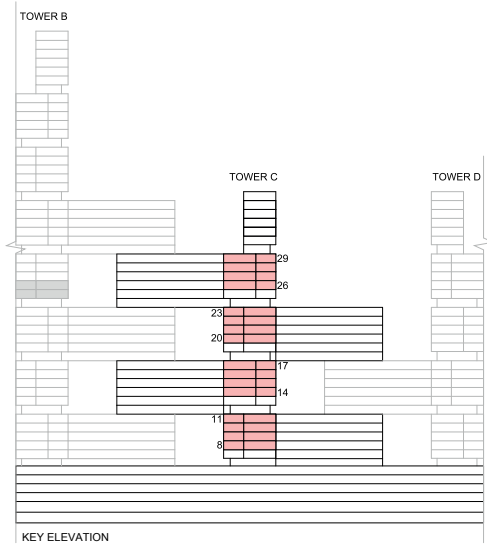

List of unit numbers with this unit plan:

VIEWS

Ras Al Khor, Amenities

C802, C902, C1002, C1102

Ras Al Khor, Golf Course, Amenities

C1402, C1502, C1602, C1702, C2002, C2102, C2202, C2302

Ras Al Khor, Golf Course

C2602, C2702, C2802, C2902

Disclaimer: 1. All dimensions are in metric, measured to wall finishes. 2. All materials, dimensions & drawings are approximate. 3. Information is subject to change without notice, at developer's absolute discretion. 4. Actual area may vary from the stated area. 5. Drawing are not to scale. 6. All images used are for illustrative purpose only and do not represent the actual size, features, specifications, fittings and furnishings. 7. The developer reserves the right to make revisions/ alterations, at its absolute discretion, without any liability whatsoever.

2 BEDROOM APARTMENT

TYPE A (with powder room + balcony) VARIANT 1

TOTAL SALEABLE AREA

SUITE = 1,034.63 SQ.FT.

BALCONY = 64.69 SQ.FT.

TOTAL = 1,099.32 SQ.FT.

UNIT

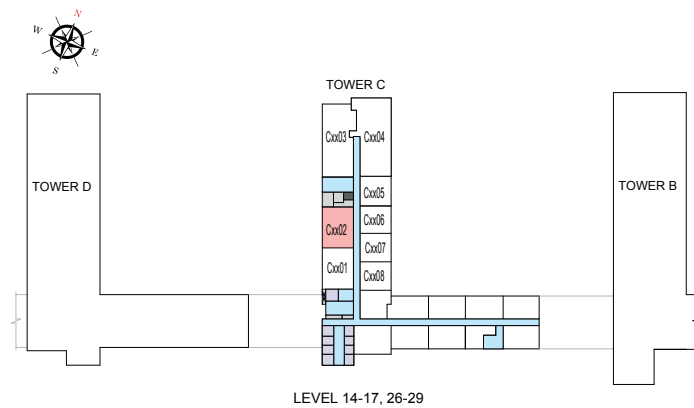
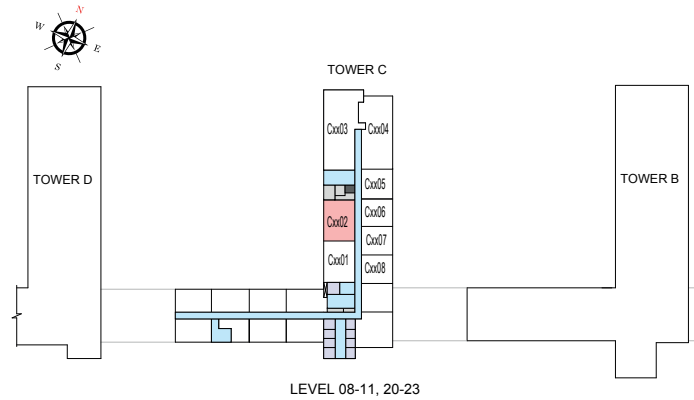

List of unit numbers with this unit plan:

VIEWS

Ras Al Khor, Amenities

C802, C902, C1002, C1102

Ras Al Khor, Golf Course, Amenities

C1402, C1502, C1602, C1702, C2002, C2102, C2202, C2302

Ras Al Khor, Golf Course

C2602, C2702, C2802, C2902

Disclaimer: 1. All dimensions are in metric, measured to wall finishes. 2. All materials, dimensions & drawings are approximate. 3. Information is subject to change without notice, at developer's absolute discretion. 4. Actual area may vary from the stated area. 5. Drawing are not to scale. 6. All images used are for illustrative purpose only and do not represent the actual size, features, specifications, fittings and furnishings. 7. The developer reserves the right to make revisions/ alterations, at its absolute discretion, without any liability whatsoever.

2 BEDROOM APARTMENT

TYPE G (with powder room + yard)

TOTAL SALEABLE AREA

SUITE = 1,025.05 SQ.FT.

YARD = 184.82 SQ.FT.

TOTAL = 1,209.87 SQ.FT.

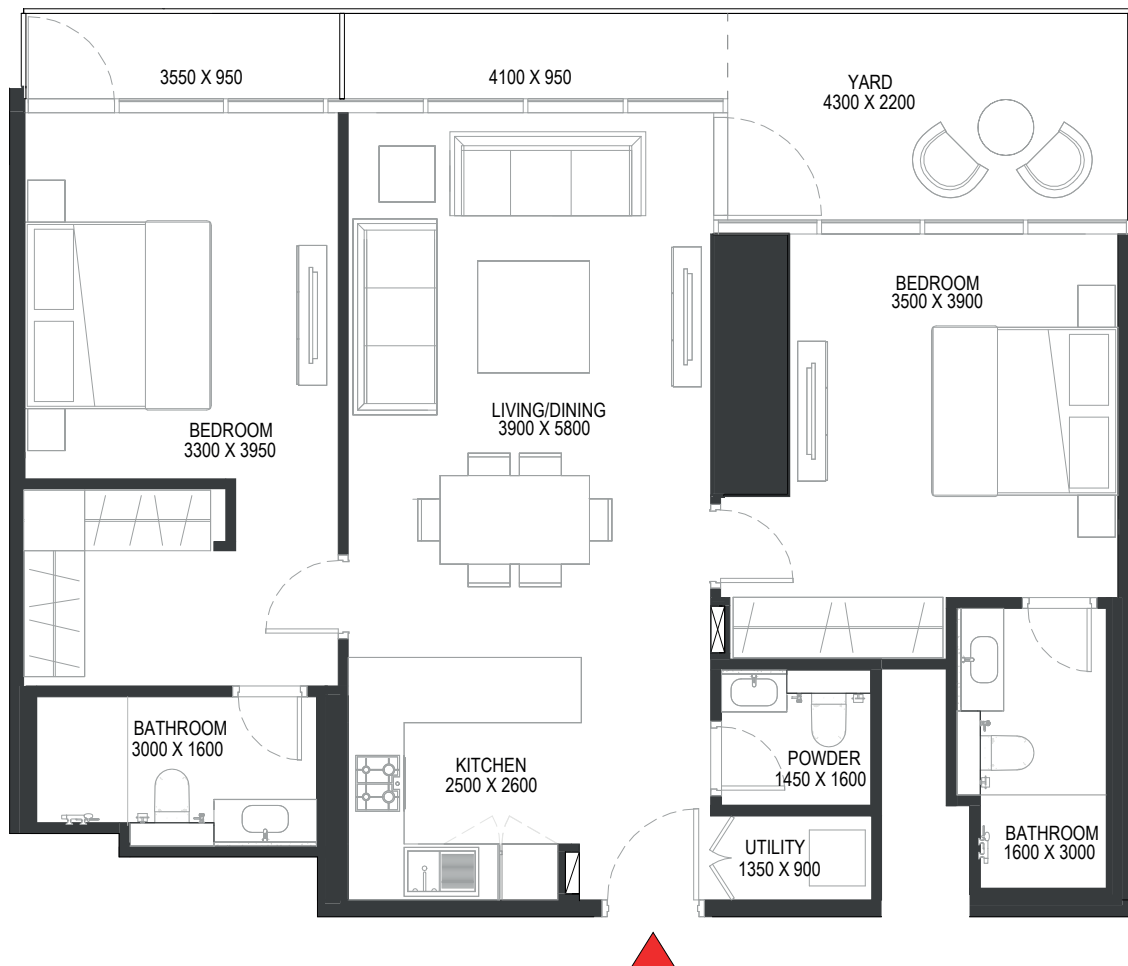
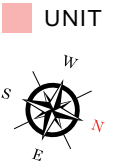
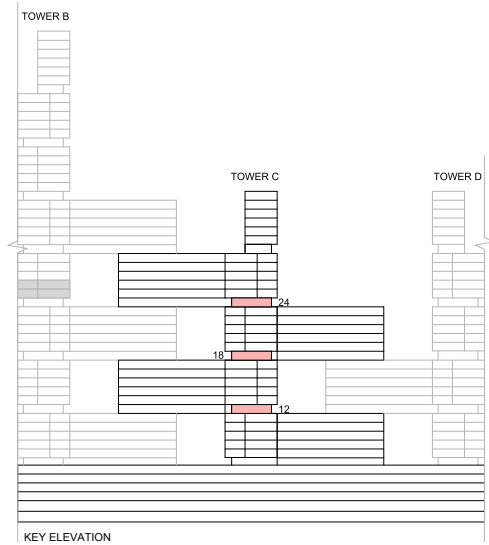

List of unit numbers with this unit plan:

VIEWS

Ras Al Khor, Amenities
C1201

Ras Al Khor, Golf Course, Amenities
C1801, C2401

Disclaimer: 1. All dimensions are in metric, measured to wall finishes. 2. All materials, dimensions & drawings are approximate. 3. Information is subject to change without notice, at developer's absolute discretion. 4. Actual area may vary from the stated area. 5. Drawing are not to scale. 6. All images used are for illustrative purpose only and do not represent the actual size, features, specifications, fittings and furnishings. 7. The developer reserves the right to make revisions/ alterations, at its absolute discretion, without any liability whatsoever.

2 BEDROOM APARTMENT

TYPE G (with powder room + yard)

TOTAL SALEABLE AREA

SUITE = 1,025.05 SQ.FT.

YARD = 184.82 SQ.FT.

TOTAL = 1,209.87 SQ.FT.

UNIT

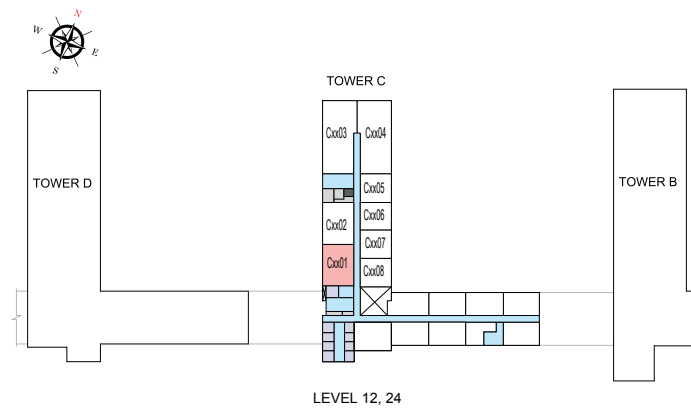
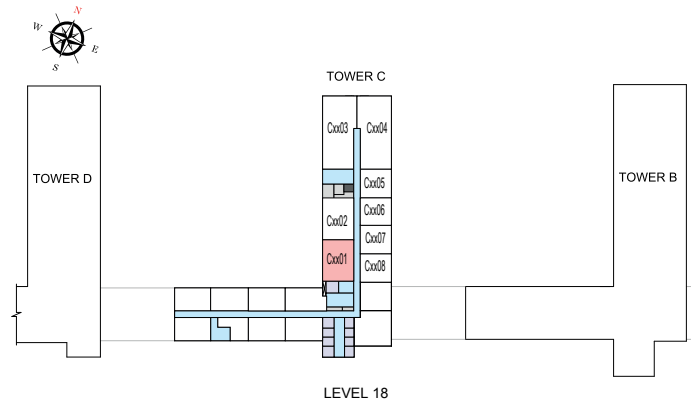

List of unit numbers with this unit plan:

VIEWS

Ras Al Khor, Amenities

C1201

Ras Al Khor, Golf Course, Amenities

C1801, C2401

Disclaimer: 1. All dimensions are in metric, measured to wall finishes. 2. All materials, dimensions & drawings are approximate. 3. Information is subject to change without notice, at developer's absolute discretion. 4. Actual area may vary from the stated area. 5. Drawing are not to scale. 6. All images used are for illustrative purpose only and do not represent the actual size, features, specifications, fittings and furnishings. 7. The developer reserves the right to make revisions/ alterations, at its absolute discretion, without any liability whatsoever.

2 BEDROOM APARTMENT

TYPE G (with powder room + yard) VARIANT 1

TOTAL SALEABLE AREA

SUITE = 1,025.05 SQ.FT.

YARD = 184.82 SQ.FT.

TOTAL = 1,209.87 SQ.FT.

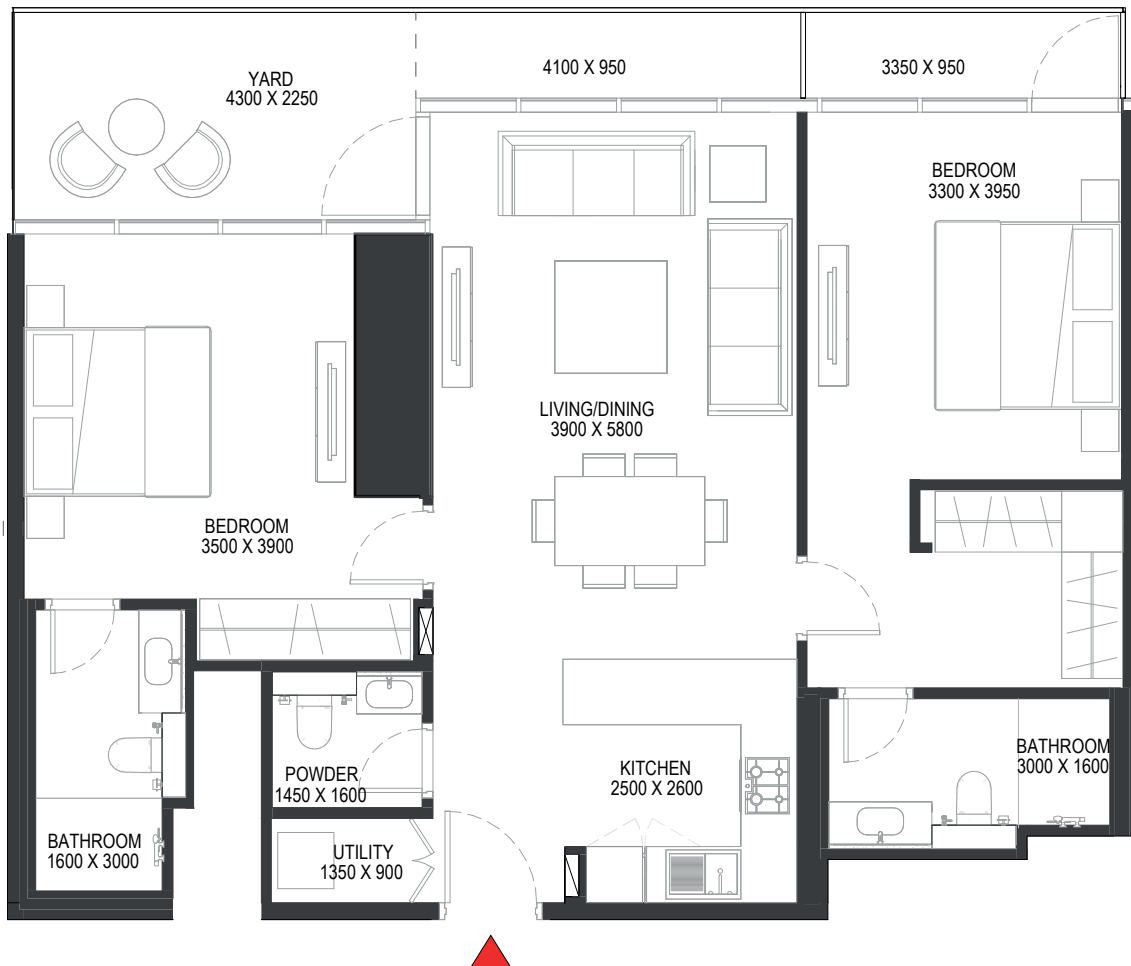
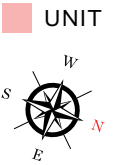
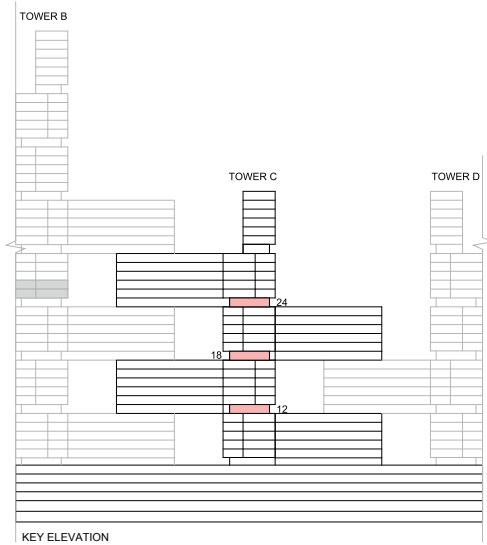

List of unit numbers with this unit plan:

VIEWS

Ras Al Khor, Amenities
C1202

Ras Al Khor, Golf Course, Amenities
C1802, C2402

Disclaimer: 1. All dimensions are in metric, measured to wall finishes. 2. All materials, dimensions & drawings are approximate. 3. Information is subject to change without notice, at developer's absolute discretion. 4. Actual area may vary from the stated area. 5. Drawing are not to scale. 6. All images used are for illustrative purpose only and do not represent the actual size, features, specifications, fittings and furnishings. 7. The developer reserves the right to make revisions/ alterations, at its absolute discretion, without any liability whatsoever.

2 BEDROOM APARTMENT

TYPE G (with powder room + yard) VARIANT 1

TOTAL SALEABLE AREA

SUITE = 1,025.05 SQ.FT.

YARD = 184.82 SQ.FT.

TOTAL = 1,209.87 SQ.FT.

UNIT

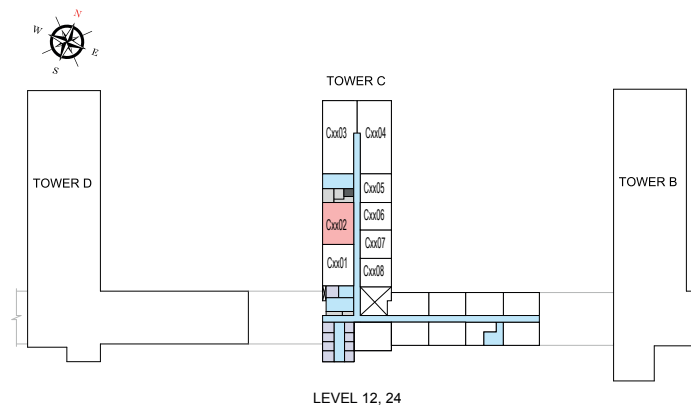
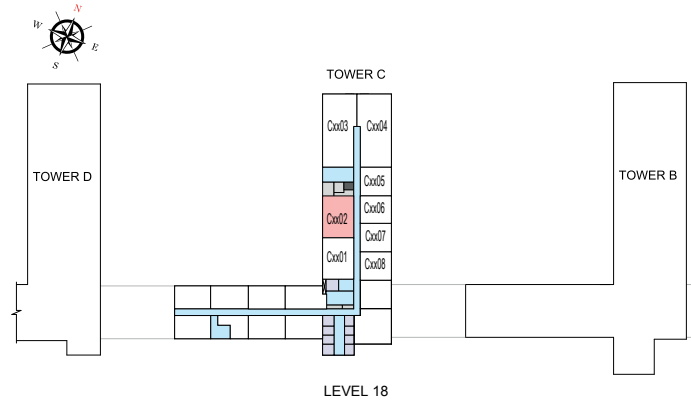

List of unit numbers with this unit plan:

VIEWS

Ras Al Khor, Amenities

C1202

Ras Al Khor, Golf Course, Amenities

C1802, C2402

Disclaimer: 1. All dimensions are in metric, measured to wall finishes. 2. All materials, dimensions & drawings are approximate. 3. Information is subject to change without notice, at developer's absolute discretion. 4. Actual area may vary from the stated area. 5. Drawing are not to scale. 6. All images used are for illustrative purpose only and do not represent the actual size, features, specifications, fittings and furnishings. 7. The developer reserves the right to make revisions/ alterations, at its absolute discretion, without any liability whatsoever.

2 BEDROOM APARTMENT

TYPE P (with powder room + yard)

TOTAL SALEABLE AREA

SUITE = 1,034.61 SQ.FT.

YARD = 178.41 SQ.FT.

TOTAL = 1,213.02 SQ.FT.

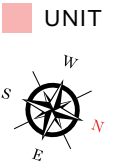
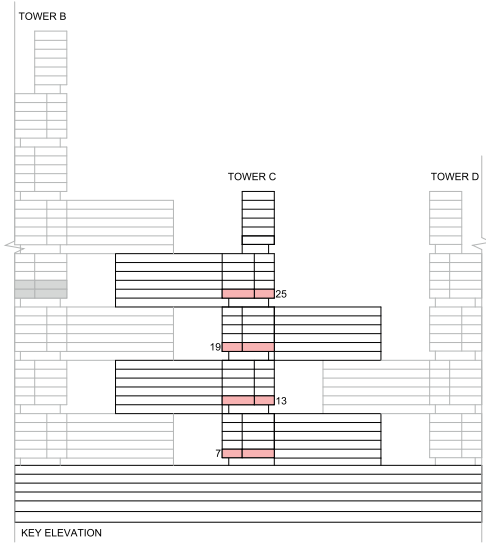

List of unit numbers with this unit plan:

VIEWS

Ras Al Khor, Amenities
C701

Ras Al Khor, Golf Course, Amenities
C1301, C1901

Ras Al Khor, Golf Course
C2501

Disclaimer: 1. All dimensions are in metric, measured to wall finishes. 2. All materials, dimensions & drawings are approximate. 3. Information is subject to change without notice, at developer's absolute discretion. 4. Actual area may vary from the stated area. 5. Drawing are not to scale. 6. All images used are for illustrative purpose only and do not represent the actual size, features, specifications, fittings and furnishings. 7. The developer reserves the right to make revisions/ alterations, at its absolute discretion, without any liability whatsoever.

2 BEDROOM APARTMENT

TYPE P (with powder room + yard)

TOTAL SALEABLE AREA

SUITE = 1,034.61 SQ.FT.

YARD = 178.41 SQ.FT.

TOTAL = 1,213.02 SQ.FT.

UNIT

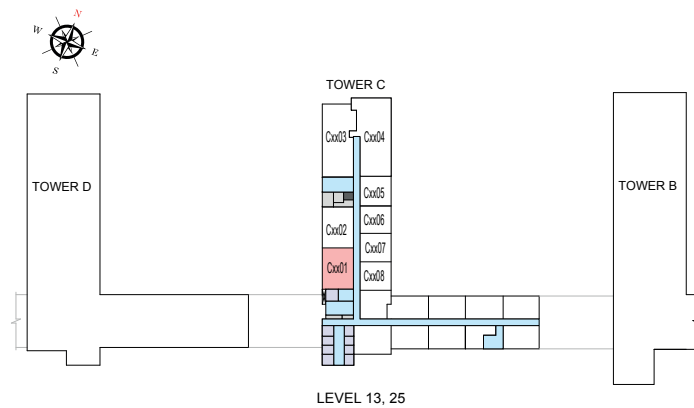
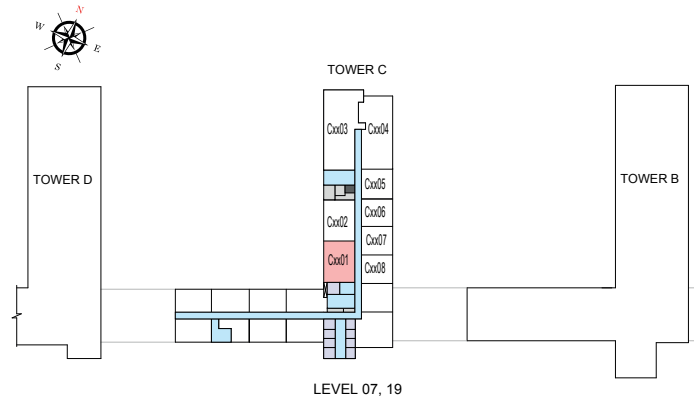

List of unit numbers with this unit plan:

VIEWS

Ras Al Khor, Amenities
C701

Ras Al Khor, Golf Course, Amenities
C1301, C1901

Ras Al Khor, Golf Course
C2501

Disclaimer: 1. All dimensions are in metric, measured to wall finishes. 2. All materials, dimensions & drawings are approximate. 3. Information is subject to change without notice, at developer's absolute discretion. 4. Actual area may vary from the stated area. 5. Drawing are not to scale. 6. All images used are for illustrative purpose only and do not represent the actual size, features, specifications, fittings and furnishings. 7. The developer reserves the right to make revisions/ alterations, at its absolute discretion, without any liability whatsoever.

2 BEDROOM APARTMENT

TYPE P (with powder room + yard) VARIANT 1

TOTAL SALEABLE AREA

SUITE = 1,034.61 SQ.FT.

YARD = 178.41 SQ.FT.

TOTAL = 1,213.02 SQ.FT.

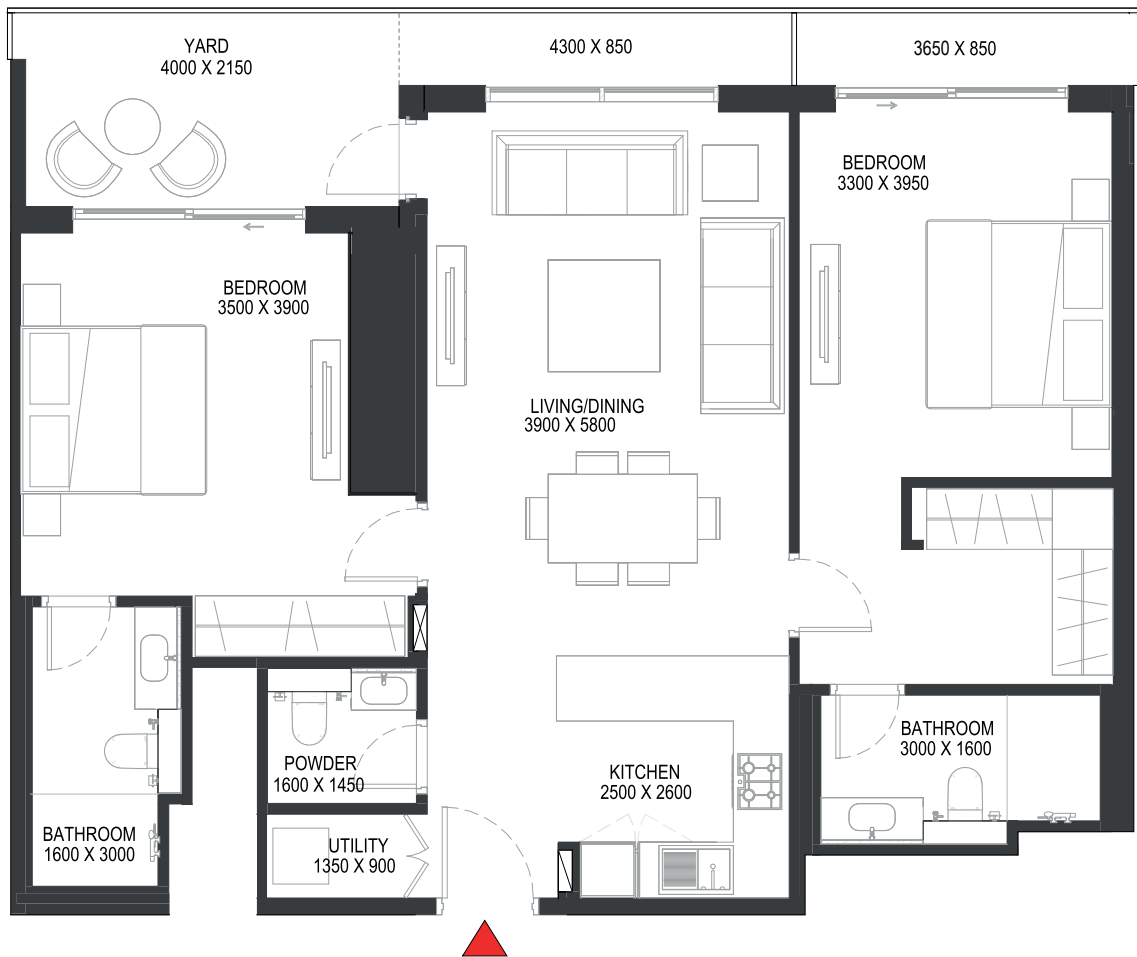
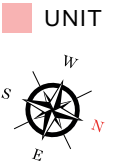
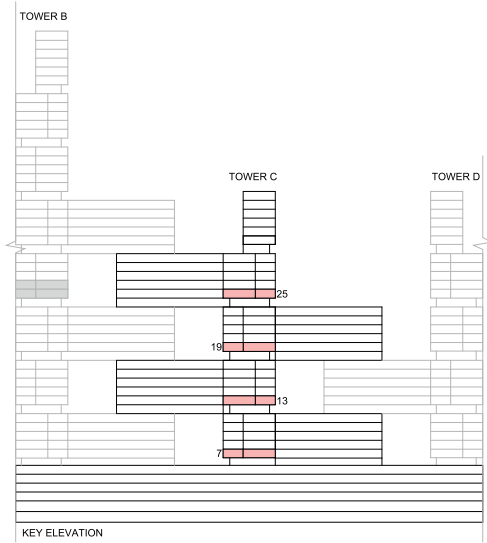

List of unit numbers with this unit plan:

VIEWS

Ras Al Khor, Amenities
C702

Ras Al Khor, Golf Course, Amenities
C1302, C1902

Ras Al Khor, Golf Course
C2502

Disclaimer: 1. All dimensions are in metric, measured to wall finishes. 2. All materials, dimensions & drawings are approximate. 3. Information is subject to change without notice, at developer's absolute discretion. 4. Actual area may vary from the stated area. 5. Drawing are not to scale. 6. All images used are for illustrative purpose only and do not represent the actual size, features, specifications, fittings and furnishings. 7. The developer reserves the right to make revisions/ alterations, at its absolute discretion, without any liability whatsoever.

2 BEDROOM APARTMENT

TYPE P (with powder room + yard) VARIANT 1

TOTAL SALEABLE AREA

SUITE = 1,034.61 SQ.FT.

YARD = 178.41 SQ.FT.

TOTAL = 1,213.02 SQ.FT.

 UNIT

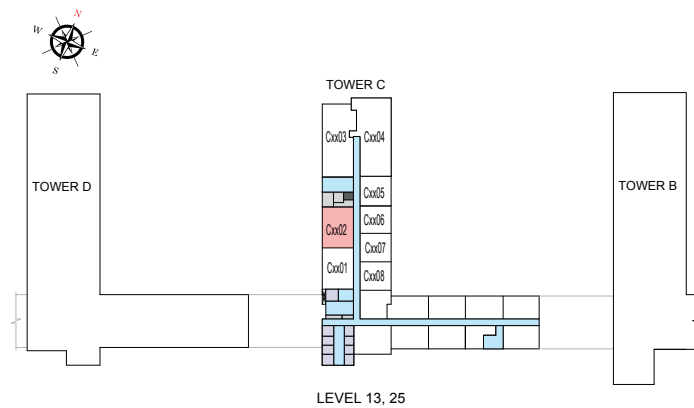
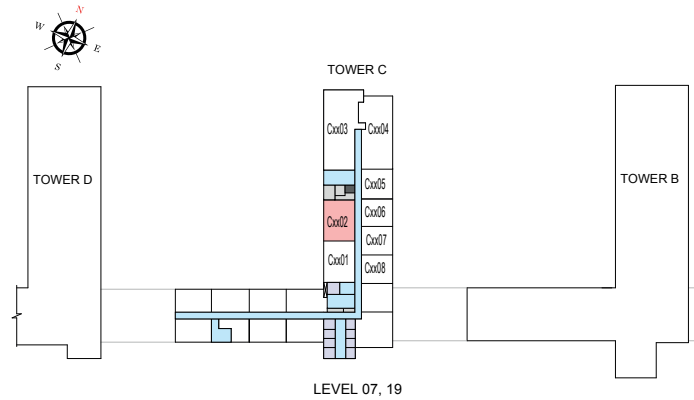

List of unit numbers with this unit plan:

VIEWS

Ras Al Khor, Amenities
C702

Ras Al Khor, Golf Course, Amenities
C1302, C1902

Ras Al Khor, Golf Course
C2502

Disclaimer: 1. All dimensions are in metric, measured to wall finishes. 2. All materials, dimensions & drawings are approximate. 3. Information is subject to change without notice, at developer's absolute discretion. 4. Actual area may vary from the stated area. 5. Drawing are not to scale. 6. All images used are for illustrative purpose only and do not represent the actual size, features, specifications, fittings and furnishings. 7. The developer reserves the right to make revisions/ alterations, at its absolute discretion, without any liability whatsoever.

3 BEDROOM APARTMENT

TYPE A (with maid room + balcony)

TOTAL SALEABLE AREA

SUITE = 1,642.57 SQ.FT.

BALCONY = 274.54 SQ.FT.

TOTAL = 1,917.11 SQ.FT.

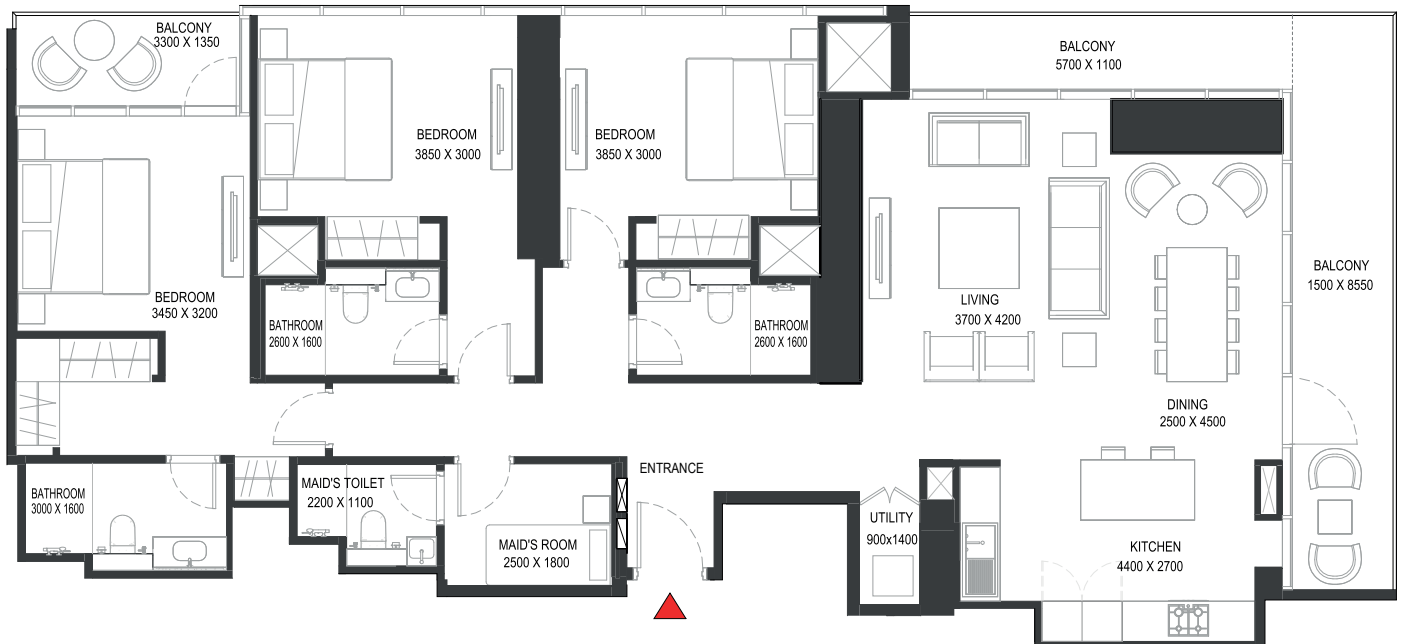
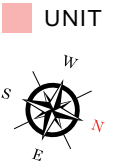
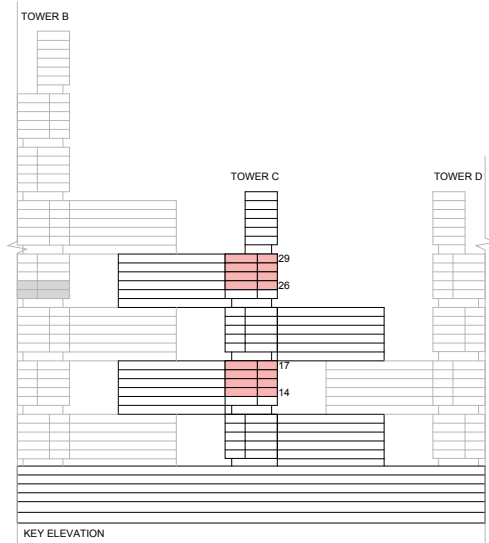

List of unit numbers with this unit plan:

VIEWS

Downtown, Ras Al Khor, Creek, Golf Course, Water body, Amenities
C1403, C1503, C1603, C1703

Downtown, Ras Al Khor, Creek, Golf Course, Water body
C2603, C2703, C2803, C2903

Disclaimer: 1. All dimensions are in metric, measured to wall finishes. 2. All materials, dimensions & drawings are approximate. 3. Information is subject to change without notice, at developer's absolute discretion. 4. Actual area may vary from the stated area. 5. Drawing are not to scale. 6. All images used are for illustrative purpose only and do not represent the actual size, features, specifications, fittings and furnishings. 7. The developer reserves the right to make revisions/ alterations, at its absolute discretion, without any liability whatsoever.

3 BEDROOM APARTMENT

TYPE A (with maid room + balcony)

TOTAL SALEABLE AREA

SUITE = 1,642.57 SQ.FT.

BALCONY = 274.54 SQ.FT.

TOTAL = 1,917.11 SQ.FT.

■ UNIT

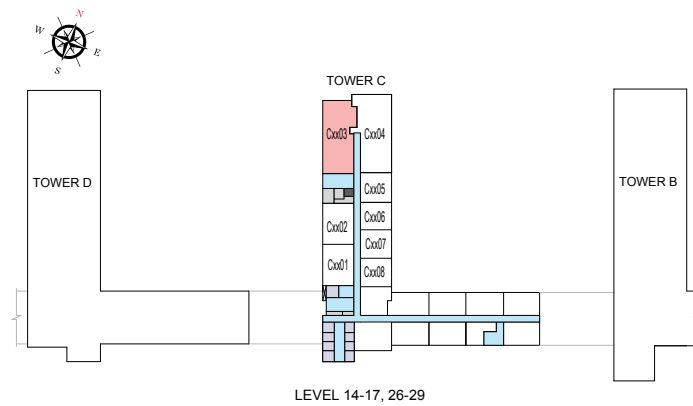

List of unit numbers with this unit plan:

VIEWS

Downtown, Ras Al Khor, Creek, Golf Course, Water body, Amenities
C1403, C1503, C1603, C1703

Downtown, Ras Al Khor, Creek, Golf Course, Water body
C2603, C2703, C2803, C2903

Disclaimer: 1. All dimensions are in metric, measured to wall finishes. 2. All materials, dimensions & drawings are approximate. 3. Information is subject to change without notice, at developer's absolute discretion. 4. Actual area may vary from the stated area. 5. Drawing are not to scale. 6. All images used are for illustrative purpose only and do not represent the actual size, features, specifications, fittings and furnishings. 7. The developer reserves the right to make revisions/ alterations, at its absolute discretion, without any liability whatsoever.

3 BEDROOM APARTMENT

TYPE A (with maid room + balcony) VARIANT 1

TOTAL SALEABLE AREA

SUITE = 1,642.57 SQ.FT.

BALCONY = 274.54 SQ.FT.

TOTAL = 1,917.11 SQ.FT.

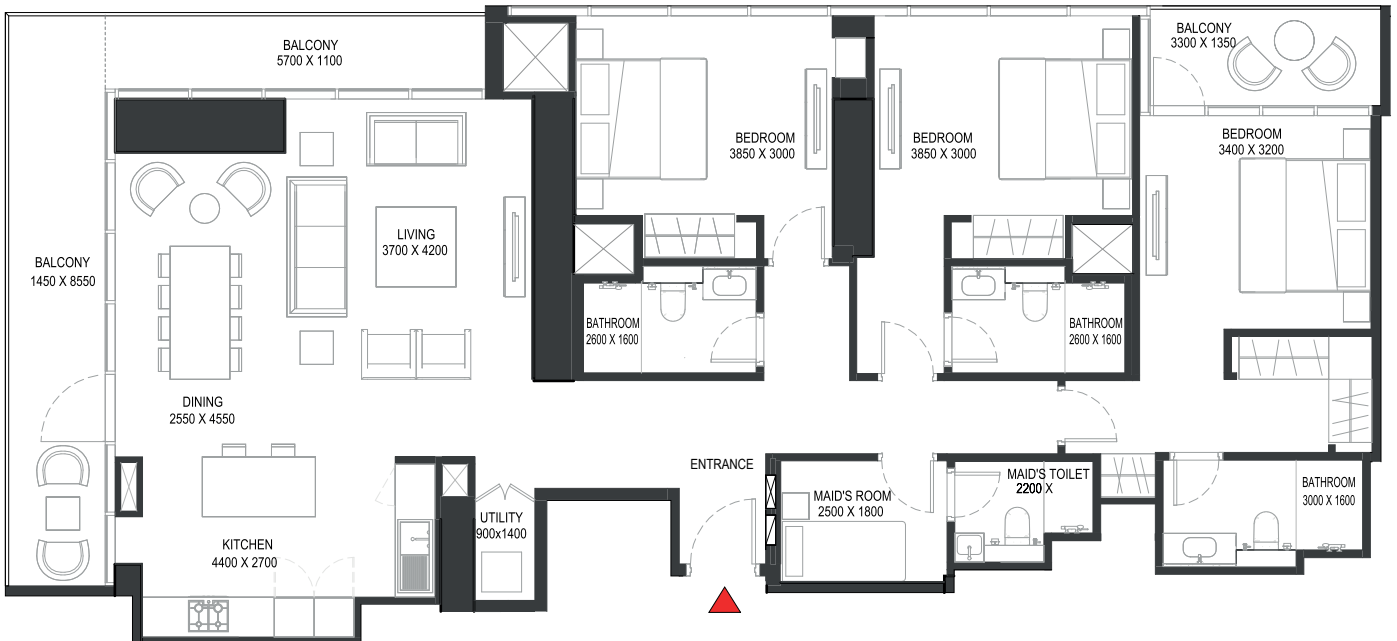
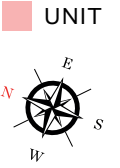
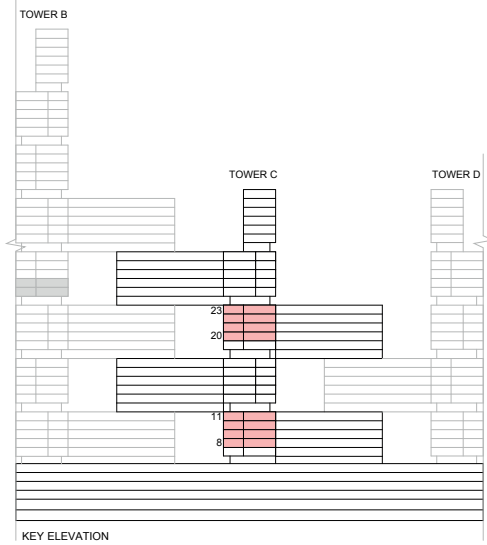

List of unit numbers with this unit plan:

VIEWS

Downtown, Ras Al Khor, Creek, Golf Course, Water body, Amenities
C804, C904, C1004, C1104, C2004, C2104, C2204, C2304

Disclaimer: 1. All dimensions are in metric, measured to wall finishes. 2. All materials, dimensions & drawings are approximate. 3. Information is subject to change without notice, at developer's absolute discretion. 4. Actual area may vary from the stated area. 5. Drawing are not to scale. 6. All images used are for illustrative purpose only and do not represent the actual size, features, specifications, fittings and furnishings. 7. The developer reserves the right to make revisions/ alterations, at its absolute discretion, without any liability whatsoever.

3 BEDROOM APARTMENT

TYPE A (with maid room + balcony) VARIANT 1

TOTAL SALEABLE AREA

SUITE = 1,642.57 SQ.FT.

BALCONY = 274.54 SQ.FT.

TOTAL = 1,917.11 SQ.FT.

 UNIT

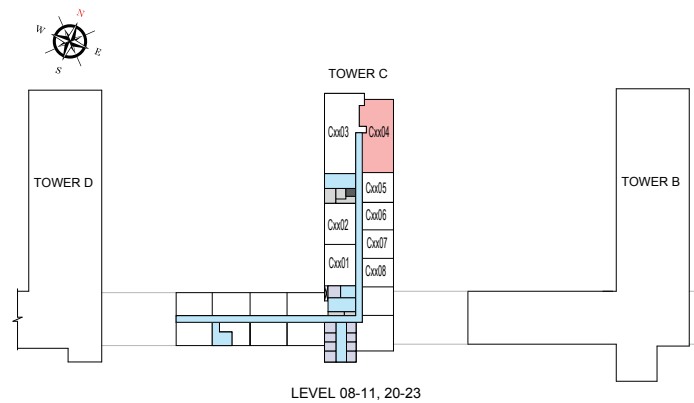

List of unit numbers with this unit plan:

VIEWS

Downtown, Ras Al Khor, Creek, Golf Course, Water body, Amenities

C804, C904, C1004, C1104, C2004, C2104, C2204, C2304

Disclaimer: 1. All dimensions are in metric, measured to wall finishes. 2. All materials, dimensions & drawings are approximate. 3. Information is subject to change without notice, at developer's absolute discretion. 4. Actual area may vary from the stated area. 5. Drawing are not to scale. 6. All images used are for illustrative purpose only and do not represent the actual size, features, specifications, fittings and furnishings. 7. The developer reserves the right to make revisions/ alterations, at its absolute discretion, without any liability whatsoever.

3 BEDROOM APARTMENT

TYPE C (with store room, maid room + yard)

TOTAL SALEABLE AREA

SUITE = 1,708.66 SQ.FT.

YARD = 782.88 SQ.FT.

TOTAL = 2,491.54 SQ.FT.

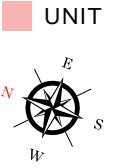
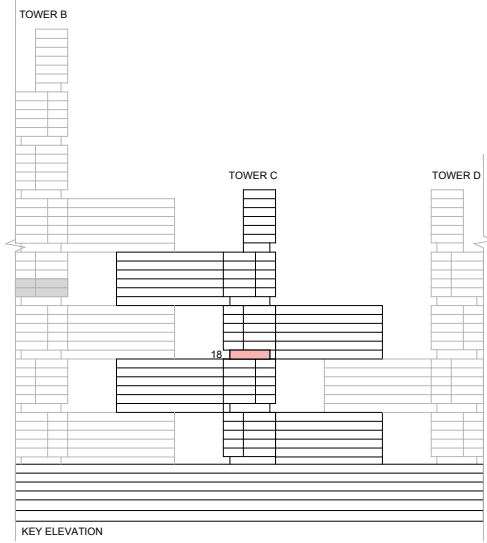

List of unit numbers with this unit plan:

VIEWS

Downtown, Ras Al Khor, Creek, Golf Course, Water body, Amenities
C1804

Disclaimer: 1. All dimensions are in metric, measured to wall finishes. 2. All materials, dimensions & drawings are approximate. 3. Information is subject to change without notice, at developer's absolute discretion. 4. Actual area may vary from the stated area. 5. Drawing are not to scale. 6. All images used are for illustrative purpose only and do not represent the actual size, features, specifications, fittings and furnishings. 7. The developer reserves the right to make revisions/ alterations, at its absolute discretion, without any liability whatsoever.

3 BEDROOM APARTMENT

TYPE C (with store room, maid room + yard)

TOTAL SALEABLE AREA

SUITE = 1,708.66 SQ.FT.

YARD = 782.88 SQ.FT.

TOTAL = 2,491.54 SQ.FT.

UNIT

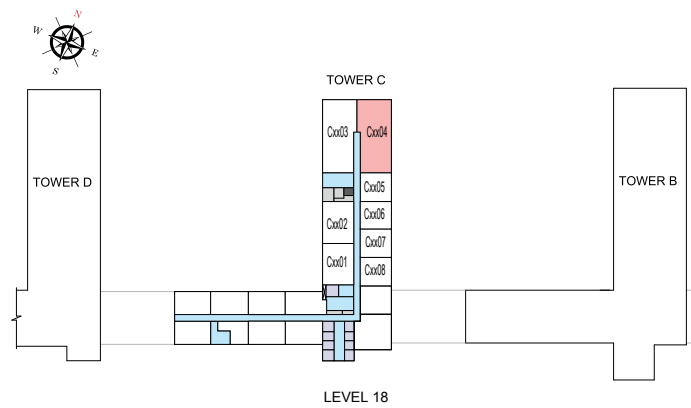

List of unit numbers with this unit plan:

VIEWS

Downtown, Ras Al Khor, Creek, Golf Course, Water body, Amenities
C1804

Disclaimer: 1. All dimensions are in metric, measured to wall finishes. 2. All materials, dimensions & drawings are approximate. 3. Information is subject to change without notice, at developer's absolute discretion. 4. Actual area may vary from the stated area. 5. Drawing are not to scale. 6. All images used are for illustrative purpose only and do not represent the actual size, features, specifications, fittings and furnishings. 7. The developer reserves the right to make revisions/ alterations, at its absolute discretion, without any liability whatsoever.

3 BEDROOM APARTMENT

TYPE C (with store room, maid room + yard) VARIANT 1

TOTAL SALEABLE AREA

SUITE = 1,708.66 SQ.FT.

YARD = 782.88 SQ.FT.

TOTAL = 2,491.54 SQ.FT.

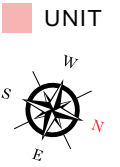
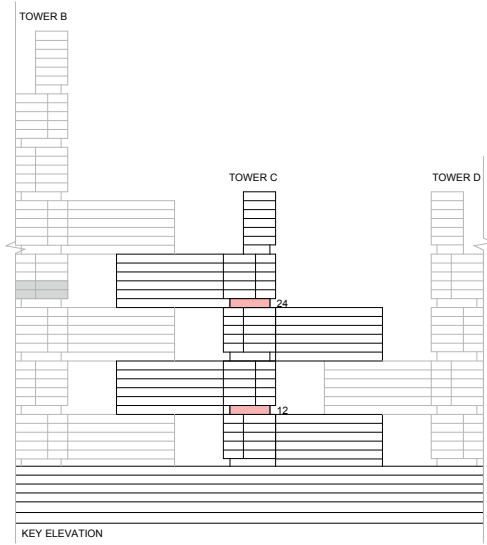

List of unit numbers with this unit plan:

VIEWS

Downtown, Ras Al Khor, Creek, Golf Course, Water body, Amenities
C1203, C2403

Disclaimer: 1. All dimensions are in metric, measured to wall finishes. 2. All materials, dimensions & drawings are approximate. 3. Information is subject to change without notice, at developer's absolute discretion. 4. Actual area may vary from the stated area. 5. Drawing are not to scale. 6. All images used are for illustrative purpose only and do not represent the actual size, features, specifications, fittings and furnishings. 7. The developer reserves the right to make revisions/ alterations, at its absolute discretion, without any liability whatsoever.

3 BEDROOM APARTMENT

TYPE C (with store room, maid room + yard) VARIANT 1

TOTAL SALEABLE AREA

SUITE = 1,708.66 SQ.FT.

YARD = 782.88 SQ.FT.

TOTAL = 2,491.54 SQ.FT.

 UNIT

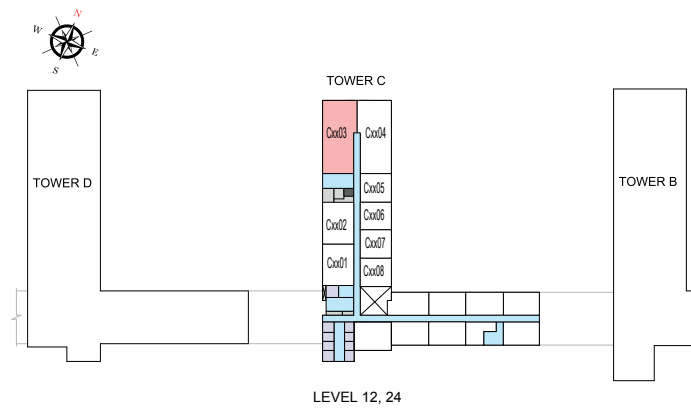

List of unit numbers with this unit plan:

VIEWS

Downtown, Ras Al Khor, Creek, Golf Course, Water body, Amenities
C1203, C2403

Disclaimer: 1. All dimensions are in metric, measured to wall finishes. 2. All materials, dimensions & drawings are approximate. 3. Information is subject to change without notice, at developer's absolute discretion. 4. Actual area may vary from the stated area. 5. Drawing are not to scale. 6. All images used are for illustrative purpose only and do not represent the actual size, features, specifications, fittings and furnishings. 7. The developer reserves the right to make revisions/ alterations, at its absolute discretion, without any liability whatsoever.

3 BEDROOM APARTMENT

TYPE D (with store room, maid room + yard)

TOTAL SALEABLE AREA

SUITE = 1,708.66 SQ.FT.

YARD = 536.03 SQ.FT.

TOTAL = 2,244.69 SQ.FT.

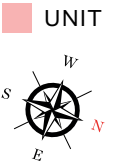
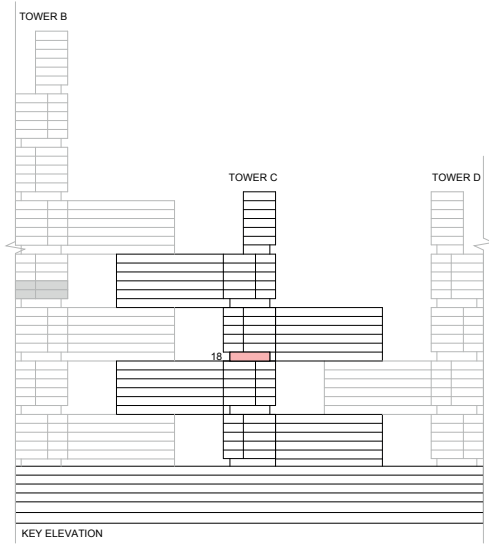

List of unit numbers with this unit plan:

VIEWS

Downtown, Ras Al Khor, Creek, Golf Course, Water body, Amenities
C1803

Disclaimer: 1. All dimensions are in metric, measured to wall finishes. 2. All materials, dimensions & drawings are approximate. 3. Information is subject to change without notice, at developer's absolute discretion. 4. Actual area may vary from the stated area. 5. Drawing are not to scale. 6. All images used are for illustrative purpose only and do not represent the actual size, features, specifications, fittings and furnishings. 7. The developer reserves the right to make revisions/ alterations, at its absolute discretion, without any liability whatsoever.

3 BEDROOM APARTMENT

TYPE D (with store room, maid room + yard)

TOTAL SALEABLE AREA

SUITE = 1,708.66 SQ.FT.

YARD = 536.03 SQ.FT.

TOTAL = 2,244.69 SQ.FT.

 UNIT

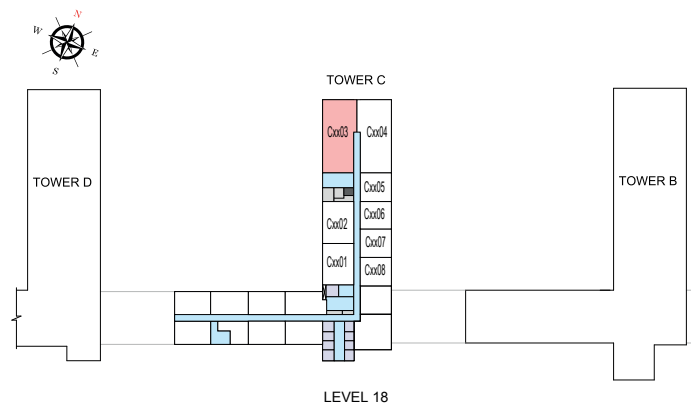

List of unit numbers with this unit plan:

VIEWS

Downtown, Ras Al Khor, Creek, Golf Course, Water body, Amenities
C1803

Disclaimer: 1. All dimensions are in metric, measured to wall finishes. 2. All materials, dimensions & drawings are approximate. 3. Information is subject to change without notice, at developer's absolute discretion. 4. Actual area may vary from the stated area. 5. Drawing are not to scale. 6. All images used are for illustrative purpose only and do not represent the actual size, features, specifications, fittings and furnishings. 7. The developer reserves the right to make revisions/ alterations, at its absolute discretion, without any liability whatsoever.

3 BEDROOM APARTMENT

TYPE D (with store room, maid room + yard) VARIANT 1

TOTAL SALEABLE AREA

SUITE = 1,708.66 SQ.FT.

YARD = 536.03 SQ.FT.

TOTAL = 2,244.69 SQ.FT.

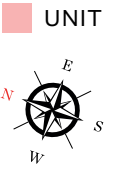
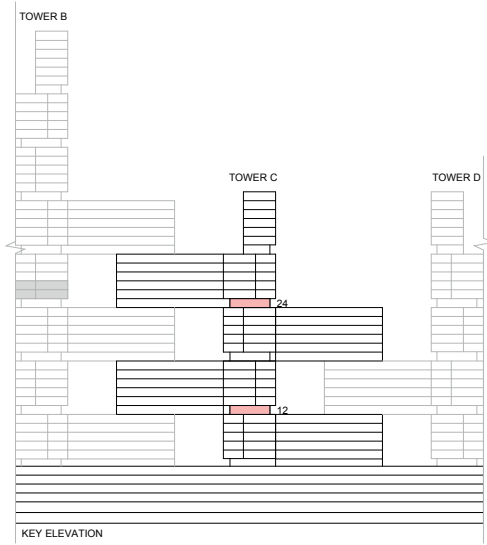

List of unit numbers with this unit plan:

VIEWS

Downtown, Ras Al Khor, Creek, Golf Course, Water body, Amenities
C1204, C2404

Disclaimer: 1. All dimensions are in metric, measured to wall finishes. 2. All materials, dimensions & drawings are approximate. 3. Information is subject to change without notice, at developer's absolute discretion. 4. Actual area may vary from the stated area. 5. Drawing are not to scale. 6. All images used are for illustrative purpose only and do not represent the actual size, features, specifications, fittings and furnishings. 7. The developer reserves the right to make revisions/ alterations, at its absolute discretion, without any liability whatsoever.

3 BEDROOM APARTMENT

TYPE D (with store room, maid room + yard) VARIANT 1

TOTAL SALEABLE AREA

SUITE = 1,708.66 SQ.FT.

YARD = 536.03 SQ.FT.

TOTAL = 2,244.69 SQ.FT.

 UNIT

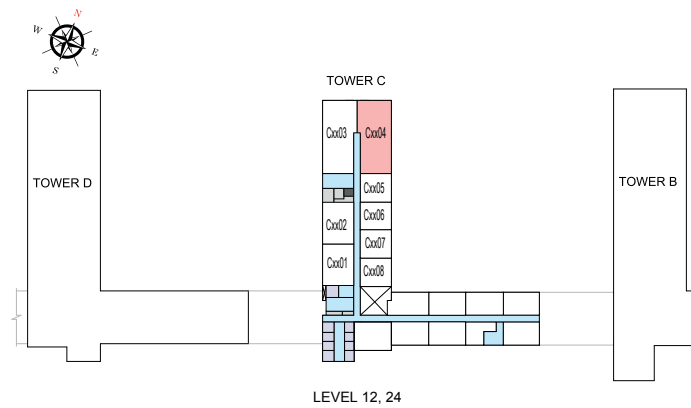

List of unit numbers with this unit plan:

VIEWS

Downtown, Ras Al Khor, Creek, Golf Course, Water body, Amenities
C1204, C2404

Disclaimer: 1. All dimensions are in metric, measured to wall finishes. 2. All materials, dimensions & drawings are approximate. 3. Information is subject to change without notice, at developer's absolute discretion. 4. Actual area may vary from the stated area. 5. Drawing are not to scale. 6. All images used are for illustrative purpose only and do not represent the actual size, features, specifications, fittings and furnishings. 7. The developer reserves the right to make revisions/ alterations, at its absolute discretion, without any liability whatsoever.

3 BEDROOM APARTMENT

TYPE E (with maid room + yard)

TOTAL SALEABLE AREA

SUITE = 1,642.57 SQ.FT.

YARD = 539.66 SQ.FT.

TOTAL = 2,182.23 SQ.FT.

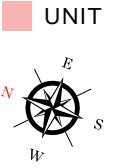
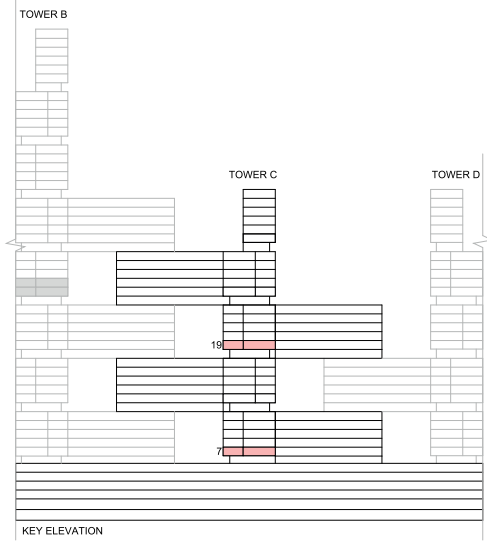

List of unit numbers with this unit plan:

VIEWS

Downtown, Ras Al Khor, Creek, Golf Course, Amenities
C704

Downtown, Ras Al Khor, Creek, Golf Course, Water body, Amenities
C1904

Disclaimer: 1. All dimensions are in metric, measured to wall finishes. 2. All materials, dimensions & drawings are approximate. 3. Information is subject to change without notice, at developer's absolute discretion. 4. Actual area may vary from the stated area. 5. Drawing are not to scale. 6. All images used are for illustrative purpose only and do not represent the actual size, features, specifications, fittings and furnishings. 7. The developer reserves the right to make revisions/ alterations, at its absolute discretion, without any liability whatsoever.

3 BEDROOM APARTMENT

TYPE E (with maid room + yard)

TOTAL SALEABLE AREA

SUITE = 1,642.57 SQ.FT.

YARD = 539.66 SQ.FT.

TOTAL = 2,182.23 SQ.FT.

 UNIT

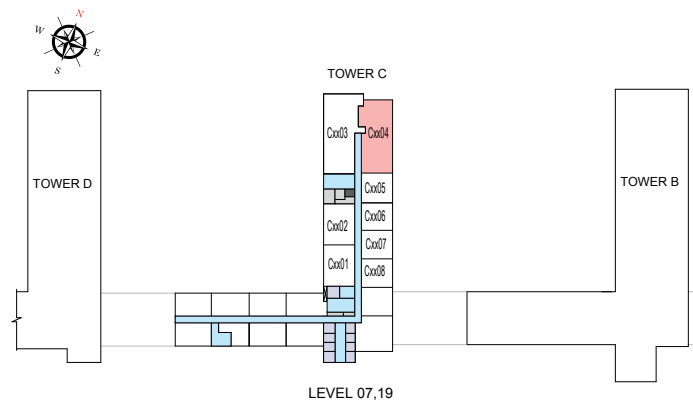

List of unit numbers with this unit plan:

VIEWS

Downtown, Ras Al Khor, Creek, Golf Course, Amenities
C704

Downtown, Ras Al Khor, Creek, Golf Course, Water body, Amenities
C1904

Disclaimer: 1. All dimensions are in metric, measured to wall finishes. 2. All materials, dimensions & drawings are approximate. 3. Information is subject to change without notice, at developer's absolute discretion. 4. Actual area may vary from the stated area. 5. Drawing are not to scale. 6. All images used are for illustrative purpose only and do not represent the actual size, features, specifications, fittings and furnishings. 7. The developer reserves the right to make revisions/ alterations, at its absolute discretion, without any liability whatsoever.

3 BEDROOM APARTMENT

TYPE E (with maid room + yard) VARIANT 1

TOTAL SALEABLE AREA

SUITE = 1,642.57 SQ.FT.

YARD = 539.66 SQ.FT.

TOTAL = 2,182.23 SQ.FT.

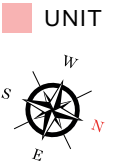
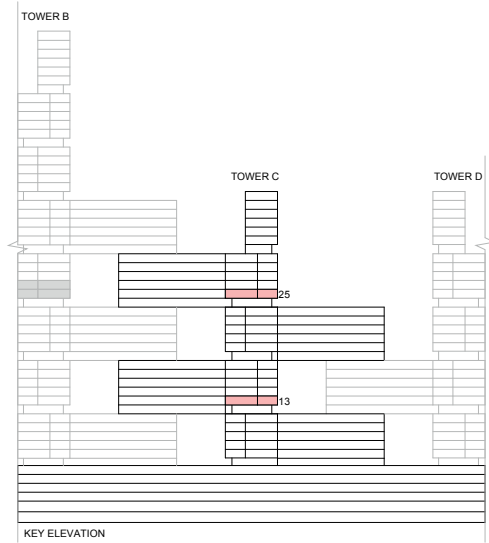

List of unit numbers with this unit plan:

VIEWS

Downtown, Ras Al Khor, Creek, Golf Course, Water body, Amenities
C1303

Downtown, Ras Al Khor, Creek, Golf Course, Water body
C2503

Disclaimer: 1. All dimensions are in metric, measured to wall finishes. 2. All materials, dimensions & drawings are approximate. 3. Information is subject to change without notice, at developer's absolute discretion. 4. Actual area may vary from the stated area. 5. Drawing are not to scale. 6. All images used are for illustrative purpose only and do not represent the actual size, features, specifications, fittings and furnishings. 7. The developer reserves the right to make revisions/ alterations, at its absolute discretion, without any liability whatsoever.

3 BEDROOM APARTMENT

TYPE E (with maid room + yard) VARIANT 1

TOTAL SALEABLE AREA

SUITE = 1,642.57 SQ.FT.

YARD = 539.66 SQ.FT.

TOTAL = 2,182.23 SQ.FT.

 UNIT

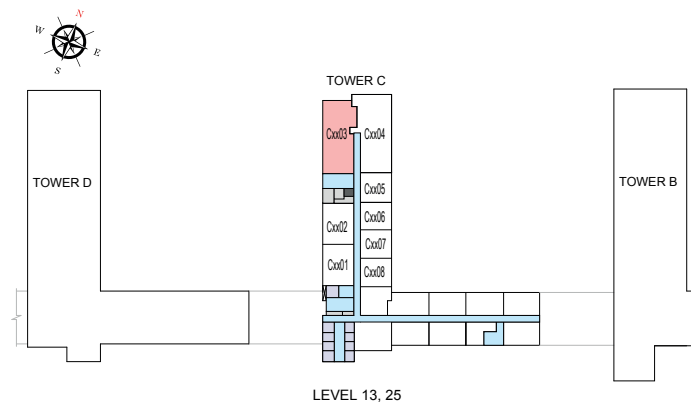

List of unit numbers with this unit plan:

VIEWS

Downtown, Ras Al Khor, Creek, Golf Course, Water body, Amenities
C1303

Downtown, Ras Al Khor, Creek, Golf Course, Water body
C2503

Disclaimer: 1. All dimensions are in metric, measured to wall finishes. 2. All materials, dimensions & drawings are approximate. 3. Information is subject to change without notice, at developer's absolute discretion. 4. Actual area may vary from the stated area. 5. Drawing are not to scale. 6. All images used are for illustrative purpose only and do not represent the actual size, features, specifications, fittings and furnishings. 7. The developer reserves the right to make revisions/ alterations, at its absolute discretion, without any liability whatsoever.

4 BEDROOM APARTMENT

TYPE A (with store room, maid room and powder room + balcony)

TOTAL SALEABLE AREA

SUITE = 2,080.88 SQ.FT.

BALCONY = 196.34 SQ.FT.

TOTAL = 2,277.22 SQ.FT.

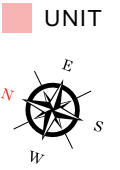
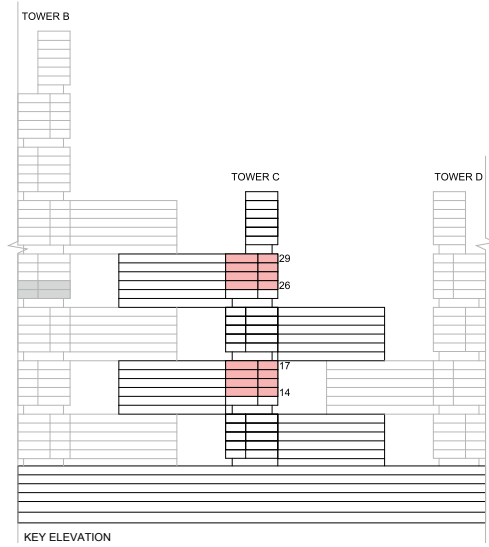

List of unit numbers with this unit plan:

VIEWS

Downtown, Ras Al Khor, Creek, Golf Course, Water body, Amenities
C1404, C1504, C1604, C1704

Downtown, Ras Al Khor, Creek, Golf Course, Water body
C2604, C2704, C2804, C2904

Disclaimer: 1. All dimensions are in metric, measured to wall finishes. 2. All materials, dimensions & drawings are approximate. 3. Information is subject to change without notice, at developer's absolute discretion. 4. Actual area may vary from the stated area. 5. Drawing are not to scale. 6. All images used are for illustrative purpose only and do not represent the actual size, features, specifications, fittings and furnishings. 7. The developer reserves the right to make revisions/ alterations, at its absolute discretion, without any liability whatsoever.

4 BEDROOM APARTMENT

TYPE A (with store room, maid room and powder room + balcony)

TOTAL SALEABLE AREA

SUITE = 2,080.88 SQ.FT.

BALCONY = 196.34 SQ.FT.

TOTAL = 2,277.22 SQ.FT.

■ UNIT

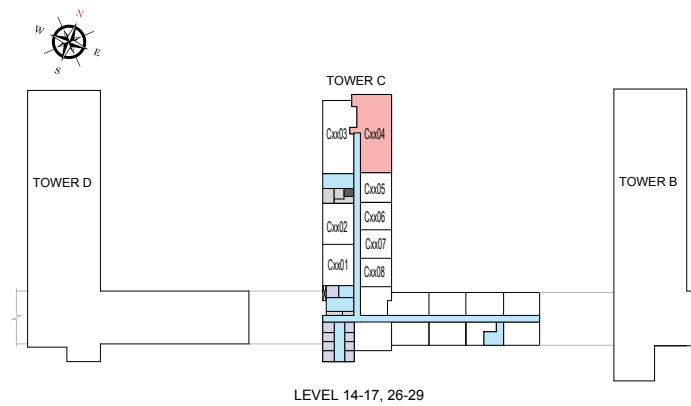

List of unit numbers with this unit plan:

VIEWS

Downtown, Ras Al Khor, Creek, Golf Course, Water body, Amenities

C1404, C1504, C1604, C1704

Downtown, Ras Al Khor, Creek, Golf Course, Water body

C2604, C2704, C2804, C2904

Disclaimer: 1. All dimensions are in metric, measured to wall finishes. 2. All materials, dimensions & drawings are approximate. 3. Information is subject to change without notice, at developer's absolute discretion. 4. Actual area may vary from the stated area. 5. Drawing are not to scale. 6. All images used are for illustrative purpose only and do not represent the actual size, features, specifications, fittings and furnishings. 7. The developer reserves the right to make revisions/ alterations, at its absolute discretion, without any liability whatsoever.

4 BEDROOM APARTMENT

TYPE A (with store room, maid room and powder room + balcony) VARIANT 1

TOTAL SALEABLE AREA

SUITE = 2,080.88 SQ.FT.

BALCONY = 196.34 SQ.FT.

TOTAL = 2,277.22 SQ.FT.

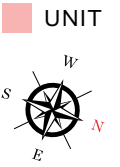
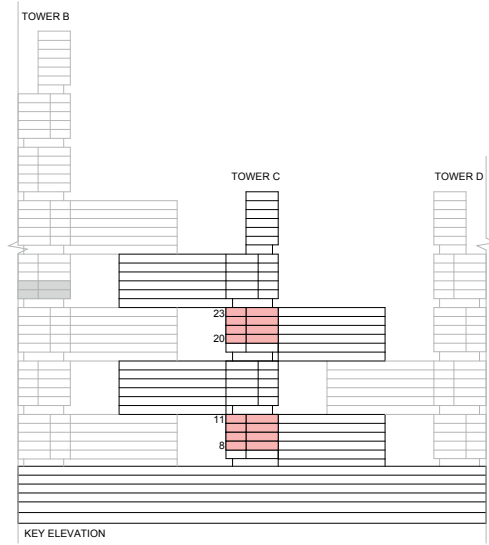

List of unit numbers with this unit plan:

VIEWS

Downtown, Ras Al Khor, Creek, Golf Course, Water body, Amenities
C803, C903, C1003, C1103, C2003, C2103, C2203, C2303

Disclaimer: 1. All dimensions are in metric, measured to wall finishes. 2. All materials, dimensions & drawings are approximate. 3. Information is subject to change without notice, at developer's absolute discretion. 4. Actual area may vary from the stated area. 5. Drawing are not to scale. 6. All images used are for illustrative purpose only and do not represent the actual size, features, specifications, fittings and furnishings. 7. The developer reserves the right to make revisions/ alterations, at its absolute discretion, without any liability whatsoever.

4 BEDROOM APARTMENT

TYPE A (with store room, maid room and powder room + balcony) VARIANT 1

TOTAL SALEABLE AREA

SUITE = 2,080.88 SQ.FT.

BALCONY = 196.34 SQ.FT.

TOTAL = 2,277.22 SQ.FT.

 UNIT

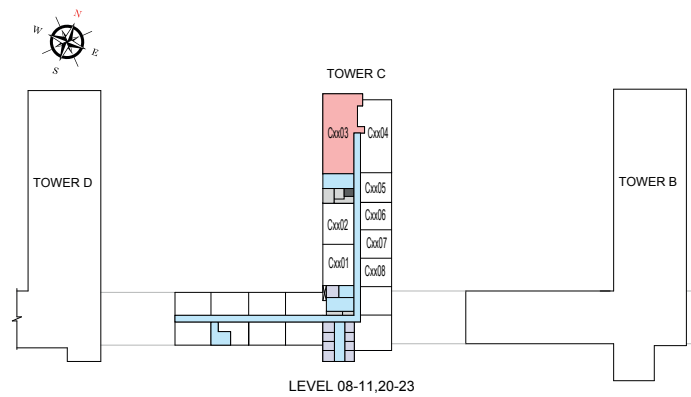

List of unit numbers with this unit plan:

VIEWS

Downtown, Ras Al Khor, Creek, Golf Course, Water body, Amenities

C803, C903, C1003, C1103, C2003, C2103, C2203, C2303

Disclaimer: 1. All dimensions are in metric, measured to wall finishes. 2. All materials, dimensions & drawings are approximate. 3. Information is subject to change without notice, at developer's absolute discretion. 4. Actual area may vary from the stated area. 5. Drawing are not to scale. 6. All images used are for illustrative purpose only and do not represent the actual size, features, specifications, fittings and furnishings. 7. The developer reserves the right to make revisions/ alterations, at its absolute discretion, without any liability whatsoever.

4 BEDROOM APARTMENT

TYPE B (with store room, maid room and powder room + balcony)

TOTAL SALEABLE AREA

SUITE = 2,084.43 SQ.FT.

BALCONY = 477.92 SQ.FT.

TOTAL = 2,562.35 SQ.FT.

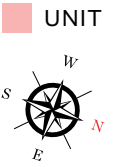
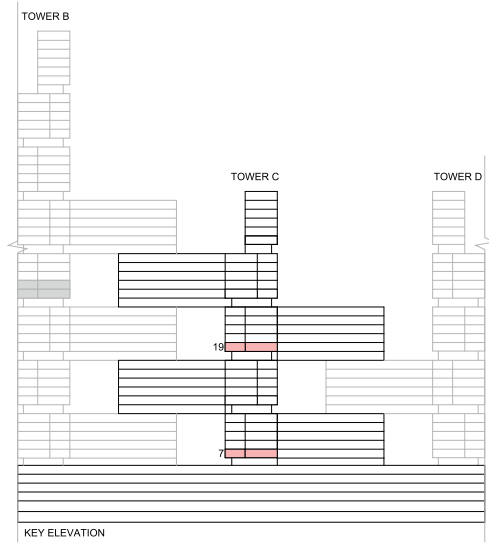

List of unit numbers with this unit plan:

VIEWS

Downtown, Ras Al Khor, Creek, Golf Course, Amenities
C703

Downtown, Ras Al Khor, Creek, Golf Course, Water body, Amenities
C1903

Disclaimer: 1. All dimensions are in metric, measured to wall finishes. 2. All materials, dimensions & drawings are approximate. 3. Information is subject to change without notice, at developer's absolute discretion. 4. Actual area may vary from the stated area. 5. Drawing are not to scale. 6. All images used are for illustrative purpose only and do not represent the actual size, features, specifications, fittings and furnishings. 7. The developer reserves the right to make revisions/ alterations, at its absolute discretion, without any liability whatsoever.

4 BEDROOM APARTMENT

TYPE B (with store room, maid room and powder room + balcony)

TOTAL SALEABLE AREA

SUITE = 2,084.43 SQ.FT.

BALCONY = 477.92 SQ.FT.

TOTAL = 2,562.35 SQ.FT.

UNIT

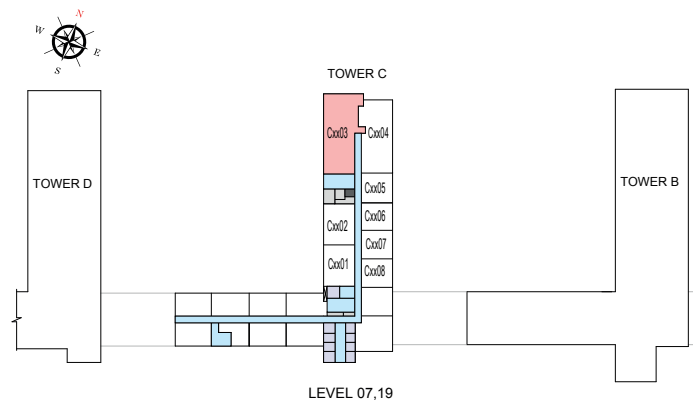

List of unit numbers with this unit plan:

VIEWS

Downtown, Ras Al Khor, Creek, Golf Course, Amenities

C703

Downtown, Ras Al Khor, Creek, Golf Course, Water body, Amenities

C1903

Disclaimer: 1. All dimensions are in metric, measured to wall finishes. 2. All materials, dimensions & drawings are approximate. 3. Information is subject to change without notice, at developer's absolute discretion. 4. Actual area may vary from the stated area. 5. Drawing are not to scale. 6. All images used are for illustrative purpose only and do not represent the actual size, features, specifications, fittings and furnishings. 7. The developer reserves the right to make revisions/ alterations, at its absolute discretion, without any liability whatsoever.

4 BEDROOM APARTMENT

TYPE B (with store room, maid room and powder room + balcony) VARIANT 1

TOTAL SALEABLE AREA

SUITE = 2,084.43 SQ.FT.

BALCONY = 477.92 SQ.FT.

TOTAL = 2,562.35 SQ.FT.

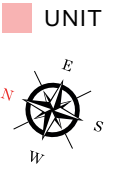
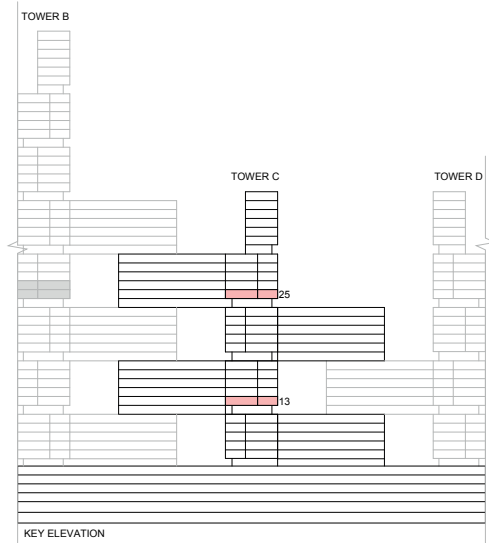

List of unit numbers with this unit plan:

VIEWS

Downtown, Ras Al Khor, Creek, Golf Course, Water body, Amenities
C1304

Downtown, Ras Al Khor, Creek, Golf Course, Amenities
C2504

Disclaimer: 1. All dimensions are in metric, measured to wall finishes. 2. All materials, dimensions & drawings are approximate. 3. Information is subject to change without notice, at developer's absolute discretion. 4. Actual area may vary from the stated area. 5. Drawing are not to scale. 6. All images used are for illustrative purpose only and do not represent the actual size, features, specifications, fittings and furnishings. 7. The developer reserves the right to make revisions/ alterations, at its absolute discretion, without any liability whatsoever.

4 BEDROOM APARTMENT

TYPE B (with store room, maid room and powder room + balcony) VARIANT 1

TOTAL SALEABLE AREA

SUITE = 2,084.43 SQ.FT.

BALCONY = 477.92 SQ.FT.

TOTAL = 2,562.35 SQ.FT.

UNIT

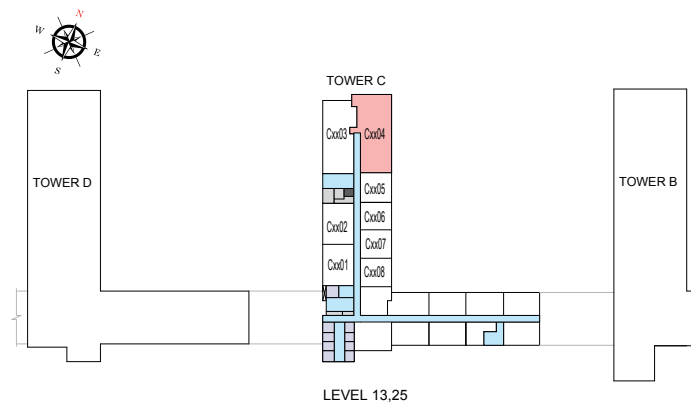

List of unit numbers with this unit plan:

VIEWS

Downtown, Ras Al Khor, Creek, Golf Course, Water body, Amenities
C1304

Downtown, Ras Al Khor, Creek, Golf Course, Amenities
C2504

Disclaimer: 1. All dimensions are in metric, measured to wall finishes. 2. All materials, dimensions & drawings are approximate. 3. Information is subject to change without notice, at developer's absolute discretion. 4. Actual area may vary from the stated area. 5. Drawing are not to scale. 6. All images used are for illustrative purpose only and do not represent the actual size, features, specifications, fittings and furnishings. 7. The developer reserves the right to make revisions/ alterations, at its absolute discretion, without any liability whatsoever.



SOBHA ONE

SOBHA
REALTY