

VISION
PLATINUM
LIWAN DUBAI

Landline: +971 4 549 0477 - WhatsApp: +971 58 661 4910
www.visiondevelopments.ae

VISION
PLATINUM
LIWAN DUBAI

V



MESSAGE FROM CEO

“We chose to create spaces that families would truly appreciate living in. Our approach prioritizes generous space reminiscent of our ancestors' dwellings, yet infused with the modern sophistication of today.

Vision is more than just a company; it represents innovation, unwavering commitment, and Emirati excellence. Through our vertically integrated real estate development platform, our legacy extends beyond mere bricks and mortar. It is crafted from visionary concepts, meticulous planning, and flawless execution.”



Inception
in Year
2011



dynamic Team
of over 700
Professionals



56
Projects
Delivered



4.5 Billion
Sq Footage
delivered



INVESTING IN DUBAI'S VISION 2040

Investing in Dubai presents a compelling proposition for discerning investors and prospective residents alike. Renowned for its unmatched safety, competitive property prices, and vibrant economy, Dubai stands as a beacon of opportunity in the global landscape. With a reputation for high capital appreciation and a business-friendly environment make it first in the region for ease of doing business, Dubai offers a conducive platform for entrepreneurial endeavors and investment growth. Moreover, the absence of personal income tax, coupled with the allure of long-term residency through the Golden Visa program, adds to its appeal as a destination of choice. Strategically positioned as a global business hub with seamless worldwide connectivity, Dubai offers a lifestyle enriched by world-class amenities and cultural diversity. Embrace the promise of a prosperous future and elevate your standard of living by investing in the dynamic and vibrant city of Dubai.



INVESTING IN PLATINUM

Allows you to obtain
two years renewable
residence permit



TAX

No income
Tax



100% BUSINESS OWNERSHIP

Applicable for
all commercial
companies



EASE OF
INVESTMENT
High Regulated
Market



POPULATION GROWTH

Dubai's Vision
2040 aiming
for 5.8M



GREEN

Green and
Recreational Space
will double in size





WHERE ELEGANCE MEETS INNOVATION

Step into Dubai's realm of unmatched elegance and sophistication, where life's every aspect is perfected. Beyond expectations, the city dazzles with its opulence and commitment to excellence, offering pristine beaches, world-class facilities, and leisure escapes that define modern luxury living. Embrace a lifestyle where the extraordinary is standard, with every turn revealing marvels.

Dubai, home to wonders like the Burj Khalifa and the lavish Dubai Mall, is a symbol of innovation and splendor. Experience a vibrant nightlife, a rich arts and music scene, and diverse lifestyle pursuits designed for the discerning. From thrilling adventures to high-end shopping, Dubai presents an unrivaled spectrum of experiences. Join us in celebrating luxury living in Dubai, where elegance and refinement are in every moment.



WHY RENT WHEN YOU CAN OWN

Investing in your own property with Vision Developments not only saves you from the uncertainties and incremental costs of renting but also contributes to your financial growth through property appreciation. It's a step towards securing a stable and prosperous future. We would be glad to discuss how we can make this investment work for you, considering your financial goals and preferences.

By partnering with Vision Developments, you're not just acquiring a property; you're investing in a tangible asset that holds the potential for long-term wealth accumulation and financial security.



LOCATION

Liwan, located in the lively area of Dubai, is the perfect example of modern city living. It provides a great mix of easy access and good transport links for its residents. Right where Mohammed bin Zayed Road E311 and Dubai Al Ain Road E66 meet, Liwan is well-placed for getting to important places in the city quickly and easily. With its well-built infrastructure and careful design, Liwan shows Dubai Properties' dedication to high standards and commitment to excellence.

EASY ACCESS TO PLACES

DUBAI INTERNATIONAL AIRPORT	20 MINS	GLOBAL VILLAGE	10 MINS	DUBAI MALL & BURJ KHALIFA	18 MINS
AL MAKTUUM INTERNATIONAL AIRPORT	25 MINS	MIRACLE GARDEN	18 MINS	OUTLET MALL	08 MINS

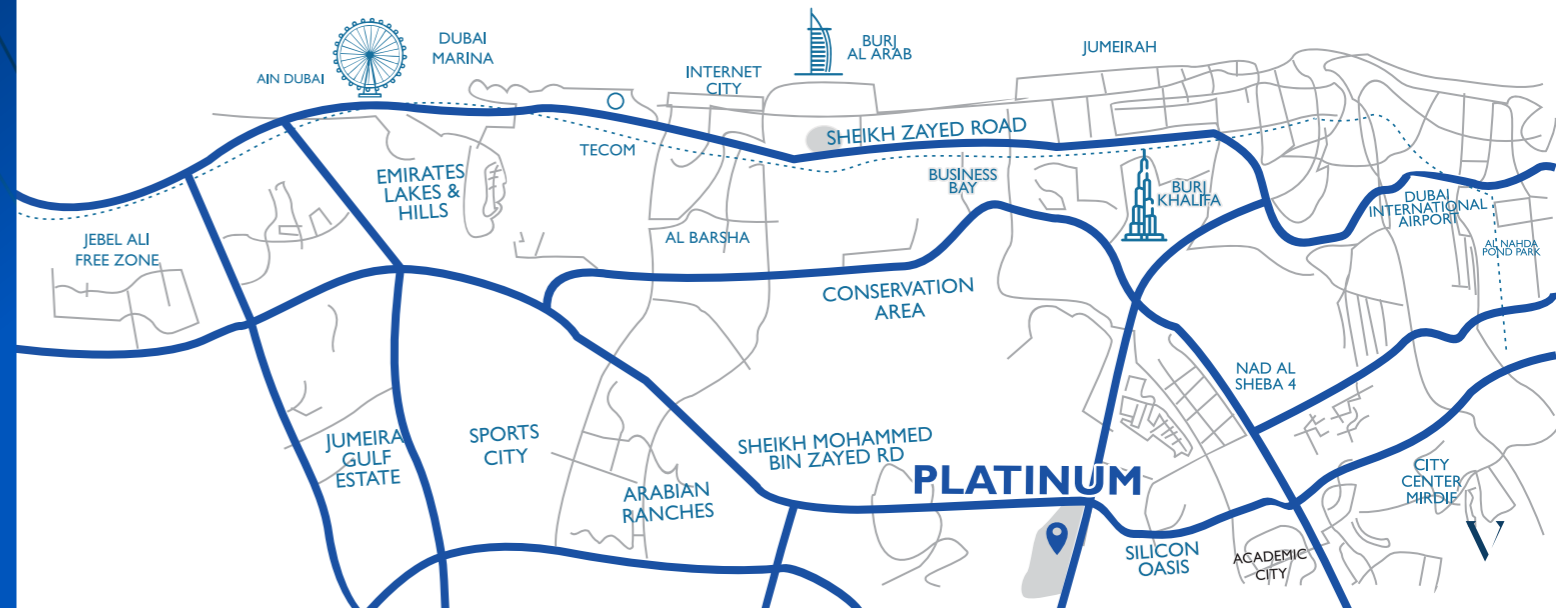



COMMUNITY CONNECTIONS
NURTURING YOUNG MINDS,
ELEVATING SPIRITS

FAMILY BLISS IN THE HEART OF DUBAI

Nestled within the vibrant heart of Dubai, Liwan embraces families with open arms, offering a modern urban lifestyle wrapped in warmth and convenience. Designed with meticulous attention to detail, Liwan presents a haven where families can thrive and create lasting memories. Imagine strolling along a scenic walking trail circling the serene manmade lake, while your children play joyfully in the specially designed kinder play area.

For sports enthusiasts, Liwan boasts a well-equipped Football ground and Basketball court where family games and friendly matches can be enjoyed. Cycling enthusiasts will relish the dedicated cycling track, perfect for leisurely rides or invigorating workouts. Embrace the serenity of Liwan's beautifully crafted outdoor spaces, where luxury and comfort harmonize to create an idyllic environment for families. Discover the joy of living in a community where every day is an adventure, filled with laughter, exploration, and the warmth of family bonds.

Scenic Walking Trail

Discover tranquility along our scenic walking trail, encircling a serene manmade lake.

Football Ground

Fuel your passion for football at our well-equipped ground, perfect for friendly matches and family games.

Basketball Court

Shoot some hoops and enjoy active family time at our vibrant basketball court.

Kids Play Area

Let your little ones unleash their energy and imagination at our specially designed kinder play area.

Cycling Track

Pedal your way to fitness and leisure along our dedicated cycling track, offering scenic views and invigorating rides."

DISCOVER YOUR NEW HOME





YOUR GATEWAY TO AN ENRICHED LIFESTYLE

Thank you for joining us on this journey through Liwan's exceptional amenities. Every aspect of our community is designed to enhance your lifestyle, the joy of outdoor activities, and the warmth of family bonds within Liwan. We invite you to experience the perfect blend of comfort, convenience, and community in the heart of Dubai. Welcome to Liwan, where every day is an opportunity to create cherished memories and live life to the fullest.



WELCOME TO PLATINUM

WE BUILD COMMUNITIES

OTHERS BUILD TO SELL

Welcome to Platinum, where every corner invites you to explore the essence of vibrant lifestyle. With modern amenities seamlessly integrated into the community, experience a harmonious blend of comfort and convenience. Embrace the opportunity to live, thrive, and indulge in the true essence of Dubai at Platinum.



INTRODUCING PLATINUM BY VISION

Step into Platinum, where every corner invites you to explore a world of enriching experiences. Here, modern amenities blend seamlessly with a warm, family-centric atmosphere. Enjoy a harmonious balance of comfort and convenience, where every corner welcomes you to discover new delights. Find a place where treasured memories are made, vibrant living meets unparalleled tranquility. Welcome to Platinum, your gateway to a life of joy

Discover a place where luxury meets practicality, offering a lifestyle that caters to your every need and elevates your everyday experiences.

LIVING AT THE PINNACLE
OF EXCELLENCE



TRANSFORMING SPACES, INSPIRING LIVES



YOUR SPACE MATTERS

SPACE IS WHAT WE NEED IN TODAY'S CONGESTED LIFE



“Studies indicate that spacious living environments positively impact health by providing more natural light, improving air quality, and offering space for physical activity, which enhances mental and physical well-being

(Source: Journal of Environmental Psychology).”



Floor to ceiling windows, bringing in natural light.



High ceilings, at 3.3 meters. Our ceiling height is 20% higher than average



Our Spacious Apartments, are 22% larger than average apartments



Many units have laundry and storage rooms for extra space.



Our apartments offer 180-degree open views, enhancing your home with beauty and tranquility.





Premium Finishing At Every Step

From intricately tiled corridors to elegantly finished walls,
our commitment to premium quality shines through at every step.



AT PLATINUM, WE HAVE INSTALLED AIR QUALITY MONITORING SENSORS GOOD AIR QUALITY ENHANCE YOUR HEALTH



"Installing air quality sensors in buildings can significantly enhance resident health by continuously monitoring and managing indoor air conditions, reducing pollutants and ensuring optimal air quality
(Source: Building and Environment Journal)."

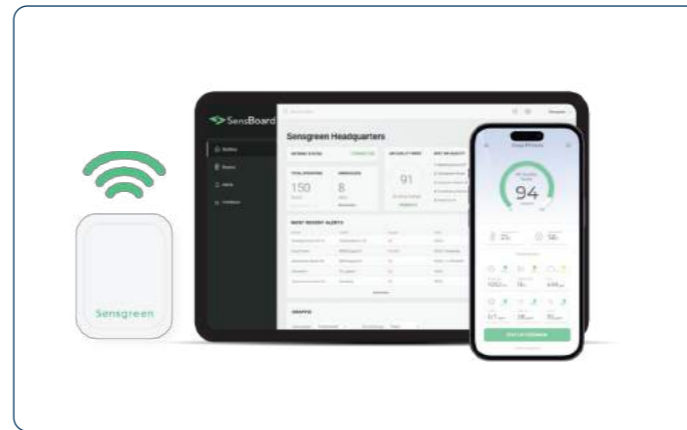

Energy Saving
15%

Boost Facility
Management
Efficiency

Reduce Absenteeism
60%

Boost Your Energy
& Concentration

Reduce Infection Risk
(Covid 19, Flu etc)

Increase Productivity
50%



ELEVATING EVERY CORNER OF YOUR LIVING SPACE

Our residences are equipped with Smart thermostats and smart door locks for automated comfort and security. You can enhance your living experience by adding other compatible Smart Home devices, allowing for a personalized and integrated smart home setup.



WE ARE WHERE YOU ARE

At Platinum, you will be able to communicate with your community and building management in various ways. You can call our toll free number, contact us via our 24/7 whatsapp line, or use the app and portal to process your requests

- Booking facilities , such as booking the gaming room for your kids birthday.
- Move in and Move outs
- Applying for work permits and NOC's
- Making your payments online
- Engaging with the community on the community wall
- Tracking your requests

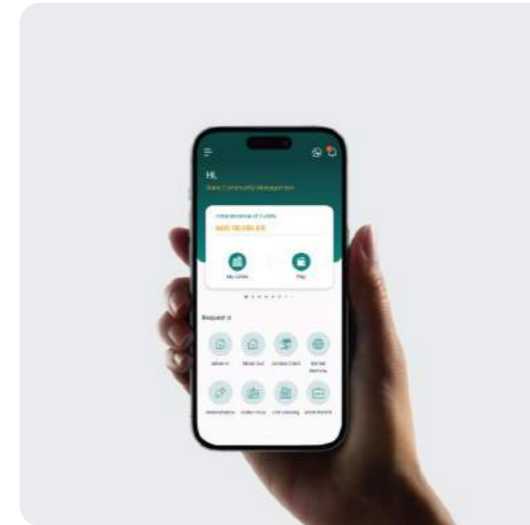

THIS IS NOT JUST A BUILDING IT'S A LIFESTYLE

CONCIERGE SERVICE

At Platinum by Vision, we understand that true luxury encompasses more than just lavish amenities; it's about personalized attention and seamless convenience. That's why our dedicated concierge team is committed to supporting and assisting all residents with their every need, ensuring a lifestyle of unparalleled comfort and ease.



ON DEMAND HOUSE KEEPING SERVICE

Experience the epitome of convenience and care with our on-demand housekeeping. Tailored for the discerning, our housekeeping ensures your home remains a pristine sanctuary.



ON DEMAND DAY CARE SERVICE

Concurrently, on demand daycare offers a nurturing environment for your little ones, blending educational activities with fun in a secure setting. Together, they symbolize our dedication to enhancing your lifestyle and peace of mind.



EMBRACE COMMUNITY LIVING AT KARMA



At Platinum, we're not just developing apartments; we're cultivating neighborhoods. We understand the value of a close-knit community for you and your family's well-being. That's why we organize engaging events throughout the year to foster connections and create lasting memories.

- UAE National Day, Eid, Christmas, Halloween, Diwali.
- Kids: Movie Nights, Halloween,
- Wellness Activities (Yoga and Gym Training)



"Research shows that kids who engage with their neighbors are 24% happier, as social interactions contribute significantly to their emotional and psychological well-being (Source: Child Development Journal).

EXCEPTIONAL FEATURES AND AMENITIES

Enjoy a life of comfort at Platinum, where each day is a treat filled with relaxation. Start your day with energy in our modern gym, and then relax by the pool, enjoying the sounds of family and fun. In the evening, take in the stunning panoramic views from our rooftop terrace, where you can unwind and appreciate the beauty around you.

With facilities like Infinity pool and a gym, you have everything you need for fun and relaxation. Our team is always here to make sure everything runs smoothly, so you can live easily and comfortably. Welcome to a daily life that's all about enjoying luxury and ease.



INFINITY
POOL



SWIMMING
POOL DECK



PERGOLA
SEATING



OUTDOOR
SHOWER



PARTY
HALL



GAMING
ROOM



24X7 SMART
SECURITY



KID'S PLAY
AREA



ROOFTOP DECK
& BBQ AREA



GYMNASIUM



MEDITATION
ROOM



CINEMA





UNLEASH YOUR POTENTIAL

Step into our state-of-the-art gym, where every workout becomes a journey towards your best self. Equipped with top-of-the-line machines and designed for ultimate comfort, our fitness oasis invites you to push your limits and achieve your wellness goals. Whether you're a beginner or a seasoned fitness enthusiast, our gym offers a holistic experience that nurtures your body, mind, and spirit.

GAMER'S HAVEN

An immersive gaming experience awaits in our state-of-the-art gaming room, equipped with the latest consoles and games for hours of entertainment.



PLAYTIME PARADISE

A vibrant and safe space filled with fun and interactive activities, designed to spark joy and creativity in children of all ages.



ZEN SANCTUARY

Find inner peace and tranquility in our dedicated meditation room, designed to provide a serene environment for mindfulness practices and quiet contemplation.



CELEBRATION CENTRAL

Host memorable events and celebrations in our spacious party hall, featuring versatile setups and amenities to make every occasion special.



GRILL & CHILL ZONE

Gather with friends and family for delightful BBQ gatherings in our outdoor area, equipped with grilling stations, seating, and a cozy ambiance.



OUTDOOR RETREAT

Escape to our tranquil pergola setting, where lush greenery, comfortable seating, and serene ambiance create the perfect spot for relaxation and reflection.

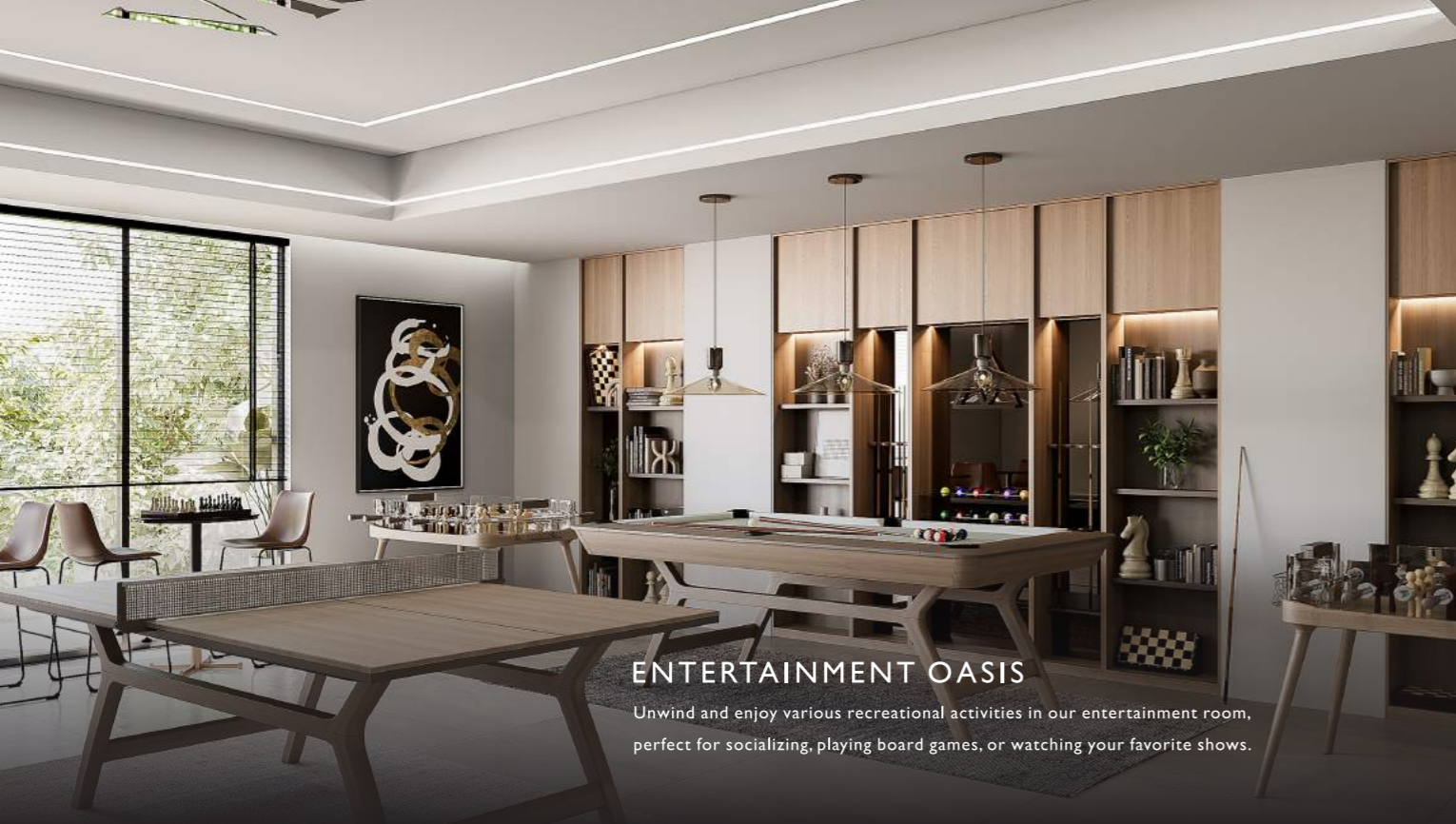

ENTERTAINMENT OASIS

Unwind and enjoy various recreational activities in our entertainment room, perfect for socializing, playing board games, or watching your favorite shows.

CINEMATIC ESCAPE

Experience the magic of cinema in our private theater, complete with plush seating and cutting-edge audiovisual technology for an unforgettable movie night.





YOUR FULLY EQUIPPED KITCHEN

Enhance your cooking experience in your fully equipped kitchen, complete with modern appliances, spacious countertops, and elegant finishes tailored to meet your needs.





*Elevating
Every Corner
of Your
Living Space*



FINISHING MATERIAL



EXTERNAL
WOODEN



INTERNAL
WOODEN



PORCELAIN
FLOORING



SMART LOCK



BATHROOM
PORCELAIN



BATHROOM
PORCELAIN

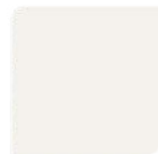

WALL PAINT



SMART AC
THERMOSTAT



TRAVERTINE
PORCELAIN



ELECTRICAL
APPLIANCES

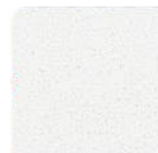

QUARTZ
COUNTERTOPS



SANITARYWARE
BAGNODESIGN

EMBRACE ELEGANCE YOUR HOME'S LUXURIOUS FINISHES

Step into a world of sophistication with our meticulously selected finishing materials. From the welcoming embrace of our External Wooden Doors to the seamless elegance of our Quartz Counter-top, every detail in your home speaks of refined taste and comfort. Revel in the warmth of Internal Wooden Doors and the sleekness of Porcelain Flooring throughout. Indulge in the luxury of "BAGNODESIGN" Sanitary-ware in your bathrooms, complemented by exquisite Bathroom Porcelain. Experience modern convenience with Smart Locks and Smart AC Thermostats, harmonizing functionality and style in every corner. Let the hues of Wall Paint reflect your personal style, completing the canvas of your dream home. Enhance your cooking experiences with top-of-the-line BOSCH Electrical Appliances, renowned for their quality and innovation, adding a touch of excellence to your kitchen.

Floor Plan 9th

Total Built Area
1281.14
Square Meter

Usable Area
868.80
Square Meter

Balcony Area
274.36
Square Meter

Service Area
233.09
Square Meter



Floor Plan Roof

Total Built Area
1281.14
Square Meter

Usable Area
121.41
Square Meter

Balcony Area
0.00
Square Meter

Service Area
654.78
Square Meter



Floor Plan Ground

Total Built Area
1293.20
Square Meter

Usable Area
22.68
Square Meter

Parking Area
902.26
Square Meter

Service Area
233.09
Square Meter



Floor Plan Typical

Total Built Area
1281.14
Square Meter

Usable Area
868.80
Square Meter

Balcony Area
274.36
Square Meter

Service Area
24.73
Square Meter



VISION
PLATINUM
 LIWAN DUBAI

UNIT - 101
 1 BEDROOM
 LEVEL-01

Internal Living Area	734.42 sq.ft.
Outdoor Living Area	230.67 sq.ft.
Total Living Area	965.09 sq.ft.



TYPICAL FLOOR PLAN
 1ST - 8TH
 FLOOR

KEY SECTION

DISCLAIMER:
 All measurements are indicative and are for marketing purposes only. All efforts have been made to ensure their accuracy, however these layouts are subject to change at the discretion of the developer and should not be relied upon as final. The actual area may vary from the stated area and the developer reserves the right to make the revisions/alterations, at its absolute discretion, without any liability whatsoever.

VISION
PLATINUM
 LIWAN DUBAI

UNIT - 102
 1 BEDROOM
 LEVEL-01

Internal Living Area	723.01 sq.ft.
Outdoor Living Area	229.49 sq.ft.
Total Living Area	952.50 sq.ft.



TYPICAL FLOOR PLAN
 1ST - 8TH
 FLOOR

KEY SECTION

DISCLAIMER:
 All measurements are indicative and are for marketing purposes only. All efforts have been made to ensure their accuracy, however these layouts are subject to change at the discretion of the developer and should not be relied upon as final. The actual area may vary from the stated area and the developer reserves the right to make the revisions/alterations, at its absolute discretion, without any liability whatsoever.



VISION
PLATINUM
 LIWAN DUBAI

UNIT - 103
 2 BEDROOM
 LEVEL-01

Internal Living Area	1258.62 sq.ft.
Outdoor Living Area	374.37 sq.ft.
Total Living Area	1632.99 sq.ft.



TYPICAL FLOOR PLAN
 1ST - 8TH
 FLOOR

KEY SECTION

DISCLAIMER:
 All measurements are indicative and are for marketing purposes only. All efforts have been made to ensure their accuracy, however these layouts are subject to change at the discretion of the developer and should not be relied upon as final. The actual area may vary from the stated area and the developer reserves the right to make the revisions/alterations, at its absolute discretion, without any liability whatsoever.

VISION
PLATINUM
 LIWAN DUBAI

UNIT - 104
 1 BEDROOM
 LEVEL-01

Internal Living Area	647.99 sq.ft.
Outdoor Living Area	207.42 sq.ft.
Total Living Area	855.41 sq.ft.



TYPICAL FLOOR PLAN
 1ST - 8TH
 FLOOR

KEY SECTION

DISCLAIMER:
 All measurements are indicative and are for marketing purposes only. All efforts have been made to ensure their accuracy, however these layouts are subject to change at the discretion of the developer and should not be relied upon as final. The actual area may vary from the stated area and the developer reserves the right to make the revisions/alterations, at its absolute discretion, without any liability whatsoever.



VISION
PLATINUM
LIWAN DUBAI

UNIT - 105
2 BEDROOM
LEVEL-01

Internal Living Area	999.89 sq.ft.
Outdoor Living Area	318.72 sq.ft.
Total Living Area	1317.61 sq.ft.



TYPICAL FLOOR PLAN
1ST - 8TH
FLOOR

KEY SECTION

DISCLAIMER:
All measurements are indicative and are for marketing purposes only. All efforts have been made to ensure their accuracy, however these layouts are subject to change at the discretion of the developer and should not be relied upon as final. The actual area may vary from the stated area and the developer reserves the right to make the revisions/alterations, at its absolute discretion, without any liability whatsoever.

VISION
PLATINUM
LIWAN DUBAI

UNIT - 106
1 BEDROOM
LEVEL-01

Internal Living Area	654.66 sq.ft.
Outdoor Living Area	190.52 sq.ft.
Total Living Area	845.18 sq.ft.



TYPICAL FLOOR PLAN
1ST - 8TH
FLOOR

KEY SECTION

DISCLAIMER:
All measurements are indicative and are for marketing purposes only. All efforts have been made to ensure their accuracy, however these layouts are subject to change at the discretion of the developer and should not be relied upon as final. The actual area may vary from the stated area and the developer reserves the right to make the revisions/alterations, at its absolute discretion, without any liability whatsoever.

VISION
PLATINUM
LIWAN DUBAI

UNIT - 107
1 BEDROOM
LEVEL-01

Internal Living Area	628.94 sq.ft.
Outdoor Living Area	201.50 sq.ft.
Total Living Area	830.44 sq.ft.

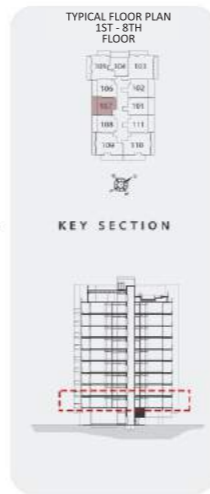

DISCLAIMER:
All measurements are indicative and are for marketing purposes only. All efforts have been made to ensure their accuracy, however these layouts are subject to change at the discretion of the developer and should not be relied upon as final. The actual area may vary from the stated area and the developer reserves the right to make the revisions/alterations, at its absolute discretion, without any liability whatsoever.

VISION
PLATINUM
LIWAN DUBAI

UNIT - 108
1 BEDROOM
LEVEL-01

Internal Living Area	643.36 sq.ft.
Outdoor Living Area	190.20 sq.ft.
Total Living Area	833.56 sq.ft.



DISCLAIMER:
All measurements are indicative and are for marketing purposes only. All efforts have been made to ensure their accuracy, however these layouts are subject to change at the discretion of the developer and should not be relied upon as final. The actual area may vary from the stated area and the developer reserves the right to make the revisions/alterations, at its absolute discretion, without any liability whatsoever.

VISION
PLATINUM
LIWAN DUBAI

UNIT - 109
2 BEDROOM
LEVEL-01

Internal Living Area	1049.80 sq.ft.
Outdoor Living Area	392.24 sq.ft.
Total Living Area	1442.04 sq.ft.



TYPICAL FLOOR PLAN
1ST - 8TH
FLOOR

KEY SECTION

DISCLAIMER:
All measurements are indicative and are for marketing purposes only. All efforts have been made to ensure their accuracy, however these layouts are subject to change at the discretion of the developer and should not be relied upon as final. The actual area may vary from the stated area and the developer reserves the right to make the revisions/alterations, at its absolute discretion, without any liability whatsoever.

VISION
PLATINUM
LIWAN DUBAI

UNIT - 110
2 BEDROOM
LEVEL-01

Internal Living Area	1130.64 sq.ft.
Outdoor Living Area	392.34 sq.ft.
Total Living Area	1522.99 sq.ft.



TYPICAL FLOOR PLAN
1ST - 8TH
FLOOR

KEY SECTION

DISCLAIMER:
All measurements are indicative and are for marketing purposes only. All efforts have been made to ensure their accuracy, however these layouts are subject to change at the discretion of the developer and should not be relied upon as final. The actual area may vary from the stated area and the developer reserves the right to make the revisions/alterations, at its absolute discretion, without any liability whatsoever.



VISION
PLATINUM
 LIWAN DUBAI

UNIT - 111
 1 BEDROOM
 LEVEL-01

Internal Living Area	723.55 sq.ft.
Outdoor Living Area	226.15 sq.ft.
Total Living Area	949.70 sq.ft.



DISCLAIMER:
 All measurements are indicative and are for marketing purposes only. All efforts have been made to ensure their accuracy, however these layouts are subject to change at the discretion of the developer and should not be relied upon as final. The actual area may vary from the stated area and the developer reserves the right to make the revisions/alterations, at its absolute discretion, without any liability whatsoever.

VISION
PLATINUM
 LIWAN DUBAI

UNIT - 901
 1 BEDROOM
 LEVEL-09

Internal Living Area	734.42 sq.ft.
Outdoor Living Area	230.67 sq.ft.
Total Living Area	965.09 sq.ft.



DISCLAIMER:
 All measurements are indicative and are for marketing purposes only. All efforts have been made to ensure their accuracy, however these layouts are subject to change at the discretion of the developer and should not be relied upon as final. The actual area may vary from the stated area and the developer reserves the right to make the revisions/alterations, at its absolute discretion, without any liability whatsoever.

VISION
PLATINUM
LIWAN DUBAI



UNIT - 902
1 BEDROOM
LEVEL-09

Internal Living Area	724.09 sq.ft.
Outdoor Living Area	229.38 sq.ft.
Total Living Area	953.47 sq.ft.

KEY PLAN

KEY SECTION

DISCLAIMER:
All measurements are indicative and are for marketing purposes only. All efforts have been made to ensure their accuracy, however these layouts are subject to change at the discretion of the developer and should not be relied upon as final. The actual area may vary from the stated area and the developer reserves the right to make the revisions/alterations, at its absolute discretion, without any liability whatsoever.

VISION
PLATINUM
LIWAN DUBAI



UPPER FLOOR

UNIT - 903
4 BEDROOM
LEVEL-09

Internal Living Area	2039.01 sq.ft.
Outdoor Living Area	374.37 sq.ft.
Total Living Area	2413.38 sq.ft.



LOWER FLOOR

KEY PLAN

KEY SECTION

DISCLAIMER:
All measurements are indicative and are for marketing purposes only. All efforts have been made to ensure their accuracy, however these layouts are subject to change at the discretion of the developer and should not be relied upon as final. The actual area may vary from the stated area and the developer reserves the right to make the revisions/alterations, at its absolute discretion, without any liability whatsoever.



VISION
PLATINUM
LIWAN DUBAI



UNIT - 904
1 BEDROOM
LEVEL-09

Internal Living Area	671.13 sq.ft.
Outdoor Living Area	207.42 sq.ft.
Total Living Area	878.55 sq.ft.



DISCLAIMER:
All measurements are indicative and are for marketing purposes only. All efforts have been made to ensure their accuracy, however these layouts are subject to change at the discretion of the developer and should not be relied upon as final. The actual area may vary from the stated area and the developer reserves the right to make the revisions/alterations, at its absolute discretion, without any liability whatsoever.

VISION
PLATINUM
LIWAN DUBAI



UPPER FLOOR

UNIT - 905
3 BEDROOM
LEVEL-09

Internal Living Area	1824.92 sq.ft.
Outdoor Living Area	318.83 sq.ft.
Total Living Area	1843.75 sq.ft.



LOWER FLOOR

DISCLAIMER:
All measurements are indicative and are for marketing purposes only. All efforts have been made to ensure their accuracy, however these layouts are subject to change at the discretion of the developer and should not be relied upon as final. The actual area may vary from the stated area and the developer reserves the right to make the revisions/alterations, at its absolute discretion, without any liability whatsoever.

VISION
PLATINUM
LIWAN DUBAI

UNIT - 906
1 BEDROOM
LEVEL-09

Internal Living Area	654.02 sq.ft.
Outdoor Living Area	190.52 sq.ft.
Total Living Area	844.54 sq.ft.



DISCLAIMER:
All measurements are indicative and are for marketing purposes only. All efforts have been made to ensure their accuracy, however these layouts are subject to change at the discretion of the developer and should not be relied upon as final. The actual area may vary from the stated area and the developer reserves the right to make the revisions/alterations, at its absolute discretion, without any liability whatsoever.

VISION
PLATINUM
LIWAN DUBAI

UNIT - 907
1 BEDROOM
LEVEL-09

Internal Living Area	628.94 sq.ft.
Outdoor Living Area	201.50 sq.ft.
Total Living Area	830.44 sq.ft.



DISCLAIMER:
All measurements are indicative and are for marketing purposes only. All efforts have been made to ensure their accuracy, however these layouts are subject to change at the discretion of the developer and should not be relied upon as final. The actual area may vary from the stated area and the developer reserves the right to make the revisions/alterations, at its absolute discretion, without any liability whatsoever.

VISION
PLATINUM
LIWAN DUBAI

UNIT - 908
1 BEDROOM
LEVEL-09

Internal Living Area	643.36 sq.ft.
Outdoor Living Area	190.20 sq.ft.
Total Living Area	833.56 sq.ft.



DISCLAIMER:
All measurements are indicative and are for marketing purposes only. All efforts have been made to ensure their accuracy, however these layouts are subject to change at the discretion of the developer and should not be relied upon as final. The actual area may vary from the stated area and the developer reserves the right to make the revisions/alterations, at its absolute discretion, without any liability whatsoever.

VISION
PLATINUM
LIWAN DUBAI

UNIT - 909
2 BEDROOM
LEVEL-09

Internal Living Area	1049.80 sq.ft.
Outdoor Living Area	392.24 sq.ft.
Total Living Area	1442.04 sq.ft.



DISCLAIMER:
All measurements are indicative and are for marketing purposes only. All efforts have been made to ensure their accuracy, however these layouts are subject to change at the discretion of the developer and should not be relied upon as final. The actual area may vary from the stated area and the developer reserves the right to make the revisions/alterations, at its absolute discretion, without any liability whatsoever.

VISION
PLATINUM
LIWAN DUBAI

UNIT - 910
2 BEDROOM
LEVEL-09

Internal Living Area	1130.64 sq.ft.
Outdoor Living Area	392.34 sq.ft.
Total Living Area	1522.99 sq.ft.



KEY PLAN

KEY SECTION

DISCLAIMER:
All measurements are indicative and are for marketing purposes only. All efforts have been made to ensure their accuracy, however these layouts are subject to change at the discretion of the developer and should not be relied upon as final. The actual area may vary from the stated area and the developer reserves the right to make the revisions/alterations, at its absolute discretion, without any liability whatsoever.

VISION
PLATINUM
LIWAN DUBAI

UNIT - 911
1 BEDROOM
LEVEL-09

Internal Living Area	723.55 sq.ft.
Outdoor Living Area	226.15 sq.ft.
Total Living Area	949.70 sq.ft.



KEY PLAN

KEY SECTION

DISCLAIMER:
All measurements are indicative and are for marketing purposes only. All efforts have been made to ensure their accuracy, however these layouts are subject to change at the discretion of the developer and should not be relied upon as final. The actual area may vary from the stated area and the developer reserves the right to make the revisions/alterations, at its absolute discretion, without any liability whatsoever.