



GARDENS PARK



LIVE THE LIFE YOU DESERVE



BAHCELER / İSKELE

TYPE

AC GROUND 1

2 + 1 • GROUND FLOOR

ÖZELLİKLER / SPECIFICATIONS

- 2 Yatak Odası
- 25 Daireden Oluşan Site İçerisinde
- Ortak Kullanım Havuz
- Zemin Kat Daire
- Kişisel Giriş
- Özel Araç Parkı Alanı
- Girişte Vestiyer Dolabı
- Tüm Yatak Odalarında Aynalı Duvar Dolapları
- Geniş Teras
- Çift Cam Alüminyum
- Lüks Dekoratif Sistemler
- Yüksek Kalitede Seramik ve Parkeler
- Yüksek Kalitede Aydınlatma Ürünleri
- Yüksek Kalitede Ahşap Doğrama ve Tezgah Ürünleri
- Klima Sistemi
- Hidrofor İstasyonu
- Opsiyonel Zeminde Isıtma Sistemleri
- Opsiyonel Dekorasyon Paketi
- 2 Bedrooms
- In the Site Consisting of 25 Apartments
- Common Pool
- Ground Floor Apartment
- Private Entrance
- Private Parking Area
- Cliset Locker at the Entrance
- Fitted Wardrobes with Mirror in all Bedrooms
- Large Terrace
- Double-Glazed Aluminium
- Luxury Decorative Systems
- High Quality Ceramic and Parquet Flooring
- High Quality Lighting Products
- High Quality Wood Works and Work-top Products
- Water Pump System
- Air Conditioning Infrastructure
- Optional Floor Heating Systems
- Optional Decoration Package

EXTERIOR

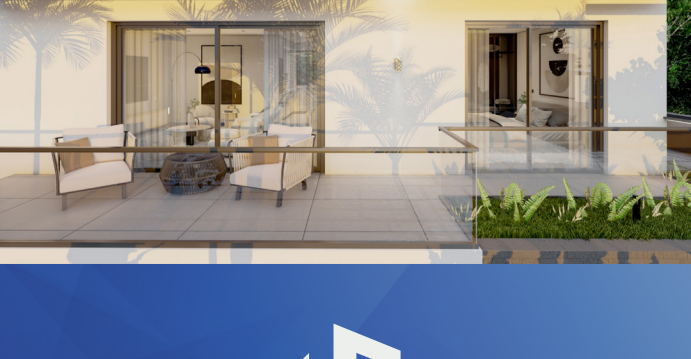

PLAN

GROUND FLOOR / ZEMİN KAT



Salon & Mutfak	40,5 m ²	Living Room & Kitchen
Koridor	4,5 m ²	Hallway
Yatak Odası-1	14 m ²	Bedroom-1
Yatak Odası-2	15 m ²	Bedroom-2
Banyo-WC	5,5 m ²	Bathroom-WC
Giriş Terası	2,5 m ²	Entrance Terrace
Teras	18 m ²	Terrace

INTERIOR

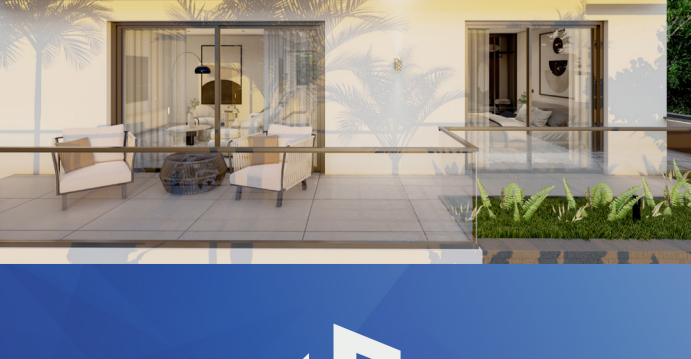

HALKEN
İNŞAAT

0392 444 48 48