



GARDENS PARK



LIVE THE LIFE YOU DESERVE



BAHCELER / ISKELE

TYPE

B GROUND

2 + 1 • GROUND FLOOR

ÖZELLİKLER / SPECIFICATIONS

- | | |
|--|---|
| 2 Yatak Odası | • 2 Bedrooms |
| 25 Daireden Oluşan Site İçerisinde | • In the Site Consisting of 25 Apartments |
| Ortak Kullanım Havuz | • Common Pool |
| Zemin Kat Daire | • Ground Floor Apartment |
| Kişisel Giriş | • Private Entrance |
| Özel Araç Park Alanı | • Private Parking Area |
| Girişte Vestiyer Dolabı | • Closet Locker at the Entrance |
| Tüm Yatak Odalarında Aynalı Duvar Dolapları | • Fitted Wardrobes with Mirror in all Bedrooms |
| Geniş Teras | • Large Terrace |
| Çift Cam Alüminyum | • Double-Glazed Aluminium |
| Lüks Dekoratif Sistemler | • Luxury Decorative Systems |
| Yüksek Kalitede Seramik ve Parkeler | • High Quality Ceramic and Parquet Flooring |
| Yüksek Kalitede Aydınlatma Ürünleri | • High Quality Lighting Products |
| Yüksek Kalitede Ahşap Doğrama ve Tezgah Ürünleri | • High Quality Wood Works and Work-top Products |
| Hidrofor Sistemi | • Water Pump System |
| Klima Altyapısı | • Air Conditioning Infrastructure |
| Opsiyonel Zeminde İstima Sistemleri | • Optional Floor Heating Systems |
| Opsiyonel Dekorasyon Paketi | • Optional Decoration Package |

EXTERIOR

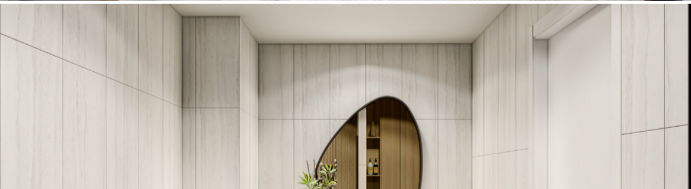
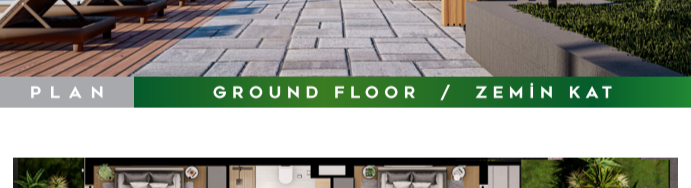
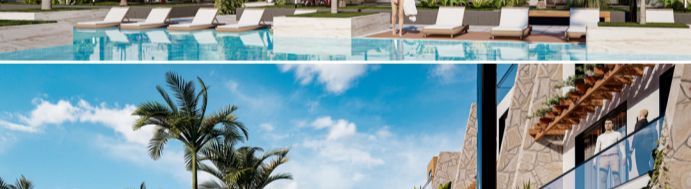
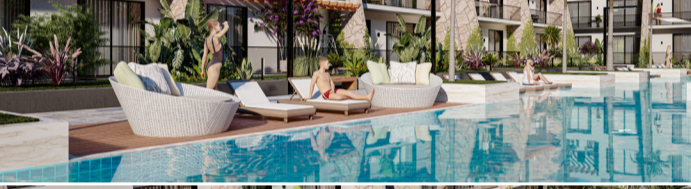

HALKEN

İNŞAAT

0 392 444 48 48