

- | | | | | | |
|-----------|----------------------------|--------------------|-----------|--------------------|--------------------|
| 1 | RESTAURANT 1 | 240 m ² | 13 | LOBBY, RECEPTION | 700 m ² |
| 2 | RECEPTION | 170 m ² | 14 | GYM | 80 m ² |
| 3 | RESTROOMS, OFFICE, STORAGE | 190 m ² | 15 | OUTDOOR SPORT ZONE | 230 m ² |
| 4 | RESTAURANT 2 | 200 m ² | 16 | PADDLE | 400 m ² |
| 5 | KITCHEN | 75 m ² | 17 | HEALTH BAR | 14 m ² |
| 6 | RESTROOMS | 20 m ² | 18 | KIDS CLUB | 100 m ² |
| 7 | BAR | 125 m ² | 19 | OUTDOOR PLAYGROUND | 80 m ² |
| 8 | SUNDESK | 445 m ² | 20 | GARDEN | 625 m ² |
| 9 | POOL | 385 m ² | 21 | GYM | 280 m ² |
| 10 | CAFE LIBRARY | 50 m ² | 22 | ROOFTOP BAR | 250 m ² |
| 11 | SPA | 350 m ² | 23 | YOGA CENTER | 285 m ² |
| 12 | RETAIL | 260 m ² | 24 | PARKING | |

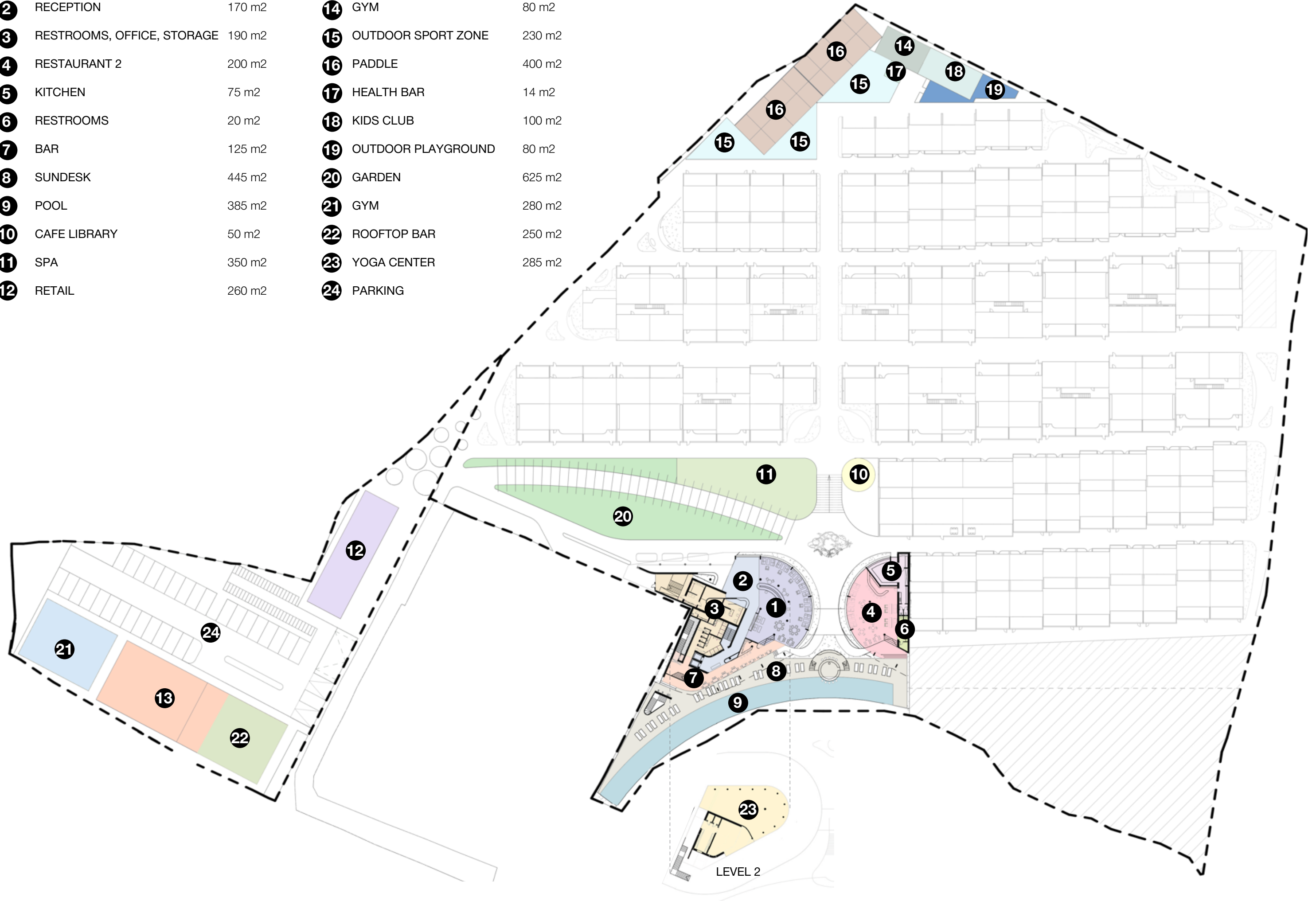

LEVEL 2