



# GALLERIA PARK RESIDENCE

Kagithane, İstanbul

---

GALLERIA PARK RESIDENCE

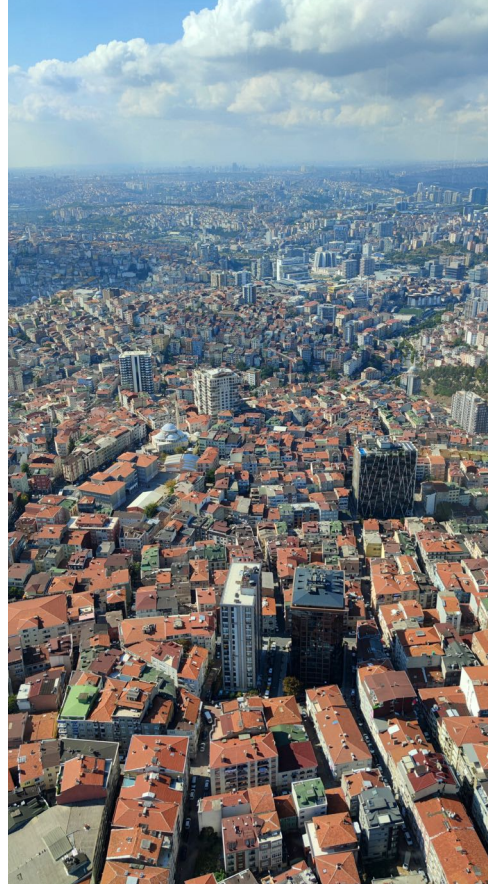
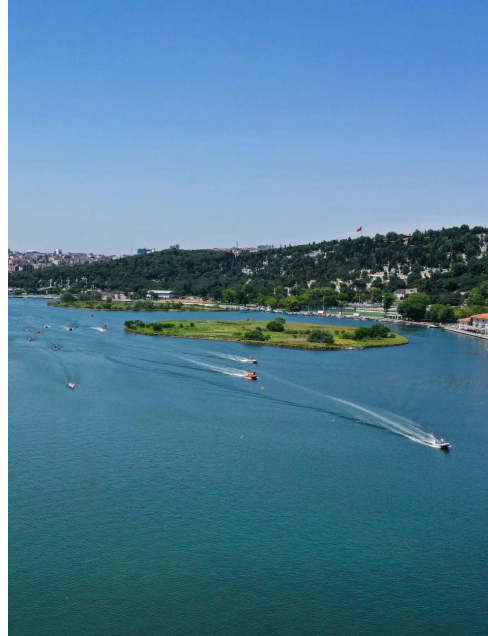

---

KAGITHANE

Kağıthane is one of the fastest developing districts of Istanbul.

It has all the possibilities of modern life. In addition to having a historical texture it is one of the rare regions that has managed to protect itself. In this city, housing needs, aesthetics and functionality are at the highest level.

# GALLERIA PARK RESIDENCE

Galleria Park Residence rising in the heart of Kağıthane region, which brings all the opportunities of city life and peace of nature to your door.

It is located in place that will allow you to live happily and also to double your earnings with a high rental income.

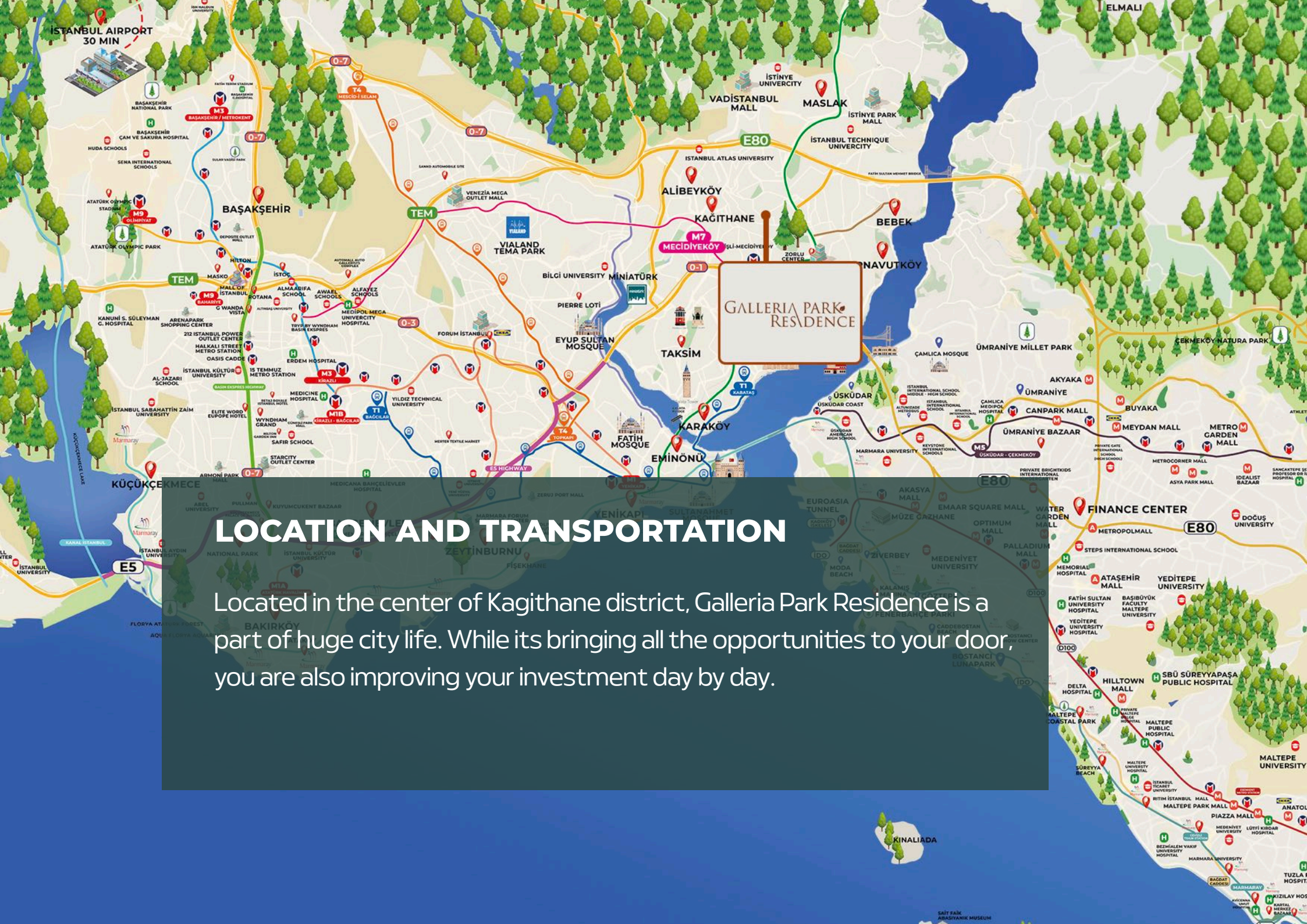

## LOCATION AND TRANSPORTATION

Located in the center of Kagithane district, Galleria Park Residence is a part of huge city life. While its bringing all the opportunities to your door, you are also improving your investment day by day.

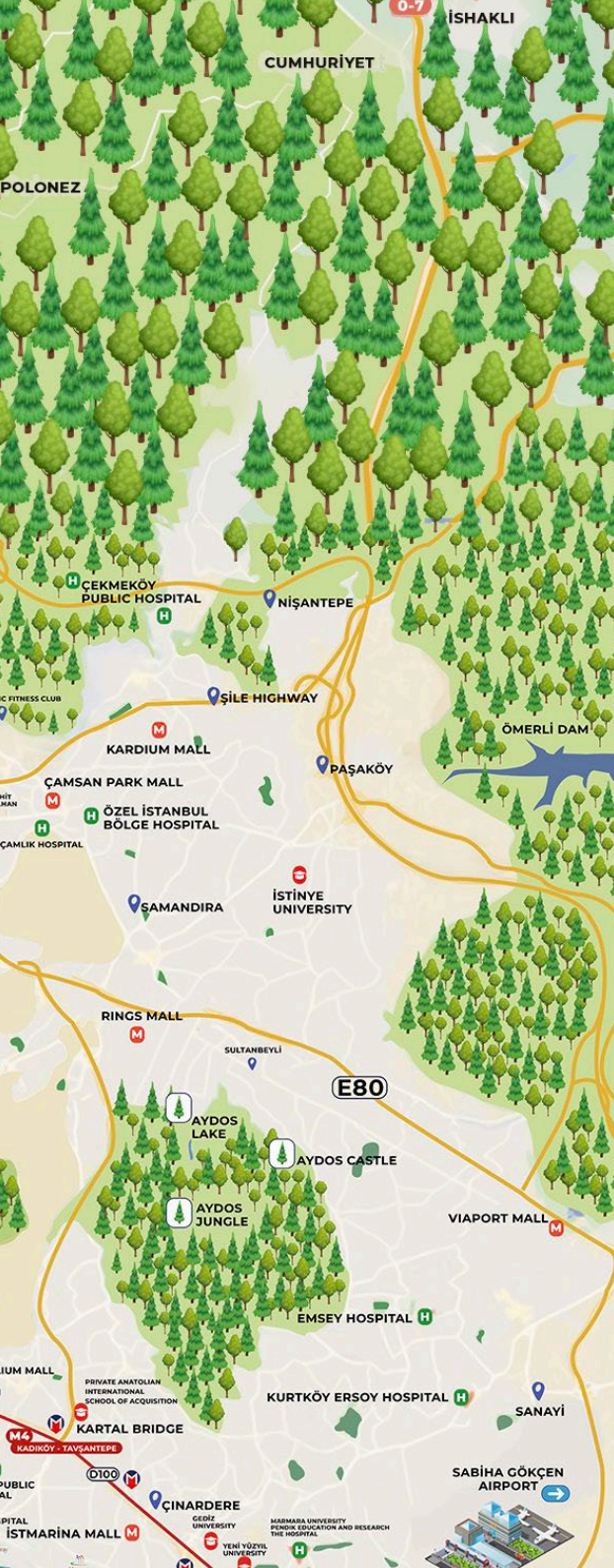

**M11 & M7 METRO**  
**1 MIN**



**AXIS MALL**  
**1 MIN**



**ERA COLLAGE**  
**1 MIN**



**MASLAK**  
**15 MIN**

Transportation line giving you opportunity to get easy and fast access to all regions of Istanbul. With this public transportation you will never late and will be always on time. 5 minutes away located 2 metro lines M7 and M11. M7 will bring you directly to the touristical center of Istanbul where you can enjoy all the attractions. M11 will provide you fast and comfortable transportation to new airport and just in 20 minutes you will be able to entre the terminal.

By close walkind distance from the Project you will find bus and minibüs stops. And 10 minutes away from Galleria Park Residence is main highway of Istanbul E5 and TEM.



**GALATASARAY**  
**STADIUM**  
**5 MIN**



**VADİ İSTANBUL**  
**MALL**  
**8 MIN**



**İSTANBUL**  
**AIRPORT**  
**25 MIN**



**UNIQ**  
**İSTANBUL**  
**10 MIN**



SKYLAND



VADİSTANBUL  
AVM



GALATASARAY  
STADYUMU



MASLAK



TRUMP TOWERS



SEBA CENTRAL



MII - M17 METRO HATTI

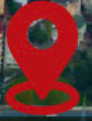

YAHYA KEMAL SPOR  
KOMPLEKSİ



AXIS AVM

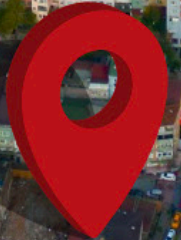

GALLERIA PARK  
RESIDENCE



ERA KOLEJİ

A woman with long dark hair is floating in a swimming pool, looking towards the right with a serene expression. The water is blue and slightly rippled. In the background, there is a stone wall with a white ledge above the pool. The overall atmosphere is calm and luxurious.

# GALLERIA PARK RESIDENCE

Galleria Park Residence located right next to **Axis AVM, Vadi Istanbul Shopping Mall, Metro, Bauhaus** etc. Everything you may need is within walking distance. Such as hospitals and pharmacies, universities and schools, shopping malls and Street malls. All the details which is necessary for your comfortable life are carefully prepared for you.

**All you have to do is enjoy your new life...**



## A UNIQUE INVESTMENT

Galleria Park Residence, the rising value of Kağıthane, brings together the needs of modern life with a luxurious and aesthetic approach.

Galleria Park Residence brings you an investment experience that always brings you profit. In the last 3 years, the property price index in the region has increased by almost 10 times.



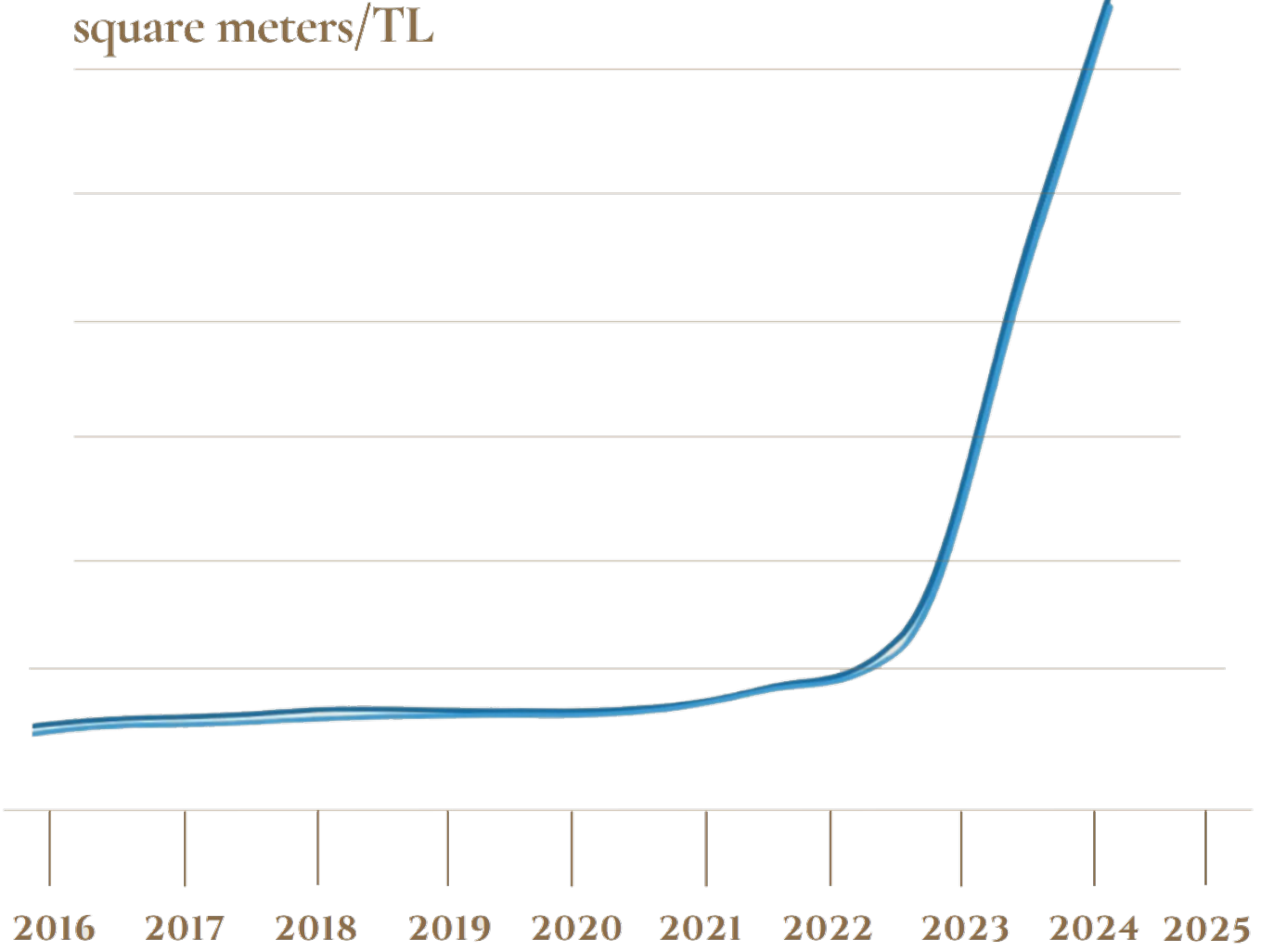

— İSTANBUL — KAĞITHANE

1 Yıl	% 27.45	▲
2 Yıl	% 60.3	▲
4 Yıl	% 120.44	▲



## ARCHITECTURAL ELEGANCE AND MODERN DESIGN

Galleria Park Residence has a structure that represents the contemporary architectural approach at its highest point.

Carefully designed modern lines and harmonious details meet in the suite living concept. Our project, where every detail has been carefully considered, offers an impressive city silhouette when viewed from the outside and promises a spacious and useful life indoors.





## LARGE AND LUXURIOUS LIVING SPACES

Galleria Park Residence attracts attention with its large living spaces that combine luxury and comfort.

Our project, with its spacious terraces and panoramic windows, allows plenty of natural light and embraces you with a breathtaking city view. In addition, the facilities offered by the project, such as the indoor swimming pool, gym and green areas, will maximize your quality of life.

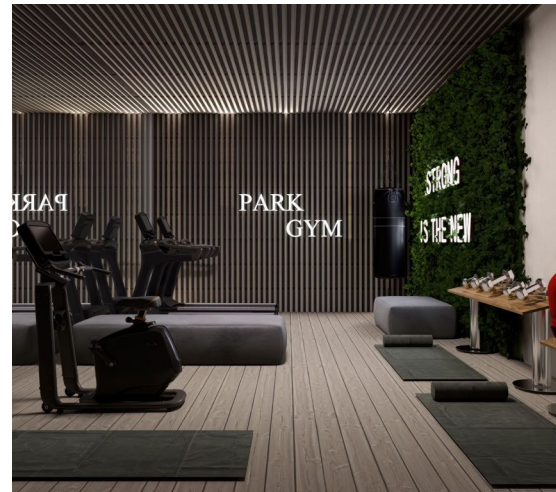
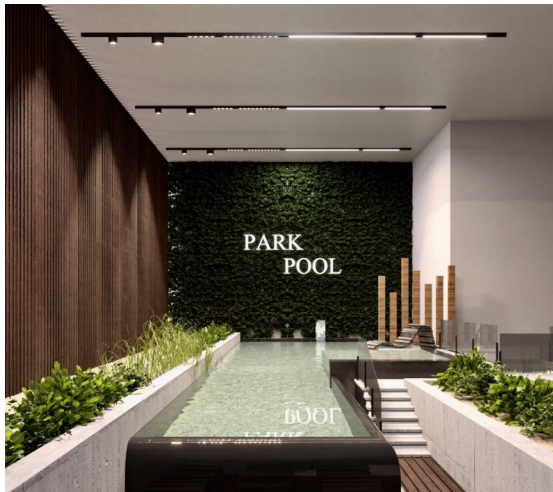

## SERVICES AND SECURITY

Galleria Park Residence is not only a residential project, but also offers a suite lifestyle.

Elements such as 24/7 security, reception services, parking lot and technological infrastructure are among the details considered for your comfort and security.



## STRONG AND SAFE PROPERTY

Galleria Park Residence is designed to ensure full compliance with earthquake regulation requirements. Our buildings are built using modern technology and engineering solutions to minimize possible risks during earthquakes. In this way, you and your loved ones can always be safe.









Galleria Park Residence



GALLERIA PARK  
RESIDENCE

---

Kagithane, İstanbul