

ذآ باي ريزيدنس

THE BAY II

RESIDENCE

FLOOR PLAN

THE BAY

RESIDENCE



BARAKA
REAL ESTATE DEVELOPMENT



BARAKA

REAL ESTATE DEVELOPMENT

FLOOR - 3 TO 10

Internal Area	407.95	Sq.ft.
Outdoor Area	93.22	Sq.ft.
Total Area	501.17	Sq.ft.

KEY PLAN

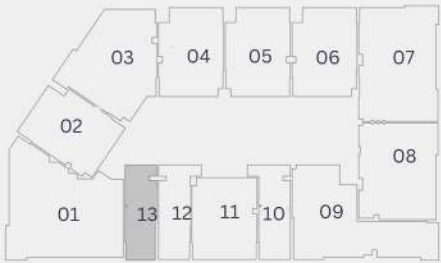

THE BAY RESIDENCE II STUDIO-TYPE A



DISCLAIMER:

All measurements are indicative and are for marketing purposes only. All efforts have been made to ensure their accuracy, however these layouts are subject to change at the discretion of the developer and should not be relied upon as final. The actual area may vary from the stated area and the developer reserves the right to make the revisions/alterations, at its absolute discretion, without any liability whatsoever



BARAKA

REAL ESTATE DEVELOPMENT

THE BAY RESIDENCE II STUDIO-TYPE B

FLOOR - 3 TO 10

Internal Area	435.29	Sq.ft.
Outdoor Area	90.52	Sq.ft.
Total Area	525.82	Sq.ft.

KEY PLAN

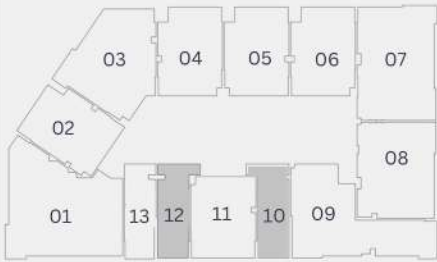

DISCLAIMER:

All measurements are indicative and are for marketing purposes only. All efforts have been made to ensure their accuracy, however these layouts are subject to change at the discretion of the developer and should not be relied upon as final. The actual area may vary from the stated area and the developer reserves the right to make the revisions/alterations, at its absolute discretion, without any liability whatsoever



BARAKA

REAL ESTATE DEVELOPMENT

THE BAY RESIDENCE II 1 BED-TYPE A

FLOOR - 2

Internal Area	747.02	Sq.ft.
Outdoor Area	471.46	Sq.ft.
Total Area	1,218.47	Sq.ft.

KEY PLAN

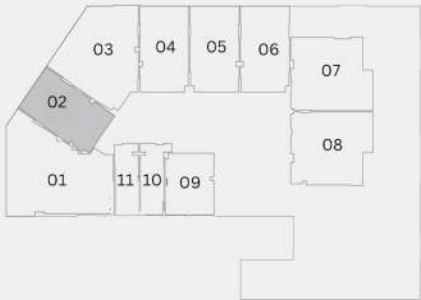

DISCLAIMER:

All measurements are indicative and are for marketing purposes only. All efforts have been made to ensure their accuracy, however these layouts are subject to change at the discretion of the developer and should not be relied upon as final. The actual area may vary from the stated area and the developer reserves the right to make the revisions/alterations, at its absolute discretion, without any liability whatsoever



BARAKA

REAL ESTATE DEVELOPMENT

THE BAY RESIDENCE II 1 BED-TYPE B

FLOOR - 3 TO 10

Internal Area	747.02	Sq.ft.
Outdoor Area	180.19	Sq.ft.
Total Area	927.20	Sq.ft.

KEY PLAN

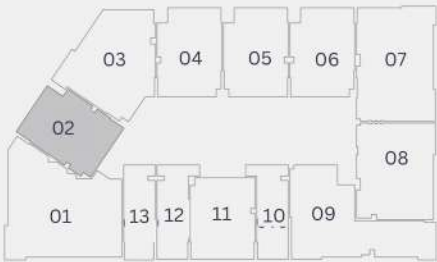

DISCLAIMER:

All measurements are indicative and are for marketing purposes only. All efforts have been made to ensure their accuracy, however these layouts are subject to change at the discretion of the developer and should not be relied upon as final. The actual area may vary from the stated area and the developer reserves the right to make the revisions/alterations, at its absolute discretion, without any liability whatsoever



BARAKA

REAL ESTATE DEVELOPMENT

FLOOR - 2

Internal Area	786.30	Sq.ft.
Outdoor Area	458.87	Sq.ft.
Total Area	1,245.17	Sq.ft.

KEY PLAN

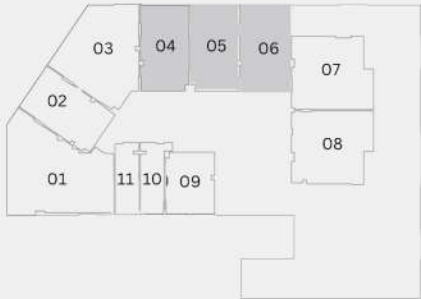

DISCLAIMER:

All measurements are indicative and are for marketing purposes only. All efforts have been made to ensure their accuracy, however these layouts are subject to change at the discretion of the developer and should not be relied upon as final. The actual area may vary from the stated area and the developer reserves the right to make the revisions/alterations, at its absolute discretion, without any liability whatsoever



BARAKA

REAL ESTATE DEVELOPMENT

THE BAY RESIDENCE II 1 BED-TYPE D

FLOOR - 3 TO 10

Internal Area	785.44	Sq.ft.
Outdoor Area	157.37	Sq.ft.
Total Area	942.81	Sq.ft.

KEY PLAN

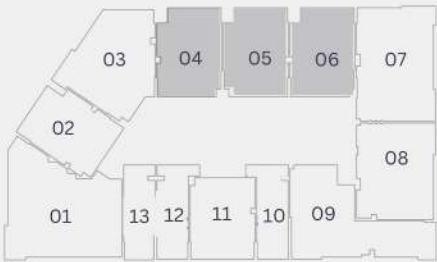

DISCLAIMER:

All measurements are indicative and are for marketing purposes only. All efforts have been made to ensure their accuracy, however these layouts are subject to change at the discretion of the developer and should not be relied upon as final. The actual area may vary from the stated area and the developer reserves the right to make the revisions/alterations, at its absolute discretion, without any liability whatsoever.



BARAKA

REAL ESTATE DEVELOPMENT

FLOOR - 3 TO 10

Internal Area	709.02	Sq.ft.
Outdoor Area	185.68	Sq.ft.
Total Area	894.70	Sq.ft.

KEY PLAN

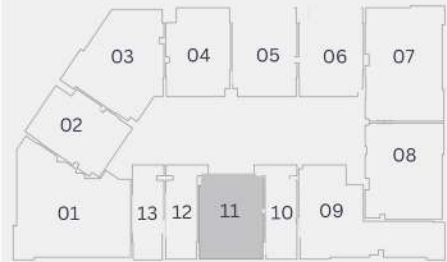

THE BAY RESIDENCE II 1 BED-TYPE E



DISCLAIMER:

All measurements are indicative and are for marketing purposes only. All efforts have been made to ensure their accuracy, however these layouts are subject to change at the discretion of the developer and should not be relied upon as final. The actual area may vary from the stated area and the developer reserves the right to make the revisions/alterations, at its absolute discretion, without any liability whatsoever



BARAKA

REAL ESTATE DEVELOPMENT

THE BAY RESIDENCE II 2 BED-TYPE A

FLOOR - 2

Internal Area	1,210.51	Sq.ft.
Outdoor Area	786.20	Sq.ft.
Total Area	1,996.71	Sq.ft.

KEY PLAN

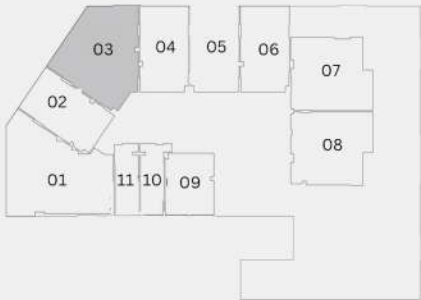

DISCLAIMER:

All measurements are indicative and are for marketing purposes only. All efforts have been made to ensure their accuracy, however these layouts are subject to change at the discretion of the developer and should not be relied upon as final. The actual area may vary from the stated area and the developer reserves the right to make the revisions/alterations, at its absolute discretion, without any liability whatsoever



BARAKA

REAL ESTATE DEVELOPMENT

THE BAY RESIDENCE II 2 BED-TYPE B

FLOOR - 3 TO 10

Internal Area	1,207.06	Sq.ft.
Outdoor Area	113.45	Sq.ft.
Total Area	1,320.52	Sq.ft.

KEY PLAN

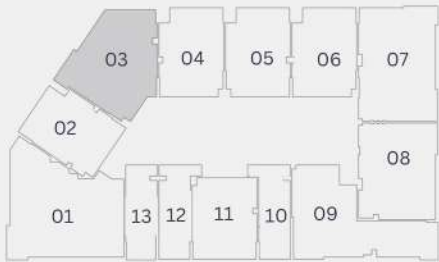

DISCLAIMER:

All measurements are indicative and are for marketing purposes only. All efforts have been made to ensure their accuracy, however these layouts are subject to change at the discretion of the developer and should not be relied upon as final. The actual area may vary from the stated area and the developer reserves the right to make the revisions/alterations, at its absolute discretion, without any liability whatsoever



BARAKA

REAL ESTATE DEVELOPMENT

THE BAY RESIDENCE II 2 BED-TYPE C

FLOOR - 2

Internal Area	1,154.64	Sq.ft.
Outdoor Area	522.26	Sq.ft.
Total Area	1,676.91	Sq.ft.

KEY PLAN

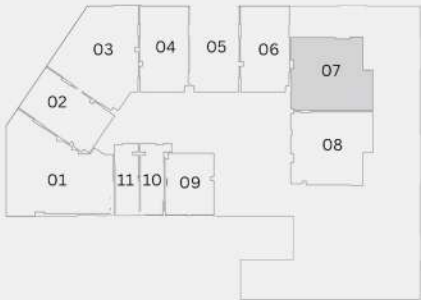

DISCLAIMER:

All measurements are indicative and are for marketing purposes only. All efforts have been made to ensure their accuracy, however these layouts are subject to change at the discretion of the developer and should not be relied upon as final. The actual area may vary from the stated area and the developer reserves the right to make the revisions/alterations, at its absolute discretion, without any liability whatsoever



BARAKA

REAL ESTATE DEVELOPMENT

THE BAY RESIDENCE II 2 BED-TYPE D

FLOOR - 3 TO 10

Internal Area	1,151.74	Sq.ft.
Outdoor Area	361.56	Sq.ft.
Total Area	1,513.30	Sq.ft.

KEY PLAN

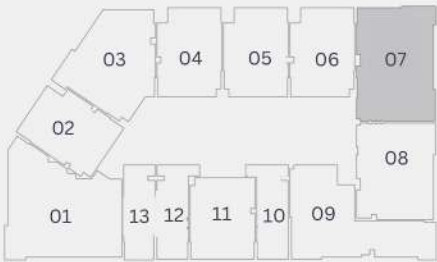

DISCLAIMER:

All measurements are indicative and are for marketing purposes only. All efforts have been made to ensure their accuracy, however these layouts are subject to change at the discretion of the developer and should not be relied upon as final. The actual area may vary from the stated area and the developer reserves the right to make the revisions/alterations, at its absolute discretion, without any liability whatsoever



BARAKA

REAL ESTATE DEVELOPMENT

THE BAY RESIDENCE II 2 BED-TYPE E

FLOOR - 2

Internal Area	1,155.40	Sq.ft.
Outdoor Area	522.91	Sq.ft.
Total Area	1,678.31	Sq.ft.

KEY PLAN

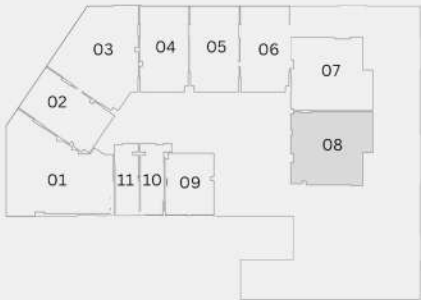

DISCLAIMER:

All measurements are indicative and are for marketing purposes only. All efforts have been made to ensure their accuracy, however these layouts are subject to change at the discretion of the developer and should not be relied upon as final. The actual area may vary from the stated area and the developer reserves the right to make the revisions/alterations, at its absolute discretion, without any liability whatsoever



BARAKA

REAL ESTATE DEVELOPMENT

THE BAY RESIDENCE II 2 BED-TYPE F

FLOOR - 3 TO 10

Internal Area	1,156.58	Sq.ft.
Outdoor Area	110.65	Sq.ft.
Total Area	1,267.24	Sq.ft.

KEY PLAN

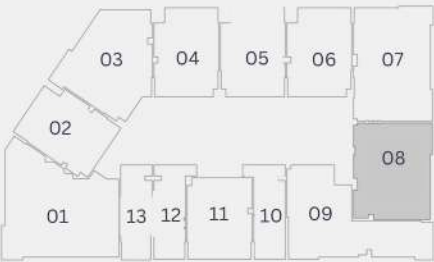

DISCLAIMER:

All measurements are indicative and are for marketing purposes only. All efforts have been made to ensure their accuracy, however these layouts are subject to change at the discretion of the developer and should not be relied upon as final. The actual area may vary from the stated area and the developer reserves the right to make the revisions/alterations, at its absolute discretion, without any liability whatsoever



BARAKA

REAL ESTATE DEVELOPMENT

THE BAY RESIDENCE II 2 BED-TYPE G

FLOOR - 3 TO 10

Internal Area	1,247.21	Sq.ft.
Outdoor Area	205.91	Sq.ft.
Total Area	1,453.13	Sq.ft.

KEY PLAN

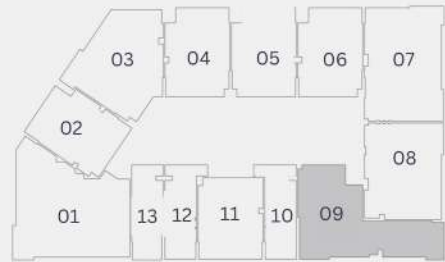

DISCLAIMER:

All measurements are indicative and are for marketing purposes only. All efforts have been made to ensure their accuracy, however these layouts are subject to change at the discretion of the developer and should not be relied upon as final. The actual area may vary from the stated area and the developer reserves the right to make the revisions/alterations, at its absolute discretion, without any liability whatsoever



BARAKA

REAL ESTATE DEVELOPMENT

THE BAY RESIDENCE II 3 BED-TYPE A

FLOOR - 2

Internal Area	1,708.23	Sq.ft.
Outdoor Area	766.61	Sq.ft.
Total Area	2,474.84	Sq.ft.

KEY PLAN

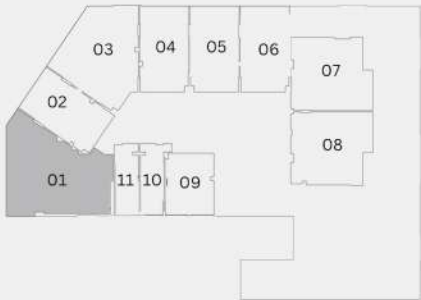

DISCLAIMER:

All measurements are indicative and are for marketing purposes only. All efforts have been made to ensure their accuracy, however these layouts are subject to change at the discretion of the developer and should not be relied upon as final. The actual area may vary from the stated area and the developer reserves the right to make the revisions/alterations, at its absolute discretion, without any liability whatsoever



BARAKA

REAL ESTATE DEVELOPMENT

THE BAY RESIDENCE II 3 BED-TYPE B

FLOOR - 3 TO 10

Internal Area	1,709.09	Sq.ft.
Outdoor Area	139.61	Sq.ft.
Total Area	1,848.70	Sq.ft.

KEY PLAN

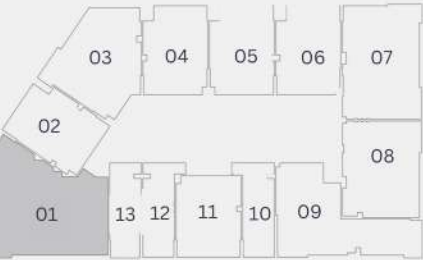

DISCLAIMER:

All measurements are indicative and are for marketing purposes only. All efforts have been made to ensure their accuracy, however these layouts are subject to change at the discretion of the developer and should not be relied upon as final. The actual area may vary from the stated area and the developer reserves the right to make the revisions/alterations, at its absolute discretion, without any liability whatsoever



BARAKA

REAL ESTATE DEVELOPMENT

FLOOR - 11 & 12

Internal Area	1,550.33	Sq.ft.
Outdoor Area	198.59	Sq.ft.
Total Area	1,748.92	Sq.ft.

KEY PLAN

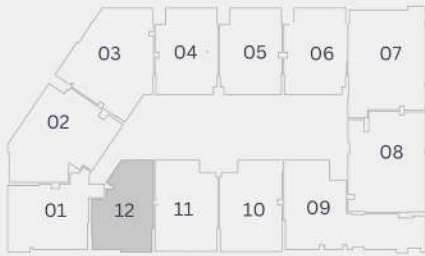

THE BAY RESIDENCE II 3 BED PH-TYPE A DUPLEX



UPPER FLOOR



LOWER FLOOR

DISCLAIMER:

All measurements are indicative and are for marketing purposes only. All efforts have been made to ensure their accuracy, however these layouts are subject to change at the discretion of the developer and should not be relied upon as final. The actual area may vary from the stated area and the developer reserves the right to make the revisions/alterations, at its absolute discretion, without any liability whatsoever



BARAKA

REAL ESTATE DEVELOPMENT

FLOOR - 11 & 12

Internal Area	1,768.62	Sq.ft.
Outdoor Area	269.85	Sq.ft.
Total Area	2,038.47	Sq.ft.

KEY PLAN

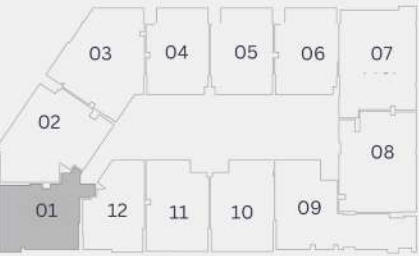

THE BAY RESIDENCE II 3 BED PH-TYPE B DUPLEX



UPPER FLOOR



LOWER FLOOR

DISCLAIMER:

All measurements are indicative and are for marketing purposes only. All efforts have been made to ensure their accuracy, however these layouts are subject to change at the discretion of the developer and should not be relied upon as final. The actual area may vary from the stated area and the developer reserves the right to make the revisions/alterations, at its absolute discretion, without any liability whatsoever



BARAKA

REAL ESTATE DEVELOPMENT

THE BAY RESIDENCE II 3 BED PH-TYPE C DUPLEX

FLOOR - 11 & 12

Internal Area	2,249.44	Sq.ft.
Outdoor Area	500.52	Sq.ft.
Total Area	2,749.96	Sq.ft.

KEY PLAN

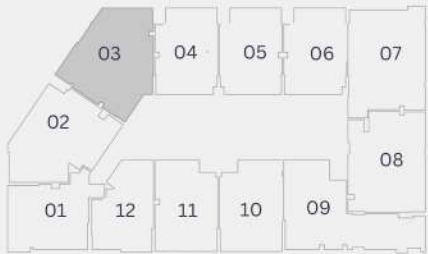

UPPER FLOOR



LOWER FLOOR

DISCLAIMER:

All measurements are indicative and are for marketing purposes only. All efforts have been made to ensure their accuracy, however these layouts are subject to change at the discretion of the developer and should not be relied upon as final. The actual area may vary from the stated area and the developer reserves the right to make the revisions/alterations, at its absolute discretion, without any liability whatsoever



BARAKA

REAL ESTATE DEVELOPMENT

FLOOR - 11 & 12

Internal Area	1,672.82	Sq.ft.
Outdoor Area	345.09	Sq.ft.
Total Area	2,017.91	Sq.ft.

KEY PLAN

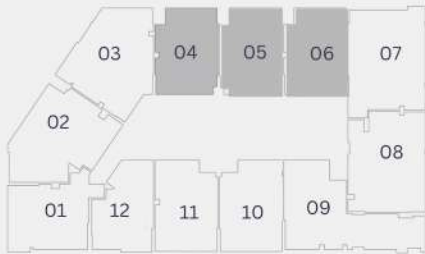

THE BAY RESIDENCE II 3 BED PH-TYPE D DUPLEX



UPPER FLOOR



LOWER FLOOR

DISCLAIMER:

All measurements are indicative and are for marketing purposes only. All efforts have been made to ensure their accuracy, however these layouts are subject to change at the discretion of the developer and should not be relied upon as final. The actual area may vary from the stated area and the developer reserves the right to make the revisions/alterations, at its absolute discretion, without any liability whatsoever



BARAKA

REAL ESTATE DEVELOPMENT

THE BAY RESIDENCE II 3 BED PH-TYPE E DUPLEX

FLOOR - 11 & 12

Internal Area	1,574.44	Sq.ft.
Outdoor Area	374.91	Sq.ft.
Total Area	1,949.34	Sq.ft.

KEY PLAN

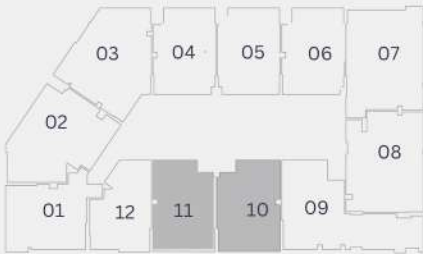

UPPER FLOOR



LOWER FLOOR

DISCLAIMER:

All measurements are indicative and are for marketing purposes only. All efforts have been made to ensure their accuracy, however these layouts are subject to change at the discretion of the developer and should not be relied upon as final. The actual area may vary from the stated area and the developer reserves the right to make the revisions/alterations, at its absolute discretion, without any liability whatsoever



BARAKA

REAL ESTATE DEVELOPMENT

THE BAY RESIDENCE II 4 BED PH-TYPE A DUPLEX

FLOOR - 11 & 12

Internal Area	2,082.71	Sq.ft.
Outdoor Area	592.45	Sq.ft.
Total Area	2,675.15	Sq.ft.

KEY PLAN

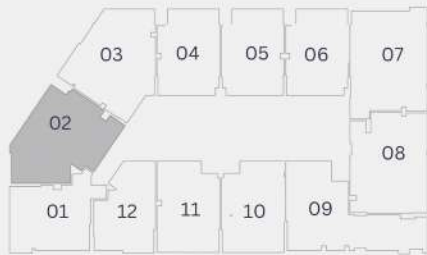

UPPER FLOOR



LOWER FLOOR

DISCLAIMER:

All measurements are indicative and are for marketing purposes only. All efforts have been made to ensure their accuracy, however these layouts are subject to change at the discretion of the developer and should not be relied upon as final. The actual area may vary from the stated area and the developer reserves the right to make the revisions/alterations, at its absolute discretion, without any liability whatsoever



BARAKA

REAL ESTATE DEVELOPMENT

FLOOR - 11 & 12

Internal Area	2,068.29	Sq.ft.
Outdoor Area	728.72	Sq.ft.
Total Area	2,797.00	Sq.ft.

KEY PLAN

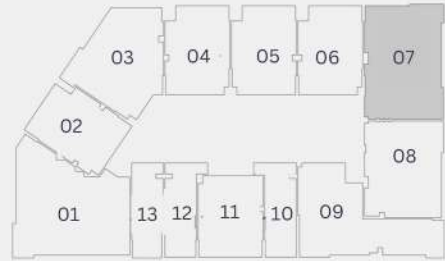

THE BAY RESIDENCE II 4 BED PH-TYPE B DUPLEX



UPPER FLOOR



LOWER FLOOR

DISCLAIMER:

All measurements are indicative and are for marketing purposes only. All efforts have been made to ensure their accuracy, however these layouts are subject to change at the discretion of the developer and should not be relied upon as final. The actual area may vary from the stated area and the developer reserves the right to make the revisions/alterations, at its absolute discretion, without any liability whatsoever



BARAKA

REAL ESTATE DEVELOPMENT

FLOOR - 11 & 12

Internal Area	2,115.75	Sq.ft.
Outdoor Area	704.50	Sq.ft.
Total Area	2,820.25	Sq.ft.

KEY PLAN

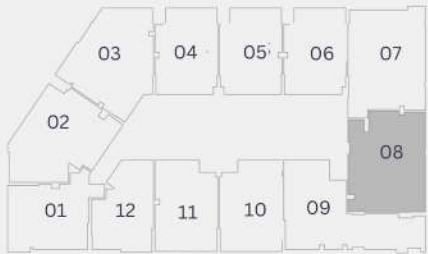

THE BAY RESIDENCE II 4 BED PH-TYPE C DUPLEX



UPPER FLOOR



LOWER FLOOR

DISCLAIMER:

All measurements are indicative and are for marketing purposes only. All efforts have been made to ensure their accuracy, however these layouts are subject to change at the discretion of the developer and should not be relied upon as final. The actual area may vary from the stated area and the developer reserves the right to make the revisions/alterations, at its absolute discretion, without any liability whatsoever



BARAKA

REAL ESTATE DEVELOPMENT

THE BAY RESIDENCE II 4 BED PH-TYPE D DUPLEX

FLOOR - 11 & 12

Internal Area	2,478.39	Sq.ft.
Outdoor Area	381.04	Sq.ft.
Total Area	2,859.43	Sq.ft.

KEY PLAN

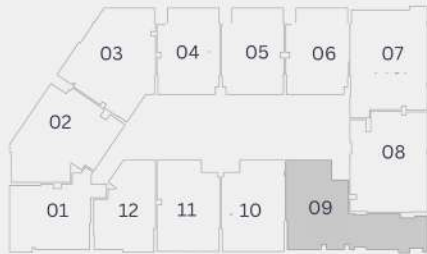

UPPER FLOOR



LOWER FLOOR

DISCLAIMER:

All measurements are indicative and are for marketing purposes only. All efforts have been made to ensure their accuracy, however these layouts are subject to change at the discretion of the developer and should not be relied upon as final. The actual area may vary from the stated area and the developer reserves the right to make the revisions/alterations, at its absolute discretion, without any liability whatsoever



BARAKA

REAL ESTATE DEVELOPMENT

THE BAY RESIDENCE II 3 BED TH-TYPE A DUPLEX

GROUND FLOOR

Internal Area	2,277.54	Sq.ft.
Outdoor Area	742.29	Sq.ft.
Total Area	3,019.83	Sq.ft.

KEY PLAN

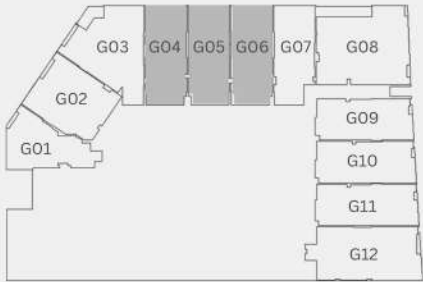

UPPER FLOOR



LOWER FLOOR

DISCLAIMER:

All measurements are indicative and are for marketing purposes only. All efforts have been made to ensure their accuracy, however these layouts are subject to change at the discretion of the developer and should not be relied upon as final. The actual area may vary from the stated area and the developer reserves the right to make the revisions/alterations, at its absolute discretion, without any liability whatsoever



BARAKA

REAL ESTATE DEVELOPMENT

THE BAY RESIDENCE II 3 BED TH-TYPE B DUPLEX

GROUND FLOOR

Internal Area	2,117.48	Sq.ft.
Outdoor Area	744.00	Sq.ft.
Total Area	2,861.48	Sq.ft.

KEY PLAN

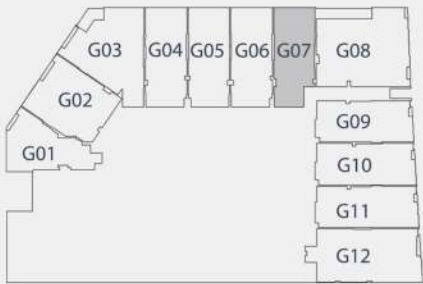

UPPER FLOOR



LOWER FLOOR

DISCLAIMER:

All measurements are indicative and are for marketing purposes only. All efforts have been made to ensure their accuracy, however these layouts are subject to change at the discretion of the developer and should not be relied upon as final. The actual area may vary from the stated area and the developer reserves the right to make the revisions/alterations, at its absolute discretion, without any liability whatsoever



BARAKA

REAL ESTATE DEVELOPMENT

THE BAY RESIDENCE II 3 BED TH-TYPE C DUPLEX

GROUND FLOOR

Internal Area	2,099.18	Sq.ft.
Outdoor Area	898.14	Sq.ft.
Total Area	2,997.32	Sq.ft.

KEY PLAN

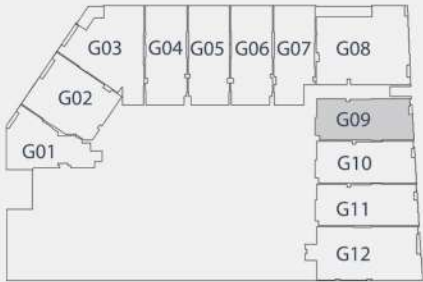

UPPER FLOOR



LOWER FLOOR

DISCLAIMER:

All measurements are indicative and are for marketing purposes only. All efforts have been made to ensure their accuracy, however these layouts are subject to change at the discretion of the developer and should not be relied upon as final. The actual area may vary from the stated area and the developer reserves the right to make the revisions/alterations, at its absolute discretion, without any liability whatsoever



BARAKA

REAL ESTATE DEVELOPMENT

THE BAY RESIDENCE II 3 BED TH-TYPE D DUPLEX

GROUND FLOOR

Internal Area	2,168.61	Sq.ft.
Outdoor Area	768.65	Sq.ft.
Total Area	2,937.26	Sq.ft.

KEY PLAN

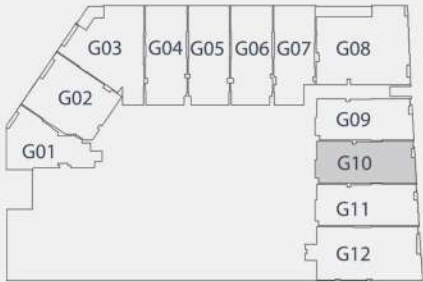

UPPER FLOOR



LOWER FLOOR

DISCLAIMER:

All measurements are indicative and are for marketing purposes only. All efforts have been made to ensure their accuracy, however these layouts are subject to change at the discretion of the developer and should not be relied upon as final. The actual area may vary from the stated area and the developer reserves the right to make the revisions/alterations, at its absolute discretion, without any liability whatsoever



BARAKA

REAL ESTATE DEVELOPMENT

THE BAY RESIDENCE II 3 BED TH-TYPE E DUPLEX

GROUND FLOOR

Internal Area	1,995.31	Sq.ft.
Outdoor Area	988.02	Sq.ft.
Total Area	2,983.33	Sq.ft.

KEY PLAN

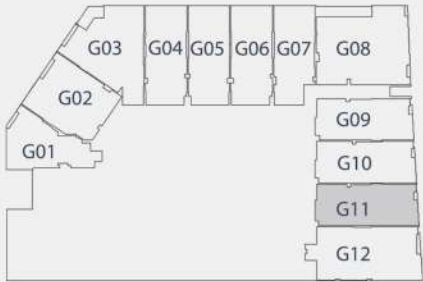

UPPER FLOOR



LOWER FLOOR

DISCLAIMER:

All measurements are indicative and are for marketing purposes only. All efforts have been made to ensure their accuracy, however these layouts are subject to change at the discretion of the developer and should not be relied upon as final. The actual area may vary from the stated area and the developer reserves the right to make the revisions/alterations, at its absolute discretion, without any liability whatsoever



BARAKA

REAL ESTATE DEVELOPMENT

GROUND FLOOR

Internal Area	2,513.91	Sq.ft.
Outdoor Area	980.70	Sq.ft.
Total Area	3,494.61	Sq.ft.

KEY PLAN

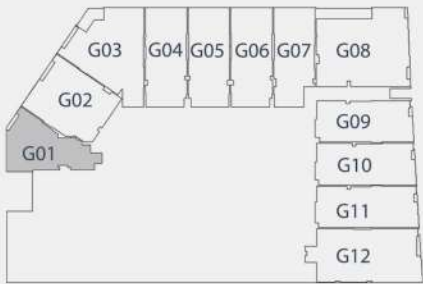

THE BAY RESIDENCE II 4 BED TH-TYPE A DUPLEX



UPPER FLOOR



LOWER FLOOR

DISCLAIMER:

All measurements are indicative and are for marketing purposes only. All efforts have been made to ensure their accuracy, however these layouts are subject to change at the discretion of the developer and should not be relied upon as final. The actual area may vary from the stated area and the developer reserves the right to make the revisions/alterations, at its absolute discretion, without any liability whatsoever



BARAKA

REAL ESTATE DEVELOPMENT

GROUND FLOOR

Internal Area	2,364.08	Sq.ft.
Outdoor Area	1,039.47	Sq.ft.
Total Area	3,403.55	Sq.ft.

KEY PLAN

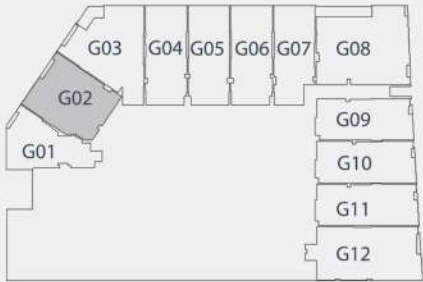

THE BAY RESIDENCE II 4 BED TH-TYPE B DUPLEX



UPPER FLOOR



LOWER FLOOR

DISCLAIMER:

All measurements are indicative and are for marketing purposes only. All efforts have been made to ensure their accuracy, however these layouts are subject to change at the discretion of the developer and should not be relied upon as final. The actual area may vary from the stated area and the developer reserves the right to make the revisions/alterations, at its absolute discretion, without any liability whatsoever



BARAKA

REAL ESTATE DEVELOPMENT

GROUND FLOOR

Internal Area	2,334.69	Sq.ft.
Outdoor Area	1,241.40	Sq.ft.
Total Area	3,576.09	Sq.ft.

KEY PLAN

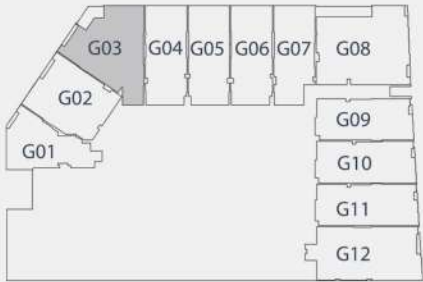

THE BAY RESIDENCE II 4 BED TH-TYPE C DUPLEX



UPPER FLOOR



LOWER FLOOR

DISCLAIMER:

All measurements are indicative and are for marketing purposes only. All efforts have been made to ensure their accuracy, however these layouts are subject to change at the discretion of the developer and should not be relied upon as final. The actual area may vary from the stated area and the developer reserves the right to make the revisions/alterations, at its absolute discretion, without any liability whatsoever



BARAKA

REAL ESTATE DEVELOPMENT

GROUND FLOOR

Internal Area	2,589.15	Sq.ft.
Outdoor Area	1,801.45	Sq.ft.
Total Area	4,390.60	Sq.ft.

KEY PLAN

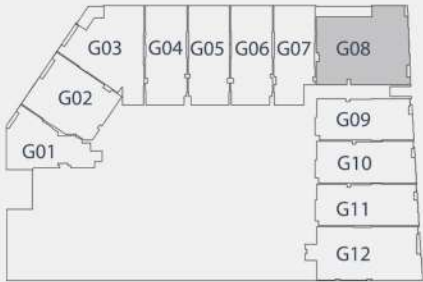

THE BAY RESIDENCE II 4 BED TH-TYPE D DUPLEX



UPPER FLOOR



LOWER FLOOR

DISCLAIMER:

All measurements are indicative and are for marketing purposes only. All efforts have been made to ensure their accuracy, however these layouts are subject to change at the discretion of the developer and should not be relied upon as final. The actual area may vary from the stated area and the developer reserves the right to make the revisions/alterations, at its absolute discretion, without any liability whatsoever



BARAKA

REAL ESTATE DEVELOPMENT

THE BAY RESIDENCE II 4 BED TH-TYPE E DUPLEX

GROUND FLOOR

Internal Area	2,678.38	Sq.ft.
Outdoor Area	1,277.89	Sq.ft.
Total Area	3,956.28	Sq.ft.

KEY PLAN

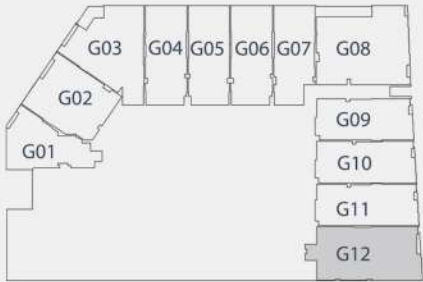

UPPER FLOOR



LOWER FLOOR

DISCLAIMER:

All measurements are indicative and are for marketing purposes only. All efforts have been made to ensure their accuracy, however these layouts are subject to change at the discretion of the developer and should not be relied upon as final. The actual area may vary from the stated area and the developer reserves the right to make the revisions/alterations, at its absolute discretion, without any liability whatsoever



بركة

للتطوير العقاري

☎ 800-273323

🌐 thebayresidences.com

✉ sales@barakadevelopment.ae