



SUNSET GROVE  
HOMES

WHERE EVERY DAY ENDS IN A

*Tapestry*  
OF TRANQUILITY



IDEAL  
*Dubai*  
LOCALE

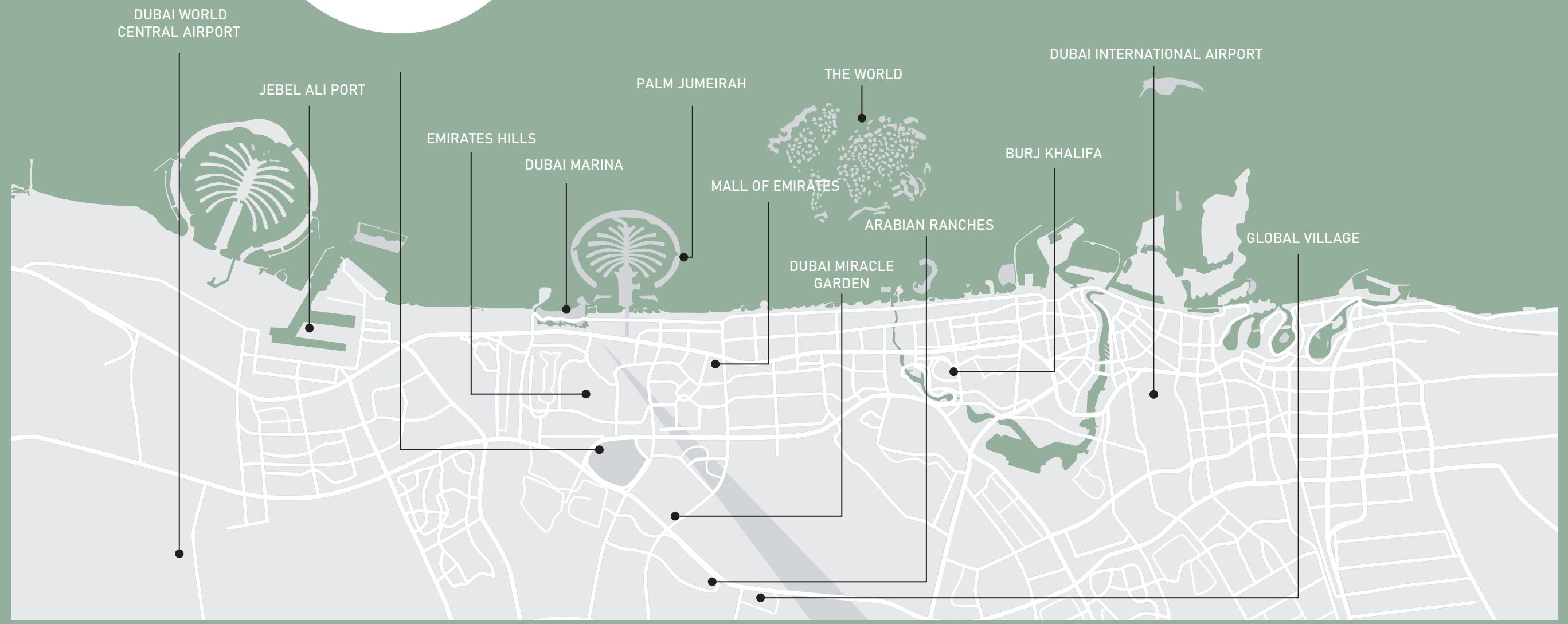



MINUTES AWAY FROM

# Landmark

DESTINATION



DOWNTOWN  
DUBAI

**10**

MINUTES



BURJ  
AL ARAB

**14**

MINUTES



PALM  
JUMEIRAH

**14**

MINUTES

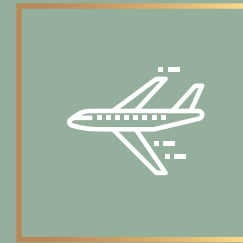

DUBAI  
INTERNATIONAL  
AIRPORT

**25**

MINUTES

Located in Dubai, Jumeirah Village Circle stands as a vibrant, high-end community. Its residents enjoy a diverse selection of dining and shopping options, enjoying a sophisticated urban lifestyle in a safe and welcoming environment. Additionally, easy access to Central Dubai is facilitated by the nearby Sheikh Mohammed Bin Zayed Road.

# Jumeirah

## VILLAGE CIRCLE

Offers excellent connectivity to various colleges, schools, and landmarks. With multiple educational institutions within a short radius, residents enjoy easy access to quality education. Jumeirah Village Circle Dubai is home to over 2,000 residential units. The development has a village-like setting with parks and canals surrounding apartments, villas and townhouses. Village Circle Dubai is a one-stop destination with the city's best offerings in retail and dining.



SUNSET GROVE  
HOMES







## PRESTIGIOUS ARCHITECTURAL ELEGANCE

---

Sunset Grove Homes epitomises prestige through its meticulously crafted project, reflecting the fervent passion and unwavering commitment of its creators. Within, an elegant ambience flawlessly merges with modern convenience to accommodate contemporary lifestyles. Enhanced by vibrant outdoor spaces and unique amenities, Sunset Grove Homes promises an unparalleled living experience.





SUNSET GROVE  
HOMES

An  
*Opulent Life*



8 HOUSES



G+2 BUILDINGS



2 PARKINGS







SUNSET GROVE  
HOMES

# Ground Floor



BEDROOM



LIVING ROOM



DINING AREA



KITCHEN



BATHROOM









## GROUND FLOOR ELEGANCE

The ground floor of your villa offers a spacious lounge radiating elegance and tranquillity. With a subtle colour scheme and abundant natural light, it offers an inviting retreat for relaxation and social gatherings alike.





## VILLA DINING DELIGHT

---

The dining space on the ground floor of your villa is elegant yet festive. With a tasteful colour palate and ample natural light, it offers a delightful setting for tasteful culinary experiences.

## STYLISH KITCHEN RETREAT

---

The modern kitchen offers a unified blend of functionality and style. With sleek appliances and ample counter space, it's a culinary haven for any aspiring chef.







## A PEACEFUL BEDROOM WITH BATHROOM

On the tranquil ground floor of your villa in Sunset Grove Homes, Jumeirah Village Circle, Dubai, UAE, lies a serene bedroom haven. The attached bathroom continues the soothing ambience, offering a spa-like retreat with modern amenities for ultimate relaxation.







SUNSET GROVE  
HOMES







SUNSET GROVE  
HOMES

# First Floor



CORRIDOR



2x BEDROOMS



2x BATHROOMS



STUDY AREA





## ELEGANT STAIRCASE VISTA

---

The stairs corridor on the first floor of your villa in Sunset Grove Homes displays spaciousness and charm. Its sweeping staircase and ornate railings create a grand entrance, offering a picturesque vista for residents and guests alike to enjoy.



## EXPERIENCE THE MAGIC OF SLEEP

Transform your bedroom into a tranquil retreat haven. Soft hues, large wall windows and a subtle colour scheme create a serene space where you can unwind and feel refreshed.





## VOGUSH BATHROOM

---

The bathroom of your home characterises contemporary elegance. With sleek fixtures, top-of-the-line fittings and luxurious amenities, it offers a relaxing retreat for rejuvenation and lessening.









SUNSET GROVE  
HOMES



[www.sunsetgrovehomes.com](http://www.sunsetgrovehomes.com)





SUNSET GROVE  
HOMES

# Second Floor



MASTER SUITE



BATHROOM



UTILITY ROOM



TERRACE



PRIVATE JACUZZI





## COSY COMFORT SPACE

Your master bedroom extends its comfort zone with the addition of a spacious walking closet providing ample storage for clothing and accessories. Your rooms offer layers of warmth with soft blankets, fluffy pillows and ambient lighting, ensuring you or your family members feel snug and relaxed.





## STYLISH REJUVENATION

---

Exemplifying modern elegance, the bathroom on the second floor of your villa offers sleek fixtures, premium fittings, and luxurious amenities, providing a serene sanctuary for relaxation and rejuvenation.





## MULTIPURPOSE UTILITY ROOM

---

We have designed your storeroom in such a way that it can be used as a multifunctional space with designated areas for storage and a convenient washing machine setup. To maximize efficiency and organization while streamlining your household chores with this versatile solution.









SUNSET GROVE  
HOMES







SUNSET GROVE  
HOMES

# Floor Plans





# SUNSET GROVE HOMES

## 4 BEDROOMS + PRIVATE POOL & JACUZZI

### G+2

#### CORNER VILLA

TOTAL AREA	SQM	SQ. FT.
TOTAL BUILT UP AREA	288.26	3102.80
TOTAL PLOT AREA	368.1	3962.19

FLOOR TYPE	SQM	SQ. FT.
GROUND FLOOR BUILT UP AREA	124.88	1344.19
FIRST FLOOR BUILT UP AREA	92.79	998.78
SECOND FLOOR BUILT UP AREA	70.59	759.82
LANDSCAPE AREA	76.84	827.09
PARKING AREA	27.5	296.00

#### KEYPLAN

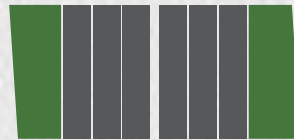

#### DISCLAIMER

The views, plans and layout shown are the artist's impression only. **Sunset Grove Homes** has the right to change these specifications, plans and amenities without prior notice in the interest of quality and timely delivery. We assure you that any such changes made will not, in any way, be detrimental to the quality of the building.



Ground Floor



First Floor



Second Floor

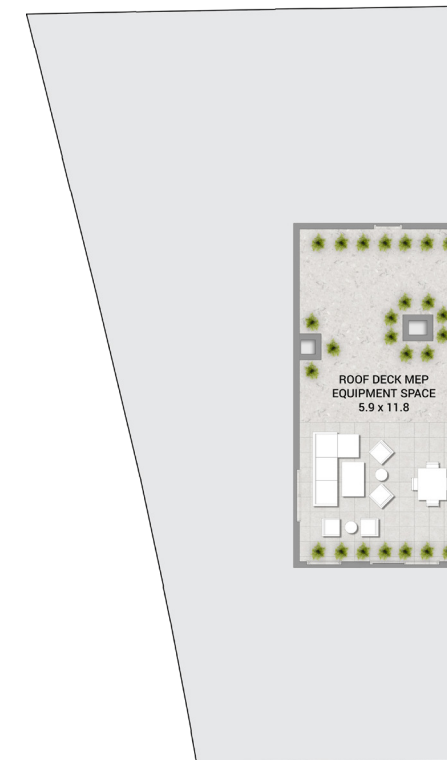

Roof Top





# SUNSET GROVE HOMES

## 4 BEDROOMS & JACUZZI

### G+2

#### MIDDLE VILLAS

TOTAL AREA	SQM	SQ. FT.
TOTAL BUILT UP AREA	261.32	2812.82
TOTAL PLOT AREA	156	1679.17

FLOOR TYPE	SQM	SQ. FT.
GROUND FLOOR BUILT UP AREA	97.99	1054.75
FIRST FLOOR BUILT UP AREA	92.74	998.24
SECOND FLOOR BUILT UP AREA	70.59	759.82
LANDSCAPE AREA	32.74	352.41
PARKING AREA	27.5	296.00

#### KEYPLAN

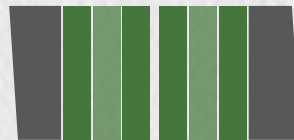

#### DISCLAIMER

The views, plans and layout shown are the artist's impression only. **Sunset Grove Homes** has the right to change these specifications, plans and amenities without prior notice in the interest of quality and timely delivery. We assure you that any such changes made will not, in any way, be detrimental to the quality of the building.

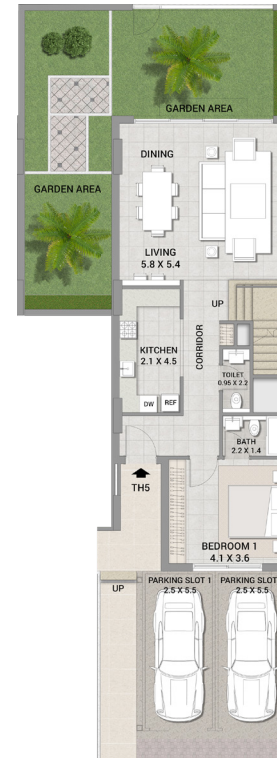

Ground  
Floor

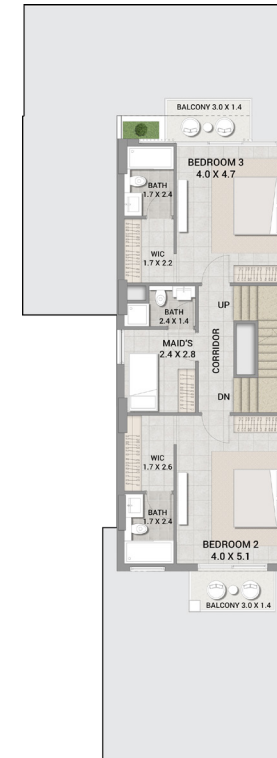

First  
Floor



Second  
Floor

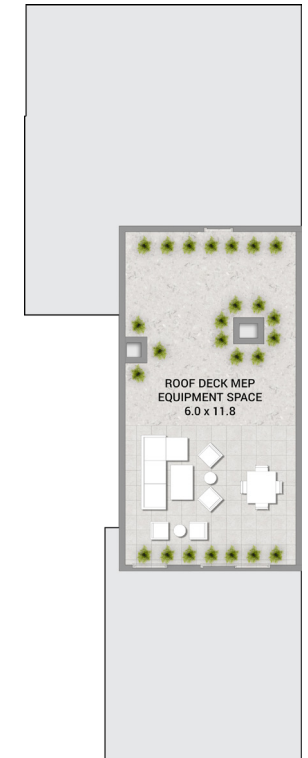

Roof Top



# PAYMENT PLAN

50/50

Downpayment 20%

4% Dubai Land Department Registration Charges

50%

AFTER 100% PROJECT HANDOVER

EXPECTED COMPLETION 3RD QUARTER - 2025



SUNSET GROVE  
HOMES

# VIRTUAL TOUR

CLICK HERE



SUNSET GROVE  
HOMES





# SUNSET GROVE HOMES



**Each Villa Offers Unparalleled Comfort, Elegance, and Privacy.  
Experience Opulent Amenities and Personalized Service in Your Slice of Paradise.**

[www.sunsetgrovehomes.com](http://www.sunsetgrovehomes.com)