



ALMAHRA
RESORT



المهرة
منتجع





Feel Al Mahra Touch.

An aerial photograph of a long, narrow pier or breakwater structure extending from a sandy beach into the ocean. The pier is constructed from large, light-colored rocks and is flanked by waves on both sides. The water transitions from a shallow, light turquoise near the shore to a deeper, darker blue further out. The sky is not visible, focusing the viewer's attention on the coastal structure and the surrounding sea.

01 | CHAIRMAN
MESSAGE

02 | LOCATION

03 | RESORT FACILITIES

CHOOSE YOUR
OWN FLAT | 04

OUR PROJECTS | 05

المحتويات
CONTENTS

د. فيصل علي موسى

رئيس مجلس إدارة فام القابضة

Dr. Faisal Ali Mousa

Chairman, FAM Holding



شهدت سنة ٢٠٠٦ انشاء فام القابضة كمجموعة وطنية تتنوع نشاطاتها بين عدة قطاعات من خلال شركاتها و استثماراتها المتعددة

منذ تأسيسها، تتقدم فام القابضة بخطوات ثابتة نحو مزيد من التوسع و الفاعلية من خلال طرح و انجاز مشاريع فريدة لترسم بذلك نمطا جديدا في كافة مجالات الاعمال التي تنشط فيها المجموعة

FAM Holding is a conglomerate of business solutions across a number of industries having diversified investments in the region. Since our founding in early 2006, we have been moving forward aggressively on many fronts to capitalize on solid growth opportunities, to improve our operating efficiency, to expand our global presence and to sharpen our business portfolio's focus on our core businesses.

FAM Holding, with a rich heritage, strong convictions and fair business principles is ideally positioned to leverage its strengths and make optimum use of resources to become one of the most sought business houses in the region. The long-term aim is to create a broad range of innovative industries that will generate a steady flow of new ideas and technologies and advances.

Take the first step towards developing positive relationships by allowing us to share our experience and expertise in the art of doing business.





Your destination starts here..







LOCATION

Lies directly on the beautiful beach, located in coral shaped Al Marjan Island, Arabian Gulf, Ras al-Khaimah. AL Mahra located 45 min drive from Dubai Approximately.

المكان

يقع منتجج المهرة في إمارة رأس الخيمة على الشاطئ الساحر لجزيرة المرجان التي تتمتع بإطلالة خلابة على الخليج العربي. يبعد منتجج المهرة ٤٥ دقيقة عن دبي.



PACIFIC DEVELOPMENT

MARJAN ISLAND RESORT AND SPA

MARJAN ISLAND BLVD

TURTLE BEACH

MARJAN ISLAND

COVALE TREE BY WILDFIRE RESORT & SPA

BAB AL BAHR

RAS AL KHAIMAH TOURISM DEVELOPMENT AUTHORITY

MARJAN ISLAND BLVD

AL MARJAN ISLAND FESTIVAL BEACH

CITY STAR AL MARJAN

BIN MAJID BEACH RESORT

TO RAS AL KHAIMAH

TO RAS AL KHAIMAH

WILDFIRE ASTORIA RAS AL KHAIMAH

AL HAMRA MALL

TO RAS AL KHAIMAH

SHEIKH MUHAMMAD BIN SA'IED RD

AL JAZIRAH AVIATION CLUB

KOMLOOS BEACH

TO SHARJAH

TO SHARJAH

FISHING SPOT

SCAN QR CODE

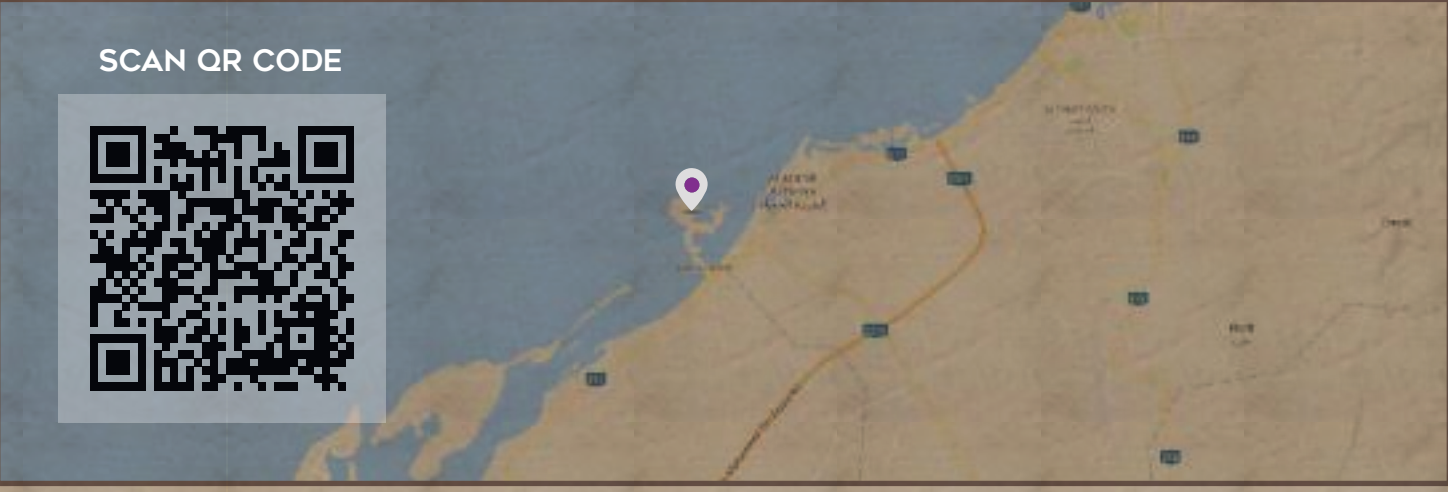





المرافق والخدمات
RESORT FACILITIES



LOBBY

Al Mahra Resort is opening its doors with contemporary designed elegant lobby, which welcomes you with VIP check in areas, gives you Premium experience and guidance. Your special experience starts from breathtaking views of interior design of the Resort and Al Marjan Island itself.

ردهة الاستقبال

يستقبل منتجج المهرة زواره في ردهة مصممة وفق أعلى معايير الفخامة التي تظهر في ادق التفاصيل الداخلية لتعكس مدى الراحة التي ستنعم بها خلال اقامتك لدينا.





MEETING ROOMS

Al Mahra Resort is offering comfortable meeting rooms with Tea-Coffee and appetizers support, always available upon your request.

الاجتماعات و الفعاليات

في منتجج المهرة نولي اعمالك اهتماماً كبيراً من خلال توفير قاعات مزودة بكل متطلبات الأعمال





24 HOURS IN-ROOM SERVICE

Al Maha Resort is offering 24-hours in-room service of multinational cuisine.

خدمة الغرف

تمتع برفقى الخدمات في جناحك الخاص ، من خلال فريق خدمة الغرف الذي يحرص على راحتكم وتلبية طلباتكم على مدار الساعة



RESTAURANTS



All-day-dining (Three-Meal Restaurant),
Specialty restaurant lounge and garden around it,
which serves Shisha light snacks and refreshments.

المطاعم



اخترنا لكم في منتجج المهرة مجموعة مطاعم بمأكولاتها المستوحاة من
أرقى فنون الطبخ العالمية وخياراتها المتنوعة التي تلائم جميع الأذواق.
سواء كانت غايتك تناول وجبة في جو عائلي يتميز بالفخامة والرقي، او كنت ترغب
بقضاء اوقات ممتعة مع الأصدقاء فإن المهرة هو وجهتك المفضلة





GYM FOR MEN & WOMEN

With Multifunction room for hosting classes such as Yoga, Zumba, Aerobics including all gymnasium equipment.

صالات لياقة بدنية

في منتجع المهرة ، يمكنك الحفاظ على لياقتك بكل سهولة من خلال صالات اللياقة البدنية المتوفرة في المنتجع و المجهزة لكل احتياجاتك





WELLNESS CLUB & SPA FOR MEN AND WOMEN

Al Mahra Resort welcomes you to enter well Being pleasure with its Luxurious treatment rooms for both, men and women.
Among various Spa facilities are: body care, massage, sauna, massage booths, Jacuzzi, Moroccan Hammam. Beauty Salon for ladies and for men.

نادي صحي و سبا للرجال و النساء

يتميز منتجع المهرة بنوادي صحّية فاخرة للنساء و الرجال. حيث يمكنكم التمتع بخدمات واسعة مثل العناية بالجسم ، المساج ، ساونا ، جاكوزي ، حمام مغربي و صالونات تجميل





KID'S CLUB

Al Mahra has an immense spaceship for Kids. Children from up to 12 years old will enjoy Specially designed Environment with diverse playing activities as Kids Pool, Kids zone, Kids club. Play Station and other gaming consoles.

نادي الأطفال

تم تصميم نادي الأطفال بكل عناية ليوفّر الراحة التامة لأطفالكم و الطمأنينة لكم ، حيث يتضمّن النادي مسبح خاص للأطفال ، صالة ألعاب ، منطقة التعلم و اللعب بالإضافة للعديد من الميزات الأخرى .





RETAIL OUTLETS



AL MAHRA resort is proposing detersive Retail Outlets accordingly to your first needs. Among those are:

- > Swimming and beach gear
- > Souvenirs and gifts
- > Day-to-day guests necessity products

محلات التجزئة

يُعتبر التسوّق من أهم عوامل الإقامة الممتعة ، لذلك يقدم مُنتج المهرة خيارات واسعة للتسوق مثل مُستلزمات السباحة ، الهدايا أو متاجر الاحتياجات اليومية





WATER SPORTS

Beach valley, scuba diving, snorkeling, jet skiing is only the beginning of your watersport adventure. Among water attractions you and your family will enjoy Banana, Parachute, and Pedal Boating.

الرياضات البحرية

حافظ على نشاطك خلال إقامتك في منتجع المهرة من خلال الرياضات البحرية المتنوعة و الفريدة التي نوفرها لك ، أهمها الغوص ، كرة الشاطئ ، صيد الاسماك بالاضافة للعديد من النشاطات الأخرى





BEACH VOLLEY BALL

The Al Mahra Resort provides access to the private beach equipped with cabanas, illuminated by beautiful sunrises and sunsets and guaranteed by qualified security to ensure safety to all guests.

رياضات الشاطئ

شاطئ منتجع المهرة هو مكانك الأمثل إذا كنت من هواة الرياضات الشاطئية ، حيث أنه يتميز بملاعب متعددة توفر لك خيارات ترفيهية غير محدودة





SWIMMING POOL FOR MEN & WOMEN

Allocated at the G floor, swimming pool is divided for two sections: one serves large pool for adults, and second is a whirlpool joy for the children entertainment.

حمامات سباحة للرجال و النساء

تمتع بأجمل لحظات الإسترخاء والراحة في مسابح منتجع المهرة ،
التي تتوزع على أرجاء المنتجع لتوفر بذلك خيارات متعددة تناسب
كافة إحتياجاتك



1. WHY TO INVEST NOW?

BEING AN OWNER OF A HOTEL UNIT GIVES YOU:

ACCESS AND OWNERSHIP OF THE PROPERTY
AT THE 1ST COAST LINE

FULLY FURNISHED HOTEL LUXURY ROOM
WITH THE LATEST BRANDED DESIGN AND
SERVICE

AL MARJAN ISLAND IS
FAMILY ORIENTED WITH
FRIENDLY ECO-ENVIRONMENT

MORE RETURN OF
INVESTMENT % THAN
BANK INVESTMENT

8% ROI GUARANTEED FOR
FIRST 3 YEARS AND
INCREASING UP TO 15% FOR
POST YEARS* FROM
FINANCIAL FORECAST

OFF PLAN INVESTMENT WITH
AT THE BENEFITS OF
PAYMENT FOR 6 YEARS

START A SYSTEM AS
WELL MANAGED
BUSINESS MODEL
WHICH IS VERY POP-
ULAR IN WESTERN
COUNTRIES AS USA,-
SPAIN,AUSTRALIA

RECEIVING STABLE
INCOME FROM YOUR
UNIT OPERATING BY
PROFESSIONALS
WHILE YOU ARE
SLEEPING

2. HOW DOES IT WORK?

1. CHOOSE YOUR HOTEL UNIT UPON YOUR TASTE & COMPLETE YOUR BOOKING FORM

2. MAKE DOWNPAYMENT 10% FROM THE TOTAL AMOUNT TO REGISTER THE UNIT UNDER YOUR NAME

3. RECEIVE YOUR PAYMENT SCHEDULE FROM OUR CONSULTANTS

4. MAKE A BOOKING FOR 14 DAYS OF A FREE HOLIDAY STAY FOR YOU AND YOUR FAMILY AFTER ANTICIPATED HANDOVER, 2020 DECEMBER

5. START TO RECEIVE YOUR GUARANTEED ROI 8% FROM THE FIRST OPERATING YEAR

6. YOU ARE AN OWNER OF 4 STARS RESORT UNIT, WITH EXPECTED RETURN OF INVESTMENT UP TO 15% YEARLY ROI

PAYMENT SCHEDULE

| INSTALLMENTS | MILESTONE EVENT | PERCENT VALUE | AMOUNT (AED) |
|---------------------------------|--|---------------|--------------|
| 1ST INSTALLMENTS (DEPOSIT) | ON BOOKING | 10% | |
| 2ND INSTALLMENTS (36 MONTHS) | STARTING FROM 01/12/2017 TO 1/12/2020 | 36% (1%*36) | |
| 3RD INSTALLMENTS | ON HANDOVER 31/12/2020 | 20% | |
| 4TH INSTALLMENTS (34 MONTHS) | POST-HANDOVER STARTING FROM 01/01/2020 TO 01/11/2022 | 34%(1%*34) | |
| ADMINISTRATION FEES | ON BOOKING | | 5000 |

Garden View

AL MAHRA RESORT







إستثمر
لمستقبل
عائلتك
**INVEST FOR
YOUR FAMILY
FUTURE**

FLOOR PLANS



TYPE A

| | |
|-------------|-------------------------------------|
| Type: | Villa |
| Bedrooms: | Three Bedroom |
| Bathrooms: | 2 |
| Gross Area: | 270.44 m ² 2910.99 Sq |

AMENITIES

Central A/C
Terrasse
Private Pool
Covered Parking
Dining in Building
Shared Gym



Ground Floor



First Floor

Disclaimer: Unless stated above, all accessories and interior finishes such as wallpaper, chandeliers, furniture, electronics, white goods, curtains, hard and soft landscaping, pavements, features, swimming pool(s) and other elements displayed in the brochure, or within the show apartment / villa or between the plot boundary and the unit, are not part of the standard unit and exhibited for illustrative purposes only. Areas shown are based on plans at the time of printing; actual dimensions could vary up to final 'as built' status and are not intended to form part of any contract or warranty.



TYPE B

| | |
|-------------|--|
| Type: | Family Two Bedroom Suite |
| Bedrooms: | 2 Bedroom |
| Bathrooms: | 2 |
| Gross Area: | 135.62 m ² - 135.51 m ² 1459.80 Sq - 1458.61 Sq |

AMENITIES

- Central A/C
- Balcony
- Shared Pool
- Covered Parking
- Dining in Building
- Shared Gym



Disclaimer: Unless stated above, all accessories and interior finishes such as wallpaper, chandeliers, furniture, electronics, white goods, curtains, hard and soft landscaping, pavements, features, swimming pool(s) and other elements displayed in the brochure, or within the show apartment / villa or between the plot boundary and the unit, are not part of the standard unit and exhibited for illustrative purposes only. Areas shown are based on plans at the time of printing; actual dimensions could vary up to final 'as built' status and are not intended to form part of any contract or warranty.



TYPE C

| | |
|-------------|---|
| Type: | One Bedroom Suite |
| Bedrooms: | One Bedroom |
| Bathrooms: | 2 |
| Gross Area: | 122.19 m ² - 122.55 m ² 1315.24 Sq - 1319.11722 Sq |

AMENITIES

- Central A/C
- Balcony
- Shared Pool
- Covered Parking
- Dining in Building
- Shared Gym



Disclaimer: Unless stated above, all accessories and interior finishes such as wallpaper, chandeliers, furniture, electronics, white goods, curtains, hard and soft landscaping, pavements, features, swimming pool(s) and other elements displayed in the brochure, or within the show apartment / villa or between the plot boundary and the unit, are not part of the standard unit and exhibited for illustrative purposes only. Areas shown are based on plans at the time of printing; actual dimensions could vary up to final 'as built' status and are not intended to form part of any contract or warranty.



TYPE C-1

| | |
|-------------|--|
| Type: | One Bedroom Suite |
| Bedrooms: | One Bedroom |
| Bathrooms: | 2 |
| Gross Area: | 106.39 m ² - 106.08 m ² 1145.17 Sq - 1141.83 Sq |

AMENITIES

- Central A/C
- Balcony
- Shared Pool
- Covered Parking
- Dining in Building
- Shared Gym



Disclaimer: Unless stated above, all accessories and interior finishes such as wallpaper, chandeliers, furniture, electronics, white goods, curtains, hard and soft landscaping, pavements, features, swimming pool(s) and other elements displayed in the brochure, or within the show apartment / villa or between the plot boundary and the unit, are not part of the standard unit and exhibited for illustrative purposes only.
Areas shown are based on plans at the time of printing; actual dimensions could vary up to final 'as built' status and are not intended to form part of any contract or warranty.



TYPE D

| | |
|-------------|--|
| Type: | Deluxe Room |
| Bedrooms: | Studio |
| Bathrooms: | 1 |
| Gross Area: | 59.80 m ² - 59.62 m ² 643.68 Sq - 641.74 Sq |

AMENITIES

Central A/C
Balcony
Shared Pool
Covered Parking
Dining in Building
Shared Gym

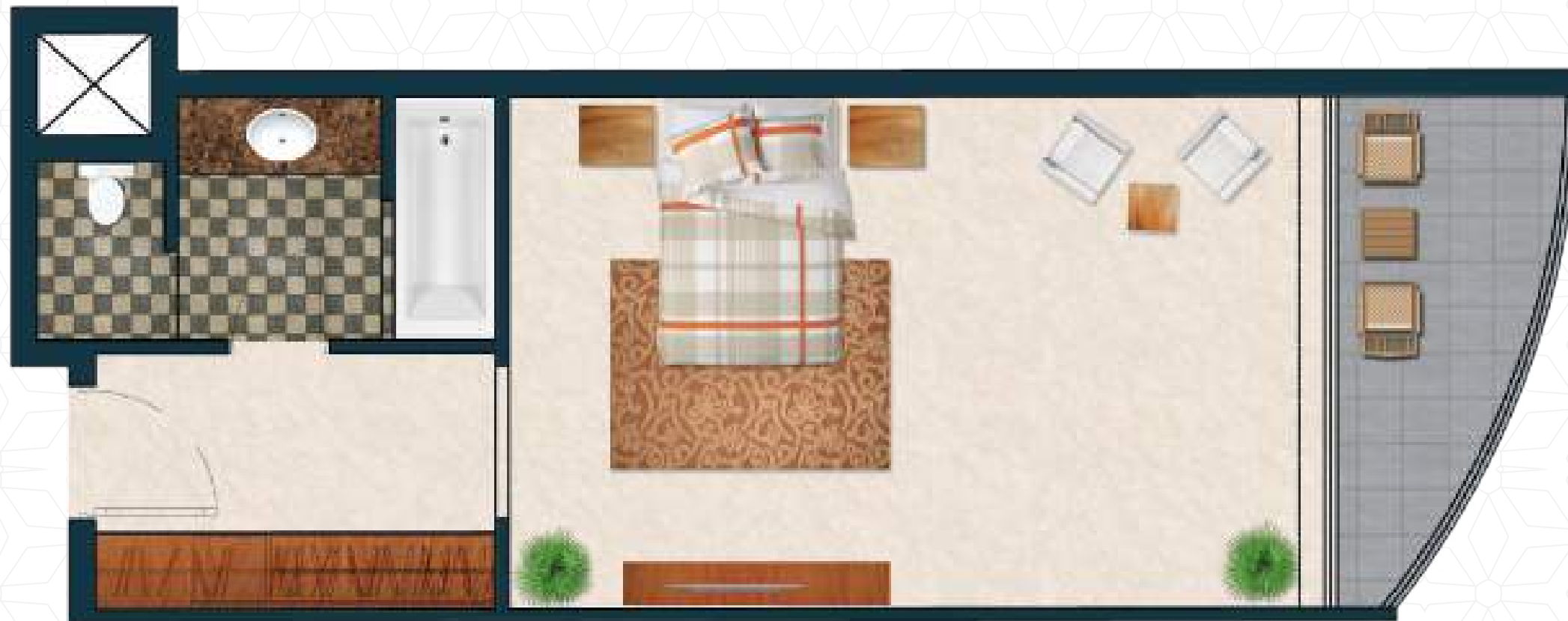

Disclaimer: Unless stated above, all accessories and interior finishes such as wallpaper, chandeliers, furniture, electronics, white goods, curtains, hard and soft landscaping, pavements, features, swimming pool(s) and other elements displayed in the brochure, or within the show apartment / villa or between the plot boundary and the unit, are not part of the standard unit and exhibited for illustrative purposes only. Areas shown are based on plans at the time of printing; actual dimensions could vary up to final 'as built' status and are not intended to form part of any contract or warranty.



TYPE D-1

| | |
|-------------|--|
| Type: | Superior Room |
| Bedrooms: | Studio |
| Bathrooms: | 1 |
| Gross Area: | 52.25 m ² - 52.10 m ² 562.41 Sq - 560.79 Sq |

AMENITIES

Central A/C
Balcony
Shared Pool
Covered Parking
Dining in Building
Shared Gym

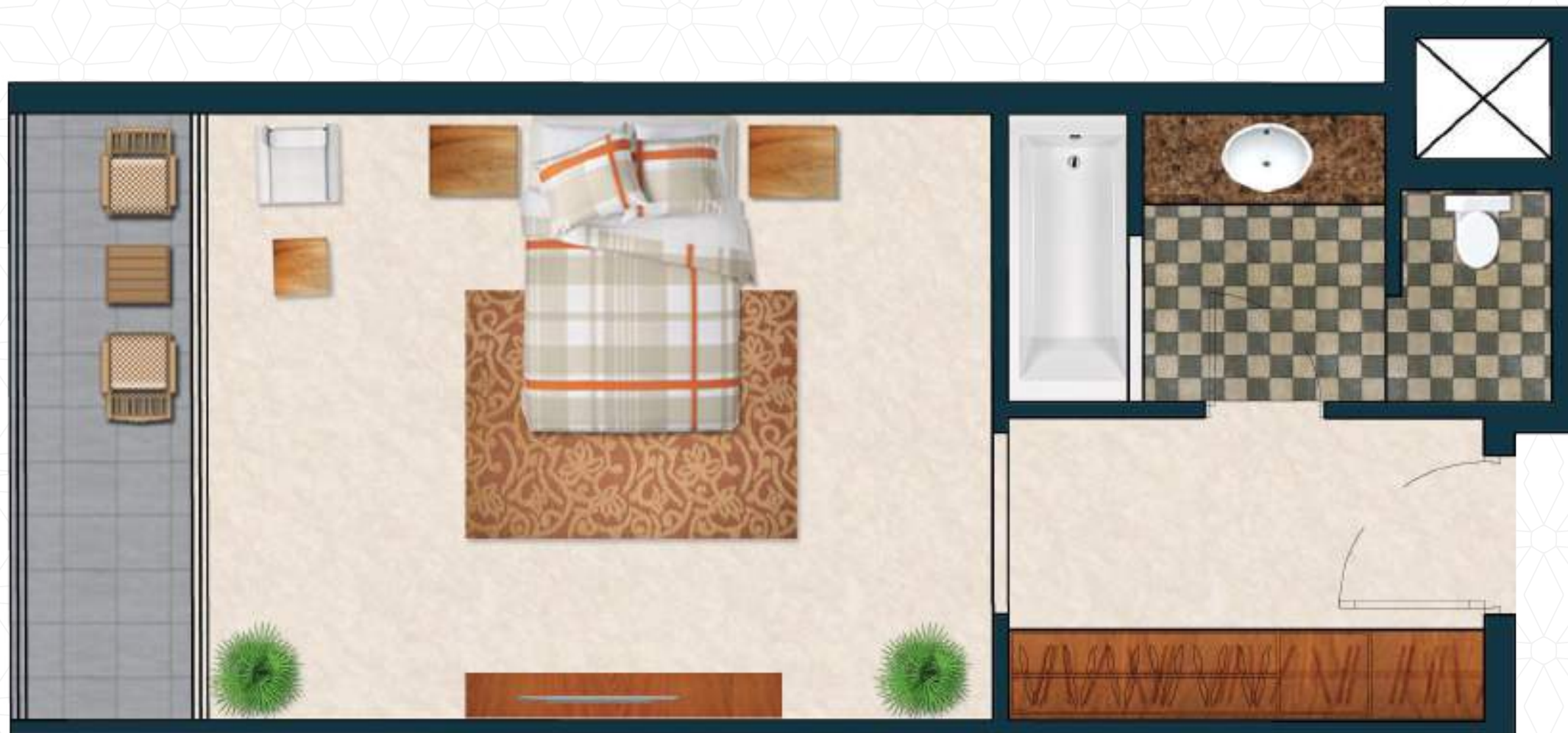

Disclaimer: Unless stated above, all accessories and interior finishes such as wallpaper, chandeliers, furniture, electronics, white goods, curtains, hard and soft landscaping, pavements, features, swimming pool(s) and other elements displayed in the brochure, or within the show apartment / villa or between the plot boundary and the unit, are not part of the standard unit and exhibited for illustrative purposes only.
Areas shown are based on plans at the time of printing; actual dimensions could vary up to final 'as built' status and are not intended to form part of any contract or warranty.



TYPE D-2

| | |
|-------------|-----------------------------------|
| Type: | Superior Room |
| Bedrooms: | Studio |
| Bathrooms: | 1 |
| Gross Area: | 51.83 m ² 557.89 Sq |

AMENITIES

Central A/C
Balcony
Shared Pool
Covered Parking
Dining in Building
Shared Gym

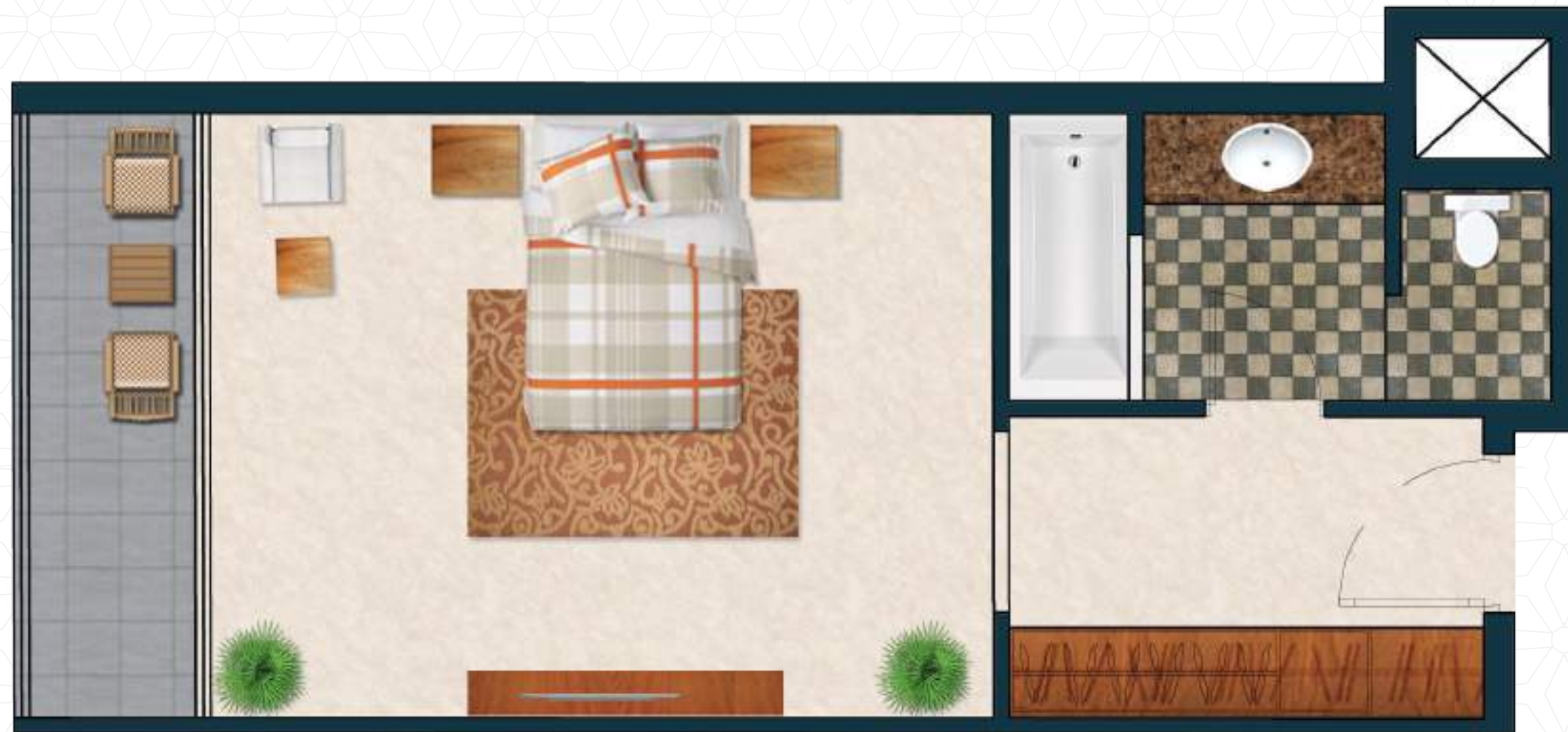

Disclaimer: Unless stated above, all accessories and interior finishes such as wallpaper, chandeliers, furniture, electronics, white goods, curtains, hard and soft landscaping, pavements, features, swimming pool(s) and other elements displayed in the brochure, or within the show apartment / villa or between the plot boundary and the unit, are not part of the standard unit and exhibited for illustrative purposes only. Areas shown are based on plans at the time of printing; actual dimensions could vary up to final 'as built' status and are not intended to form part of any contract or warranty.



TYPE D-3

| | |
|-------------|--|
| Type: | Superior Room |
| Bedrooms: | Studio |
| Bathrooms: | 1 |
| Gross Area: | 53.15 m ² - 55.71 m ² 572.10 Sq - 599.65 Sq |

AMENITIES

- Central A/C
- Balcony
- Shared Pool
- Covered Parking
- Dining in Building
- Shared Gym



Disclaimer: Unless stated above, all accessories and interior finishes such as wallpaper, chandeliers, furniture, electronics, white goods, curtains, hard and soft landscaping, pavements, features, swimming pool(s) and other elements displayed in the brochure, or within the show apartment / villa or between the plot boundary and the unit, are not part of the standard unit and exhibited for illustrative purposes only.
Areas shown are based on plans at the time of printing; actual dimensions could vary up to final 'as built' status and are not intended to form part of any contract or warranty.



TYPE E

| | |
|-------------|--|
| Type: | Junior Suite |
| Bedrooms: | Studio |
| Bathrooms: | 1 |
| Gross Area: | 76.70 m ² - 76.54 m ² 825.59 Sq - 823.86 Sq |

AMENITIES

- Central A/C
- Balcony
- Shared Pool
- Covered Parking
- Dining in Building
- Shared Gym



Disclaimer: Unless stated above, all accessories and interior finishes such as wallpaper, chandeliers, furniture, electronics, white goods, curtains, hard and soft landscaping, pavements, features, swimming pool(s) and other elements displayed in the brochure, or within the show apartment / villa or between the plot boundary and the unit, are not part of the standard unit and exhibited for illustrative purposes only. Areas shown are based on plans at the time of printing; actual dimensions could vary up to final 'as built' status and are not intended to form part of any contract or warranty.



TYPE F

| | |
|-------------|--|
| Type: | Superior Room |
| Bedrooms: | Studio |
| Bathrooms: | 1 |
| Gross Area: | 58.54 m ² - 58.41 m ² 630.11 Sq - 628.72 Sq |

AMENITIES

Central A/C
Balcony
Shared Pool
Covered Parking
Dining in Building
Shared Gym



Disclaimer: Unless stated above, all accessories and interior finishes such as wallpaper, chandeliers, furniture, electronics, white goods, curtains, hard and soft landscaping, pavements, features, swimming pool(s) and other elements displayed in the brochure, or within the show apartment / villa or between the plot boundary and the unit, are not part of the standard unit and exhibited for illustrative purposes only.
Areas shown are based on plans at the time of printing; actual dimensions could vary up to final 'as built' status and are not intended to form part of any contract or warranty.



TYPE G

| | |
|-------------|-----------------------------------|
| Type: | Deluxe Room |
| Bedrooms: | Studio |
| Bathrooms: | 1 |
| Gross Area: | 62.22 m ² 669.73 Sq |

AMENITIES

Central A/C
Balcony
Shared Pool
Covered Parking
Dining in Building
Shared Gym



Disclaimer: Unless stated above, all accessories and interior finishes such as wallpaper, chandeliers, furniture, electronics, white goods, curtains, hard and soft landscaping, pavements, features, swimming pool(s) and other elements displayed in the brochure, or within the show apartment / villa or between the plot boundary and the unit, are not part of the standard unit and exhibited for illustrative purposes only. Areas shown are based on plans at the time of printing; actual dimensions could vary up to final 'as built' status and are not intended to form part of any contract or warranty.



TYPE L

| | |
|-------------|----------------------|
| Type: | Superior Room |
| Bedrooms: | Studio |
| Bathrooms: | 1 |
| Gross Area: | 44.94 m ² |

AMENITIES

Central A/C
Shared Pool
Covered Parking
Dining in Building
Shared Gym



Disclaimer: Unless stated above, all accessories and interior finishes such as wallpaper, chandeliers, furniture, electronics, white goods, curtains, hard and soft landscaping, pavements, features, swimming pool(s) and other elements displayed in the brochure, or within the show apartment / villa or between the plot boundary and the unit, are not part of the standard unit and exhibited for illustrative purposes only. Areas shown are based on plans at the time of printing; actual dimensions could vary up to final 'as built' status and are not intended to form part of any contract or warranty.



TYPE K

| | |
|-------------|--|
| Type: | Junior Suite |
| Bedrooms: | Studio |
| Bathrooms: | 1 |
| Gross Area: | 76.70 m ² - 76.54 m ² 825.59 Sq - 823.86 Sq |

AMENITIES

- Central A/C
- Balcony
- Shared Pool
- Covered Parking
- Dining in Building
- Shared Gym



Disclaimer: Unless stated above, all accessories and interior finishes such as wallpaper, chandeliers, furniture, electronics, white goods, curtains, hard and soft landscaping, pavements, features, swimming pool(s) and other elements displayed in the brochure, or within the show apartment / villa or between the plot boundary and the unit, are not part of the standard unit and exhibited for illustrative purposes only. Areas shown are based on plans at the time of printing; actual dimensions could vary up to final 'as built' status and are not intended to form part of any contract or warranty.



فام القابضة
FAM HOLDING

مجموعة فيصل علي موسى
FAISAL ALI MOUSA GROUP

Dubai

Office 1014 Burjuman Business Tower
P.O. Box 21 1021, Dubai, UAE
www.famholding.com

Tel: +971 4 351 7250
Fax: +971 4 351 5159
Email: info@famholding.com



Sharjah

Office 1014 Burjuman Business Tower
P.O. Box 21 1021
Dubai United Arab Emirates
Tel: +971 4 351 7250
Fax: +971 4 351 5159
Email: info@famholding.com

Dubai

P.O. Box 53874,
Dubai - U.A.E.
Tel: +971 (0)4 3211134
Fax: +971 (0)4 3211135

Abu Dhabi

PO Box 72898,
Abu Dhabi,
United Arab Emirates
Tel: +971 2 652 0000
Fax: +971 2 652 0001

Ras Al Khaimah

Al Nakheel
Tel: +971 07 227 8822
Fax: +971 07 2227 8822
Office @homeofarchitecturerak.com



OUR PROJECTS





فام القابضة
FAM HOLDING

مجموعة فيصل علي موسى
FAISAL ALI MOUSA GROUP





T: +971 4 351 7250
F: +971 4 351 5159

فام القابضة
FAM HOLDING
مجموعة فيصل علي موسى
FAISAL ALI MOUSA GROUP

WWW.FAMHOLDING.COM