



www.deyaar.com • 800-DEYAAR

M
MIDTOWN
BY DEYAAR

دانية ديستركت
DANIA DISTRICT

WELCOME TO MIDTOWN

مرحباً بكم في ميدتاون

يوفر لكم ميدتاون فرصة سكن فريدة من نوعها. حيث تجتمع خبرة البناء والتطوير مع الحرفة المعمارية. هذا المجمع المتكامل يحمل بصمة (ديار) حيث يضم مجمعاً سكنياً، ومجموعة من وسائل الراحة والخدمات المختارة بعناية، ومجموعة من المتاجر والمطاعم، بالإضافة إلى المسطحات الخضراء، وكل ذلك ضمن مساحة تقارب ٥ ملايين قدم مربع.



Where development expertise meets architectural mastery, Midtown welcomes you to a unique living experience. This signature township by Deyaar hosts a residential complex with an array of thoughtful amenities, retail services and dining options. Resting along the beautifully landscaped piazza, these amenities are spread over a sprawling 5 million square feet of development.

ABOUT DANIA DISTRICT

عن دانية ديستركت



دانية ديستركت DANIA DISTRICT

تستقبلكم دانية ديستركت في وسط مجمع ميدتاون، في أبنيتها الستة المذهلة، والتي تنبض بمستوى حياة متميز، حيث صممت دانية لتلبي جميع متطلبات الحياة العصرية عبر منازل مصممة بعناية، مسطحات خضراء، ملعب كرة سلة، ملعب تنس وغيرها الكثير، احجز منزلك الآن ليكون كل يوم تعيشه فيه ذكرى مميزة.

Dania District, a slice of paradise in the heart of Midtown, welcomes you to six magnificent buildings boasting the finest of lifestyle options. With beautifully designed homes, open lawns, a basketball court, tennis courts and more, Dania District is designed to suit all your lifestyle needs. So book your home today and make every day, a day to remember.



IMPZ

N
SH. MOHAMMED BIN
ZAYED ROAD



دانية ديستركت
DANIA DISTRICT

JUMEIRAH GOLF
ESTATES

- | | | | | | |
|---|---|----|--|----|---|
| 1 | ملعب تنس
TENNIS COURT | 8 | مساحات خضراء / منطقة فعاليات
OPEN LAWN/EVENTS SPACE | 11 | مواقف الزوار
VISITORS PARKING |
| 2 | بركة سباحة عائلية
FAMILY SWIMMING POOL | 9 | محلات تجزئة ومطاعم
RETAIL - F&B OUTLETS | 12 | مدخل مواقف السكان
RESIDENTS PARKING ENTRANCE |
| 3 | بركة سباحة للأطفال
CHILDREN'S POOL | 10 | منطقة ترفيهية مع جدار للتسلق
RECREATIONAL AREA WITH CLIMBING WALL | 13 | ممشى الحديقة المركزية
CENTRAL GARDEN WALK |
| 4 | غرف التبدل
CHANGING FACILITIES | | | | |
| 5 | منطقة ألعاب للأطفال / رياضة في الهواء الطلق
CHILDREN'S PLAY AREA/OUTDOOR SPORT | | | | |
| 6 | مضمار الجري
JOGGING TRACK | | | | |
| 7 | ملعب لكرة السلة
BASKETBALL COURT | | | | |

مخطط الطابق FLOOR PLANS

إخلاء مسؤولية:

(1) جميع المعلومات والمواد والمخططات والمرافق الواردة هي تقريبية ووضعت لغايات العرض فقط. للمطور الحق في مراجعة المخططات والموصفات والمواد والقياسات والرسومات والمرافق المعروضة دون إشعار مسبق. (2) مساحات الوحدات والأبعاد الحقيقية والمخططات ومواقع ومواصفات الشرفات والأبواب والخزائن أو أية تجهيزات أخرى قد تختلف من طابق إلى آخر أو من وحدة إلى أخرى وهي خاضعة للتعديل من قبل المطور. (3) لن يتم توفير أي أثاث أو أجهزة كهربائية من قبل المطور.

Disclaimers:

(1) All information, materials, plans and amenities are approximate and provided for illustrative purposes only. The developer reserves the right to make revisions to the floor plans and any features, materials, dimensions, drawings and amenities of the project without notice. (2) Units areas, actual dimensions, layout, location, specifications of balcony, door, wardrobe or other fixtures may vary from floor to floor and between units and are subject to revision by the developer. (3) Furniture and electric devices will not be provided by the developer.

DANIA 2 & 3
STUDIO APARTMENT - TYPE B & C

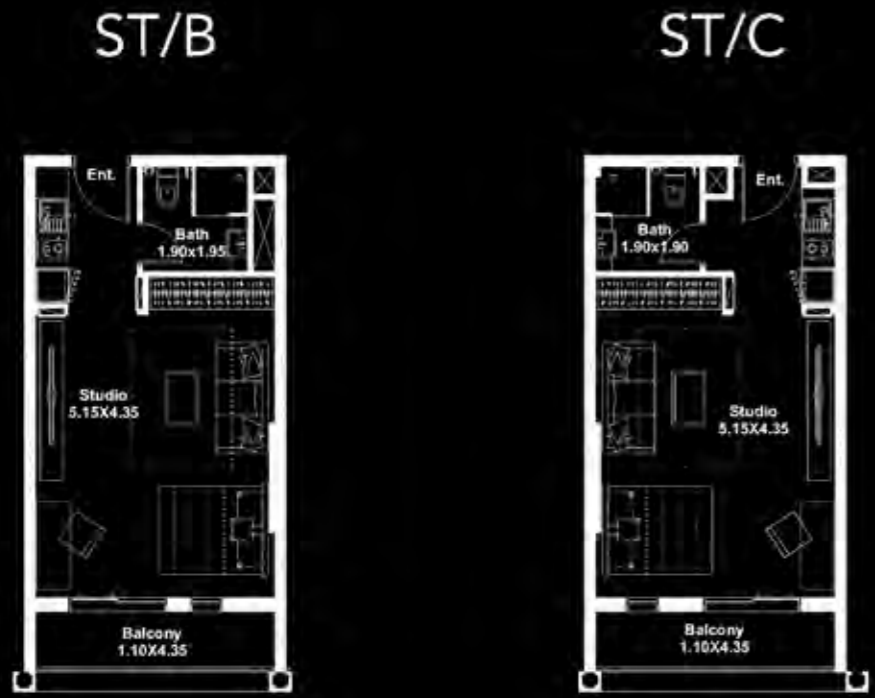

TYPE	UNIT NO.	LEVEL	UNIT (SQ.FT.)	BALCONY (SQ.FT.)	TOTAL (SQ.FT.)	TOTAL COUNT (NO.)
ST/B	05 & 08	9-16	382	56	438	32
ST/C	06 & 07	9-16	388	56	444	32

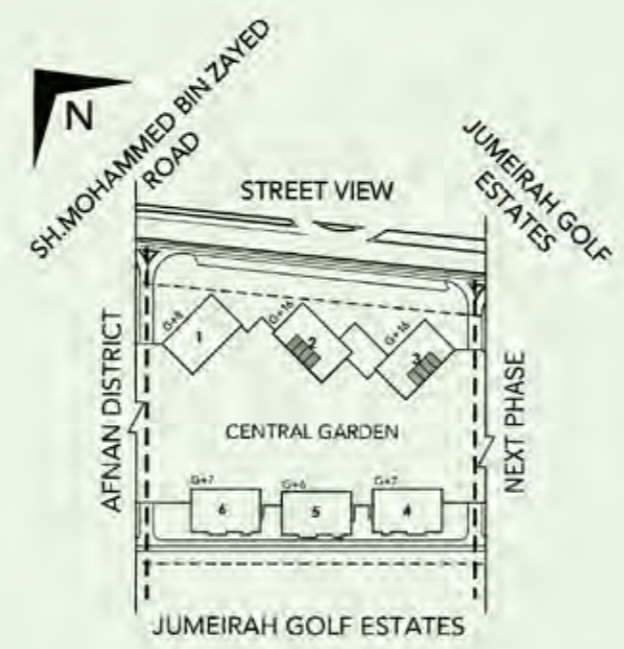

DANIA 2 & 3

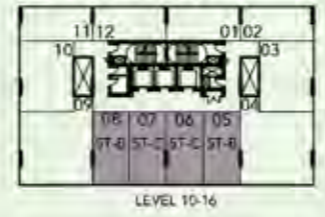

DANIA 2 & 3

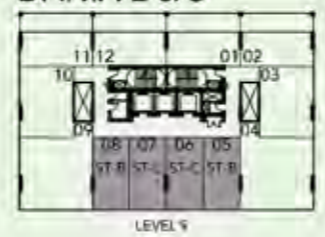

DANIA 2 & 3
STUDIO APARTMENT - TYPE D & E



TYPE	UNIT NO.	LEVEL	UNIT (SQ.FT.)	BALCONY (SQ.FT.)	TOTAL (SQ.FT.)	TOTAL COUNT (NO.)
ST/D	01 & 12	9	427	240	667	4
ST/E	02 & 11	9	431	248	679	4

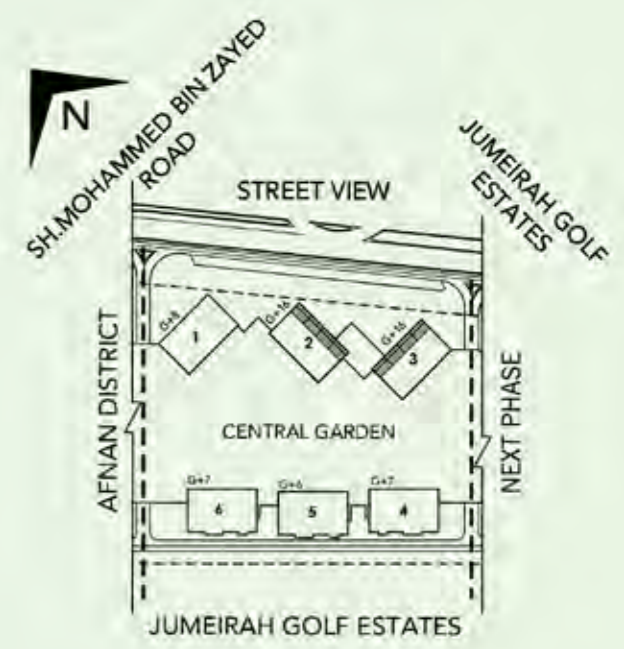

DANIA 2 & 3

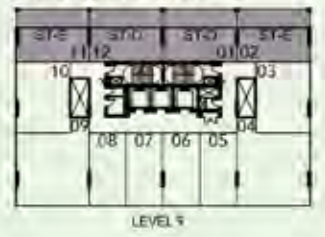

DANIA 2 & 3
STUDIO APARTMENT - TYPE F & G

ST/F

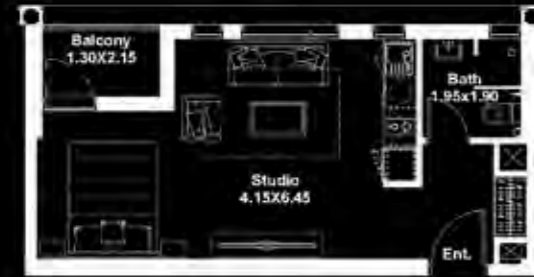

ST/G



TYPE	UNIT NO.	LEVEL	UNIT (SQ.FT.)	BALCONY (SQ.FT.)	TOTAL (SQ.FT.)	TOTAL COUNT (NO.)
ST/F	01 & 12	10-16	392	37	429	28
ST/G	02 & 11	10-16	394	37	431	28

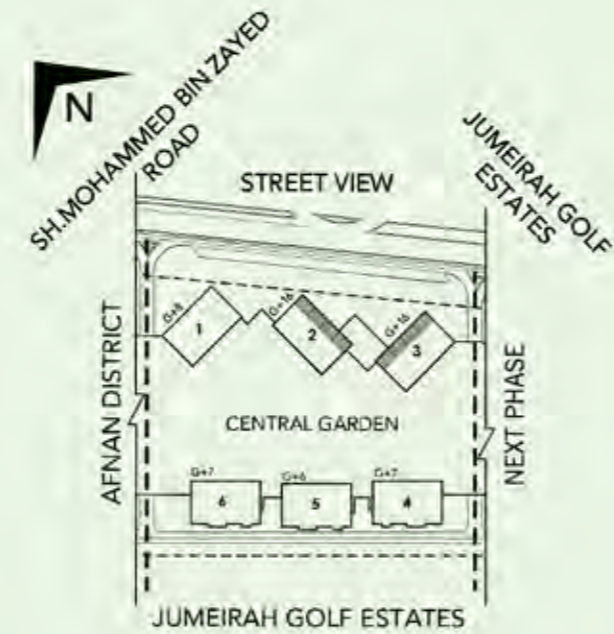

DANIA 2 & 3

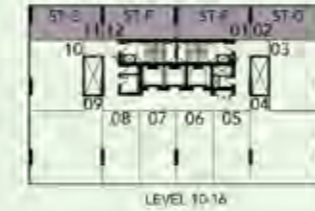

DANIA 1, 2 & 3
STUDIO APARTMENT - TYPE H

ST/H



TYPE	UNIT NO.	LEVEL	UNIT (SQ.FT.)	BALCONY (SQ.FT.)	TOTAL (SQ.FT.)	TOTAL COUNT (NO.)
ST/H	07 (BLDG 1 & 3)	1	496	236	732	2
	04 (BLDG 2)	1	496	236	732	1

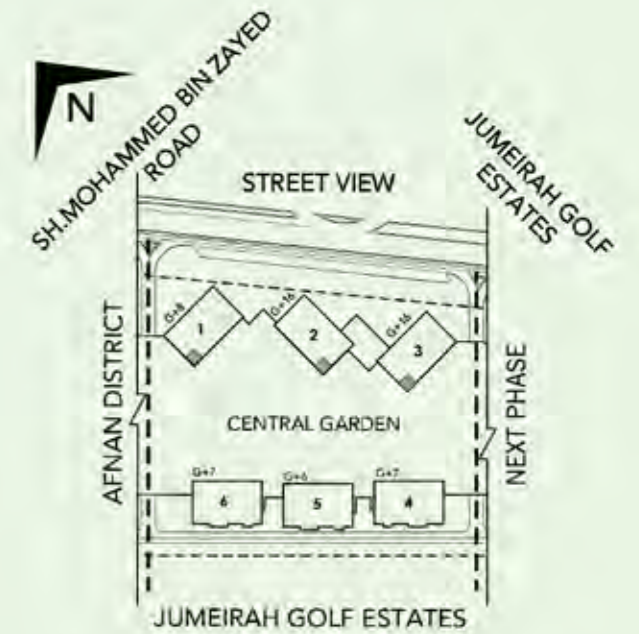

DANIA 1 & 3

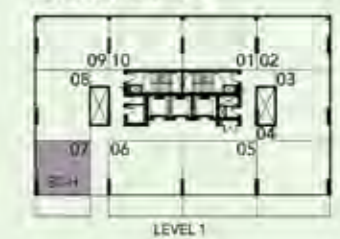

DANIA 2

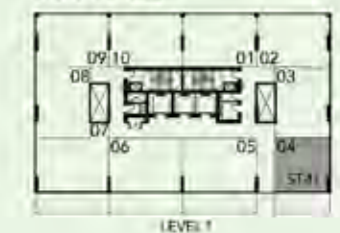

DANIA 1, 2 & 3
ONE BEDROOM APARTMENT - TYPE A & F

1BR/A

1BR/F



TYPE	UNIT NO.	LEVEL	UNIT (SQ.FT.)	BALCONY (SQ.FT.)	TOTAL (SQ.FT.)	TOTAL COUNT (NO.)
1BR/A	04 & 07	2-8	666	53	719	42
1BR/F	04 (BLDG 1 & 3)	1	716	322	1,038	2
1BR/F	07 (BLDG 2)	1	716	322	1,038	1

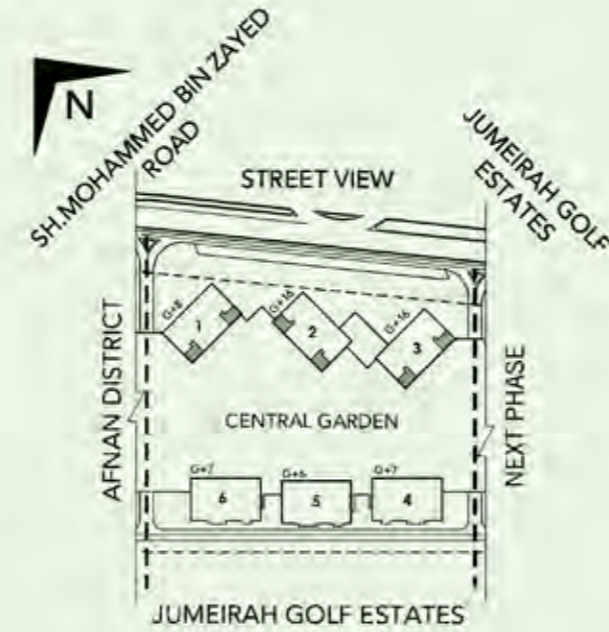

DANIA 1,2 & 3

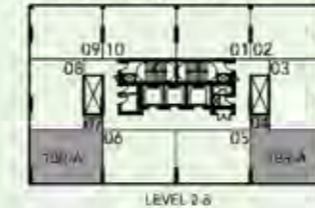

DANIA 1 & 3

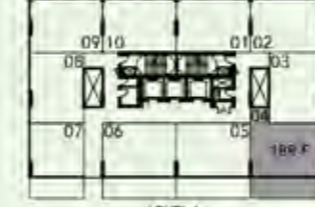

DANIA 2

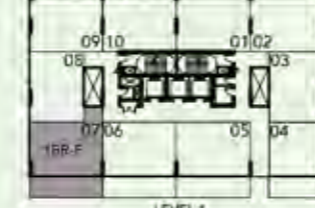

DANIA 1,2 & 3
ONE BEDROOM APARTMENT - TYPE B & C

1BR/B

1BR/C

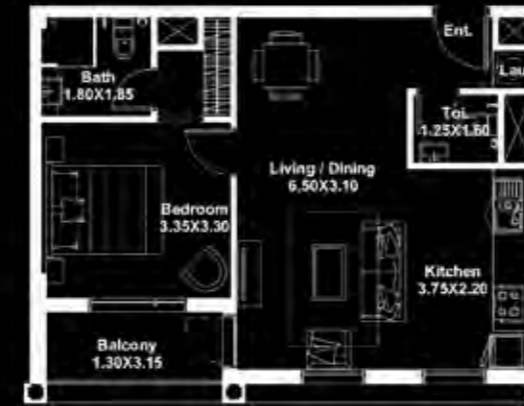

TYPE	UNIT NO.	LEVEL	UNIT (SQ.FT.)	BALCONY (SQ.FT.)	TOTAL (SQ.FT.)	TOTAL COUNT (NO.)
1BR/B	01 & 10	1-8	605	51	656	48
1BR/B	05 & 06	2-8	593	51	644	42
1BR/C	03 & 08/10	1-16	576	50	626	80

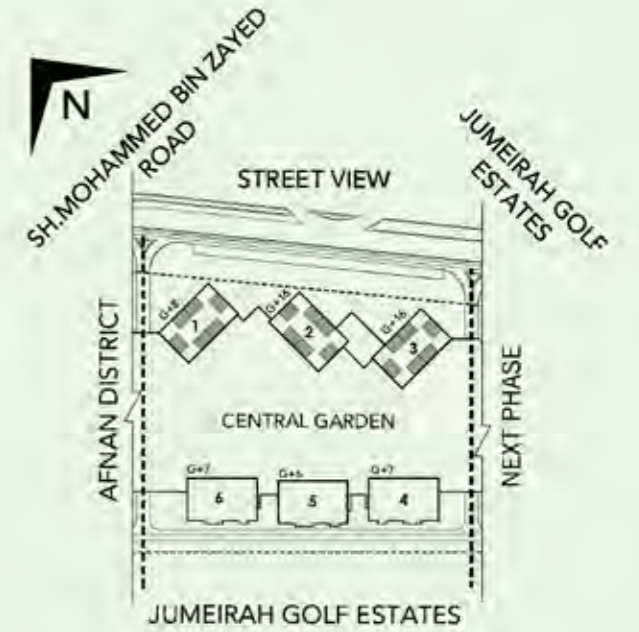

DANIA 2 & 3

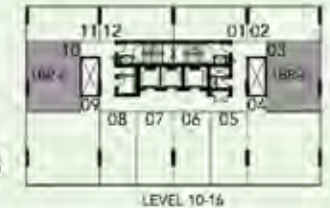

DANIA 2 & 3

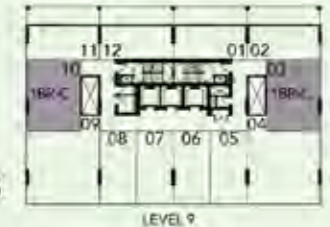

DANIA 1,2 & 3



DANIA 1,2 & 3

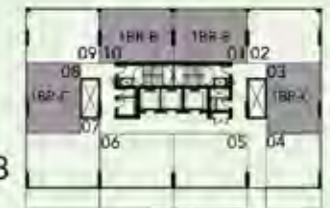

DANIA 1, 2 & 3
ONE BEDROOM APARTMENT - TYPE D & E

1BR/D



1BR/E

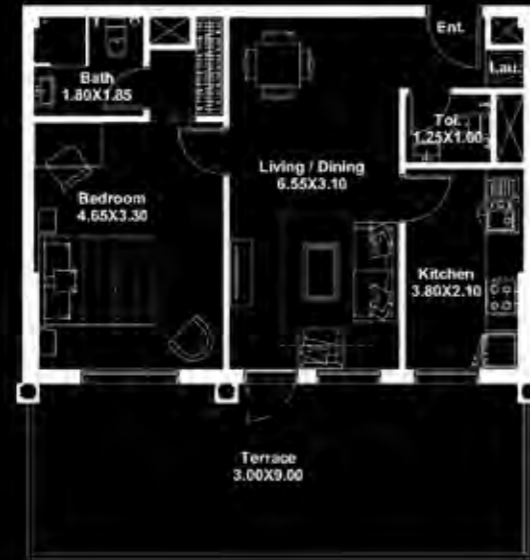

TYPE	UNIT NO.	LEVEL	UNIT (SQ.FT.)	BALCONY (SQ.FT.)	TOTAL (SQ.FT.)	TOTAL COUNT (NO.)
1BR/D	02 & 09	1-8	610	54	664	48
1BR/E	05 & 06	1	644	317	961	6

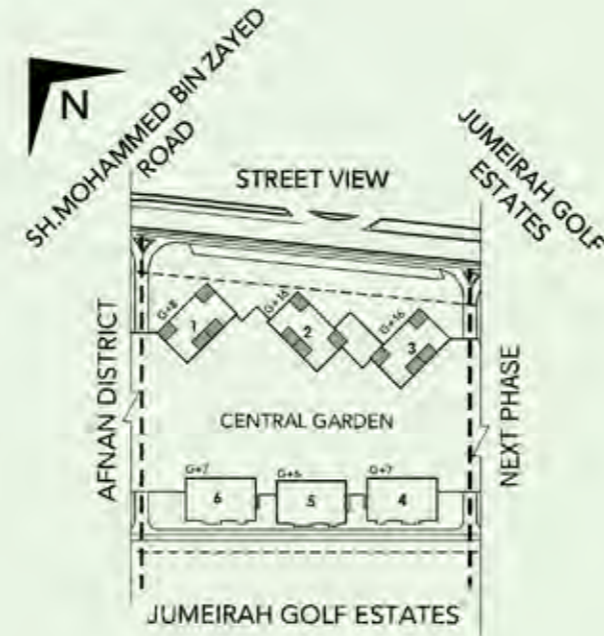

DANIA 1,2 & 3

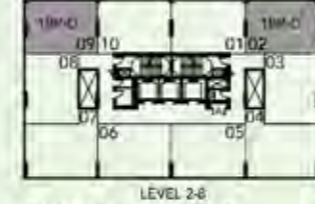

DANIA 1,2 & 3

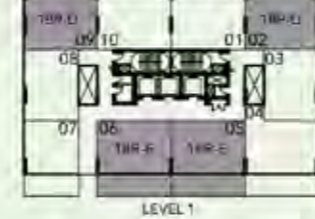

DANIA 4, 5 & 6
ONE BEDROOM APARTMENT - TYPE G

1BR/G



TYPE	UNIT NO.	LEVEL	UNIT (SQ.FT.)	BALCONY (SQ.FT.)	TOTAL (SQ.FT.)	TOTAL COUNT (NO.)
1BR/G	05, 10 & 17	2-4	677	95	772	9

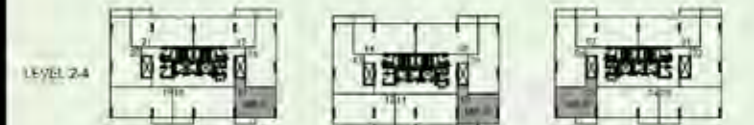
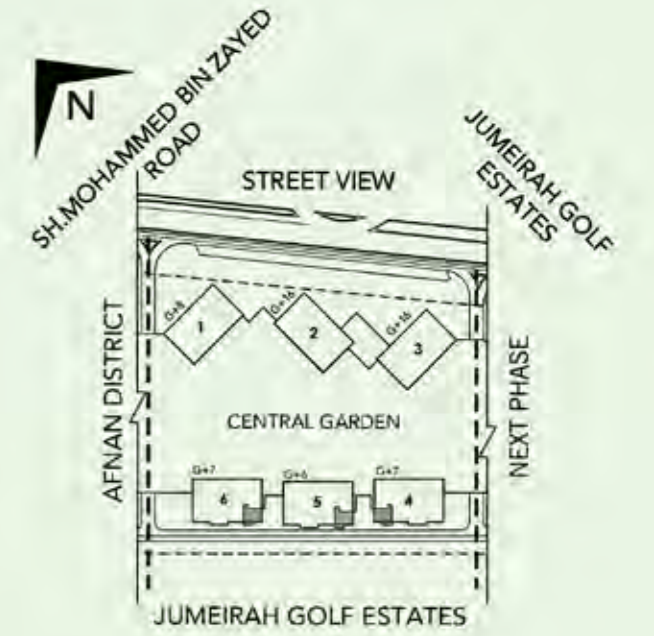

DANIA 6

DANIA 5

DANIA 4

DANIA 4, 5 & 6
ONE BEDROOM APARTMENT - TYPE H

1BR/H



TYPE	UNIT NO.	LEVEL	UNIT (SQ.FT.)	BALCONY (SQ.FT.)	TOTAL (SQ.FT.)	TOTAL COUNT (NO.)
1BR/H	03, 04 & 07	M	644	95	739	8
	05, 10 & 17	1				
	05 & 08	7				
	05, 10 & 17	5, 6	639	95	734	6

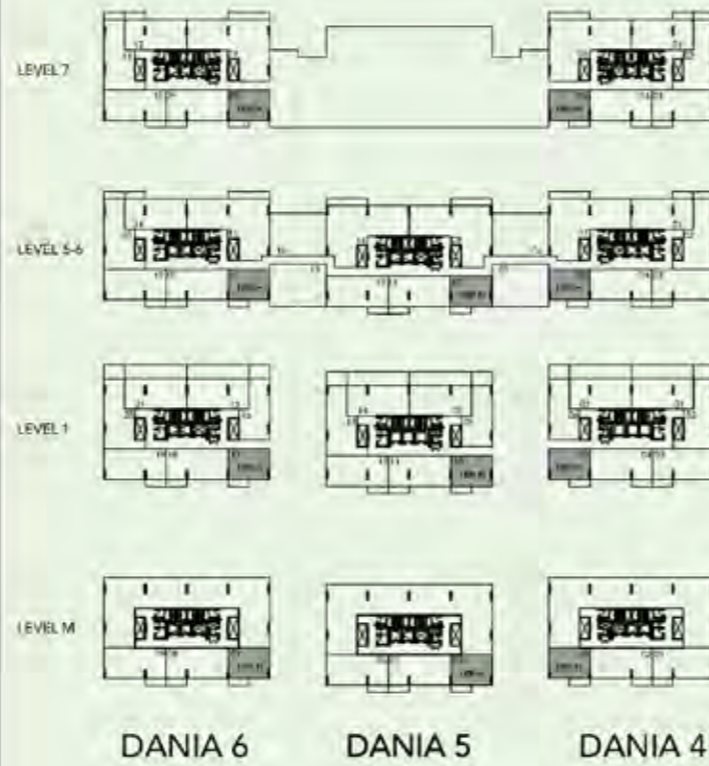
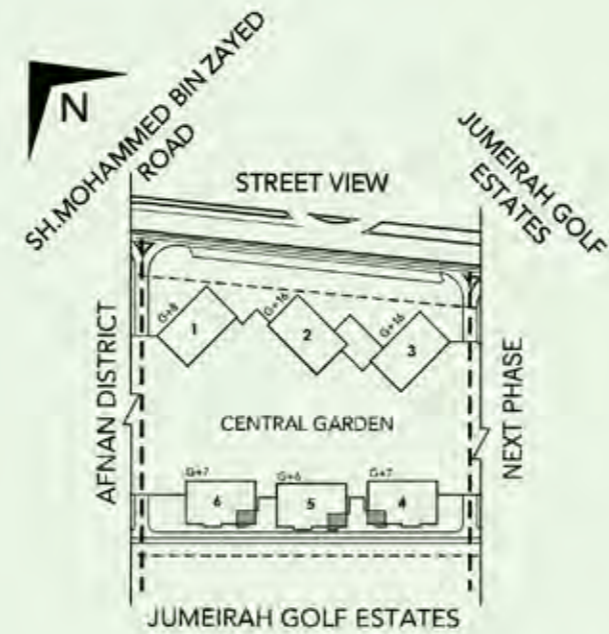

DANIA 4, 5 & 6
ONE BEDROOM APARTMENT - TYPE I

1BR/I



TYPE	UNIT NO.	LEVEL	UNIT (SQ.FT.)	BALCONY (SQ.FT.)	TOTAL (SQ.FT.)	TOTAL COUNT (NO.)
1BR/I	06, 09 & 16	1	821	150	971	3

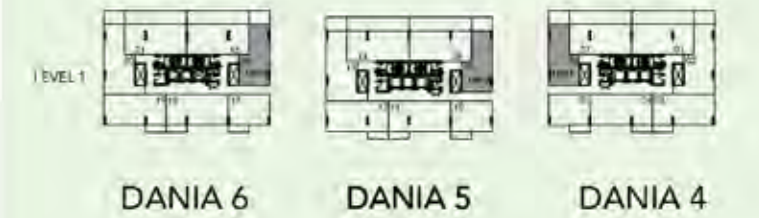
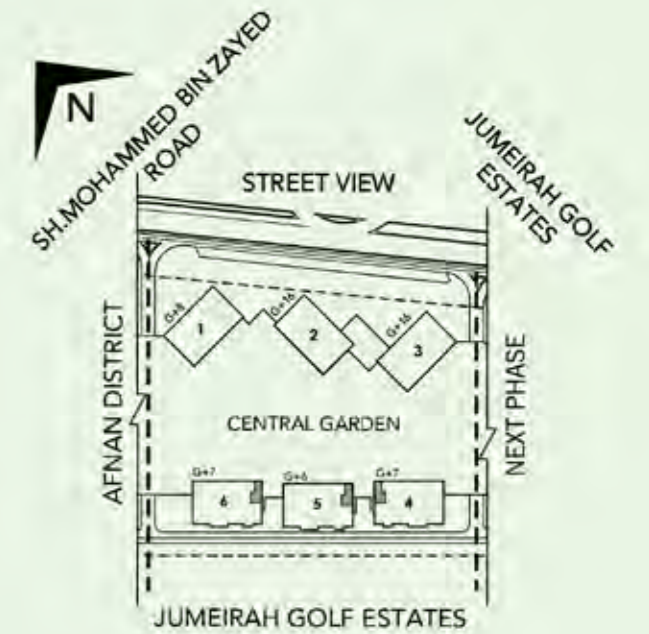

DANIA 2 & 3
TWO BEDROOM APARTMENT - TYPE A

2BR/A



TYPE	UNIT NO.	LEVEL	UNIT (SQ.FT.)	BALCONY (SQ.FT.)	TOTAL (SQ.FT.)	TOTAL COUNT (NO.)
2BR/A	04 & 09	9-16	904	69	973	32

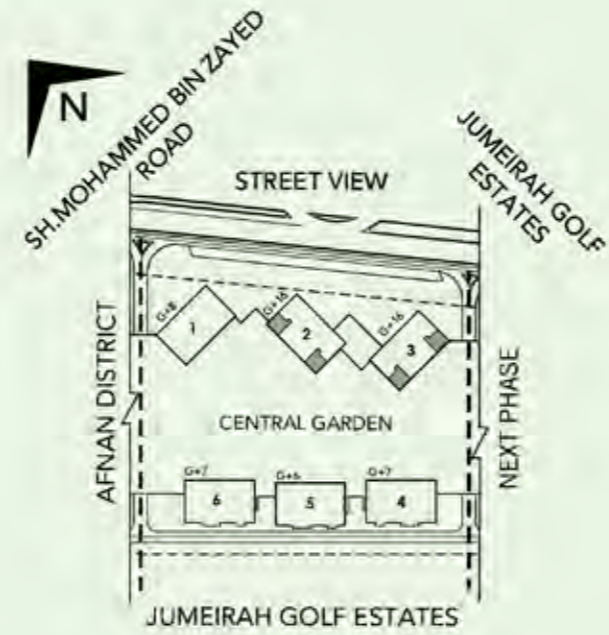

DANIA 2 & 3

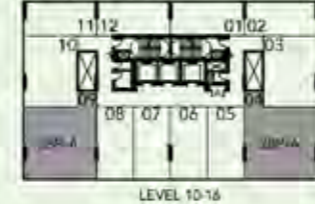

DANIA 2 & 3

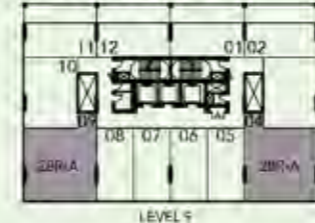

DANIA 4, 5 & 6
TWO BEDROOM APARTMENT - TYPE B

2BR/B



TYPE	UNIT NO.	LEVEL	UNIT (SQ.FT.)	BALCONY (SQ.FT.)	TOTAL (SQ.FT.)	TOTAL COUNT (NO.)
2BR/B	01, 06 & 09	M	962	99	1,061	17
	03 & 19	1-6				
	03 & 10	7				
	02, 05 & 08	M				
	04, 11, 12 & 18	1-6				
	04 & 09	7				
	01, 07, 08, 14, 15 & 21	2-4				
01 & 21	5-6	1,009	96	1,105	24	
	01 & 12	7				

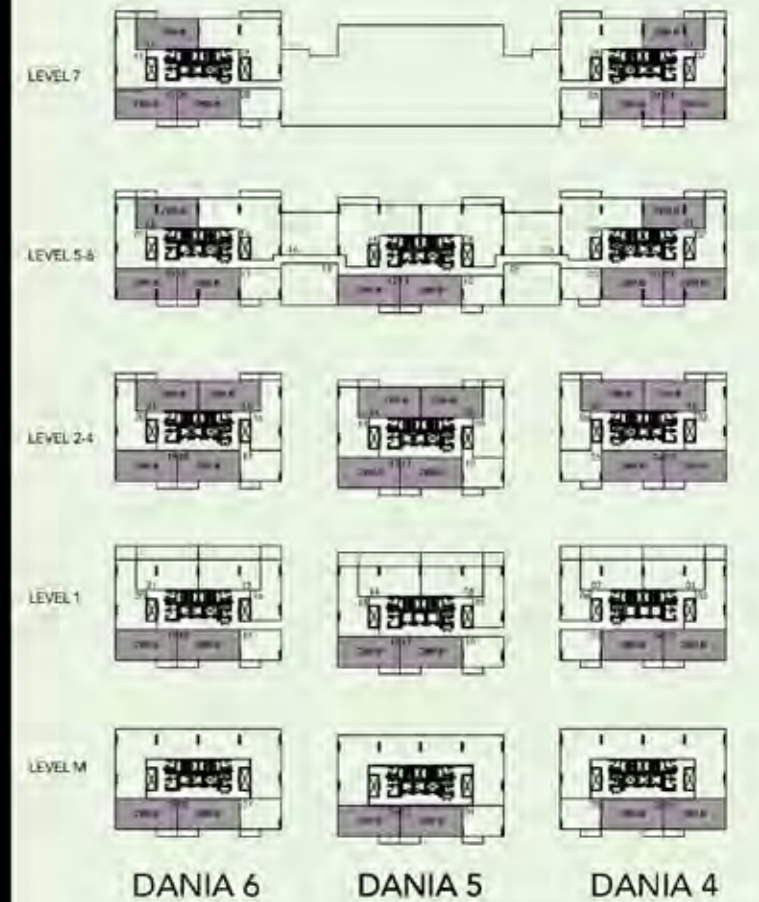
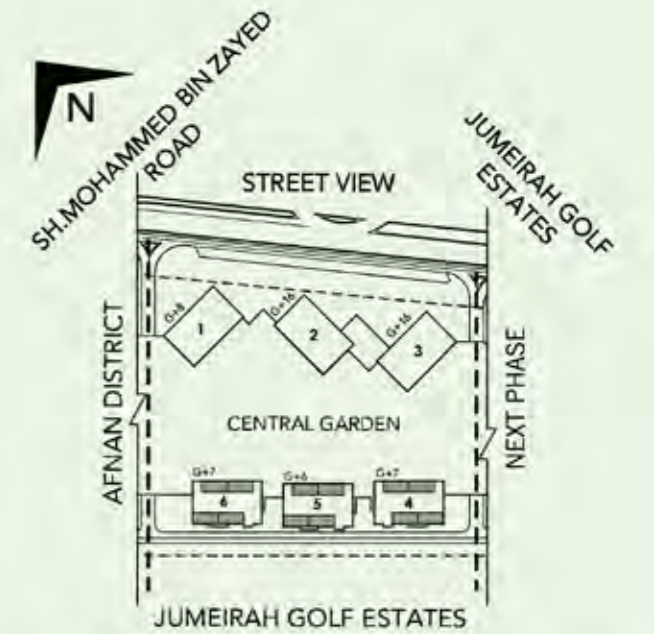

DANIA 6 DANIA 5 DANIA 4

DANIA 4, 5 & 6
TWO BEDROOM APARTMENT - TYPE C

2BR/C



TYPE	UNIT NO.	LEVEL	UNIT (SQ.FT.)	BALCONY (SQ.FT.)	TOTAL (SQ.FT.)	TOTAL COUNT (NO.)
2BR/C	06, 09 & 16	2-4	990	92	1,082	9

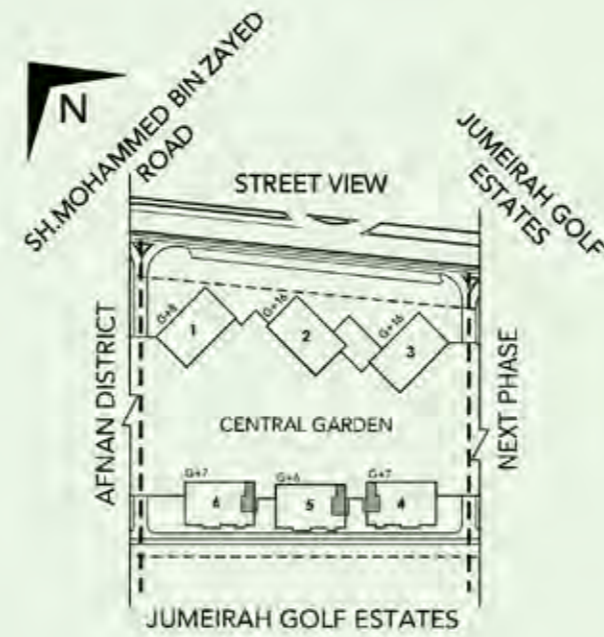

DANIA 4, 5 & 6
TWO BEDROOM APARTMENT - TYPE D

2BR/D



TYPE	UNIT NO.	LEVEL	UNIT (SQ.FT.)	BALCONY (SQ.FT.)	TOTAL (SQ.FT.)	TOTAL COUNT (NO.)
2BR/D	02, 11 & 20	2-4	1,046	92	1,138	15
	02 & 20	5-6				
	02 & 11	7				

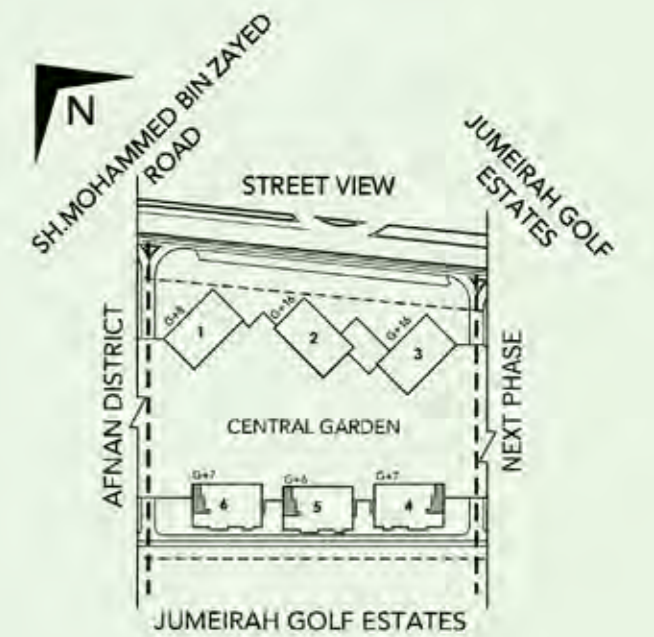

DANIA 4, 5 & 6
TWO BEDROOM APARTMENT - TYPE E

2BR/E



TYPE	UNIT NO.	LEVEL	UNIT (SQ.FT.)	BALCONY (SQ.FT.)	TOTAL (SQ.FT.)	TOTAL COUNT (NO.)
2BR/E	02, 13 & 20	1	1,046	150	1,196	3

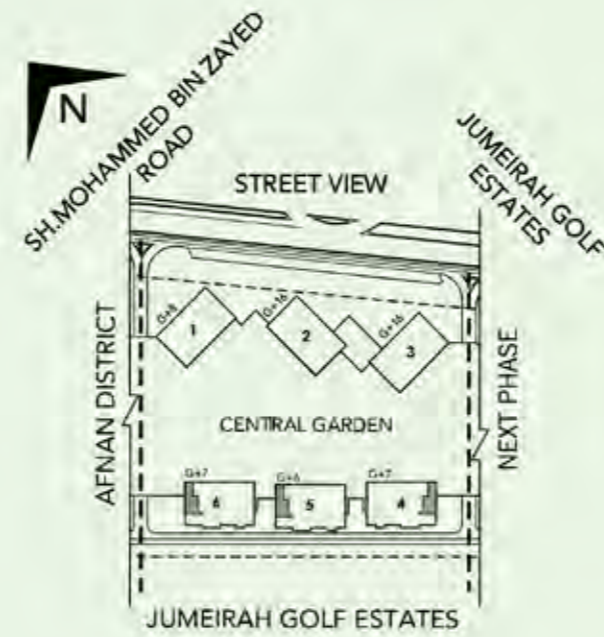

DANIA 6 DANIA 5 DANIA 4

DANIA 4, 5 & 6
TWO BEDROOM APARTMENT - TYPE F

2BR/F



TYPE	UNIT NO.	LEVEL	UNIT (SQ.FT.)	BALCONY (SQ.FT.)	TOTAL (SQ.FT.)	TOTAL COUNT (NO.)
2BR/F	01, 07, 08, 14, 15 & 21	1	1,009	461	1,470	6

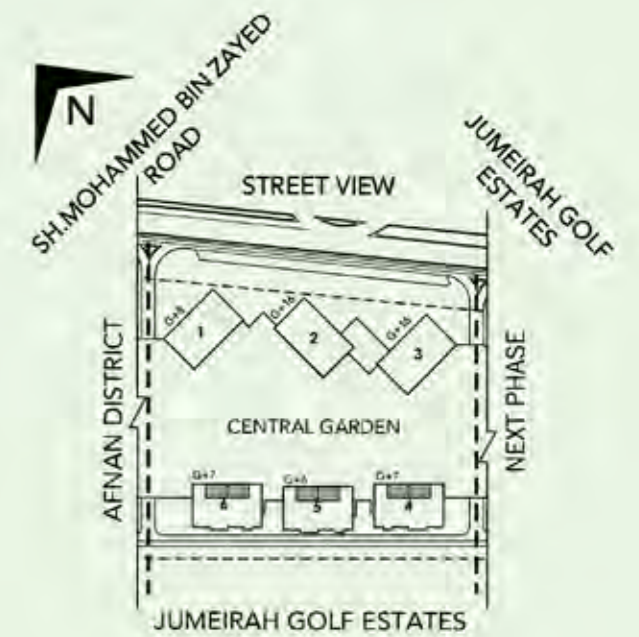

DANIA 6 DANIA 5 DANIA 4

DANIA 4, 5 & 6
TWO BEDROOM APARTMENT - TYPE G

2BR/G



TYPE	UNIT NO.	LEVEL	UNIT (SQ.FT.)	BALCONY (SQ.FT.)	TOTAL (SQ.FT.)	TOTAL COUNT (NO.)
2BR/G	06 & 16	5-6	1,105	144	1,249	4
2BR/G	09 & 13	5-6	1,134	120	1,254	4

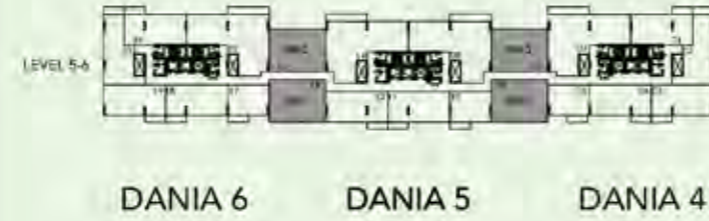
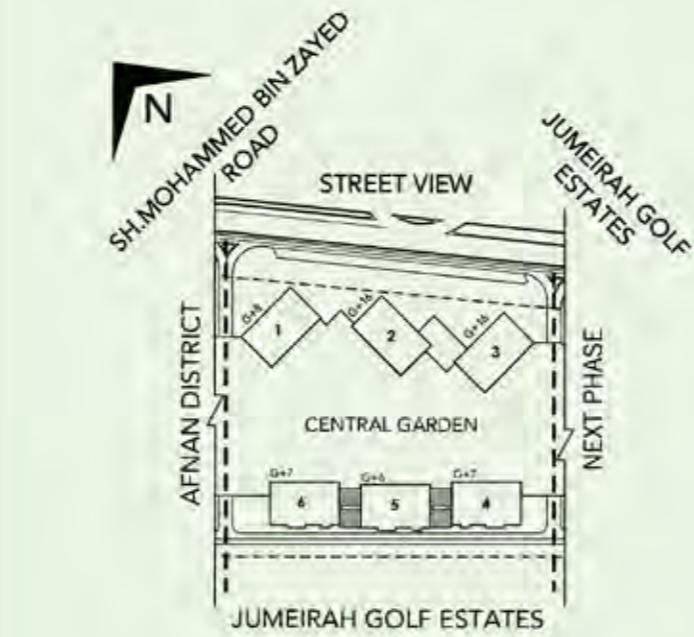

DANIA 4, 5 & 6
THREE BEDROOM APARTMENT - TYPE A

3BR/A



TYPE	UNIT NO.	LEVEL	UNIT (SQ.FT.)	BALCONY (SQ.FT.)	TOTAL (SQ.FT.)	TOTAL COUNT (NO.)
3BR/A	07,08,14 & 15	5-6	1,483	190	1,673	8
	06 & 07	7	1,484	187	1,671	2

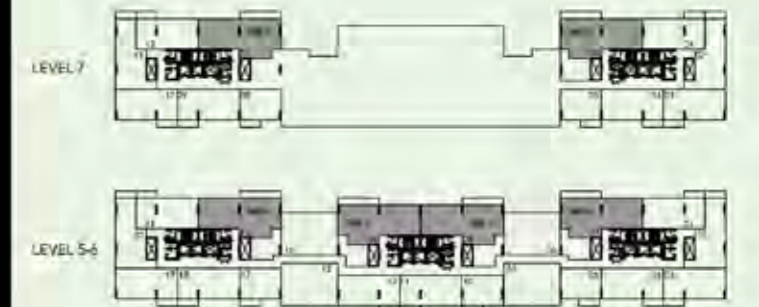
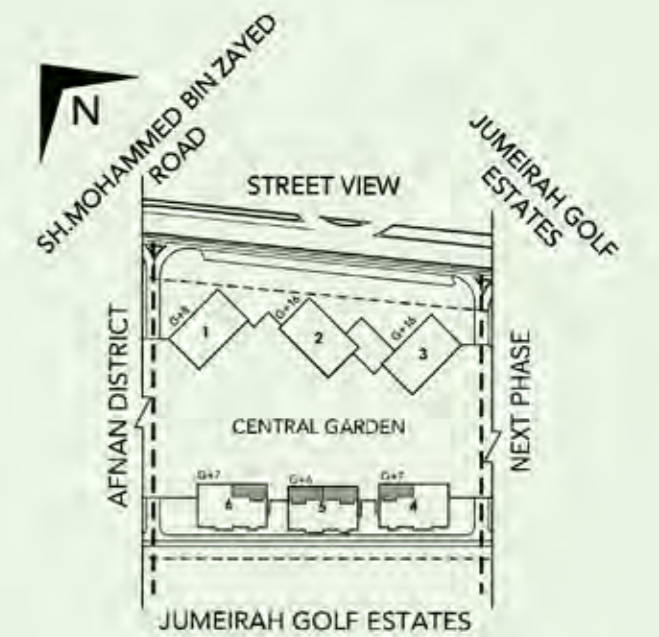

DANIA 6 DANIA 5 DANIA 4



دانية ديستركت
DANIA DISTRICT

تفضلوا بزيارتنا في مركز مبيعات ديار، برج برلنغتون، الخليج التجاري، دبي. 800 DEYAAR (339227) • www.midtown.ae
Visit us at the Deyaar Sales Centre, Burlington Tower, Business Bay, Dubai. 800 DEYAAR (339227) • www.midtown.ae