

An aerial photograph of a desert oasis. In the center, a circular pond with clear, greenish water is surrounded by a dense cluster of palm trees and other greenery. The surrounding landscape is a vast, undulating desert of golden sand dunes, with long shadows cast across them, suggesting a low sun position. The sky is a pale, hazy blue, and the overall atmosphere is serene and majestic.

LUCKY
OASIS
RESIDENCE



Up Next



Life of Pi



Big Little Lies



Continue





An unparalleled oasis nestled within the vibrant urban landscape of Jumeirah Village Circle, Dubai. Crafted by visionary architects and design experts epitomizes luxury living at its finest. Experience a lifestyle of unparalleled comfort and opulence, where every detail is meticulously curated to elevate your living experience.

**Welcome to
Lucky Oasis Residence.**

ELEVATE YOUR
LIFESTYLE WITH
UNBEATABLE
VALUE

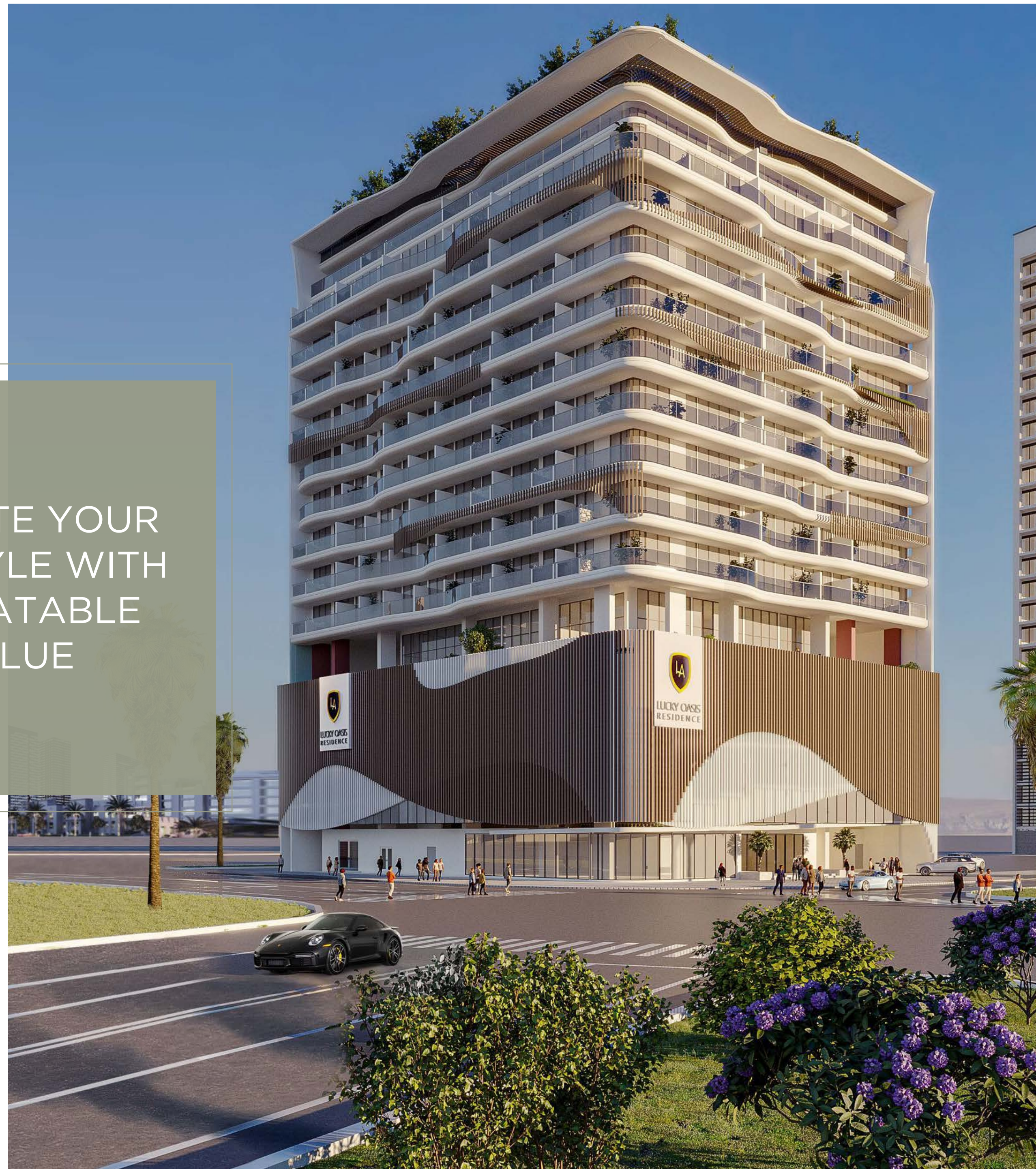

BEACH LIKE
RETREAT IN
YOUR OWN
HAVEN

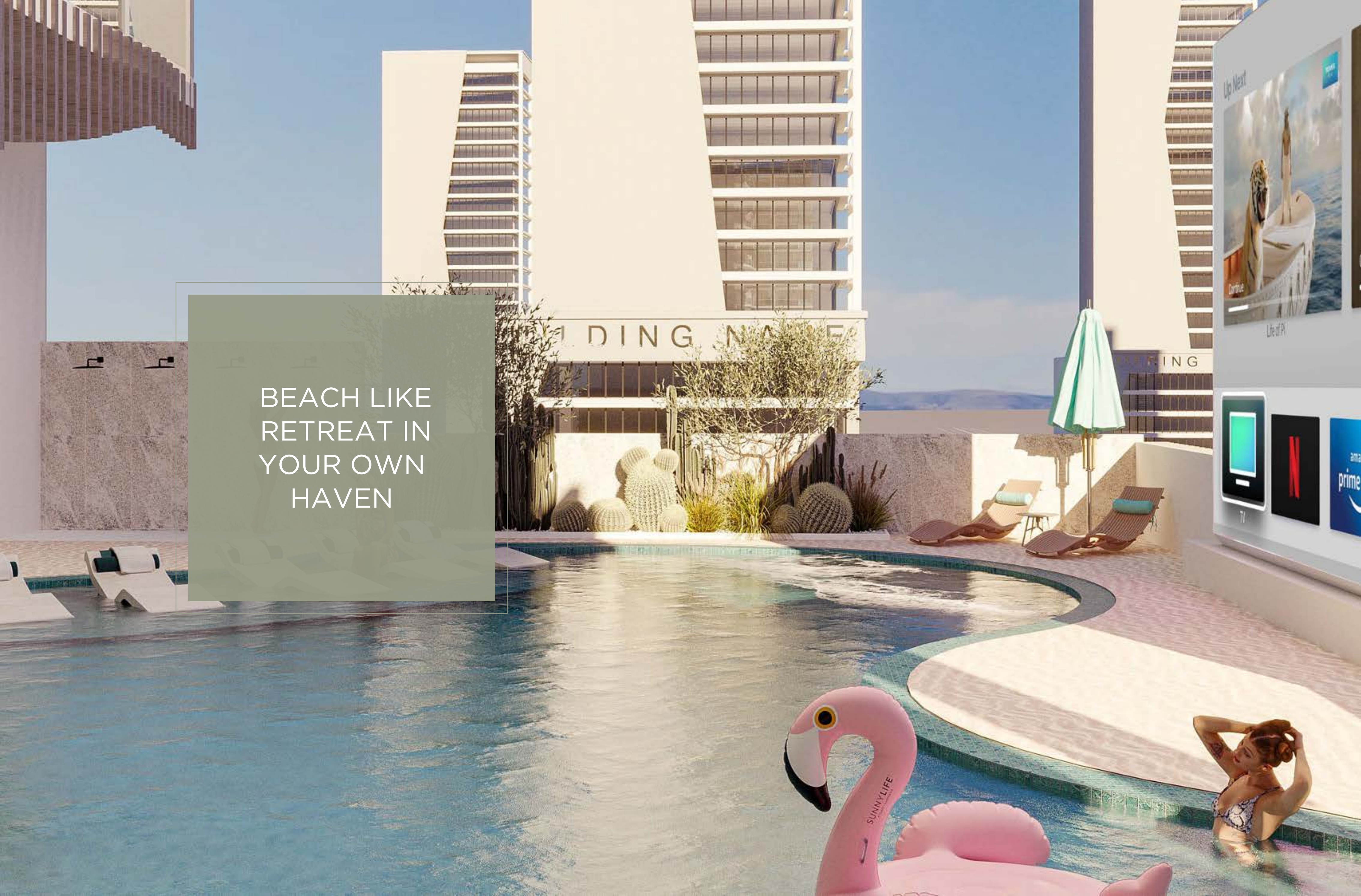



THE ESSENCE OF ELEGANCE LIES WITHIN THE DETAILS

Refined living awaits you with our carefully curated interiors tailored to complement your well deserved lifestyle. Each detail is meticulously selected, every element thoughtfully arranged; our spaces are designed to elevate your everyday experience. From luxurious furnishings to elegant accents, immerse yourself in a sanctuary that reflects your discerning taste and enhances the quality of your life.



Lucky Oasis Residence at Jumeirah Village Circle embodies luxury living in a vibrant community. Surrounded by serene landscapes in the heart of Dubai, it offers both tranquility and energy. Positioned in a bustling area, it enjoys a great neighborhood vibe and seamless connectivity. Experience the perfect balance of serenity and excitement.

REFINED
LIVING
IN A DYNAMIC
COMMUNITY



Lucky Oasis Residence Jumeirah Village Circle Location & Accessibility



Palm Jumeirah

20 minutes



Burj Al Arab

15 minutes



Dubai International Airport

30 minutes



Burj Khalifa

20 minutes



Mall of the Emirates

20 minutes

- | | |
|---------------------------------------|--|
| 1 Jumeirah Village Circle | 14 Dubai Media City |
| 2 Al Barsha South | 15 Palm Jumeirah |
| 3 Dubai Miracle Garden | 16 Mall Of The Emirates |
| 4 Arabian Ranches | 17 Dubai Hills Estate |
| 5 Damac Hills | 18 Global Village |
| 6 Motor City | 19 Burj Al Arab |
| 7 Dubai International Cricket Stadium | 20 World Islands |
| 8 Sports City | 21 Mohammed Bin Rashid Al Maktoum City |
| 9 Jumeirah Golf Estate | 22 Meydan Racecourse |
| 10 Jumeirah Islands | 23 Burj Khalifa |
| 11 Emirates Hills | 24 Dubai Mall |
| 12 Dubai Marina | 25 Dubai Design District |
| 13 Jebel Ali Race Course | 26 Dubai International Airport |

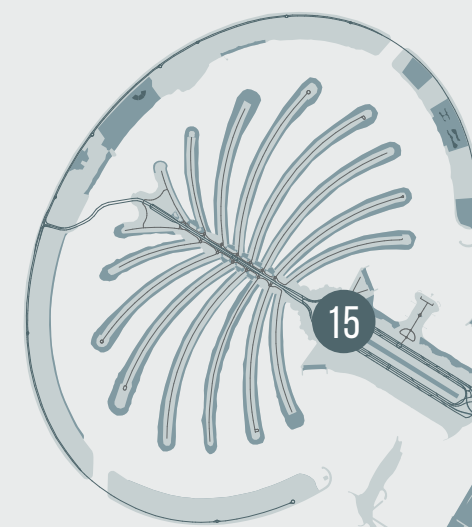

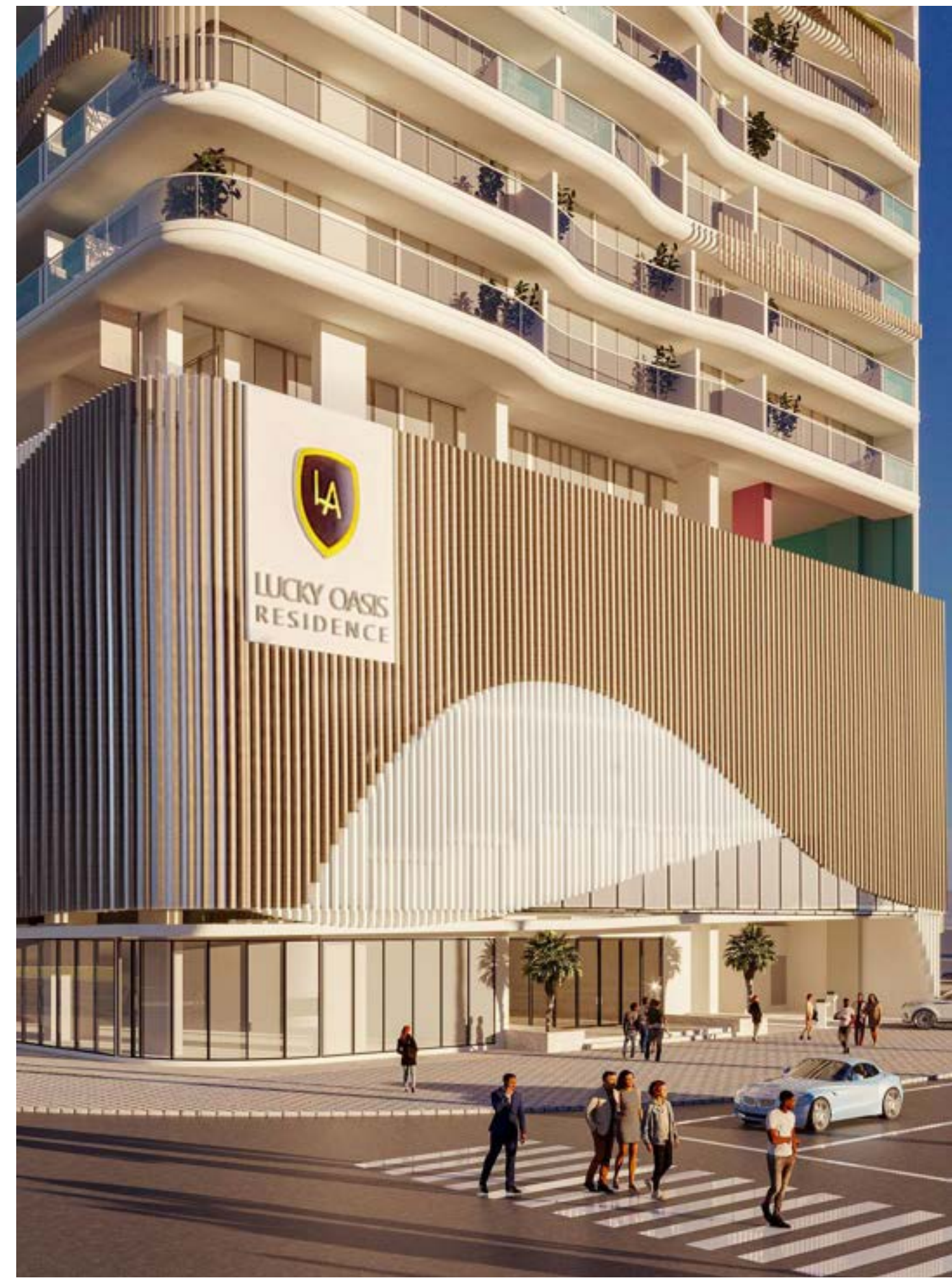

37
Studios

84
1 Bedroom

17
2 Bedrooms

5
3 Bedrooms

143
Units Total

A modern, minimalist hallway with warm lighting and a stone counter. The hallway features a light-colored tiled floor, dark wood-paneled walls, and recessed ceiling lights. A long, low stone counter is positioned on the right side, topped with a black lamp and some decorative items. A large, oval-shaped artwork is mounted on the wall behind the counter. The overall atmosphere is sophisticated and refined.

AN EXQUISITE
ENTRANCE TO
YOUR REFINED
OASIS



PRECISION IN
EVERY DETAIL,
EXCELLENCE IN
EVERY ASPECT



Enter our kitchens, where exquisite design meets functionality. Our kitchen boasts seamless aesthetics and thoughtful details, inspiring creativity and culinary experiments. From sleek countertops to premium appliances, every element is curated to elevate your cooking experience.

WHERE EVERY
CULINARY
EXPERIMENT
TRIUMPHS

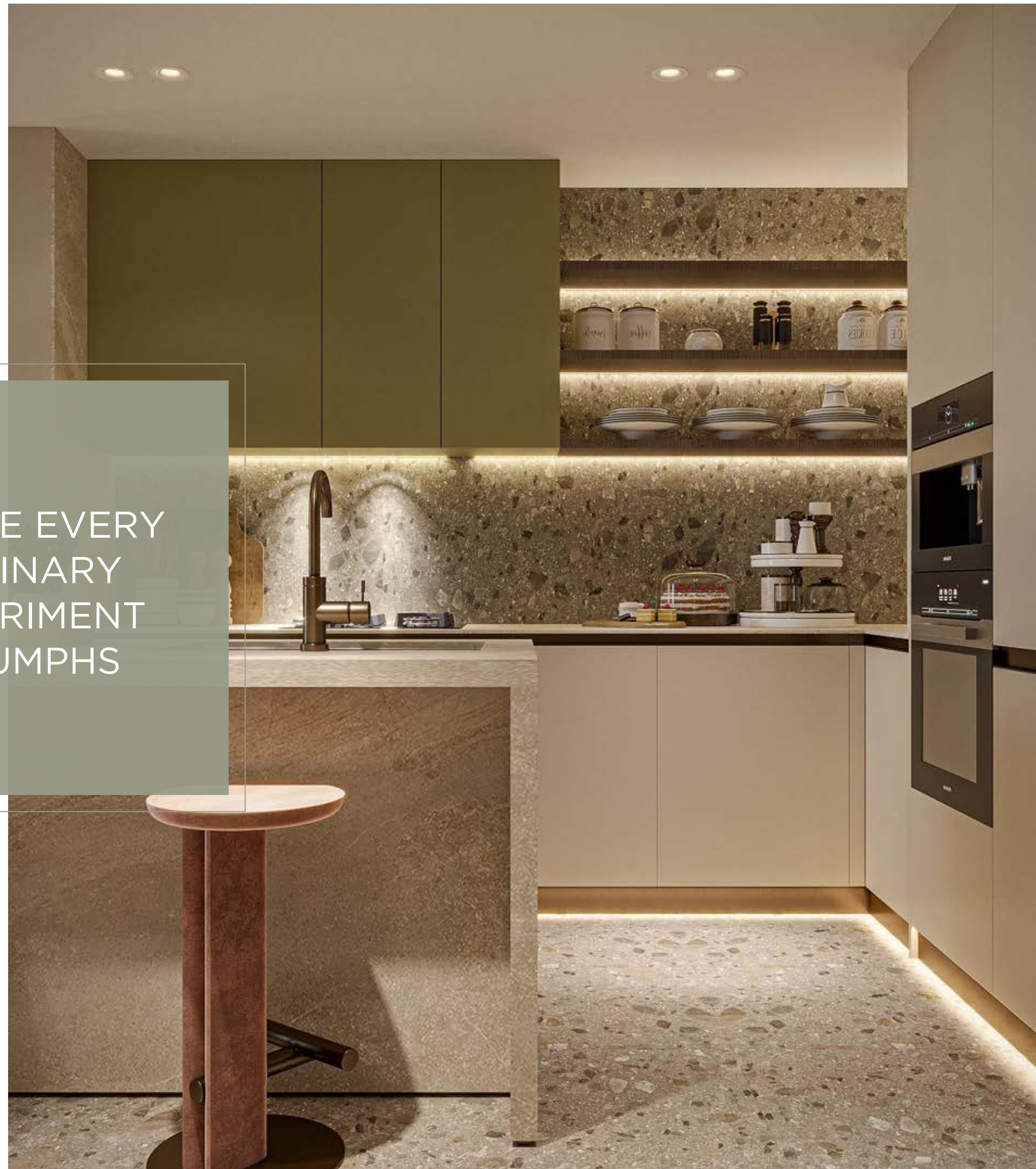



SAVOUR
THE DINING
EXPERIENCE,
EVERYTIME

From intimate gatherings to lavish feasts, this beautifully appointed area sets the stage for memorable moments shared with loved ones. With its tasteful decor and inviting vibe, our dining area is the perfect gathering spot in your home.

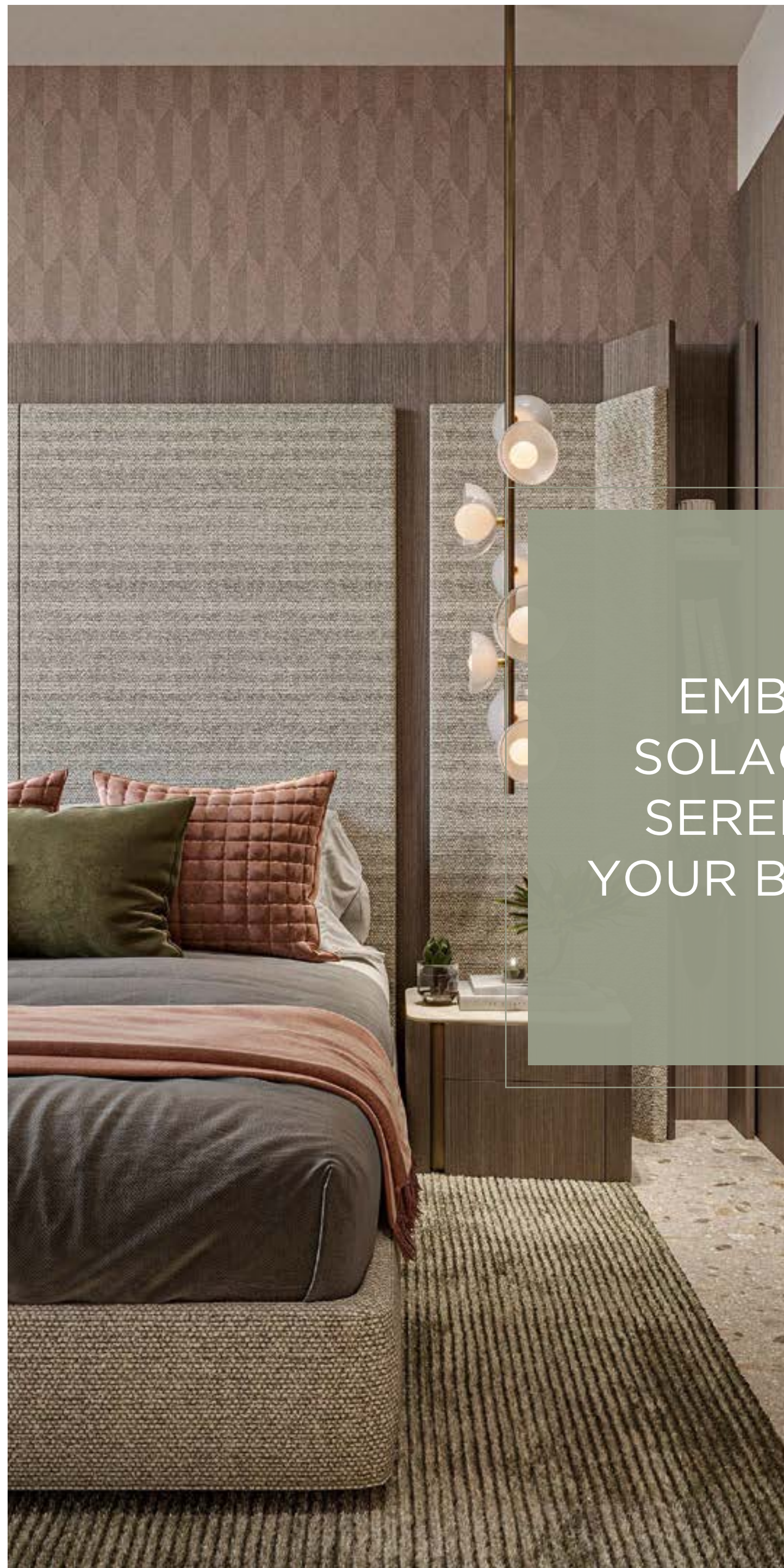

EMBRACE
SOLACE AND
SERENITY IN
YOUR BEDROOM



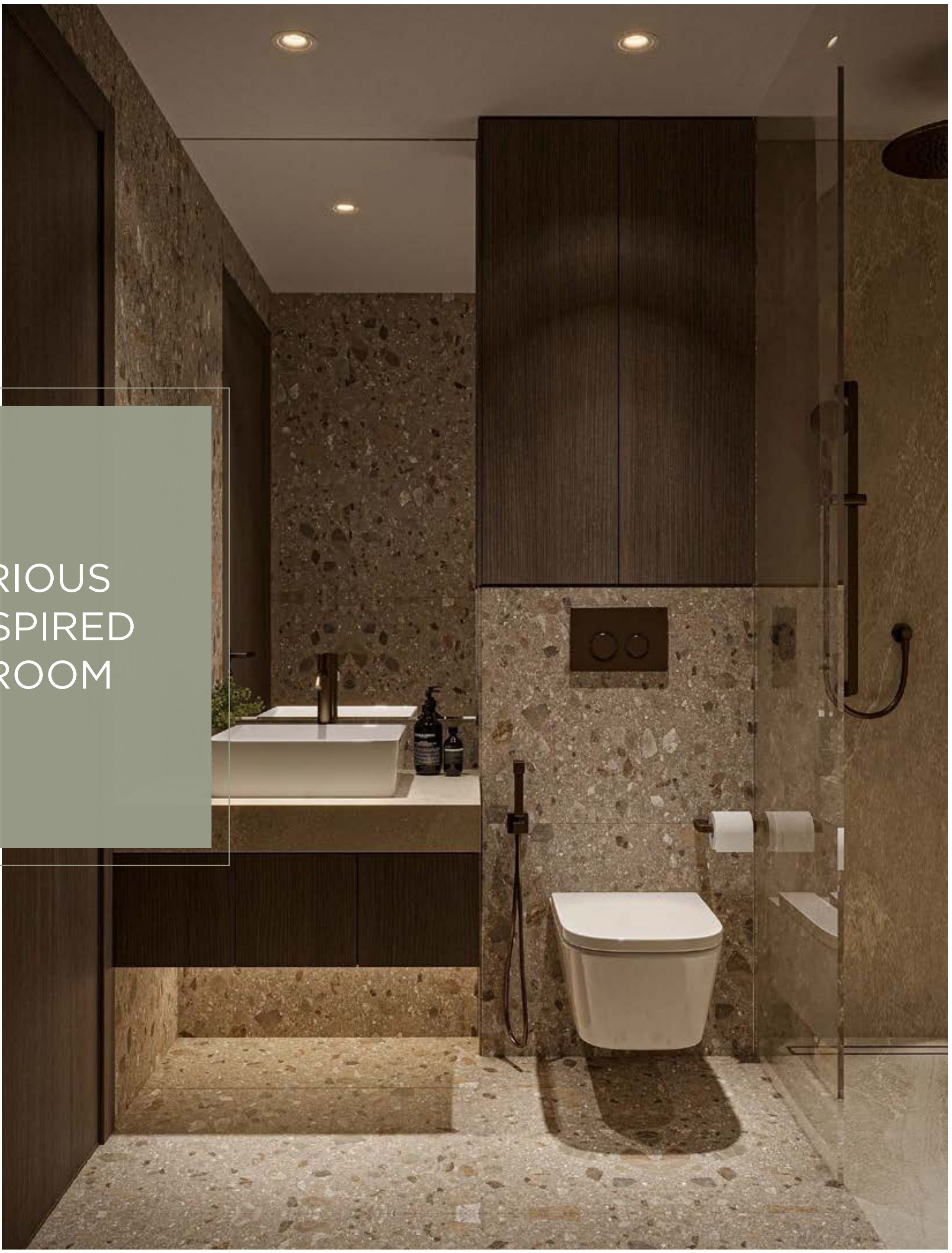

LUXURIOUS
SPA-INSPIRED
BATHROOM

A WORLD OF AMENITIES



**BEACH
POOL**



**GOLF
SIMULATOR**



**MINI GOLF
COURSE**



**GAMING
FACILITIES**



**SMART HOME
SYSTEM**



**BALCONY
PLUNGE POOL**



**SHALLOW
WATER POOL**



**KIDS
POOL**



**JOGGING
TRACK**



**CLUB
ROOM**



**PODIUM
GARDEN**



**ROOFTOP
PLUNGE POOL**



**BBQ &
GAZEBO**



**PRAYER
HALL**



**INDOOR FITNESS
STUDIO**



**YOGA
AREA**



**OUTDOOR FITNESS
STUDIO**



**STORAGE
SPACE**



**OUTDOOR
CINEMA**



**HOSPITALITY
SUITE**



**LIBRARY
CORNER**



**INDOOR KIDS
PLAY AREA**

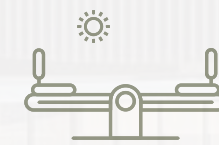

**OUTDOOR KIDS
PLAY AREA**



**CO-WORKING
SPACE**



**ARCADE
ROOM**

A modern, minimalist clubhouse interior. The space features a bar with a marble countertop and a wooden slat wall behind it. In the foreground, there is a large, light-colored modular sofa with a white throw blanket and a small table with a glass of water. The background shows a staircase with a wooden railing and a hanging planter with greenery. The lighting is warm and ambient, creating a relaxed atmosphere.

CLUBHOUSE:
ULTIMATE
RELAXATION
HUB

EMBRACE
SOCIAL
CONNECTIONS
IN OUR
ARCADE ROOM

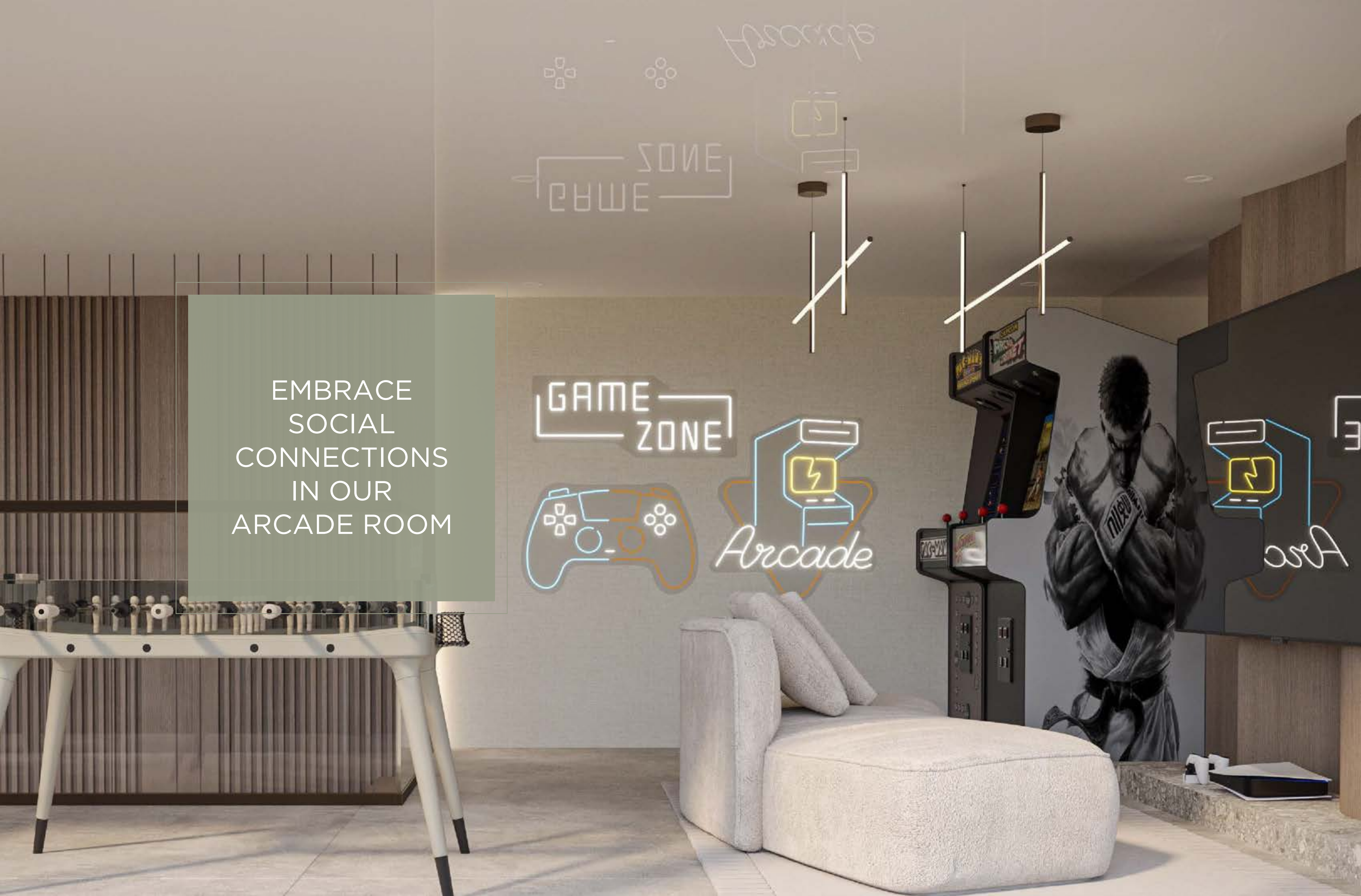



Dedicated indoor gym and kids play area, ensuring fun & laughter year-round.



Co-working area, perfect for remote work or collaborative projects.



Beach-style pool, creating a resort-like experience right at home.



A DIVERSE ARRAY OF AMENITIES THAT EXCEED EXPECTATIONS



Unwind in style at the rooftop sky lounge, with panoramic views and chic ambiance.



PUT YOUR
WAY TO
ENDLESS
FUN IN OUR
MINI GOLF
COURSE

Enjoy family-friendly fun on our mini golf course, where every swing is a delightful experience for all ages.

IMMERSE
YOURSELF IN
THE VIRTUAL
GREENS,
WHERE EVERY
SWING FEELS
LIKE REALITY

Perfect your swing and improve your game with our cutting-edge golf simulator, offering realistic gameplay and virtual courses from around the world.

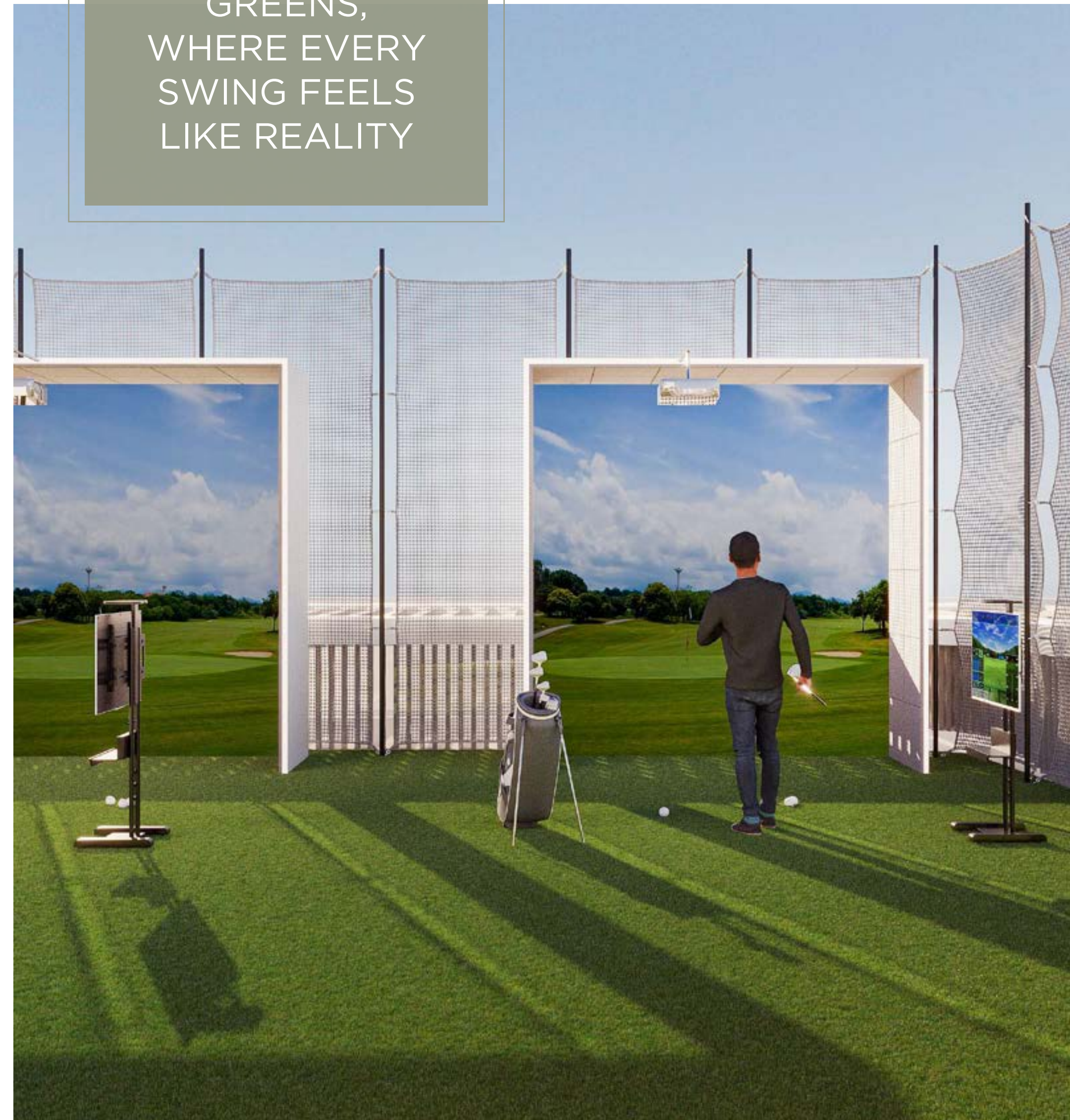

ACHIEVE
YOUR FITNESS
GOALS
WITH A VIEW

Dive into your fitness journey with our fully equipped gym, featuring high-end machines and personalized training options to help you reach your goals. all with a beach pool view!

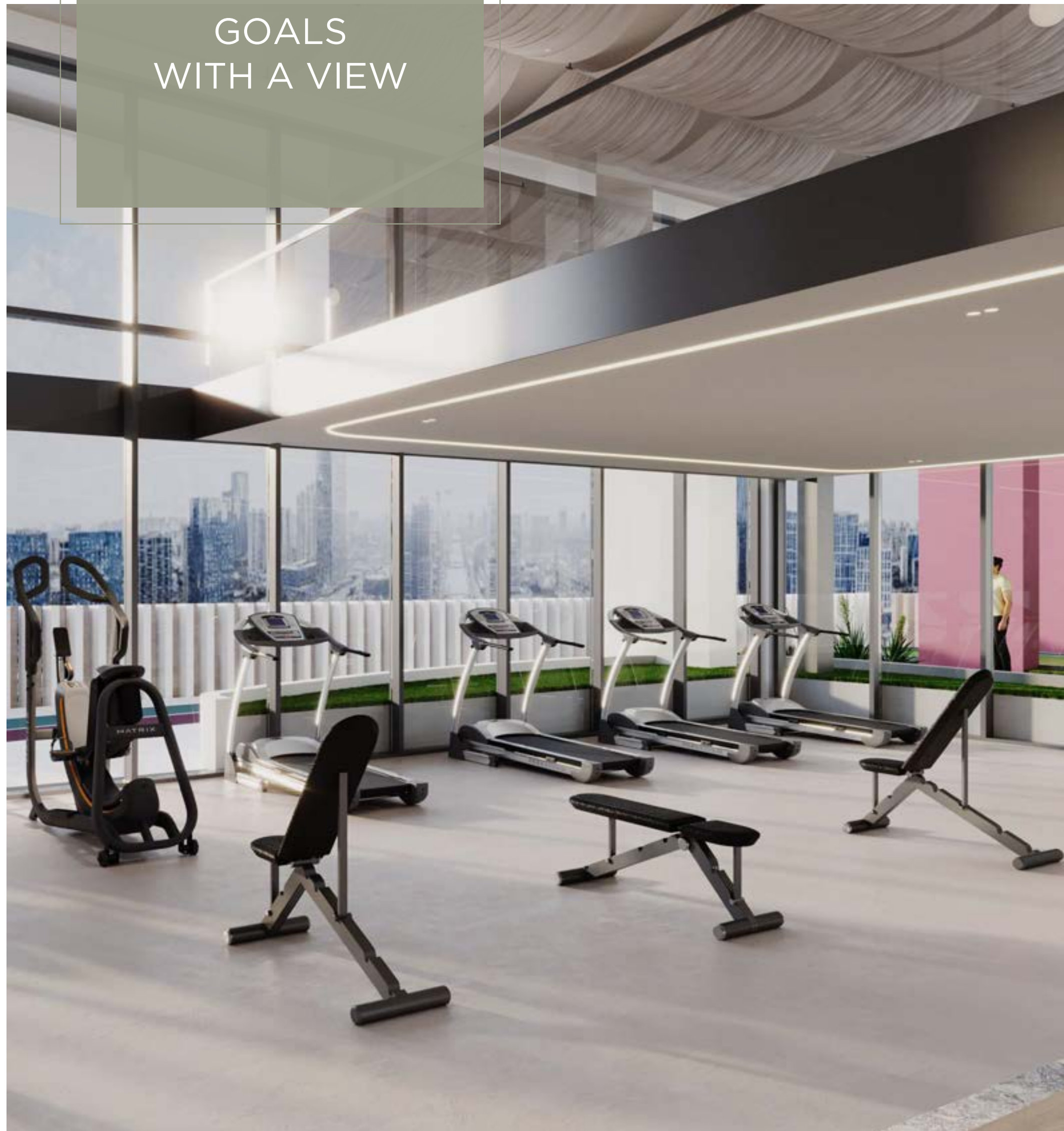

CONNECT
YOUR BODY
AND SOUL WITH
A REFRESHING
AMBIANCE

Discover inner peace and zen in our serene yoga room, designed to enhance mindfulness and relaxation through a variety of classes and meditation sessions.



KIDS ZONE



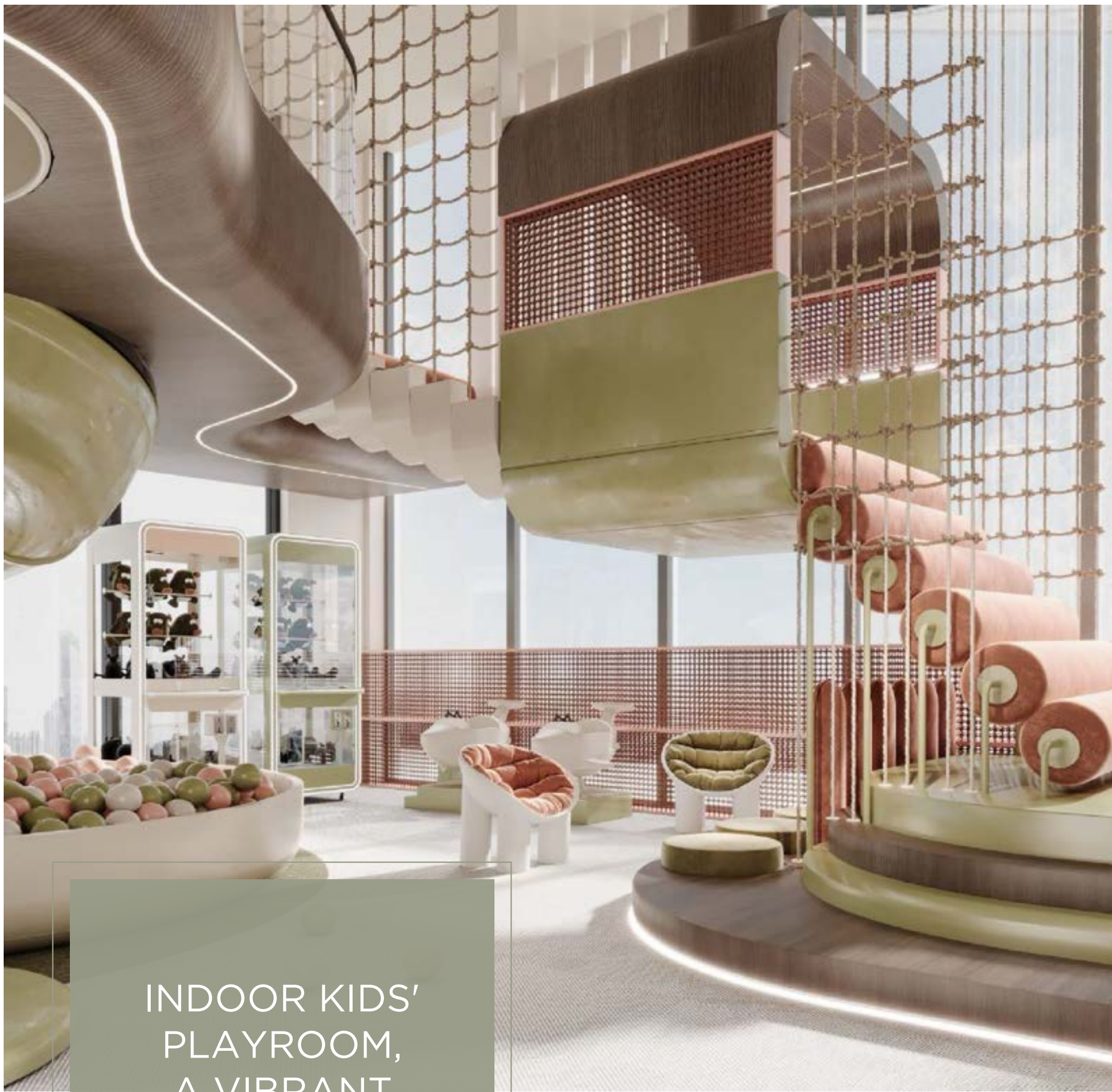

INDOOR KIDS'
PLAYROOM,
A VIBRANT
SPACE FOR
ENDLESS FUN

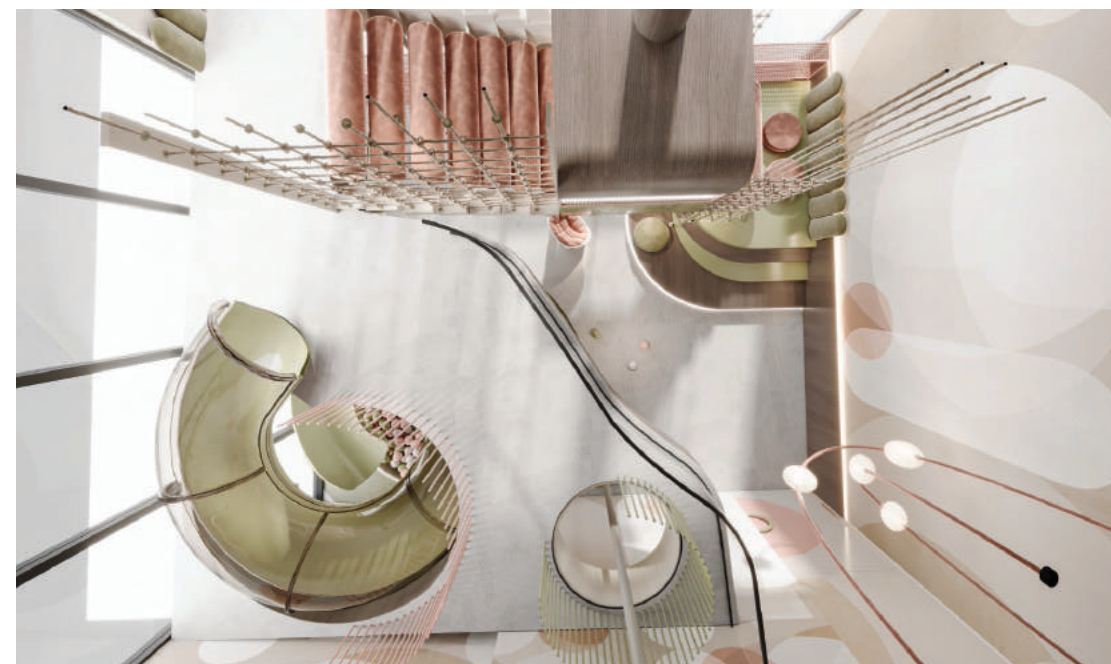

CO-WORKING
SPACE,
IDEAL FOR
COLLABORATION
AND CREATIVITY

To foster inspiration, creativity and productivity, our modern amenities and inspiring atmosphere provide the perfect backdrop for success.

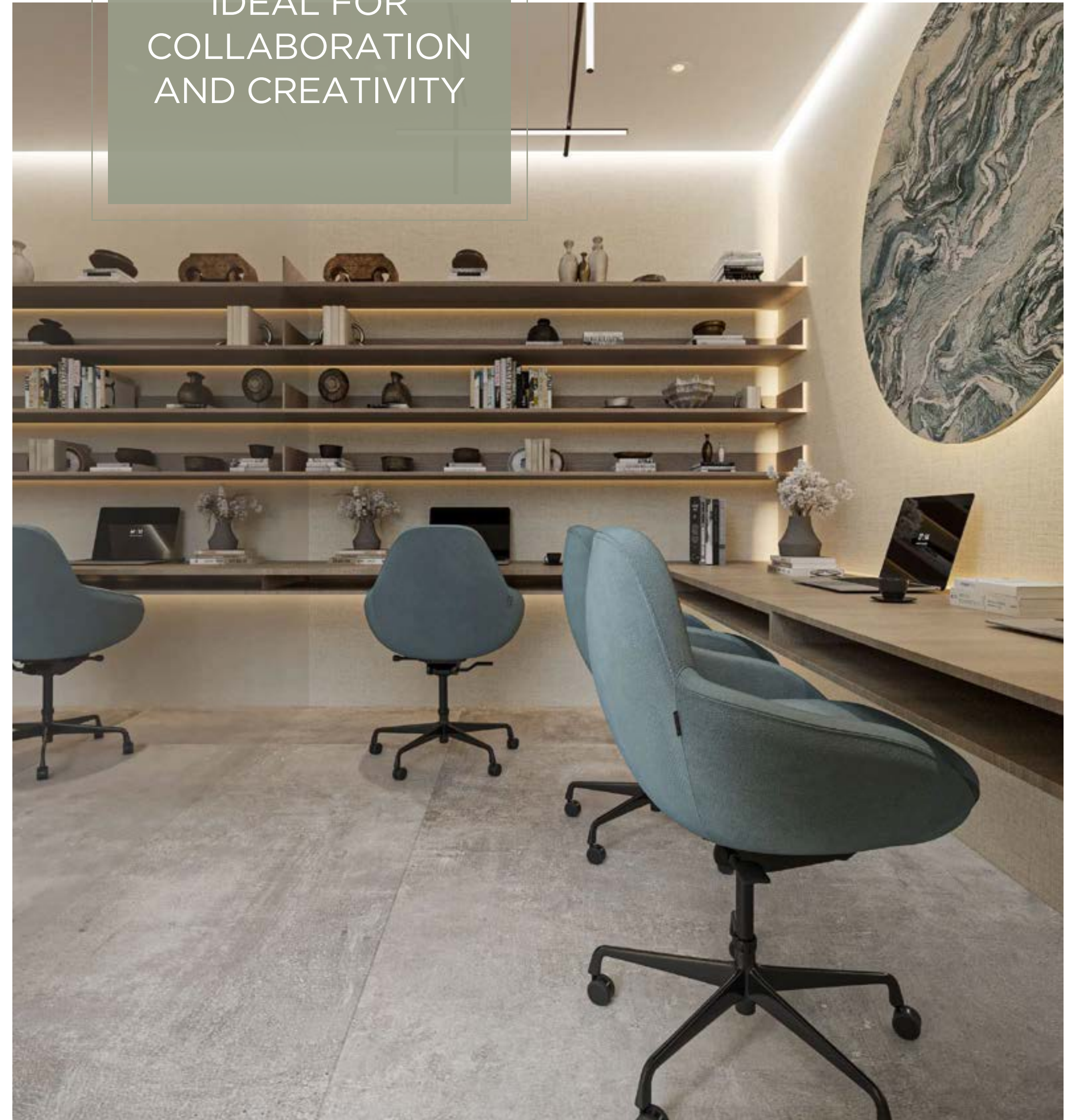

DISCOVER
SERENITY
WITH
PANORAMIC
VIEWS

Indulge in luxury and comfort in our exclusive hospitality suite, designed to provide a premium retreat for guests and special occasions.

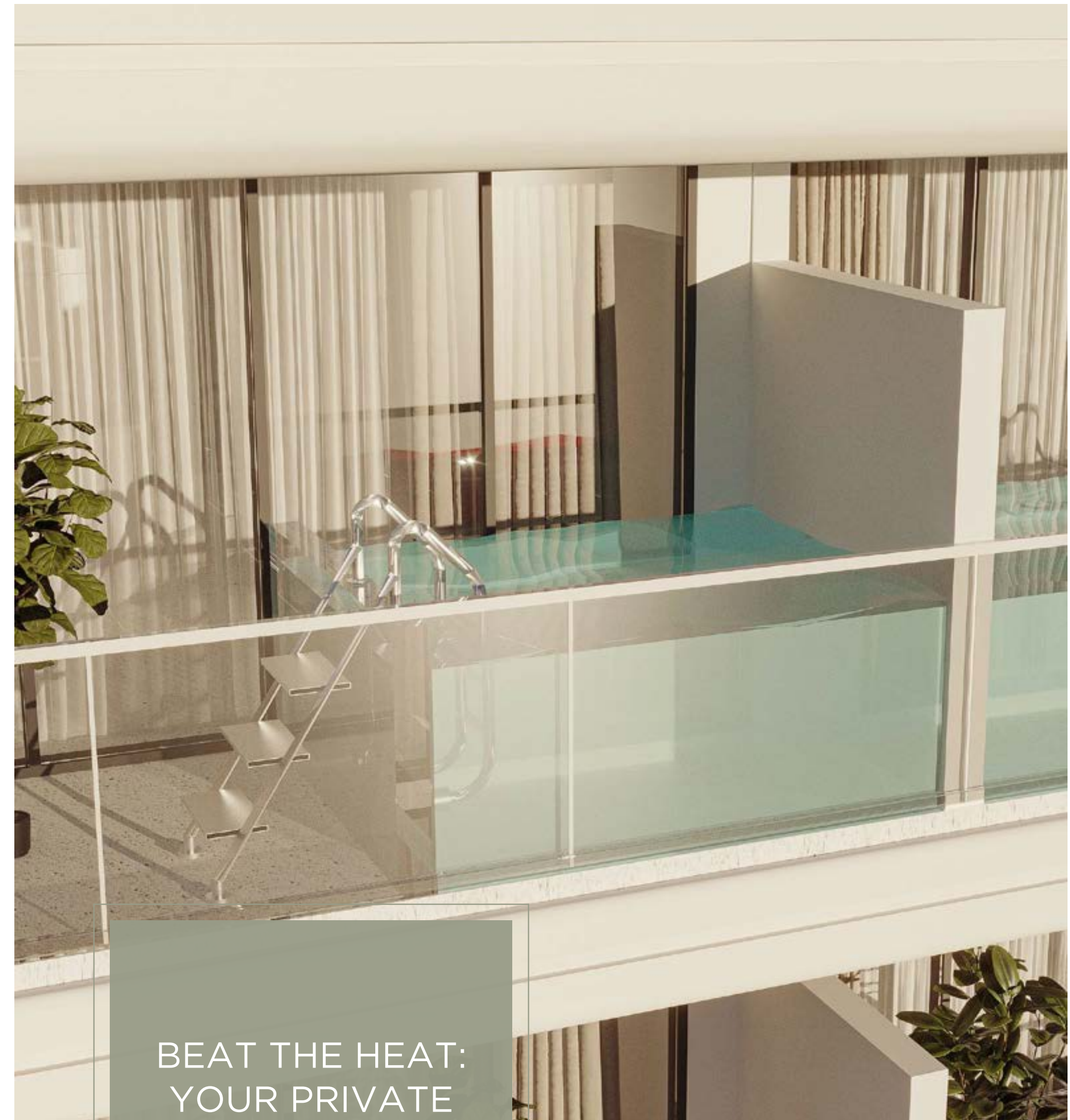
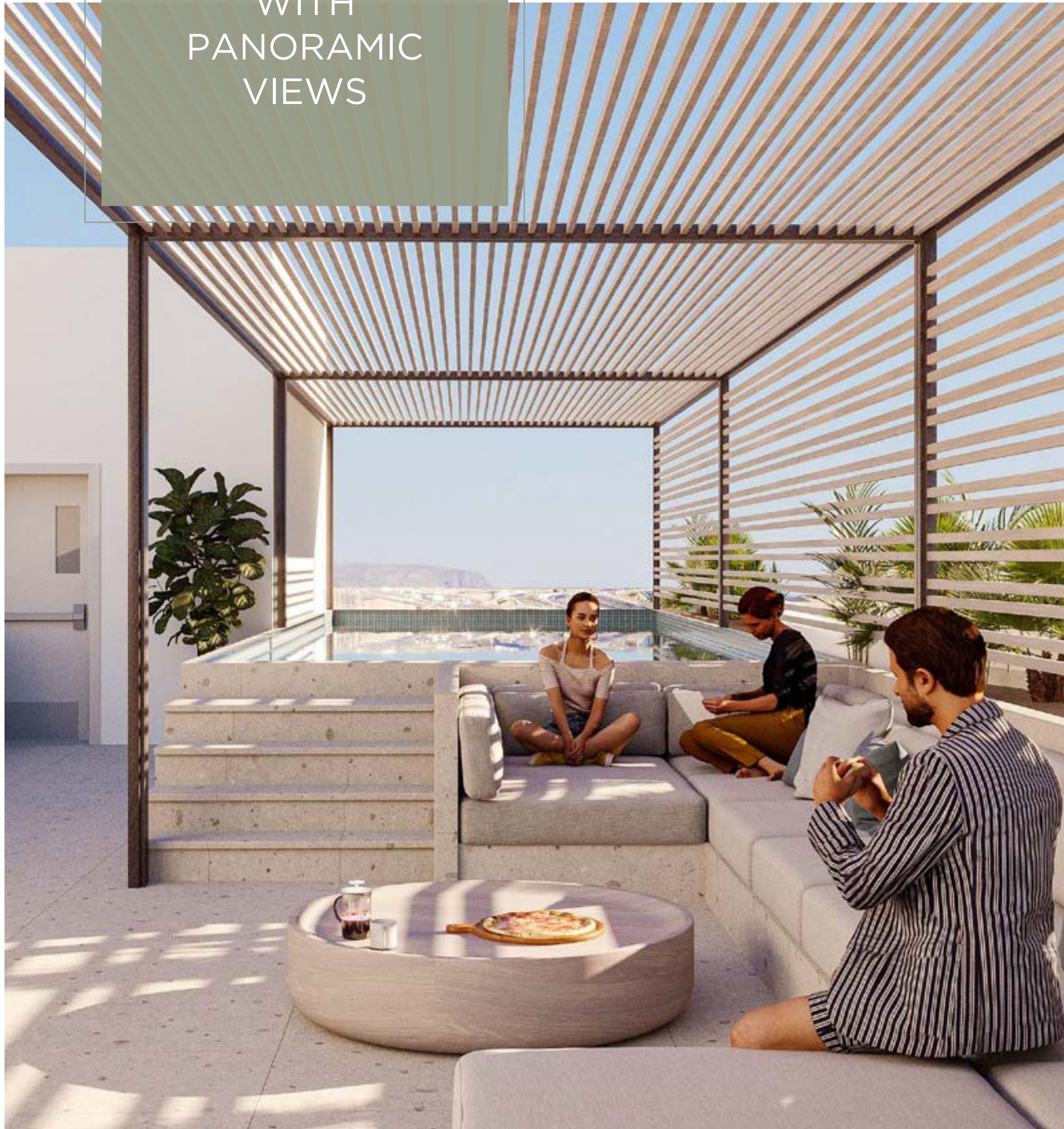

BEAT THE HEAT:
YOUR PRIVATE
PLUNGE
POOL RETREAT!

Dive into luxury with your own plunge pool experience, a vacation vibe from the comfort of your home!



HOSPITALITY
SUITE, OFFERING
A RETREAT FOR
YOUR VISITING
FAMILY AND
GUESTS

Elevate your evenings to new heights at our rooftop lounge, where you'll experience tranquil relaxation with a view.

REFLECTION &
WORSHIP:
YOUR EXCLUSIVE
MOSQUE SPACE

Find peace and tranquility in our welcoming mosque prayer space, offering solace and reflection for all visitors.

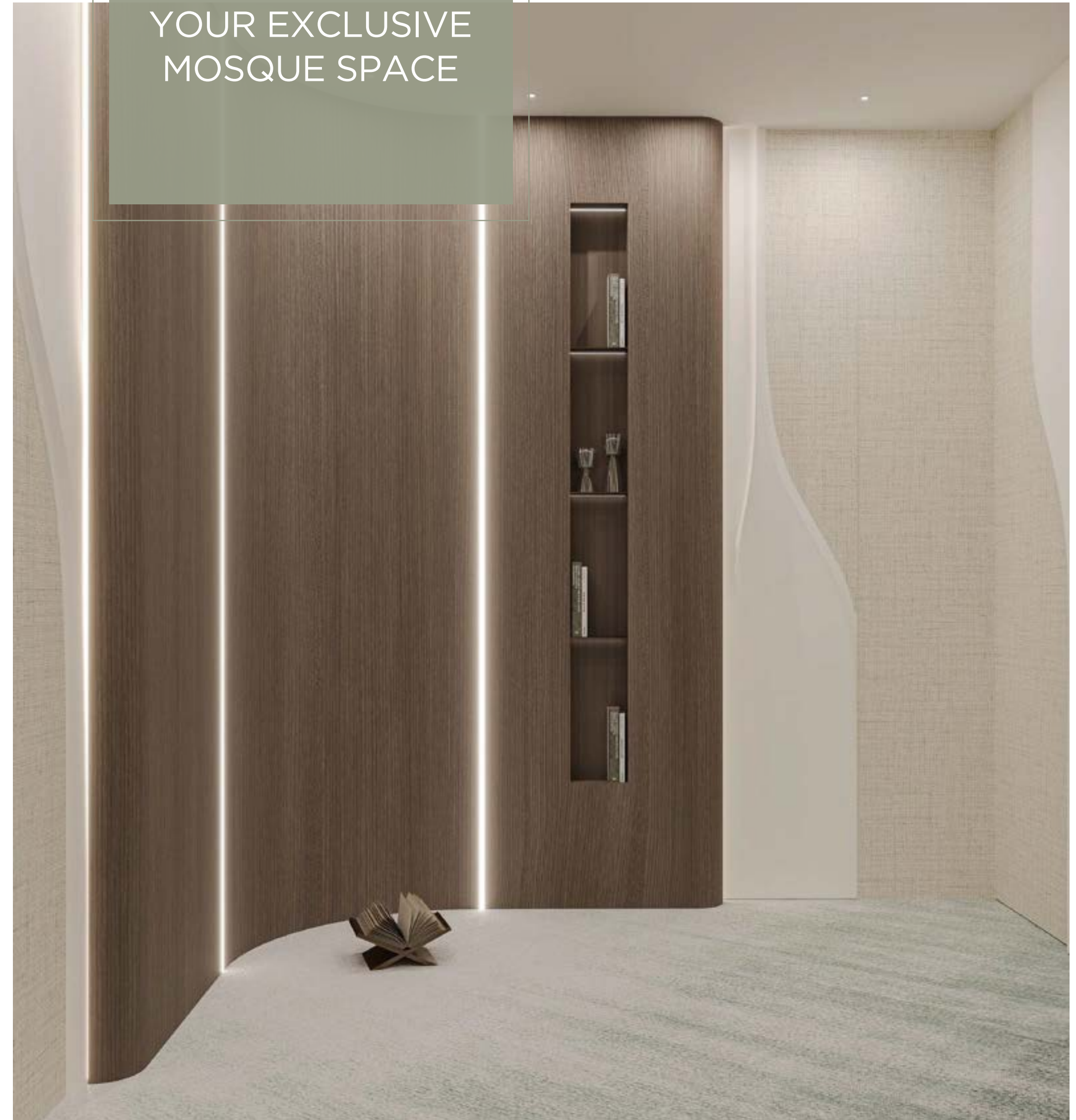

CUTTING-EDGE
SMART HOME
SYSTEM
UPGRADING
MODERN LIVING





EXQUISITE
FINISHES EXUDING
ELEGANCE



BRANDED
FITTINGS FOR
ELEVATED
LIFESTYLE



PREMIUM
INTERIOR
CRAFTSMANSHIP



DELIVERING
UNPARALLELED
QUALITY WITHOUT
COMPROMISE



LUXURY
LIVING
PERFECTED

FLOOR PLAN STUDIO



Internal Area
351.65 sq.ft
32.67 sq.m

Terrace Area
76.96 sq.ft
7.15 sq.m

Total Area
428.61 sq.ft
39.82 sq.m

**FLOOR PLAN
1 BEDROOM - TYPE 1**



Internal Area
750.33 sq.ft
69.71 sq.m

Terrace Area
410.21 sq.ft
38.11 sq.m

Total Area
1160.54 sq.ft
107.82 sq.m

**FLOOR PLAN
1 BEDROOM - TYPE 2**



Internal Area
702.24 sq.ft
65.24 sq.m

Terrace Area
158.08 sq.ft
14.50 sq.m

Total Area
858.32 sq.ft
79.74 sq.m

**FLOOR PLAN
2 BEDROOM - TYPE 1**



Internal Area
978.63 sq.ft
90.92 sq.m

Terrace Area
225.93 sq.ft
20.99 sq.m

Total Area
1204.56 sq.ft
111.91 sq.m

**FLOOR PLAN
2 BEDROOM - TYPE 2**



Internal Area
752.81 sq.ft
69.94 sq.m

Terrace Area
408.38 sq.ft
37.94 sq.m

Total Area
1161.19 sq.ft
107.88 sq.m

**FLOOR PLAN
3 BEDROOM - TYPE 1**



Internal Area
1464.61 sq.ft
136.07 sq.m

Terrace Area
546.35 sq.ft
52.43 sq.m

Total Area
2028.96 sq.ft
188.50 sq.m

**FLOOR PLAN
3 BEDROOM - TYPE 2**



Internal Area
1582.82 sq.ft
147.06 sq.m

Terrace Area
978.42 sq.ft
90.90 sq.m

Total Area
2561.24 sq.ft
237.96 sq.m



Kitchen
**EUROPEAN
KITCHEN**



Door
**90° FIRE RATED
DOOR**

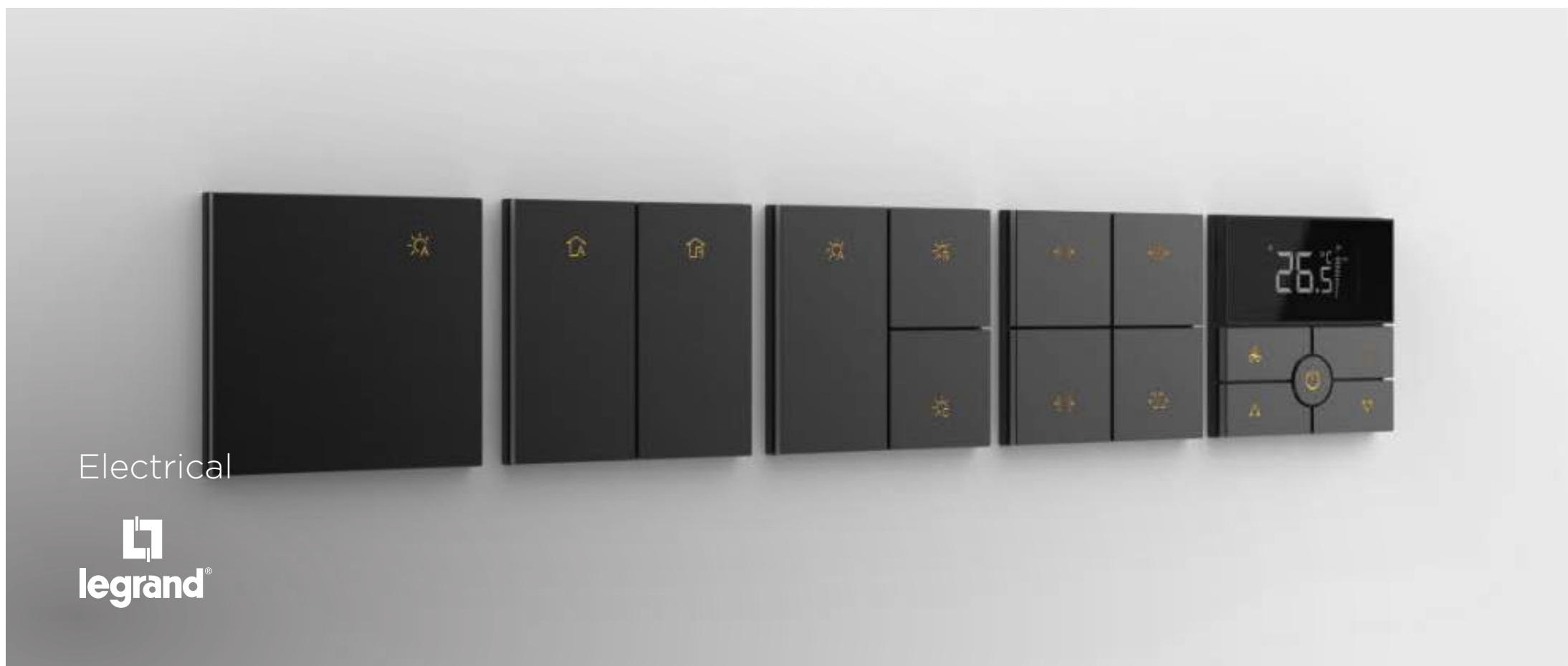

Electrical
legrand

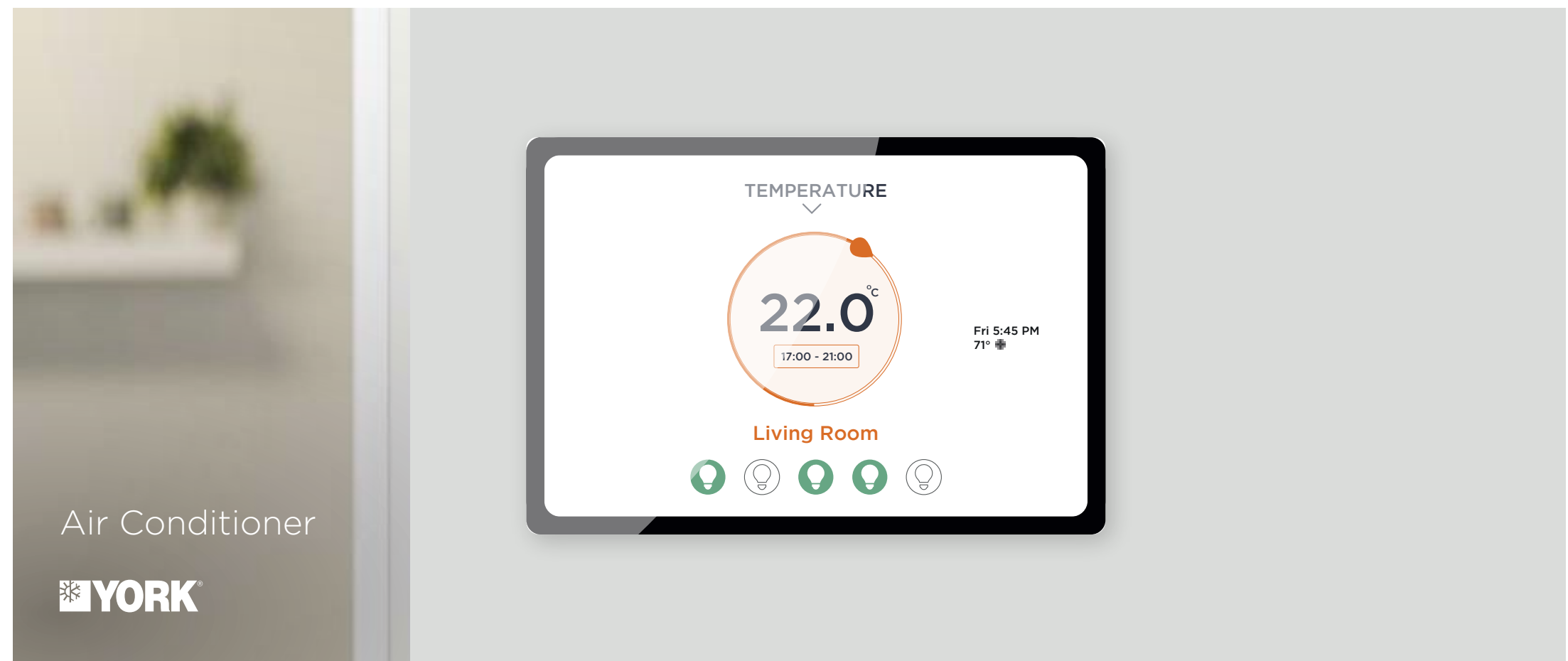

Air Conditioner
YORK



Tiles
**EUROPEAN
PORCELAIN TILES**



Bathroom Fittings
KLUDI



The Promise of Lucky Aeon

At Lucky Aeon, we take pride in our esteemed reputation within the competitive realm of real estate development. Our philosophy revolves around ensuring a seamless and enjoyable property investment journey. We prioritize cultivating strong client relationships and ensuring satisfaction at every phase of the process.

Investing in a property by Lucky Aeon transcends mere financial decision making; it signifies an investment in a brand characterized by excellence and a profound passion for crafting exceptional living environments. We eagerly anticipate collaborating with you to realize your real estate investment aspirations.

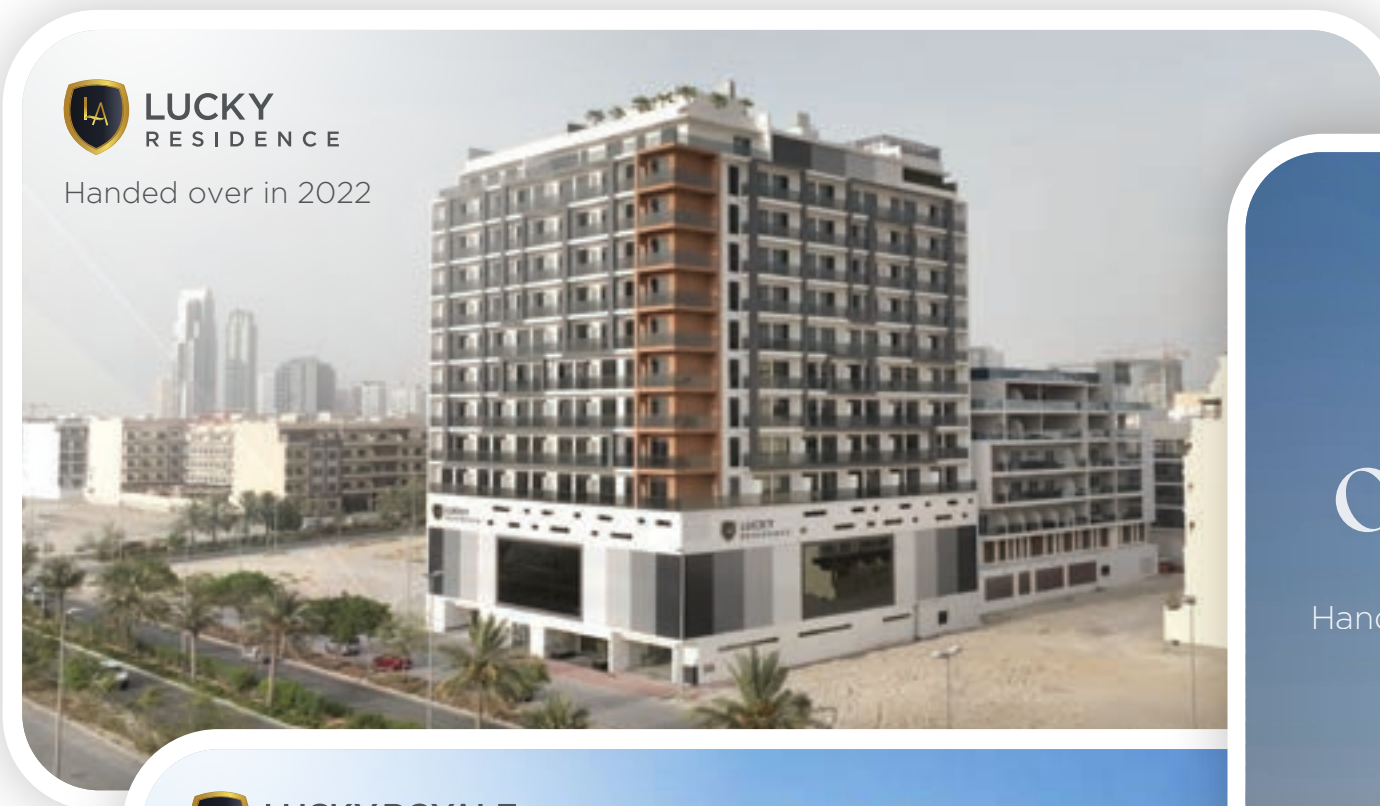

TIMELINE

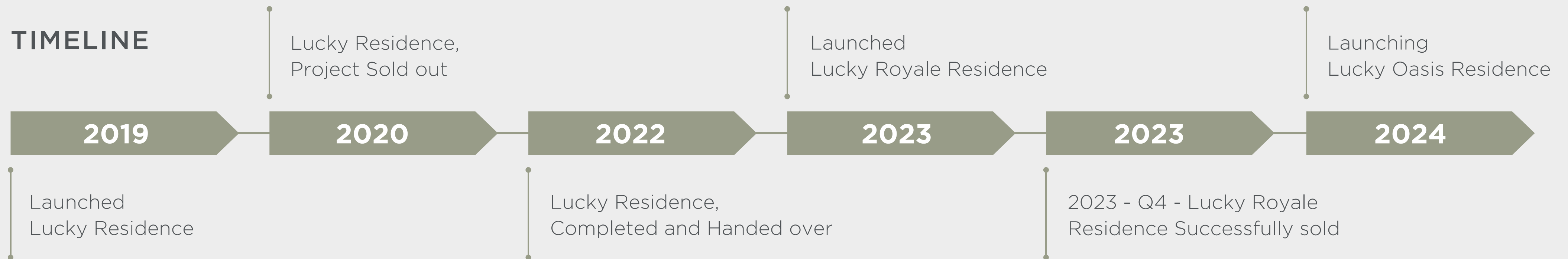



LUCKYAEON
Real Estate Development

☎ +971 55 798 1210 | +971 4 394 0098
info@luckyaeondevelopments.com
www.luckyaeondevelopments.com

*Disclaimer - Brochure content is only for illustrative purpose and subject to change.