

DIVINE LIVING

ARJAN



Forbes
GLOBAL PROPERTIES

TAKMEEL
REAL ESTATE DEVELOPMENT





DIVINE LIVING

ARJAN

Driven Properties proudly presents the latest project by Takmeel Development, Divine Living, Arjan.

This off plan residential project represents a true quiet oasis in a buzzing city. Divine Living offers a remarkable combination of spacious layouts and beautiful designs. The finish of the building is carefully crafted to represent a timeless aesthetics that is both natural and elegant, created to suit the taste of modern homebuyers.



THE BUILDING



LOCATION MAP

The community features residential complexes, commercial buildings and retail developments.

Although residential and peaceful, the luxurious residences offer direct and quick access to Sheikh Zayed Road and Umm Suqeim Street allowing fast reach to the whole city.



02 MINUTES
TO BARSHA
CITY CENTRE

05 MINUTES
TO UMM
SUQEIM ROAD

20 MINUTES
TO BURJ KHALIFA

20 MINUTES
TO DUBAI MARINA

20 MINUTES
TO AL SUFOUH
BEACH

25 MINUTES
TO DUBAI
INTERNATIONAL
AIRPORT

PLOT LOCATION

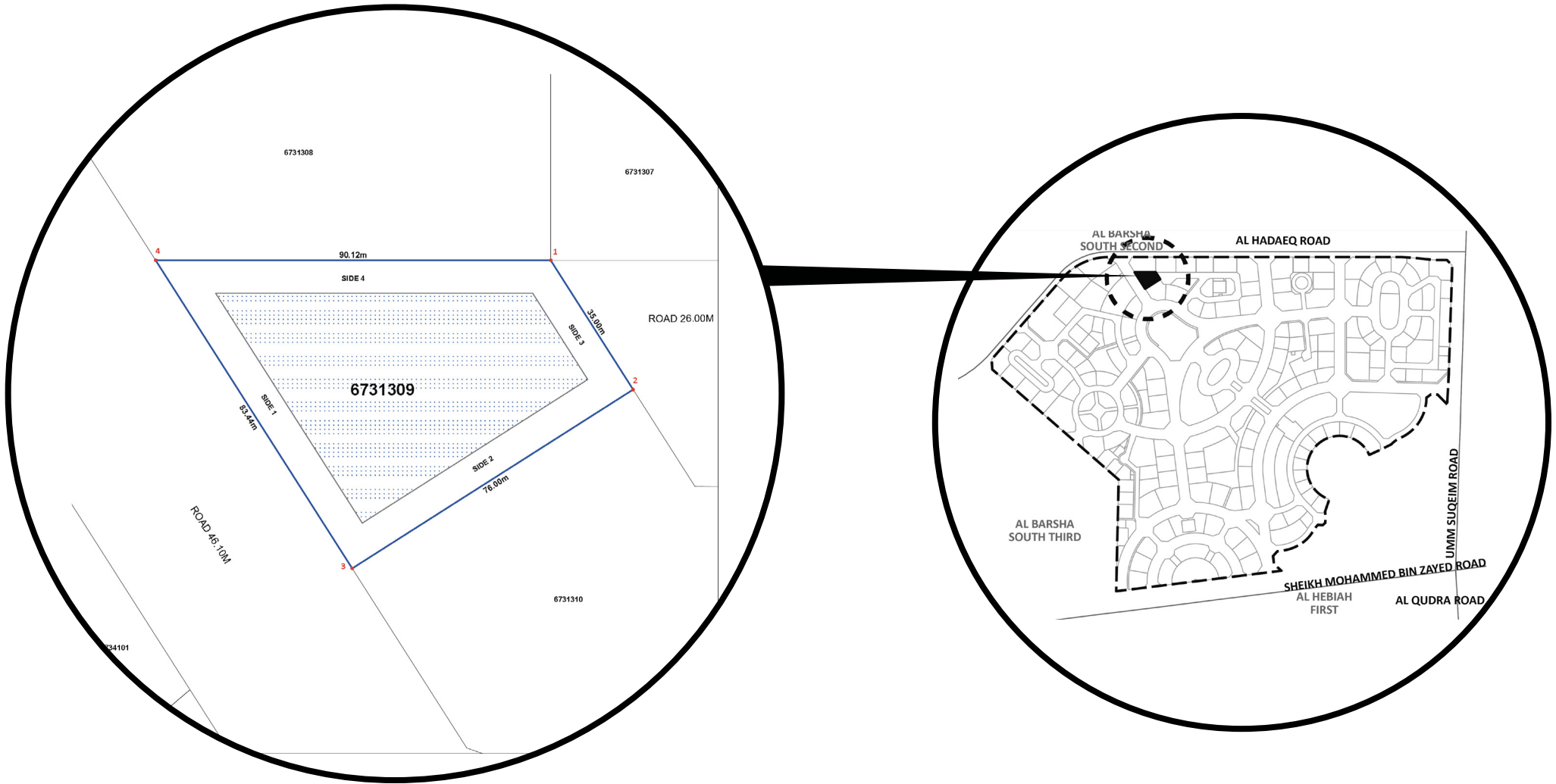

IN THE HEART OF A THRIVING COMMUNITY



The neighborhood is particularly popular for having two of the most visited parks in Dubai: Dubai Miracle Garden and Dubai Butterfly Garden. Since this community is fairly new, the general feel of the community is quiet and peaceful.

The roads are free of excessive noise and traffic.

TIMELESS
ELEGANCE,
WITH A COLOR
PALETTE THAT
IS BOTH
CONTEMPORARY
AND TIMELESS.



PROJECT HIGHLIGHTS



World Class
Materials



High Quality
Finishing



Financing
Available



Thriving
Neighbourhood



Family
Friendly



AMENITIES



Fully Equipped
Gym



Swimming
Pool



Children's
Pool



Children's
Play Area



Landscaped
Gardens



Covered
Parking



3 Lift's /
Elevators



24/7
Security



24/7
CCTV





STEP INTO ELEGANT LIVING

DIVINE
LIVING
ARJAN

UNIT DETAILS

DIVINE
LIVING
ARJAN



TYPICAL 1 BEDROOM



TYPICAL 1 BEDROOM



TYPICAL 1 BEDROOM



TYPICAL BATHROOM



TYPICAL BATHROOM



TYPICAL BEDROOM



TYPICAL 2 BEDROOM



TYPICAL 2 BEDROOM



TYPICAL 2 BEDROOM



TYPICAL 3 BEDROOM



TYPICAL 3 BEDROOM



TYPICAL 3 BATHROOM



TYPICAL 3 BEDROOM



TYPICAL POWDER BATHROOM 01



TYPICAL POWDER BATHROOM 02



TYPICAL POWDER BATHROOM 03

GENERAL MATERIALS



FLUTED MARBLE - LOBBY



PORCELAIN TILES - LOBBY

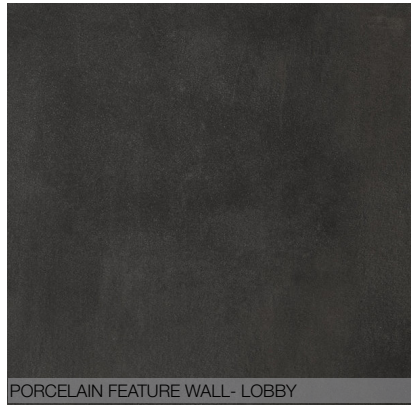

PORCELAIN FEATURE WALL - LOBBY

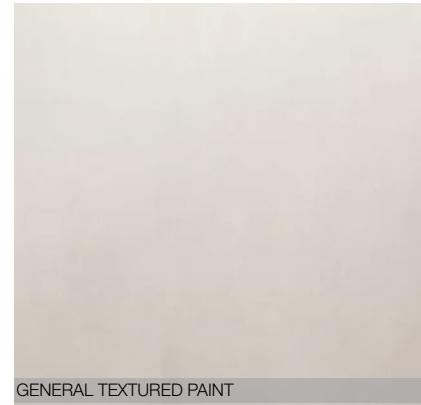

GENERAL TEXTURED PAINT



TIMBER VINYL FLOORING - GYM



FEATURE BATHROOM TILE



GENERAL WALL + FLOOR TILE



OAK VENEER FOR JOINERY + DOORS



PORCELAIN - KITCHEN TOP/SPLASHBACK



GENERAL SANITARYWARE/ IRONMONGERY



RECONSTITUTED STONE BATHROOM TOPS



LACQUERED MDF/LAMINATE KITCHEN/WARDROBE

PAYMENT PLAN

CASH PAYMENT PLAN		
Installment No.	Milestone	Payment %
1st	Down Payment Month 0	10%
2nd	Month 2	10%
3rd	Month 7	10%
4th	Month 12	10%
5th	On Completion	60%

2 YEARS POST HANDOVER PAYMENT PLAN		
Installment No.	Milestone	Payment %
1st	Down Payment Month 0	10%
2nd	Month 2	10%
3rd	Month 7	10%
4th	Month 12	10%
5th	On Completion Month 18	10%
6th	After 5 Months From Completion	10%
7th	After 10 Months From Completion	10%
8th	After 15 Months From Completion	10%
9th	After 20 Months From Completion	10%
10th	After 25 Months From Completion	10%

DIVINE LIVING

ARJAN

2nd Floor, Building 13, Bay Square, Business Bay, Dubai

Tel: +971 (0) 4 429 7040 | Fax: +971 (0) 4 429 6024



Forbes
GLOBAL PROPERTIES

TAKMEEL
REAL ESTATE DEVELOPMENT

