

TOWN
SQUARE



LEXINGTON

NSHAMA 



Contents

| | |
|----------------------|----|
| Town Square | 04 |
| Community Facilities | 09 |
| Lifestyle | 11 |
| Lexington | 12 |
| Exterior & Interior | 14 |
| Amenities | 19 |
| Floor Plans | 20 |





Redefining Possibilities for Urban Lifestyles

With green spaces, contemporary architecture, diverse retail stores, state-of-the-art amenities and a lively social scene, Town Square is the perfect hub for families and young professionals!

Location Proximities



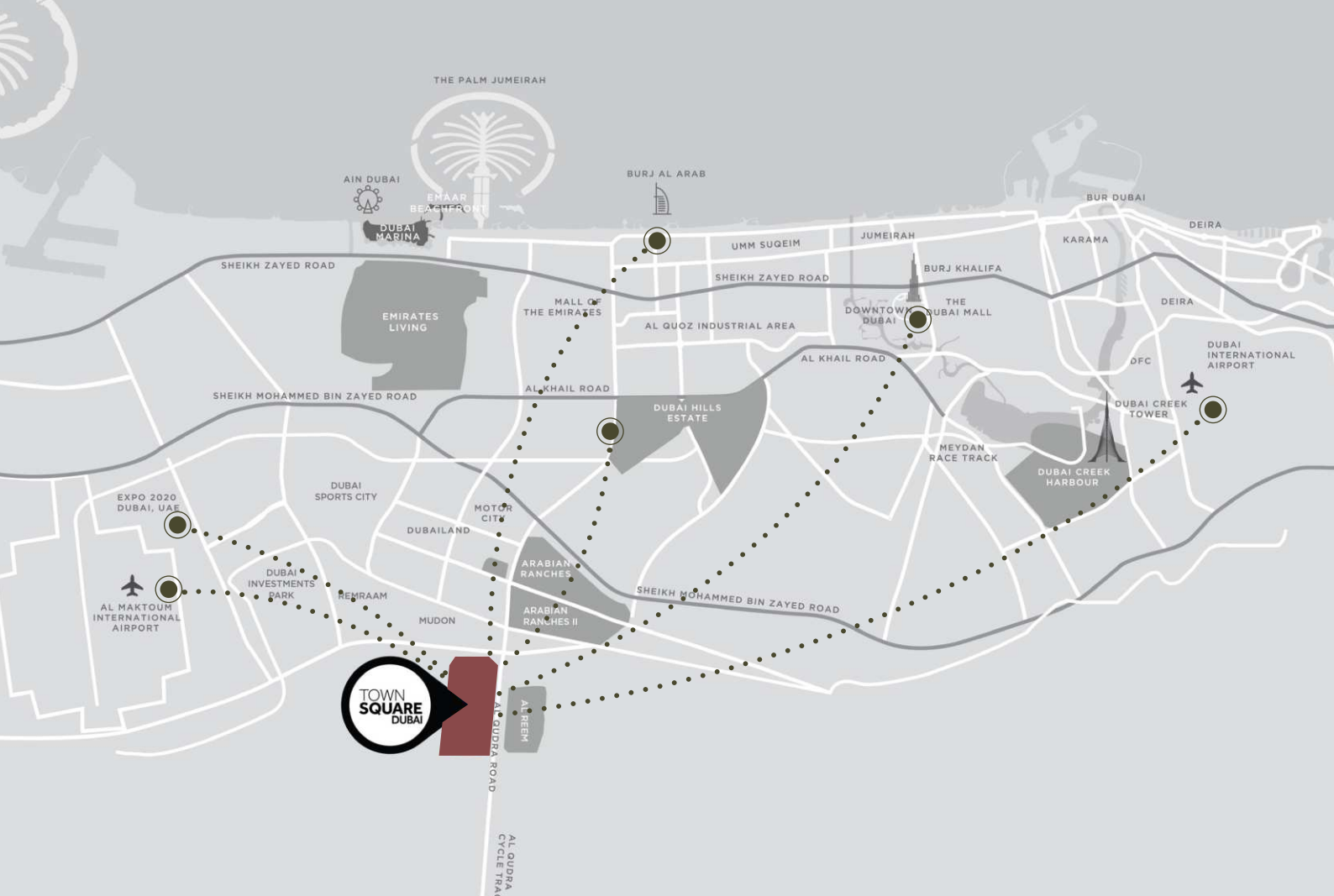

29 min
Dubai Mall



28 min
Dubai Intl Airport



25 min
DWC Airport



24 min
Burj Al Arab



20 min
Dubai Hills Mall

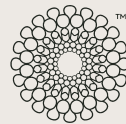

20 min
District 2020

Key Facts





50,000

SQM Town Square park



260,000

SQM greenery



250+

Retail outlets

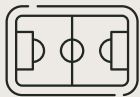

8,000

SQM sports arenas



13

KM cycling trails



10

KM running track

Community Facilities





Town Square Park



Swimming Pool



GYM



Basketball Courts



Carousel



Barbeque Area



Cycling Track



Jogging Track



Kids Play Area



Kids Train



Retail Outlets



Fitness Club



Restaurants & Cafes



Splash Pad



Football Pitch



Squash & Tennis Court



Padel Court



Nurseries



Veterinary Clinic



Pet Shop



Clinics



Pharmacies



Grooming & Beauty Services



Laundry Shop

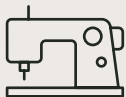

Tailor Shop



Dog Park



Mosque



Supermarkets



Food Trucks



Skate Park





Cultivate a new way of living

Uncover amenities that cater to all interests, from lively fitness facilities to calm, serene retreats.

For discoverers, thinkers, and those with a vibrant personality, there's something for everyone!

LEXINGTON

Discover our contemporary apartments featuring 1, 2, and 3 bedrooms, including spacious 3-bedroom duplexes, all crafted for comfort and tranquility.

Enjoy the airy living areas adorned with stylish porcelain flooring, built-in wardrobes, and fully equipped kitchens.

Venture outside to lush green trails ideal for jogging, walking, and unwinding, providing a perfect balance of urban convenience in-sync with nature.

Embrace a Higher Standard of Living

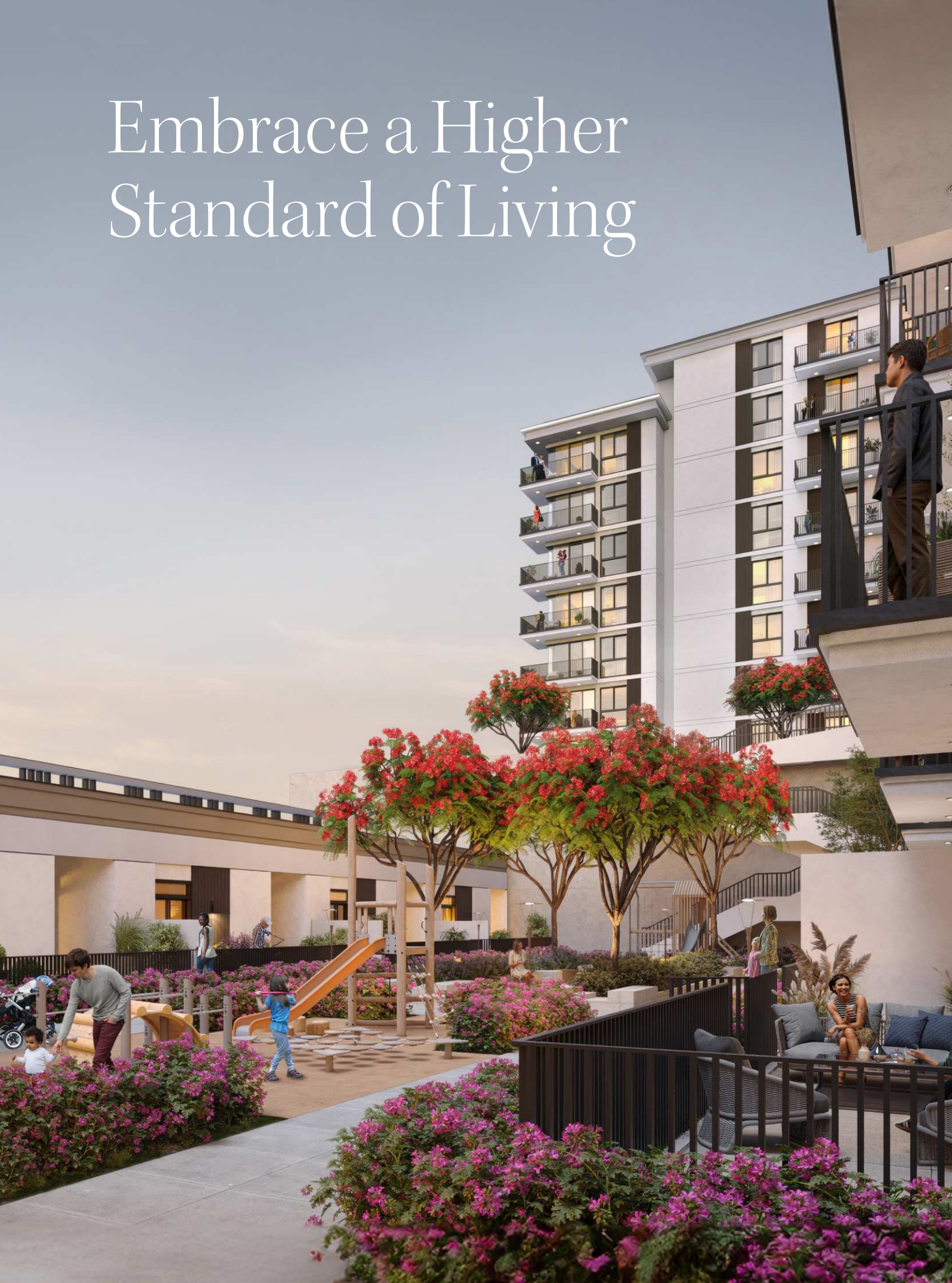



Immerse yourself in architecture that resonates

LEXINGTON presents a refined selection of modern residential apartments.

The sleek design, marked by clean lines and large windows, redefines urban elegance, offering an ideal fusion of style and convenience.





Interiors that inspire

Abundant natural light fills the living and dining spaces, establishing a warm and welcoming environment.

The bedrooms are adorned with elegant glazed porcelain floors and generous built-in wardrobes, while the master suites feature opulent en-suite bathrooms.

Savor the seamless combination of modern style and practicality, making your fitted kitchen a chic and efficient zone with abundant counter space and streamlined organization.



Elevated Living at Every Turn





Recreational Amenities



Swimming Pool



Gym



Indoor & Outdoor
Kids Play Area



BBQ Area



Open Green Areas



Pet Washroom

Floor Plans





*Balcony sizes vary

1 bedroom - Unit type A

| Area | Min | Max |
|----------------|---------------------------|---------------------------|
| Suite | 55.91 Sq.m / 601.81 Sq.ft | 56.08 Sq.m / 603.64 Sq.ft |
| Balcony | 5.31 Sq.m / 57.16 Sq.ft | 5.34 Sq.m / 57.26 Sq.ft |
| Total built-up | 61.23 Sq.m / 659.07 Sq.ft | 61.39 Sq.m / 660.80 Sq.ft |

Disclaimer

1. All room dimensions are in metric and measured to structural elements and exclude wall finishes and construction tolerances.
 2. All dimensions have been provided by our consultant architects. 3. All materials, dimensions, drawings features and amenities are approximate at the time of printing. 4. Actual area may vary from stated area. Drawings not to scale E&OE. The developer reserves the right to make revisions to the floor plans and any features, materials, dimensions, drawings and amenities mentioned in this brochure without notice.



*Balcony sizes vary

1 bedroom - Unit type B

| Area | Min | Max |
|----------------|---------------------------|---------------------------|
| Suite | 49.86 Sq.m / 536.69 Sq.ft | 55.73 Sq.m / 599.87 Sq.ft |
| Balcony | 11.80 Sq.m / 127.01 Sq.ft | 13.51 Sq.m / 145.42 Sq.ft |
| Total built-up | 61.66 Sq.m / 663.70 Sq.ft | 69.24 Sq.m / 745.29 Sq.ft |

Disclaimer

1. All room dimensions are in metric and measured to structural elements and exclude wall finishes and construction tolerances.
 2. All dimensions have been provided by our consultant architects. 3. All materials, dimensions, drawings features and amenities are approximate at the time of printing. 4. Actual area may vary from stated area. Drawings not to scale E&OE. The developer reserves the right to make revisions to the floor plans and any features, materials, dimensions, drawings and amenities mentioned in this brochure without notice.



*Balcony sizes vary

1 bedroom - Unit type C

Area

| | |
|----------------|---------------------------|
| Suite | 56.43 Sq.m / 607.41 Sq.ft |
| Balcony | 6.58 Sq.m / 70.83 Sq.ft |
| Total built-up | 63.01 Sq.m / 678.23 Sq.ft |

Disclaimer

1. All room dimensions are in metric and measured to structural elements and exclude wall finishes and construction tolerances. 2. All dimensions have been provided by our consultant architects. 3. All materials, dimensions, drawings features and amenities are approximate at the time of printing. 4. Actual area may vary from stated area. Drawings not to scale E&OE. The developer reserves the right to make revisions to the floor plans and any features, materials, dimensions, drawings and amenities mentioned in this brochure without notice.



*Balcony sizes vary

2 bedroom - Unit type A

| Area | Min | Max |
|----------------|----------------------------|----------------------------|
| Suite | 86.81 Sq.m / 934.42 Sq.ft | 88.63 Sq.m / 954.01 Sq.ft |
| Balcony | 7.48 Sq.m / 80.51 Sq.ft | 7.49 Sq.m / 80.62 Sq.ft |
| Total built-up | 94.29 Sq.m / 1014.93 Sq.ft | 96.12 Sq.m / 1034.63 Sq.ft |

Disclaimer

1. All room dimensions are in metric and measured to structural elements and exclude wall finishes and construction tolerances.
 2. All dimensions have been provided by our consultant architects. 3. All materials, dimensions, drawings features and amenities are approximate at the time of printing. 4. Actual area may vary from stated area. Drawings not to scale E&OE. The developer reserves the right to make revisions to the floor plans and any features, materials, dimensions, drawings and amenities mentioned in this brochure without notice.



*Balcony sizes vary

2 bedroom - Unit type B

| Area | Min | Max |
|----------------|---------------------------|---------------------------|
| Suite | 78.43 Sq.m / 844.21 Sq.ft | 78.47 Sq.m / 844.64 Sq.ft |
| Balcony | 11.78 Sq.m / 126.80 Sq.ft | 11.81 Sq.m / 127.12 Sq.ft |
| Total built-up | 90.24 Sq.m / 971.34 Sq.ft | 90.25 Sq.m / 971.44 Sq.ft |

Disclaimer

1. All room dimensions are in metric and measured to structural elements and exclude wall finishes and construction tolerances.
 2. All dimensions have been provided by our consultant architects. 3. All materials, dimensions, drawings features and amenities are approximate at the time of printing. 4. Actual area may vary from stated area. Drawings not to scale E&OE. The developer reserves the right to make revisions to the floor plans and any features, materials, dimensions, drawings and amenities mentioned in this brochure without notice.



*Balcony sizes vary

2 bedroom - Unit type C

| Area | |
|----------------|----------------------------|
| Suite | 85.68 Sq.m / 922.25 Sq.ft |
| Balcony | 7.49 Sq.m / 80.62 Sq.ft |
| Total built-up | 93.17 Sq.m / 1002.87 Sq.ft |

Disclaimer

1. All room dimensions are in metric and measured to structural elements and exclude wall finishes and construction tolerances.
 2. All dimensions have been provided by our consultant architects. 3. All materials, dimensions, drawings features and amenities are approximate at the time of printing. 4. Actual area may vary from stated area. Drawings not to scale E&OE. The developer reserves the right to make revisions to the floor plans and any features, materials, dimensions, drawings and amenities mentioned in this brochure without notice.



*Balcony sizes vary

2 bedroom - Unit type D

| Area | Min | Max |
|----------------|----------------------------|----------------------------|
| Suite | 85.72 Sq.m / 922.68 Sq.ft | 85.81 Sq.m / 923.65 Sq.ft |
| Balcony | 7.49 Sq.m / 80.62 Sq.ft | 7.61 Sq.m / 81.91 Sq.ft |
| Total built-up | 93.30 Sq.m / 1004.27 Sq.ft | 93.33 Sq.m / 1004.60 Sq.ft |

Disclaimer

1. All room dimensions are in metric and measured to structural elements and exclude wall finishes and construction tolerances.
 2. All dimensions have been provided by our consultant architects. 3. All materials, dimensions, drawings features and amenities are approximate at the time of printing. 4. Actual area may vary from stated area. Drawings not to scale E&OE. The developer reserves the right to make revisions to the floor plans and any features, materials, dimensions, drawings and amenities mentioned in this brochure without notice.



*Balcony sizes vary

2 bedroom - Unit type E

| Area | Min | Max |
|----------------|----------------------------|----------------------------|
| Suite | 80.17 Sq.m / 862.94 Sq.ft | 80.21 Sq.m / 863.37 Sq.ft |
| Balcony | 14.62 Sq.m / 157.37 Sq.ft | 14.64 Sq.m / 157.58 Sq.ft |
| Total built-up | 94.81 Sq.m / 1020.53 Sq.ft | 94.83 Sq.m / 1020.74 Sq.ft |

Disclaimer

1. All room dimensions are in metric and measured to structural elements and exclude wall finishes and construction tolerances.
 2. All dimensions have been provided by our consultant architects. 3. All materials, dimensions, drawings features and amenities are approximate at the time of printing. 4. Actual area may vary from stated area. Drawings not to scale E&OE. The developer reserves the right to make revisions to the floor plans and any features, materials, dimensions, drawings and amenities mentioned in this brochure without notice.



*Balcony sizes vary

2 bedroom - Unit type F

| Area | Min | Max |
|----------------|---------------------------|---------------------------|
| Suite | 82.40 Sq.m / 886.95 Sq.ft | 82.42 Sq.m / 887.16 Sq.ft |
| Balcony | 5.32 Sq.m / 57.26 Sq.ft | 5.34 Sq.m / 57.48 Sq.ft |
| Total built-up | 87.74 Sq.m / 944.43 Sq.ft | 87.74 Sq.m / 944.43 Sq.ft |

Disclaimer

1. All room dimensions are in metric and measured to structural elements and exclude wall finishes and construction tolerances.
 2. All dimensions have been provided by our consultant architects. 3. All materials, dimensions, drawings features and amenities are approximate at the time of printing. 4. Actual area may vary from stated area. Drawings not to scale E&OE. The developer reserves the right to make revisions to the floor plans and any features, materials, dimensions, drawings and amenities mentioned in this brochure without notice.



*Balcony sizes vary

2 bedroom - Unit type G

| Area | |
|----------------|---------------------------|
| Suite | 78.39 Sq.m / 843.78 Sq.ft |
| Balcony | 6.40 Sq.m / 68.89 Sq.ft |
| Total built-up | 84.79 Sq.m / 912.67 Sq.ft |

Disclaimer

1. All room dimensions are in metric and measured to structural elements and exclude wall finishes and construction tolerances.
 2. All dimensions have been provided by our consultant architects. 3. All materials, dimensions, drawings features and amenities are approximate at the time of printing. 4. Actual area may vary from stated area. Drawings not to scale E&OE. The developer reserves the right to make revisions to the floor plans and any features, materials, dimensions, drawings and amenities mentioned in this brochure without notice.



*Balcony sizes vary

2 bedroom - Unit type H

| Area | Min |
|----------------|---------------------------|
| Suite | 76.13 Sq.m / 819.46 Sq.ft |
| Balcony | 8.21 Sq.m / 88.37 Sq.ft |
| Total built-up | 84.34 Sq.m / 907.83 Sq.ft |

Disclaimer

1. All room dimensions are in metric and measured to structural elements and exclude wall finishes and construction tolerances.
 2. All dimensions have been provided by our consultant architects. 3. All materials, dimensions, drawings features and amenities are approximate at the time of printing. 4. Actual area may vary from stated area. Drawings not to scale E&OE. The developer reserves the right to make revisions to the floor plans and any features, materials, dimensions, drawings and amenities mentioned in this brochure without notice.



*Balcony sizes vary

3 bedroom - Unit type A

| Area | Min | Max |
|----------------|-----------------------------|-----------------------------|
| Suite | 111.57 Sq.m / 1200.93 Sq.ft | 112.14 Sq.m / 1207.06 Sq.ft |
| Balcony | 19.01 Sq.m / 204.62 Sq.ft | 19.13 Sq.m / 205.91 Sq.ft |
| Total built-up | 130.70 Sq.m / 1406.84 Sq.ft | 131.15 Sq.m / 1411.69 Sq.ft |

Disclaimer

1. All room dimensions are in metric and measured to structural elements and exclude wall finishes and construction tolerances.
 2. All dimensions have been provided by our consultant architects. 3. All materials, dimensions, drawings features and amenities are approximate at the time of printing. 4. Actual area may vary from stated area. Drawings not to scale E&OE. The developer reserves the right to make revisions to the floor plans and any features, materials, dimensions, drawings and amenities mentioned in this brochure without notice.

LEXINGTON

NSHAMA[®]