



SOBHA ONE

SOBHA  
REALTY





ONE

THE JOURNEY BEGINS

ONE that brings you  
closer to nature





A place where you can take  
one day at a time





ONE

BE ONESELF

It's one of a kind, like you





One where the world is  
close yet far away



# THE POWER OF ONE



*When imagination and vision  
come together Life meets style.*

City and nature hum together,  
Work & play find a balance and become One



# ONE WAY: YOUR WAY

The best places are hidden in plain sight

Near the vital Ras Al Khor Road, Sobha One is a little world tucked away. Look to the north at the calming waters of the Creek as they look back. Further north in the skyline with panoramic views of The Burj Khalifa, Creek Tower to the Northeast and Downtown to the West.





# ARRIVE & DEPART WITH GRACE

Sobha One is right near two new interchanges on Ras Al Khor Road. So, getting home has never been faster. With exits in both the West and East, a new planned metro line behind Sobha One, soar where you need to be on your terms.







# LIVING BY THE WATER

Imagine waking up each morning next to serene water. The sun glints off the water, casting a sparkling path across the ripples. A light breeze blows, rustling the leaves of the nearby trees.

It's yours to stroll down the pathway or sit peacefully watching the calm waters. Go on, spend lazy weekends lounging near the water, reading, and soaking up the sun.





# ONE POINT OF VIEW: YOURS

With a canvas spread over 1.5 million square feet, its breathtaking views as far as your eye can see. Look around to views of Golf Course, calm water, iconic Burj Khalifa & Downtown. Every glance sets a different mood.





# ONE

SPACE

Sobha One spreads its tapestry over five interlinked towers. Rising from 30 stories tall and hitting a crescendo of 65 stories, it's one note after another that sings in chorus with the skyline

With 1 to 4 bedroom apartments & 2 to 4 bedroom Duplex, it's a world of its own.







ONE FOR ALL  
ALL FOR ONE



*Life is too short to settle for anything less than  
the best. At Sobha One, luxury living is a  
natural choice.*



# TEE OFF IN STYLE

The first of its kind in Dubai, a world class Pitch and Putt golf course featuring 18 holes of golf, each meticulously designed.

It is the perfect way to unwind after a long day at work. After all, there's nothing like sinking a long putt on a sun-drenched fairway. The clubhouse is appointed with upscale amenities and a patio overlooking the greens.





# DINE BY THE WATERS

The food & beverage esplanade that borders the calm waters is also a feast for the palate to suit every taste and time.

Spread over almost half a kilometer, it offers fine restaurants for an intimate dinner, quick catch-up over a cup of coffee, or a power lunch.





# SKY GARDEN

Rise high above and look at the stars. Soak in the stunning views of the city. Catch the sun rays when they rise and set. Do it all from the magnificent panoramic sky terrace in each tower





# COURTYARD FOR THE SENSES



*All the 5 Towers at Sobha One have interconnected four themed courtyards. As private outdoor retreats, these lush, landscaped spaces add to the overall aesthetic.*



# RELAX

In a fast-paced world, finding ways to relax is more important than ever. Take a leisurely stroll through the tree avenues, do yoga on the group decks, or stroll in the gardens. And when you need to refuel, enjoy a meal at the BBQ & dining areas or catch a movie under the stars on our cinema screen. There is something for everyone







# REMEMBER

The family courtyard is a great way to spend quality time together. You can pack a picnic lunch and enjoy the beautiful weather. Or spending a day cooling off in the water, splashing with the little ones. So, come on down and make memories with your loved ones!







# RECHARGE

We believe that fitness should be fun! That's why we've created a unique courtyard that combines the best of gyms with exciting new indoor and outdoor features from static bikes, treadmills, circuit training areas and battle ropes. So sweat it out and be the best version of yourself.







# REFRESH

This themed courtyard is the way to do just that after a long day. Step into the pool area, and the stress of daily life melts away. Feel your muscles loosening and your mind clearing as you swim laps. Close your eyes and let the warm sun wash over you, lulling you into a state of relaxation.







SOBHA ONE



FLEXIBLE PAYMENT PLAN

60%

During Construction

40%

On Completion

Grand 1 to 4 Bedroom apartments



ONE

*awaits you...*



# LOCATION MAP



  
**RAS AL KHOR  
 WILDLIFE SANCTUARY**  
 05 MINUTES

  
**MEYDAN  
 RACE COURSE**  
 10 MINUTES

  
**SOBHA HARTLAND &  
 2 INTERNATIONAL SCHOOLS**  
 10 MINUTES

  
**DUBAI INTERNATIONAL  
 AIRPORT**  
 12 MINUTES

  
**BUSINESS BAY**  
 12 MINUTES

  
**THE DUBAI MALL**  
 15 MINUTES

  
**BURJ KHALIFA &  
 DOWNTOWN DUBAI**  
 15 MINUTES

  
**DUBAI FRAME**  
 15 MINUTES

  
**DUBAI OPERA**  
 15 MINUTES

  
**PALM JUMEIRAH**  
 25 MINUTES



# MASTER PLAN

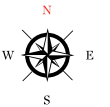



# GROUND FLOOR

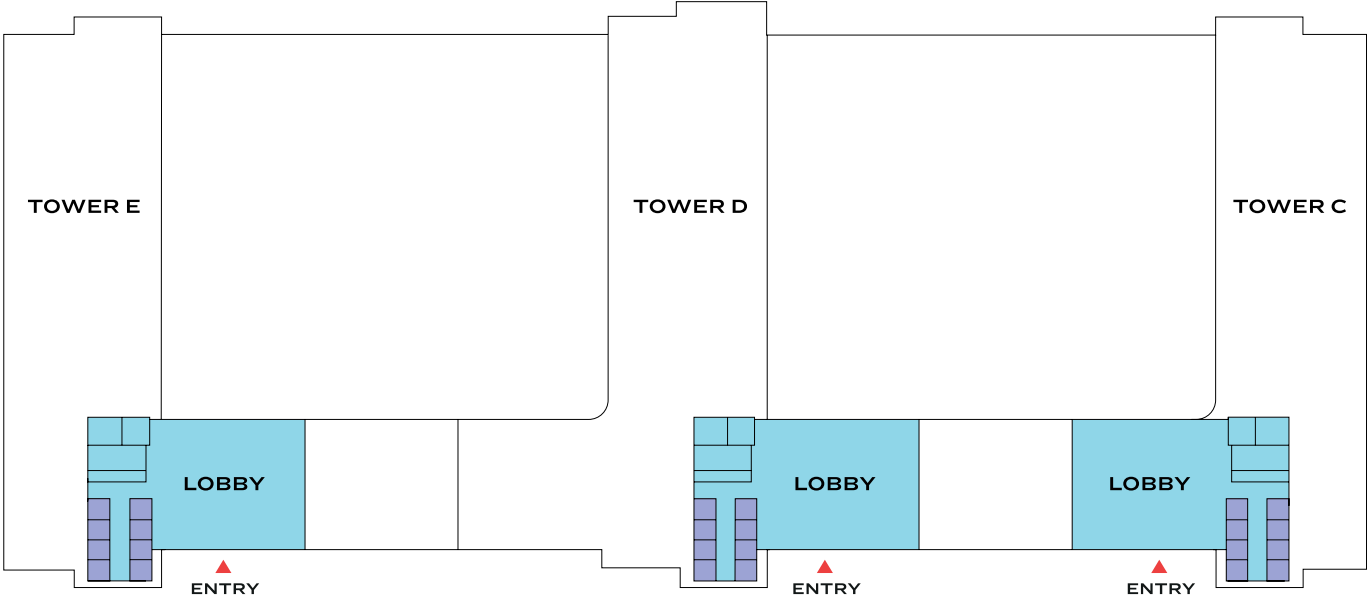



**TOWER**  
**FLOOR PLAN LAYOUTS**



# FLOOR PLAN LAYOUT

## TOWER E

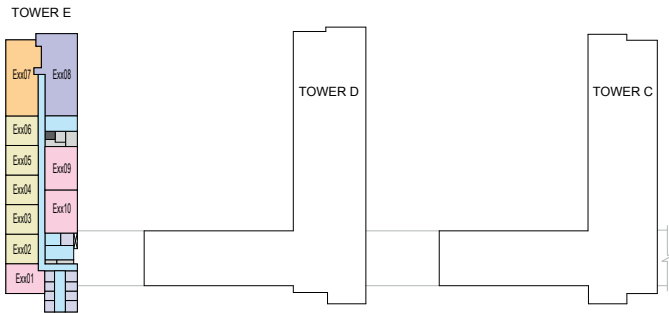

LEVEL 7-11, 19-23

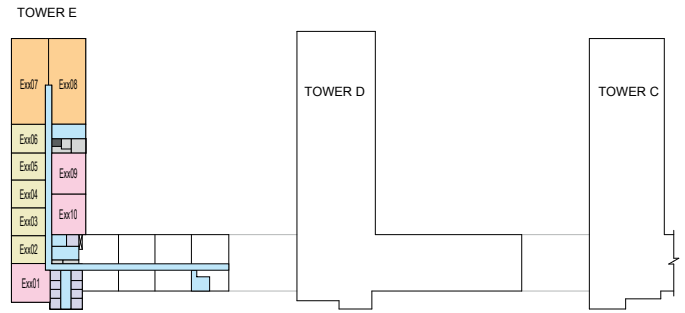

LEVEL 12, 24

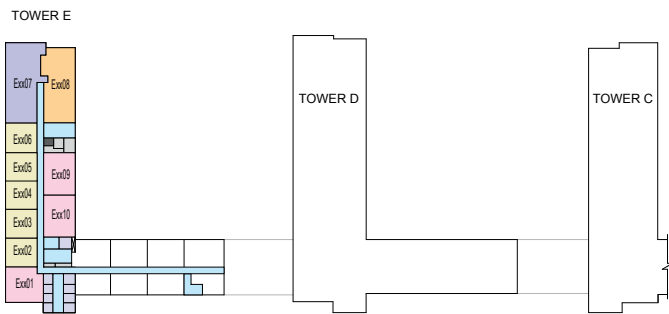

LEVEL 13-17, 25-29

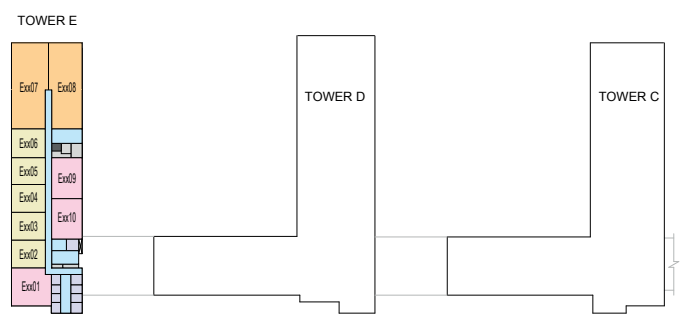

LEVEL 18

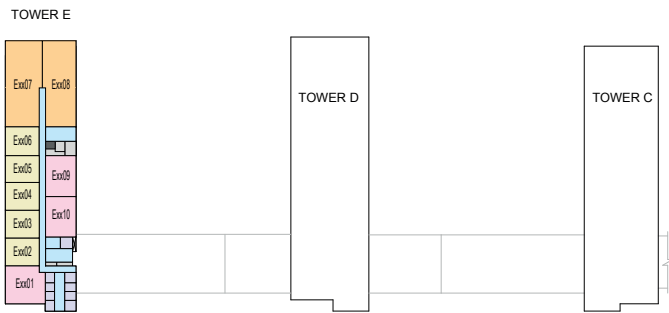

LEVEL 30,36

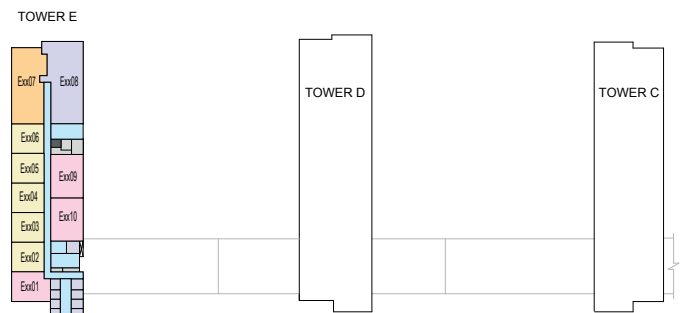

LEVEL 33-35

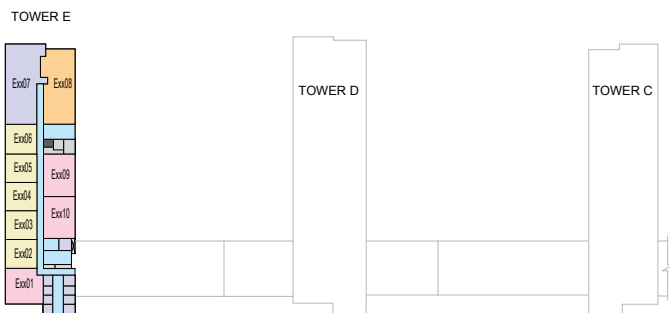

LEVEL 37-41

- 1 BED UNIT
- 3 BED UNIT
- LOBBIES, CORRIDORS & STAIRS
- LIFTS
- 2 BED UNIT
- 4 BED UNIT
- SERVICES
- GARBAGE ROOM

Disclaimer: 1. All dimensions are in metric, measured to wall finishes. 2. All materials, dimensions & drawings are approximate. 3. Information is subject to change without notice, at developer's absolute discretion. 4. Actual area may vary from the stated area. 5. Drawing are not to scale. 6. All images used are for illustrative purpose only and do not represent the actual size, features, specifications, fittings and furnishings. 7. The developer reserves the right to make revisions/ alterations, at its absolute discretion, without any liability whatsoever.



# TOWER E

UNIT PLAN LAYOUTS



# 1 BEDROOM APARTMENT

TYPE A (with powder room + balcony) VARIANT 3

## TOTAL SALEABLE AREA

SUITE = 676.40 SQ.FT.  
BALCONY = 57.46 SQ.FT.  
TOTAL = 733.86 SQ.FT.

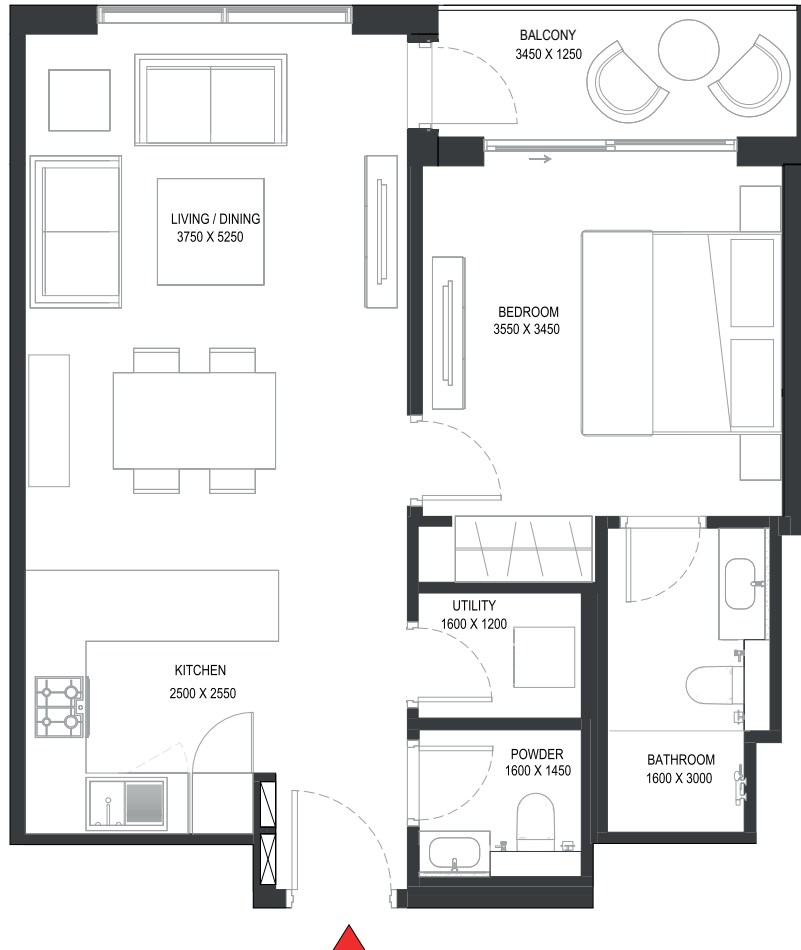
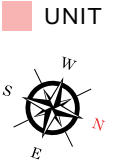
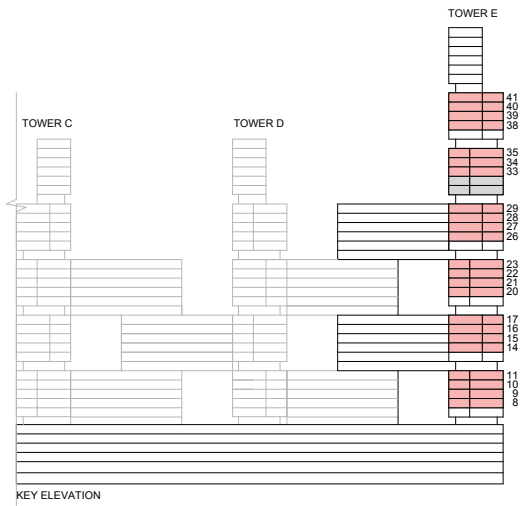

List of unit numbers with this unit plan:

## VIEWS

### Downtown, Ras Al Khor

E802, E804, E806, E902, E904, E906, E1002, E1004, E1006, E1102, E1104, E1106, E1402, E1404, E1406, E1502, E1504, E1506, E1602, E1604, E1606, E1702, E1704, E1706, E2002, E2004, E2006, E2102, E2104, E2106, E2202, E2204, E2206, E2302, E2304, E2306, E2602, E2604, E2606, E2702, E2704, E2706, E2802, E2804, E2806, E2902, E2904, E2906, E3302, E3304, E3306, E3402, E3404, E3406, E3502, E3504, E3506, E3802, E3804, E3806, E3902, E3904, E3906, E4002, E4004, E4006, E4102, E4104, E4106

Disclaimer: 1. All dimensions are in metric, measured to wall finishes. 2. All materials, dimensions & drawings are approximate. 3. Information is subject to change without notice, at developer's absolute discretion. 4. Actual area may vary from the stated area. 5. Drawing are not to scale. 6. All images used are for illustrative purpose only and do not represent the actual size, features, specifications, fittings and furnishings. 7. The developer reserves the right to make revisions/ alterations, at its absolute discretion, without any liability whatsoever.



# 1 BEDROOM APARTMENT

TYPE A (with powder room + balcony) VARIANT 3

**TOTAL SALEABLE AREA**

SUITE = 676.40 SQ.FT.

BALCONY = 57.46 SQ.FT.

TOTAL = 733.86 SQ.FT.

 UNIT

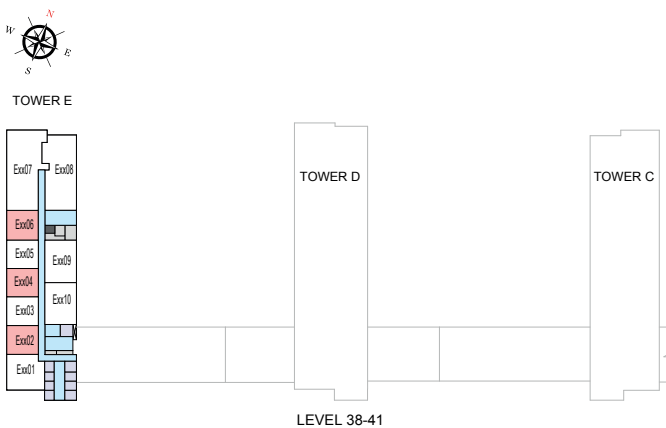
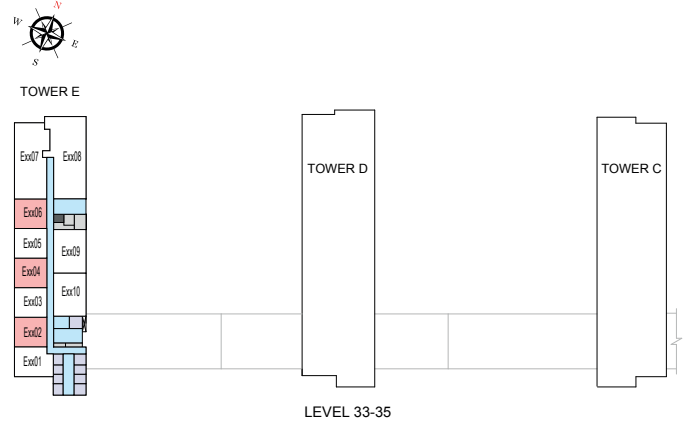
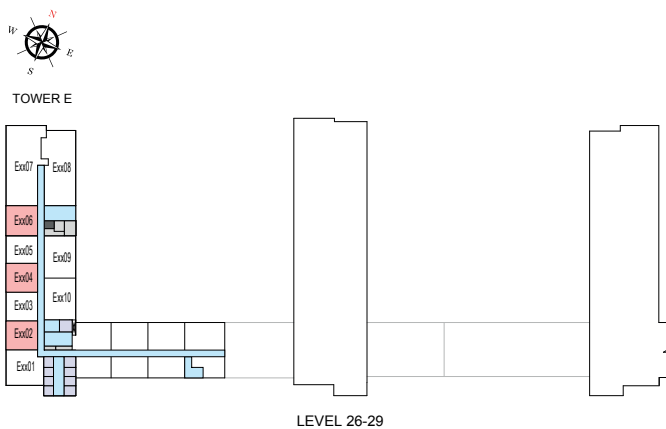
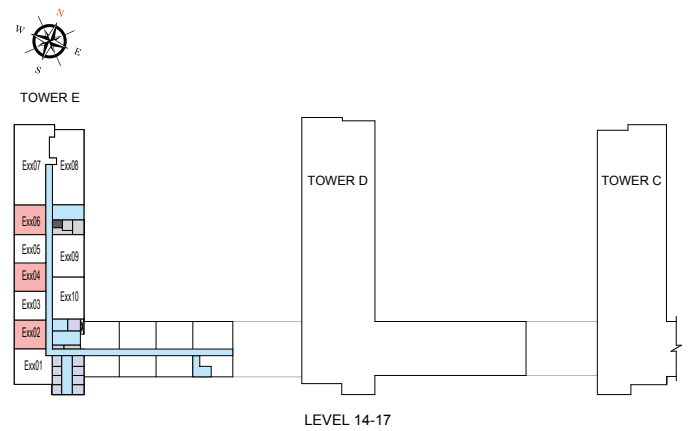
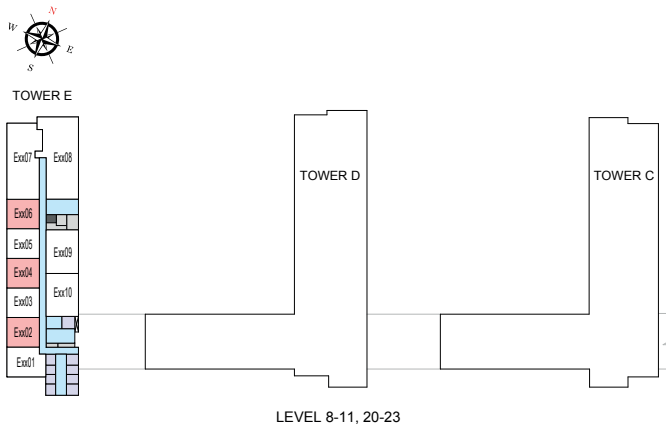

List of unit numbers with this unit plan:

## VIEWS

### Downtown, Ras Al Khor

E802, E804, E806, E902, E904, E906, E1002, E1004, E1006, E1102, E1104, E1106, E1402, E1404, E1406, E1502, E1504, E1506, E1602, E1604, E1606, E1702, E1704, E1706, E2002, E2004, E2006, E2102, E2104, E2106, E2202, E2204, E2206, E2302, E2304, E2306, E2602, E2604, E2606, E2702, E2704, E2706, E2802, E2804, E2806, E2902, E2904, E2906, E3302, E3304, E3306, E3402, E3404, E3406, E3502, E3504, E3506, E3802, E3804, E3806, E3902, E3904, E3906, E4002, E4004, E4006, E4102, E4104, E4106

Disclaimer: 1. All dimensions are in metric, measured to wall finishes. 2. All materials, dimensions & drawings are approximate. 3. Information is subject to change without notice, at developer's absolute discretion. 4. Actual area may vary from the stated area. 5. Drawing are not to scale. 6. All images used are for illustrative purpose only and do not represent the actual size, features, specifications, fittings and furnishings. 7. The developer reserves the right to make revisions/ alterations, at its absolute discretion, without any liability whatsoever.



# 1 BEDROOM APARTMENT

TYPE A (with powder room + balcony) VARIANT 4

## TOTAL SALEABLE AREA

SUITE = 676.40 SQ.FT.

BALCONY = 57.46 SQ.FT.

TOTAL = 733.86 SQ.FT.

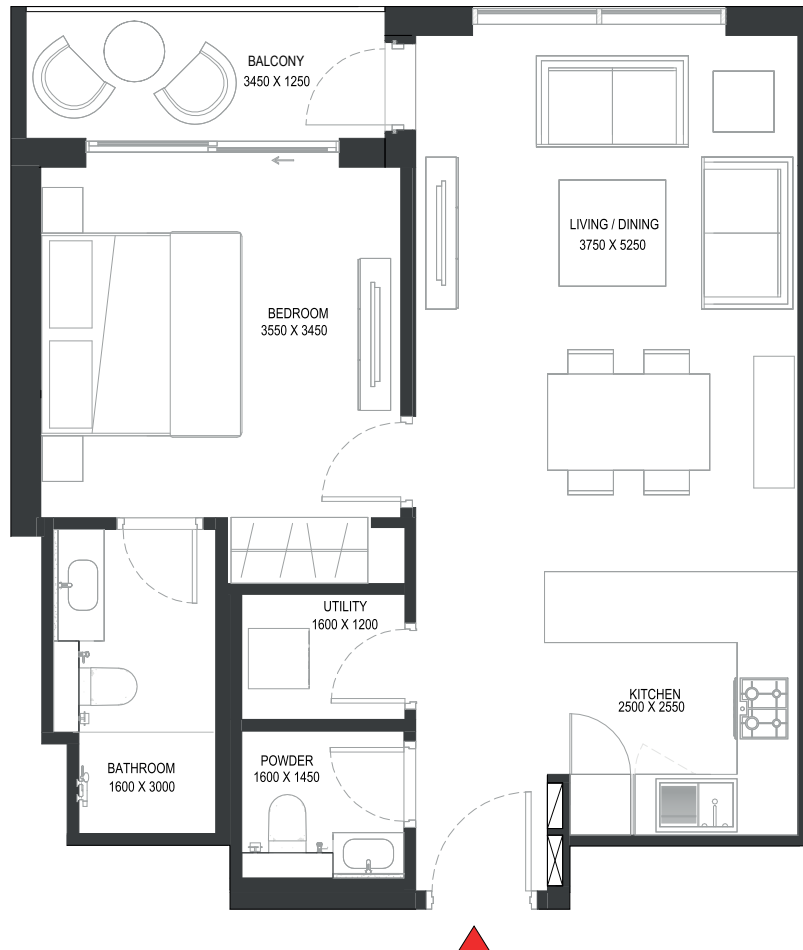
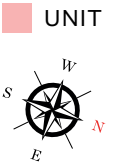
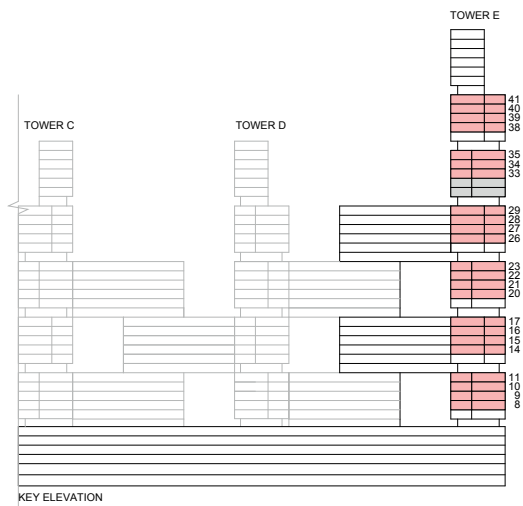

List of unit numbers with this unit plan:

## VIEWS

Downtown, Ras Al Khor

E803, E805, E903, E905, E1003, E1005, E1103, E1105, E1403, E1405, E1503, E1505, E1603, E1605, E1703, E1705, E2003, E2005, E2103, E2105, E2203, E2205, E2303, E2305, E2603, E2605, E2703, E2705, E2803, E2805, E2903, E2905, E3303, E3305, E3403, E3405, E3503, E3505, E3803, E3805, E3903, E3905, E4003, E4005, E4103, E4105

Disclaimer: 1. All dimensions are in metric, measured to wall finishes. 2. All materials, dimensions & drawings are approximate. 3. Information is subject to change without notice, at developer's absolute discretion. 4. Actual area may vary from the stated area. 5. Drawing are not to scale. 6. All images used are for illustrative purpose only and do not represent the actual size, features, specifications, fittings and furnishings. 7. The developer reserves the right to make revisions/ alterations, at its absolute discretion, without any liability whatsoever.

# 1 BEDROOM APARTMENT

TYPE A (with powder room + balcony) VARIANT 4

**TOTAL SALEABLE AREA**

SUITE = 676.40 SQ.FT.

BALCONY = 57.46 SQ.FT.

TOTAL = 733.86 SQ.FT.

 UNIT

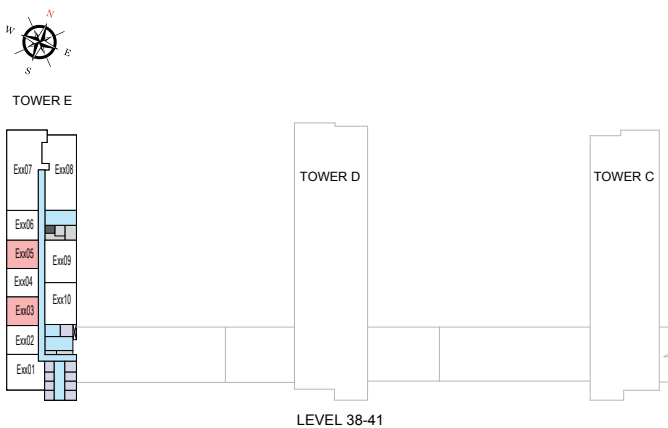
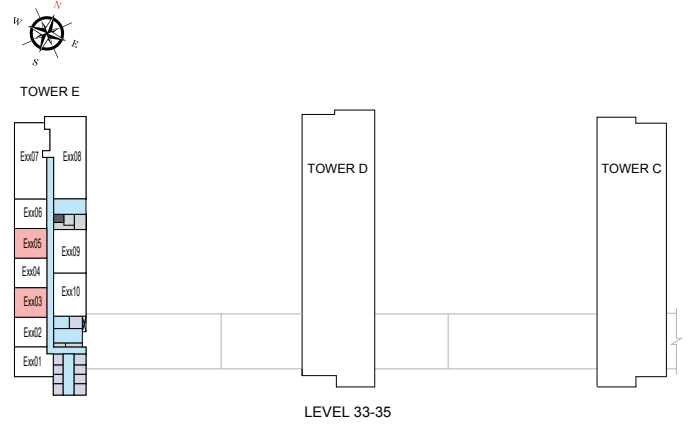
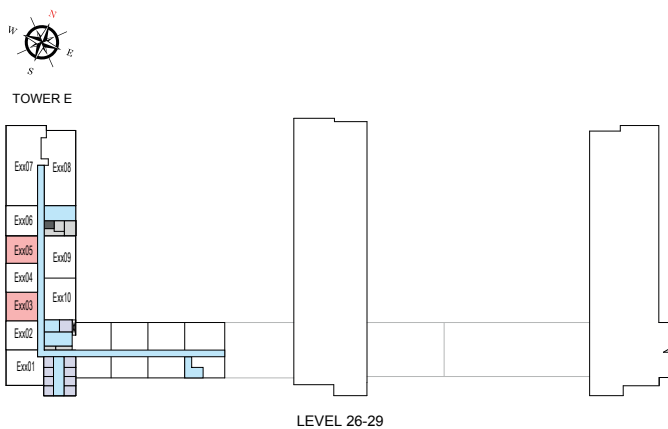
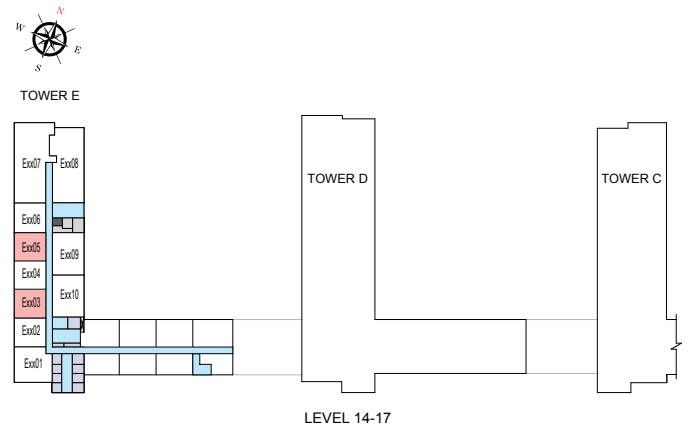
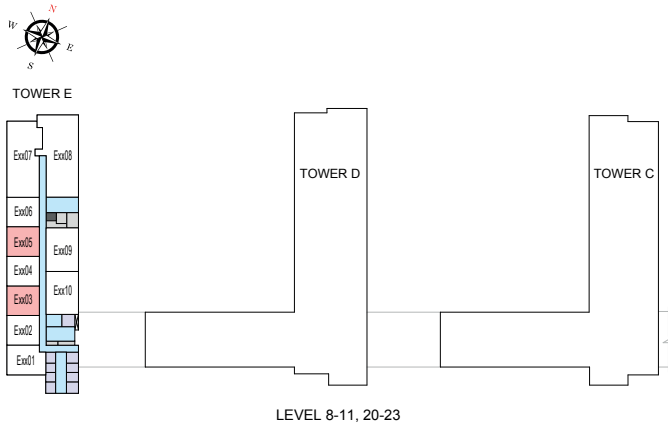

List of unit numbers with this unit plan:

## VIEWS

Downtown, Ras Al Khor

E803, E805, E903, E905, E1003, E1005, E1103, E1105, E1403, E1405, E1503, E1505, E1603, E1605, E1703, E1705, E2003, E2005, E2103, E2105, E2203, E2205, E2303, E2305, E2603, E2605, E2703, E2705, E2803, E2805, E2903, E2905, E3303, E3305, E3403, E3405, E3503, E3505, E3803, E3805, E3903, E3905, E4003, E4005, E4103, E4105

Disclaimer: 1. All dimensions are in metric, measured to wall finishes. 2. All materials, dimensions & drawings are approximate. 3. Information is subject to change without notice, at developer's absolute discretion. 4. Actual area may vary from the stated area. 5. Drawing are not to scale. 6. All images used are for illustrative purpose only and do not represent the actual size, features, specifications, fittings and furnishings. 7. The developer reserves the right to make revisions/ alterations, at its absolute discretion, without any liability whatsoever.



# 1 BEDROOM APARTMENT

TYPE B (with powder room + yard) VARIANT 3

## TOTAL SALEABLE AREA

SUITE = 675.65 SQ.FT.

YARD = 133.47 SQ.FT.

TOTAL = 809.12 SQ.FT.

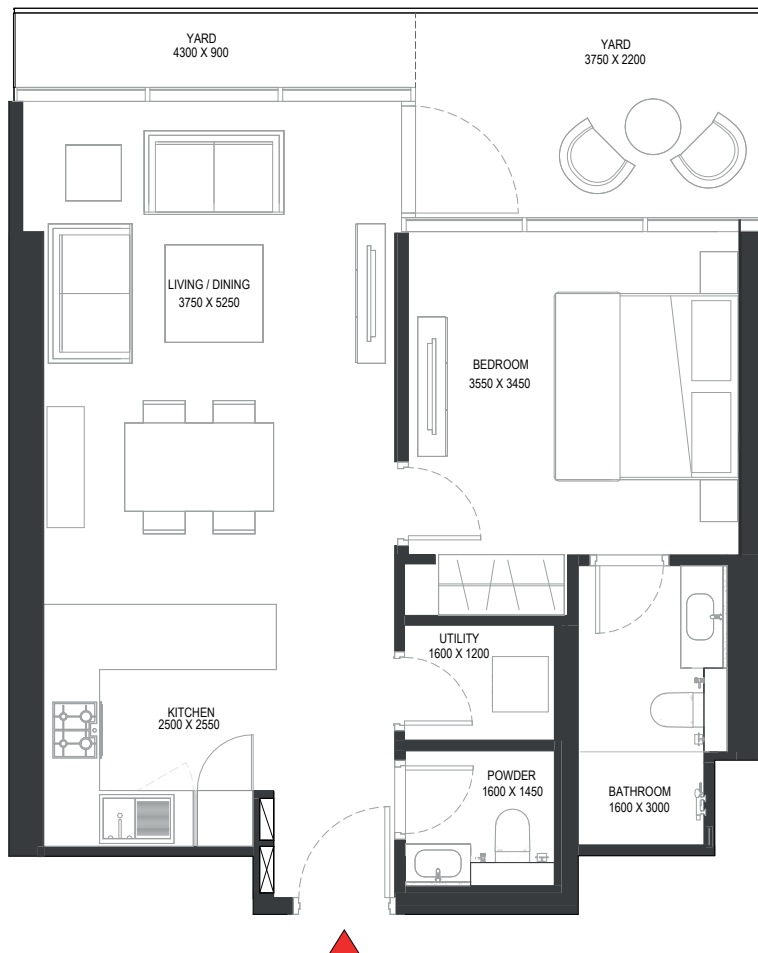
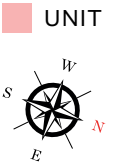
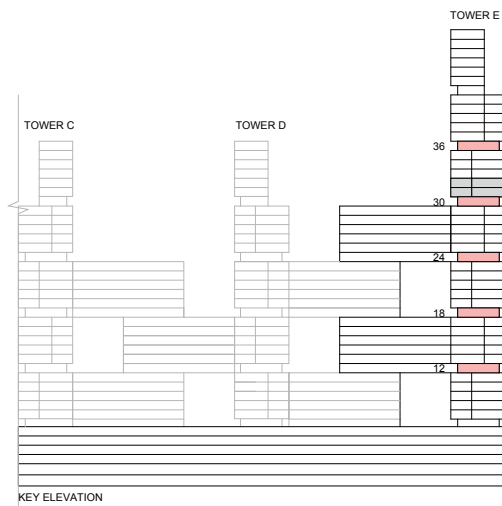

List of unit numbers with this unit plan:

## VIEWS

Downtown, Ras Al Khor

E1202, E1204, E1206, E1802, E1804, E1806, E2402, E2404, E2406, E3002, E3004, E3006, E3602, E3604, E3606

Disclaimer: 1. All dimensions are in metric, measured to wall finishes. 2. All materials, dimensions & drawings are approximate. 3. Information is subject to change without notice, at developer's absolute discretion. 4. Actual area may vary from the stated area. 5. Drawing are not to scale. 6. All images used are for illustrative purpose only and do not represent the actual size, features, specifications, fittings and furnishings. 7. The developer reserves the right to make revisions/ alterations, at its absolute discretion, without any liability whatsoever.

# 1 BEDROOM APARTMENT

TYPE B (with powder room + yard) VARIANT 3

## TOTAL SALEABLE AREA

SUITE = 675.65 SQ.FT.

YARD = 133.47 SQ.FT.

TOTAL = 809.12 SQ.FT.

■ UNIT



TOWER E

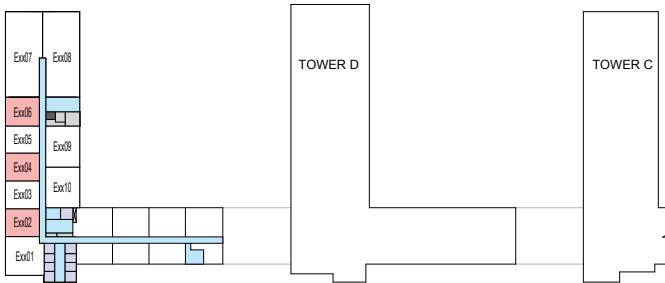

LEVEL 12



TOWER E

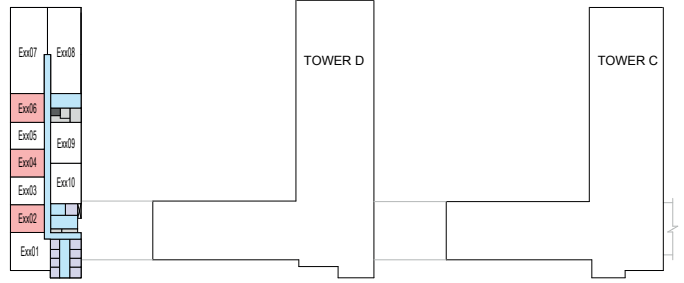

LEVEL 18



TOWER E

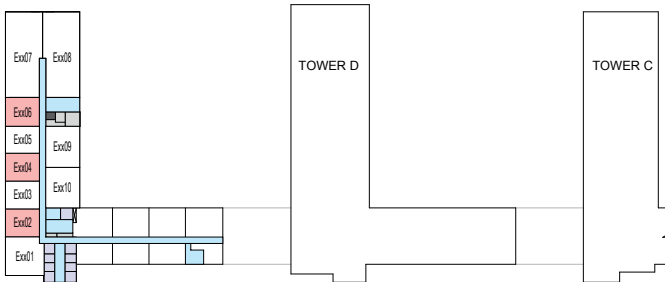

LEVEL 24



TOWER E

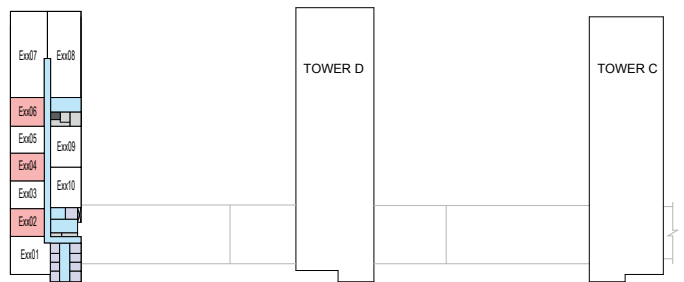

LEVEL 30,36

List of unit numbers with this unit plan:

## VIEWS

Downtown, Ras Al Khor

E1202, E1204, E1206, E1802, E1804, E1806, E2402, E2404, E2406, E3002, E3004, E3006, E3602, E3604, E3606

Disclaimer: 1. All dimensions are in metric, measured to wall finishes. 2. All materials, dimensions & drawings are approximate. 3. Information is subject to change without notice, at developer's absolute discretion. 4. Actual area may vary from the stated area. 5. Drawing are not to scale. 6. All images used are for illustrative purpose only and do not represent the actual size, features, specifications, fittings and furnishings. 7. The developer reserves the right to make revisions/ alterations, at its absolute discretion, without any liability whatsoever.



# 1 BEDROOM APARTMENT

TYPE B (with powder room + yard) VARIANT 4

**TOTAL SALEABLE AREA**

SUITE = 675.65 SQ.FT.

YARD = 133.47 SQ.FT.

TOTAL = 809.12 SQ.FT.

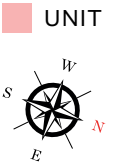
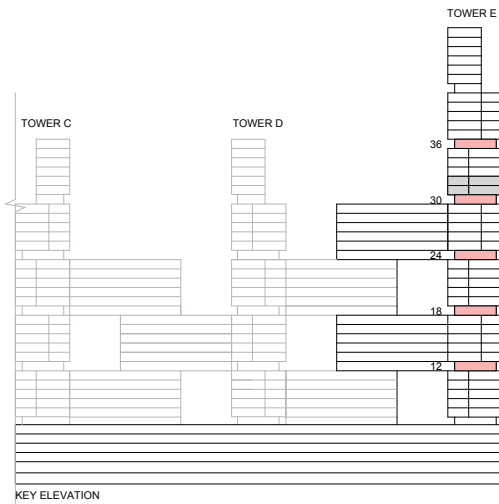

List of unit numbers with this unit plan:

## VIEWS

Downtown, Ras Al Khor

E1203, E1205, E1803, E1805, E2403, E2405, E3003, E3005, E3603, E3605

Disclaimer: 1. All dimensions are in metric, measured to wall finishes. 2. All materials, dimensions & drawings are approximate. 3. Information is subject to change without notice, at developer's absolute discretion. 4. Actual area may vary from the stated area. 5. Drawing are not to scale. 6. All images used are for illustrative purpose only and do not represent the actual size, features, specifications, fittings and furnishings. 7. The developer reserves the right to make revisions/ alterations, at its absolute discretion, without any liability whatsoever.

# 1 BEDROOM APARTMENT

TYPE B (with powder room + yard) VARIANT 4

## TOTAL SALEABLE AREA

SUITE = 675.65 SQ.FT.

YARD = 133.47 SQ.FT.

TOTAL = 809.12 SQ.FT.

■ UNIT



TOWER E

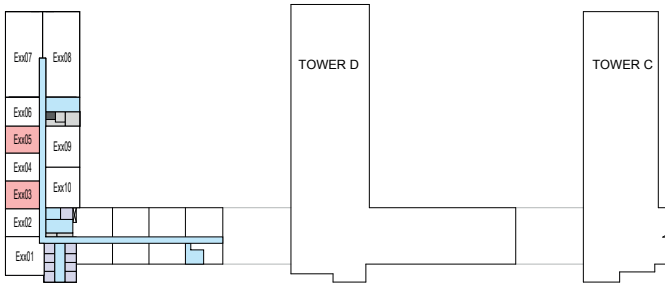

LEVEL 12



TOWER E

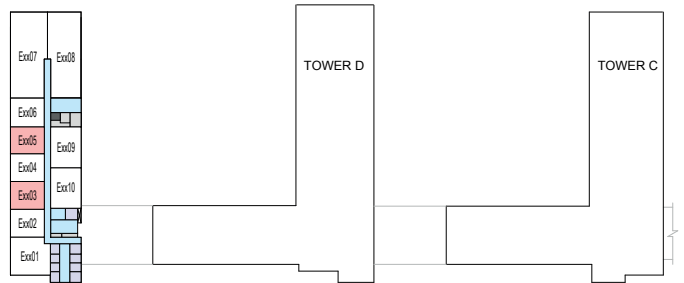

LEVEL 18



TOWER E

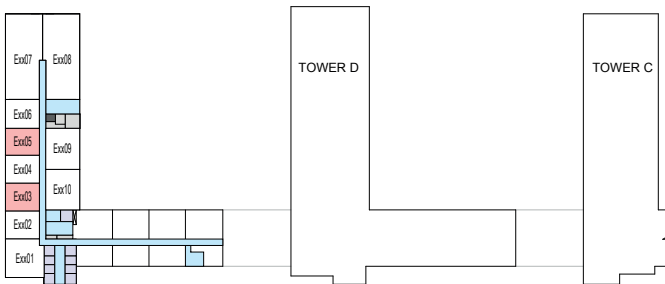

LEVEL 24



TOWER E

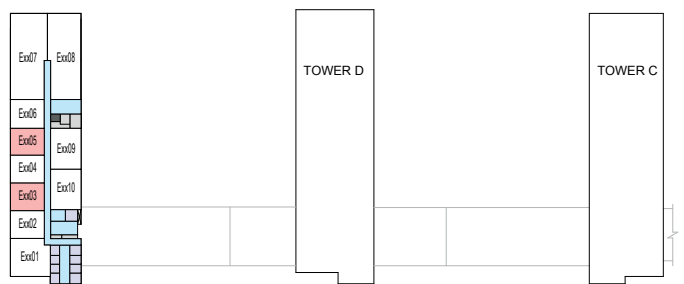

LEVEL 30,36

List of unit numbers with this unit plan:

## VIEWS

Downtown, Ras Al Khor

E1203, E1205, E1803, E1805, E2403, E2405, E3003, E3005, E3603, E3605

Disclaimer: 1. All dimensions are in metric, measured to wall finishes. 2. All materials, dimensions & drawings are approximate. 3. Information is subject to change without notice, at developer's absolute discretion. 4. Actual area may vary from the stated area. 5. Drawing are not to scale. 6. All images used are for illustrative purpose only and do not represent the actual size, features, specifications, fittings and furnishings. 7. The developer reserves the right to make revisions/ alterations, at its absolute discretion, without any liability whatsoever.



# 1 BEDROOM APARTMENT

TYPE C (with powder room + yard) VARIANT 3

## TOTAL SALEABLE AREA

SUITE = 676.40 SQ.FT.

YARD = 132.61 SQ.FT.

TOTAL = 809.01 SQ.FT.

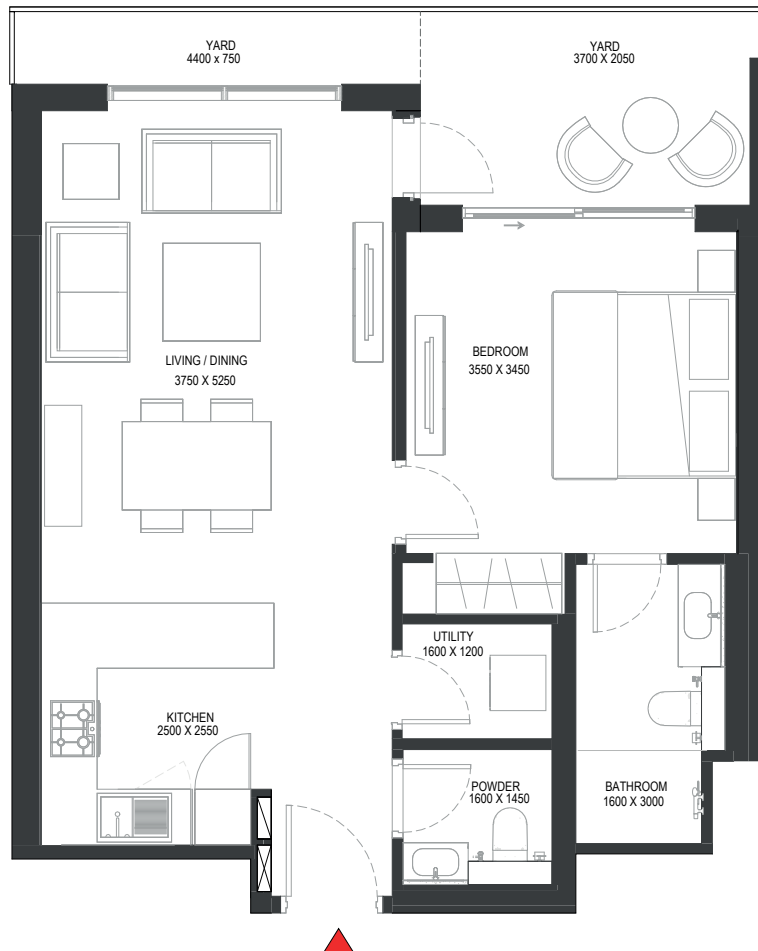
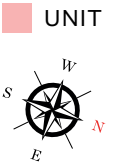
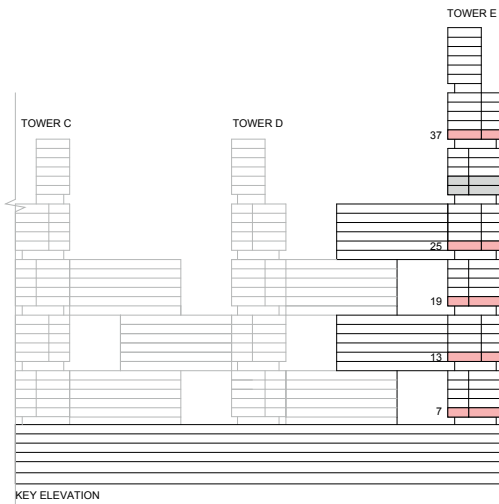

List of unit numbers with this unit plan:

## VIEWS

Downtown, Ras Al Khor

E702, E704, E706, E1302, E1304, E1306, E1902, E1904, E1906, E2502, E2504, E2506, E3702, E3704, E3706

Disclaimer: 1. All dimensions are in metric, measured to wall finishes. 2. All materials, dimensions & drawings are approximate. 3. Information is subject to change without notice, at developer's absolute discretion. 4. Actual area may vary from the stated area. 5. Drawing are not to scale. 6. All images used are for illustrative purpose only and do not represent the actual size, features, specifications, fittings and furnishings. 7. The developer reserves the right to make revisions/ alterations, at its absolute discretion, without any liability whatsoever.

# 1 BEDROOM APARTMENT

TYPE C (with powder room + yard) VARIANT 3

**TOTAL SALEABLE AREA**

SUITE = 676.40 SQ.FT.

YARD = 132.61 SQ.FT.

TOTAL = 809.01 SQ.FT.

UNIT



TOWER E

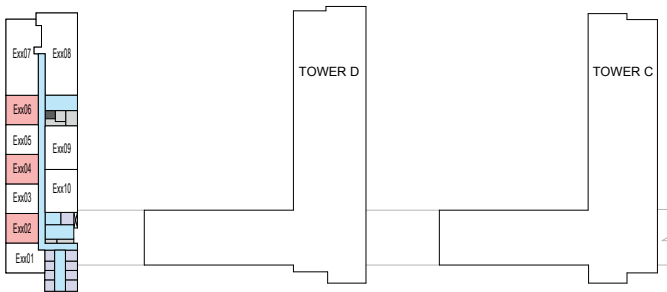

LEVEL 7, 19



TOWER E

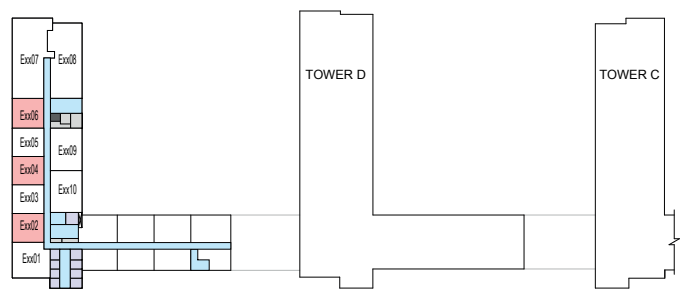

LEVEL 13



TOWER E

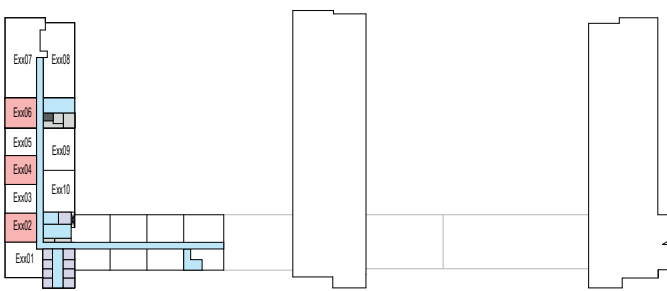

LEVEL 25



TOWER E

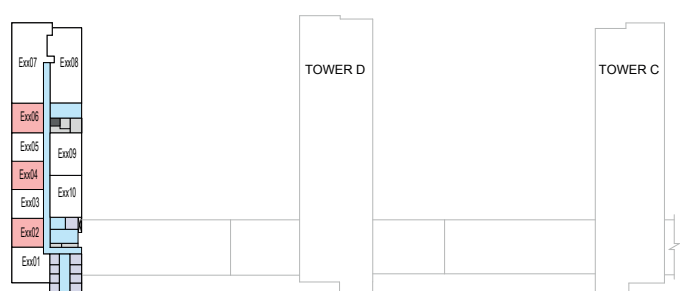

LEVEL 37

List of unit numbers with this unit plan:

## VIEWS

Downtown, Ras Al Khor

E702, E704, E706, E1302, E1304, E1306, E1902, E1904, E1906, E2502, E2504, E2506, E3702, E3704, E3706

Disclaimer: 1. All dimensions are in metric, measured to wall finishes. 2. All materials, dimensions & drawings are approximate. 3. Information is subject to change without notice, at developer's absolute discretion. 4. Actual area may vary from the stated area. 5. Drawing are not to scale. 6. All images used are for illustrative purpose only and do not represent the actual size, features, specifications, fittings and furnishings. 7. The developer reserves the right to make revisions/ alterations, at its absolute discretion, without any liability whatsoever.



# 1 BEDROOM APARTMENT

TYPE C (with powder room + yard) VARIANT 4

## TOTAL SALEABLE AREA

SUITE = 676.40 SQ.FT.

YARD = 132.61 SQ.FT.

TOTAL = 809.01 SQ.FT.

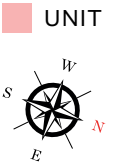
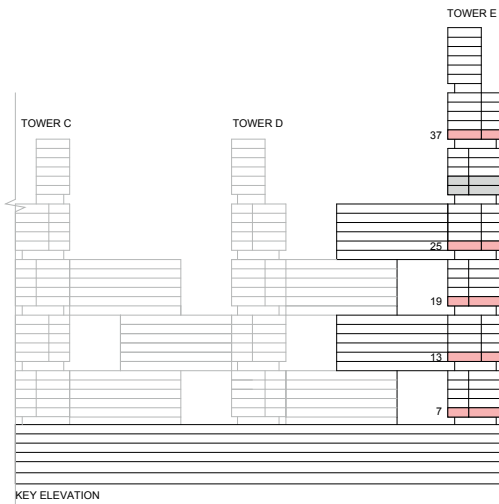

List of unit numbers with this unit plan:

## VIEWS

Downtown, Ras Al Khor

E703, E705, E1303, E1305, E1903, E1905, E2503, E2505, E3703, E3705

Disclaimer: 1. All dimensions are in metric, measured to wall finishes. 2. All materials, dimensions & drawings are approximate. 3. Information is subject to change without notice, at developer's absolute discretion. 4. Actual area may vary from the stated area. 5. Drawing are not to scale. 6. All images used are for illustrative purpose only and do not represent the actual size, features, specifications, fittings and furnishings. 7. The developer reserves the right to make revisions/ alterations, at its absolute discretion, without any liability whatsoever.

# 1 BEDROOM APARTMENT

TYPE C (with powder room + yard) VARIANT 4

## TOTAL SALEABLE AREA

SUITE = 676.40 SQ.FT.

YARD = 132.61 SQ.FT.

TOTAL = 809.01 SQ.FT.

■ UNIT



TOWER E

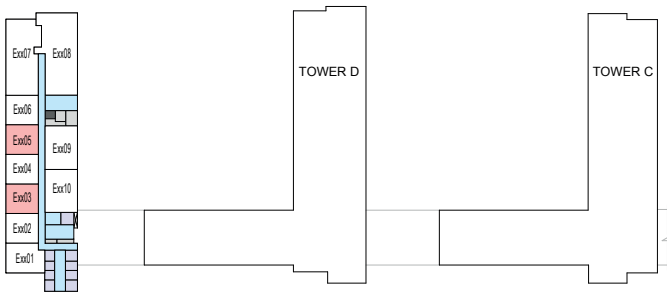

LEVEL 7, 19



TOWER E

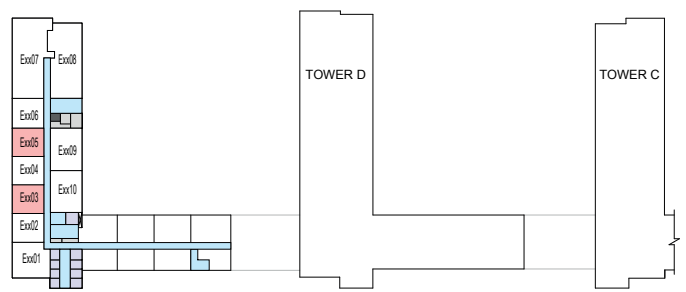

LEVEL 13



TOWER E

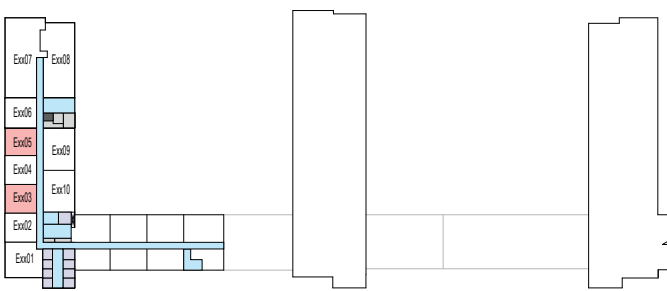

LEVEL 25



TOWER E

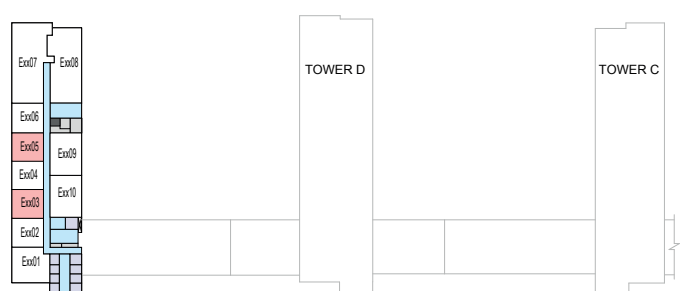

LEVEL 37

List of unit numbers with this unit plan:

## VIEWS

Downtown, Ras Al Khor

E703, E705, E1303, E1305, E1903, E1905, E2503, E2505, E3703, E3705

Disclaimer: 1. All dimensions are in metric, measured to wall finishes. 2. All materials, dimensions & drawings are approximate. 3. Information is subject to change without notice, at developer's absolute discretion. 4. Actual area may vary from the stated area. 5. Drawing are not to scale. 6. All images used are for illustrative purpose only and do not represent the actual size, features, specifications, fittings and furnishings. 7. The developer reserves the right to make revisions/ alterations, at its absolute discretion, without any liability whatsoever.



# 2 BEDROOM APARTMENT

TYPE A (with powder room + balcony) VARIANT 2

## TOTAL SALEABLE AREA

SUITE = 1,035.81 SQ.FT.  
 BALCONY = 64.36 SQ.FT.  
 TOTAL = 1,100.17 SQ.FT.

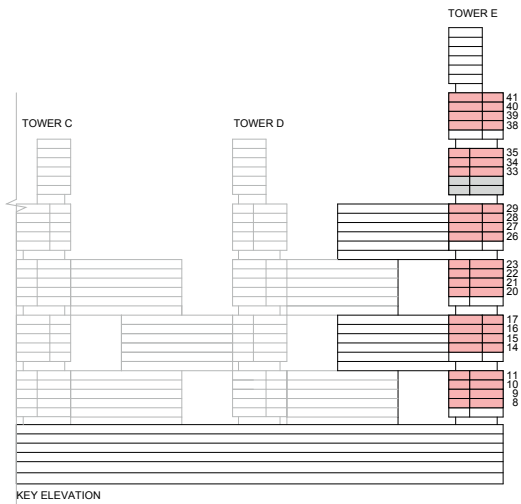

UNIT

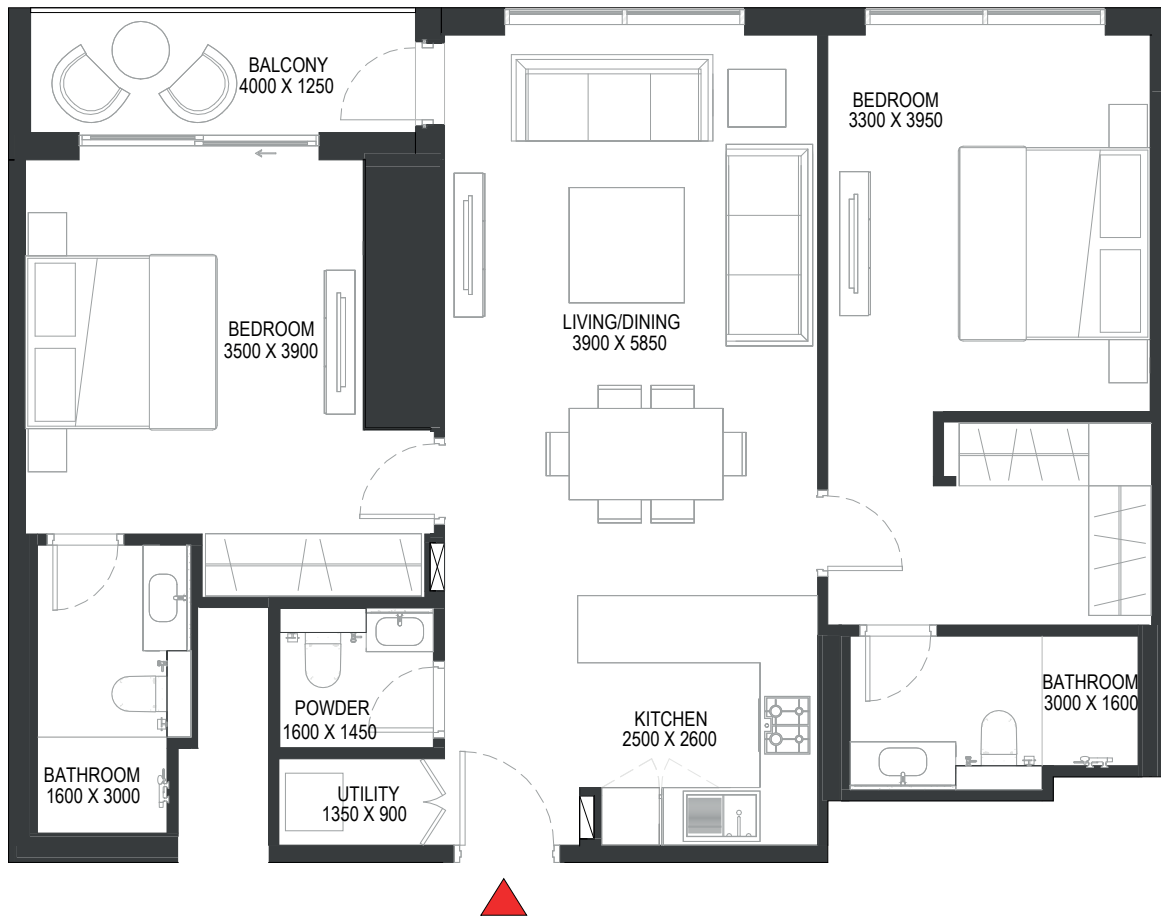
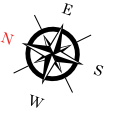

List of unit numbers with this unit plan:

### VIEWS

#### Creek, Amenities

E810, E910, E1010, E1110

#### Creek, Golf Course, Amenities

E1410, E1510, E1610, E1710, E2010, E2110, E2210, E2310

#### Creek, Golf Course

E2610, E2710, E2810, E2910, E3310, E3410, E3510, E3810, E3910, E4010, E4110

Disclaimer: 1. All dimensions are in metric, measured to wall finishes. 2. All materials, dimensions & drawings are approximate. 3. Information is subject to change without notice, at developer's absolute discretion. 4. Actual area may vary from the stated area. 5. Drawing are not to scale. 6. All images used are for illustrative purpose only and do not represent the actual size, features, specifications, fittings and furnishings. 7. The developer reserves the right to make revisions/ alterations, at its absolute discretion, without any liability whatsoever.

# 2 BEDROOM APARTMENT

TYPE A (with powder room + balcony) VARIANT 2

**TOTAL SALEABLE AREA**

SUITE = 1,035.81 SQ.FT.

BALCONY = 64.36 SQ.FT.

TOTAL = 1,100.17 SQ.FT.

 UNIT



TOWER E

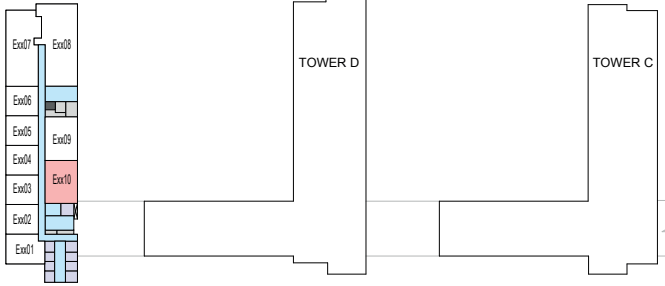

LEVEL 8-11, 20-23



TOWER E

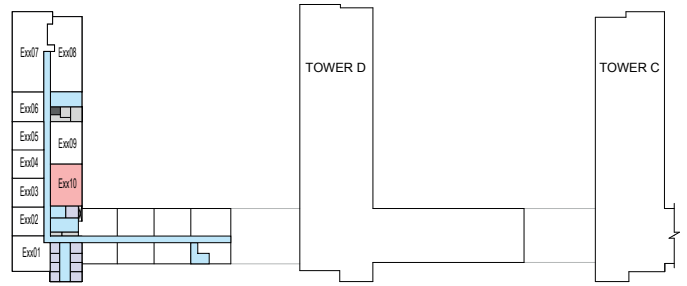

LEVEL 14-17



TOWER E

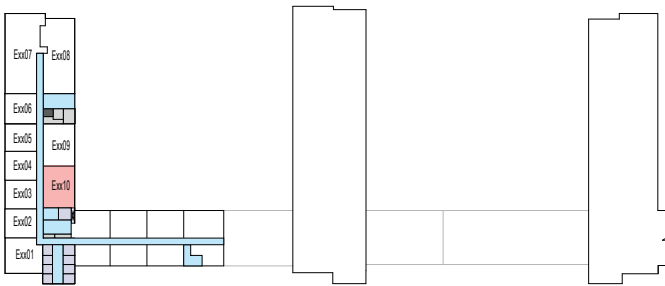

LEVEL 26-29



TOWER E

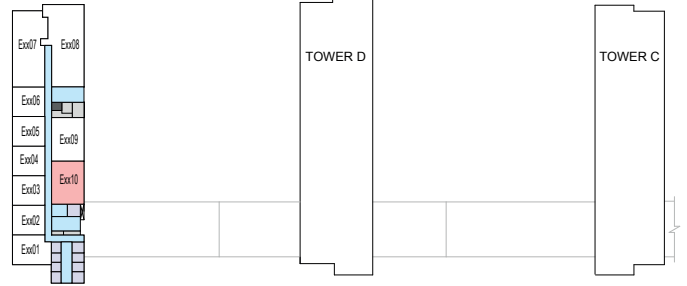

LEVEL 33-35



TOWER E

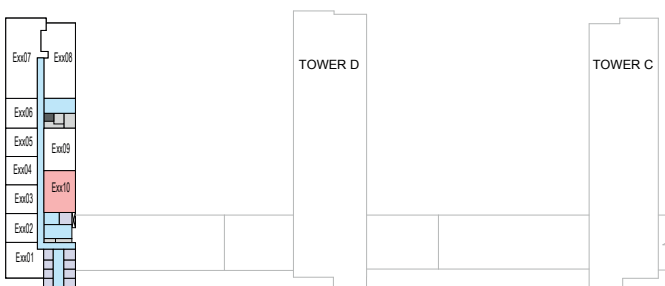

LEVEL 38-41

List of unit numbers with this unit plan:

## VIEWS

### Creek, Amenities

E810, E910, E1010, E1110

### Creek, Golf Course, Amenities

E1410, E1510, E1610, E1710, E2010, E2110, E2210, E2310

### Creek, Golf Course

E2610, E2710, E2810, E2910, E3310, E3410, E3510, E3810, E3910, E4010, E4110

Disclaimer: 1. All dimensions are in metric, measured to wall finishes. 2. All materials, dimensions & drawings are approximate. 3. Information is subject to change without notice, at developer's absolute discretion. 4. Actual area may vary from the stated area. 5. Drawing are not to scale. 6. All images used are for illustrative purpose only and do not represent the actual size, features, specifications, fittings and furnishings. 7. The developer reserves the right to make revisions/ alterations, at its absolute discretion, without any liability whatsoever.



# 2 BEDROOM APARTMENT

TYPE A (with powder room + balcony) VARIANT 3

## TOTAL SALEABLE AREA

SUITE = 1,035.81 SQ.FT.  
 BALCONY = 64.36 SQ.FT.  
 TOTAL = 1,100.17 SQ.FT.

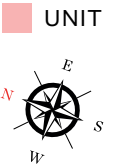
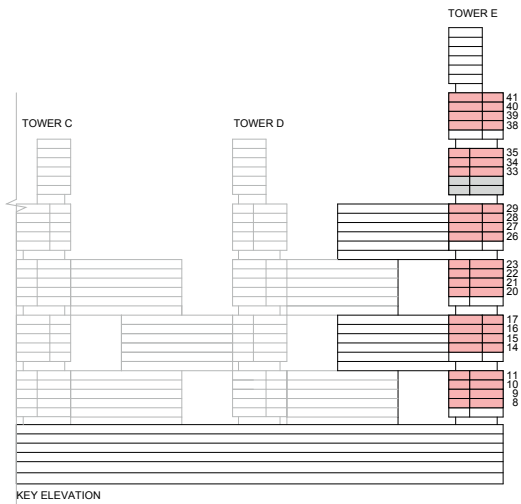

List of unit numbers with this unit plan:

### VIEWS

**Creek, Amenities**

E809, E909, E1009, E1109

**Creek, Golf Course, Amenities**

E1409, E1509, E1609, E1709, E2009, E2109, E2209, E2309

**Creek, Golf Course**

E2609, E2709, E2809, E2909, E3309, E3409, E3509, E3809, E3909, E4009, E4109

Disclaimer: 1. All dimensions are in metric, measured to wall finishes. 2. All materials, dimensions & drawings are approximate. 3. Information is subject to change without notice, at developer's absolute discretion. 4. Actual area may vary from the stated area. 5. Drawing are not to scale. 6. All images used are for illustrative purpose only and do not represent the actual size, features, specifications, fittings and furnishings. 7. The developer reserves the right to make revisions/ alterations, at its absolute discretion, without any liability whatsoever.

# 2 BEDROOM APARTMENT

TYPE A (with powder room + balcony) VARIANT 3

**TOTAL SALEABLE AREA**

SUITE = 1,035.81 SQ.FT.

BALCONY = 64.36 SQ.FT.

TOTAL = 1,100.17 SQ.FT.

 UNIT



TOWER E

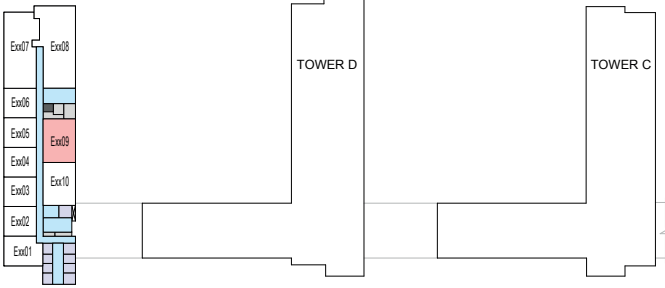

LEVEL 8-11, 20-23



TOWER E

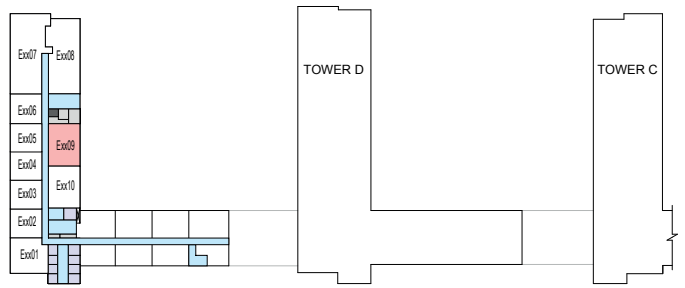

LEVEL 14-17



TOWER E

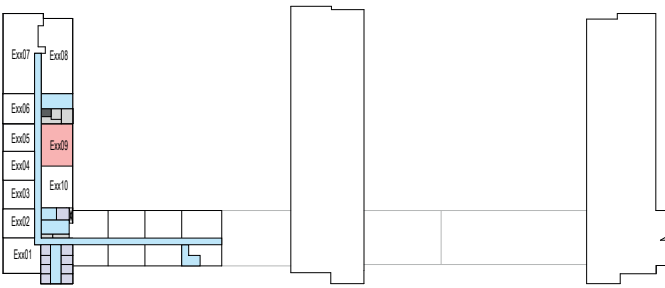

LEVEL 26-29



TOWER E

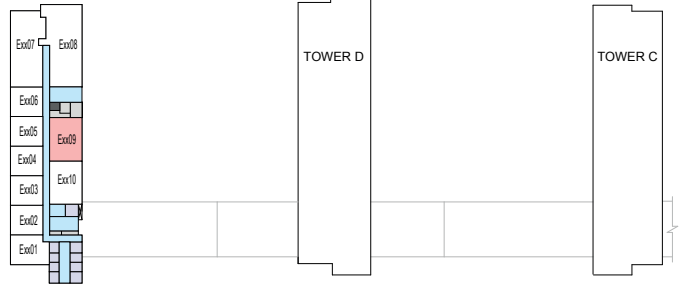

LEVEL 33-35



TOWER E

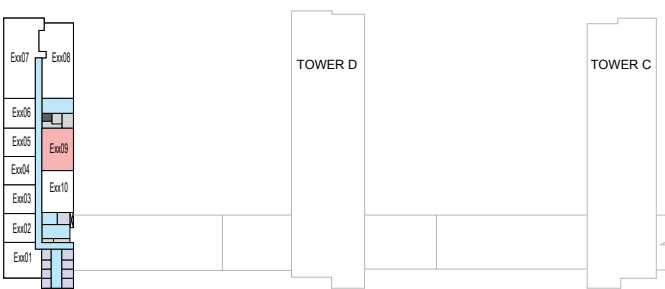

LEVEL 38-41

List of unit numbers with this unit plan:

## VIEWS

### Creek, Amenities

E809, E909, E1009, E1109

### Creek, Golf Course, Amenities

E1409, E1509, E1609, E1709, E2009, E2109, E2209, E2309

### Creek, Golf Course

E2609, E2709, E2809, E2909, E3309, E3409, E3509, E3809, E3909, E4009, E4109

Disclaimer: 1. All dimensions are in metric, measured to wall finishes. 2. All materials, dimensions & drawings are approximate. 3. Information is subject to change without notice, at developer's absolute discretion. 4. Actual area may vary from the stated area. 5. Drawing are not to scale. 6. All images used are for illustrative purpose only and do not represent the actual size, features, specifications, fittings and furnishings. 7. The developer reserves the right to make revisions/ alterations, at its absolute discretion, without any liability whatsoever.



# 2 BEDROOM APARTMENT

TYPE B (with maid room + balcony) VARIANT 2

## TOTAL SALEABLE AREA

SUITE = 1,081.08 SQ.FT.

BALCONY = 51.49 SQ.FT.

TOTAL = 1,132.57 SQ.FT.

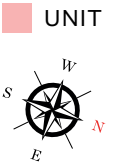

List of unit numbers with this unit plan:

## VIEWS

Downtown, Ras Al Khor

E801, E901, E1001, E1101, E1401, E1501, E1601, E1701, E2001, E2101, E2201, E2301, E2601, E2701, E2801, E2901, E3301, E3401, E3501, E3801, E3901, E4001, E4101

Disclaimer: 1. All dimensions are in metric, measured to wall finishes. 2. All materials, dimensions & drawings are approximate. 3. Information is subject to change without notice, at developer's absolute discretion. 4. Actual area may vary from the stated area. 5. Drawing are not to scale. 6. All images used are for illustrative purpose only and do not represent the actual size, features, specifications, fittings and furnishings. 7. The developer reserves the right to make revisions/ alterations, at its absolute discretion, without any liability whatsoever.

# 2 BEDROOM APARTMENT

TYPE B (with maid room + balcony) VARIANT 2

**TOTAL SALEABLE AREA**

SUITE = 1,081.08 SQ.FT.

BALCONY = 51.49 SQ.FT.

TOTAL = 1,132.57 SQ.FT.

 UNIT



TOWER E

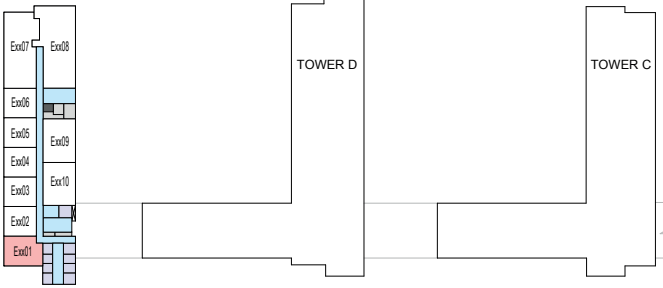

LEVEL 8-11, 20-23



TOWER E

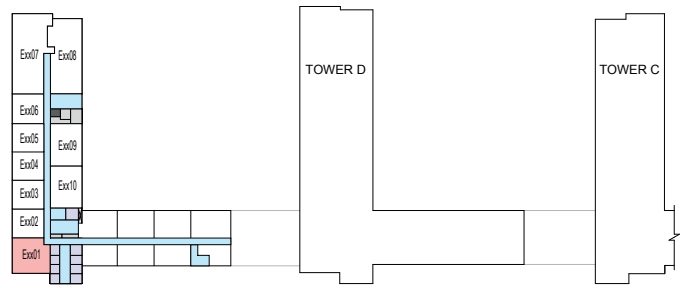

LEVEL 14-17



TOWER E

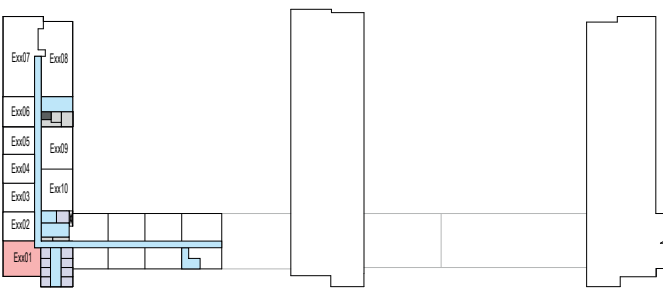

LEVEL 26-29



TOWER E

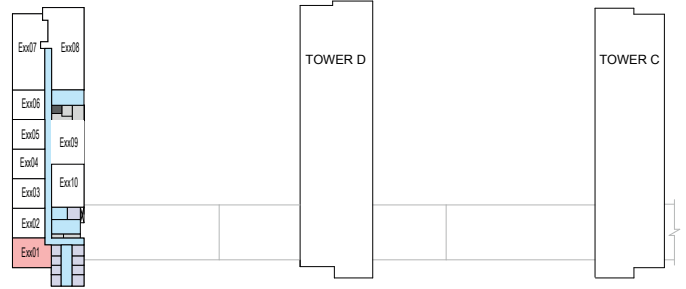

LEVEL 33-35



TOWER E

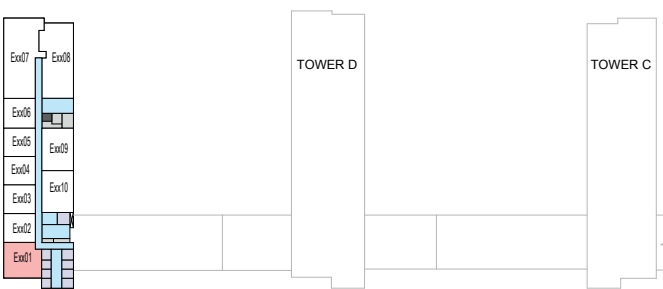

LEVEL 38-41

List of unit numbers with this unit plan:

## VIEWS

Downtown, Ras Al Khor

E801, E901, E1001, E1101, E1401, E1501, E1601, E1701, E2001, E2101, E2201, E2301, E2601, E2701, E2801, E2901, E3301, E3401, E3501, E3801, E3901, E4001, E4101

Disclaimer: 1. All dimensions are in metric, measured to wall finishes. 2. All materials, dimensions & drawings are approximate. 3. Information is subject to change without notice, at developer's absolute discretion. 4. Actual area may vary from the stated area. 5. Drawing are not to scale. 6. All images used are for illustrative purpose only and do not represent the actual size, features, specifications, fittings and furnishings. 7. The developer reserves the right to make revisions/ alterations, at its absolute discretion, without any liability whatsoever.



# 2 BEDROOM APARTMENT

TYPE G (with powder room + yard) VARIANT 2

## TOTAL SALEABLE AREA

SUITE = 1,026.77 SQ.FT.

YARD = 186.86 SQ.FT.

TOTAL = 1,213.63 SQ.FT.

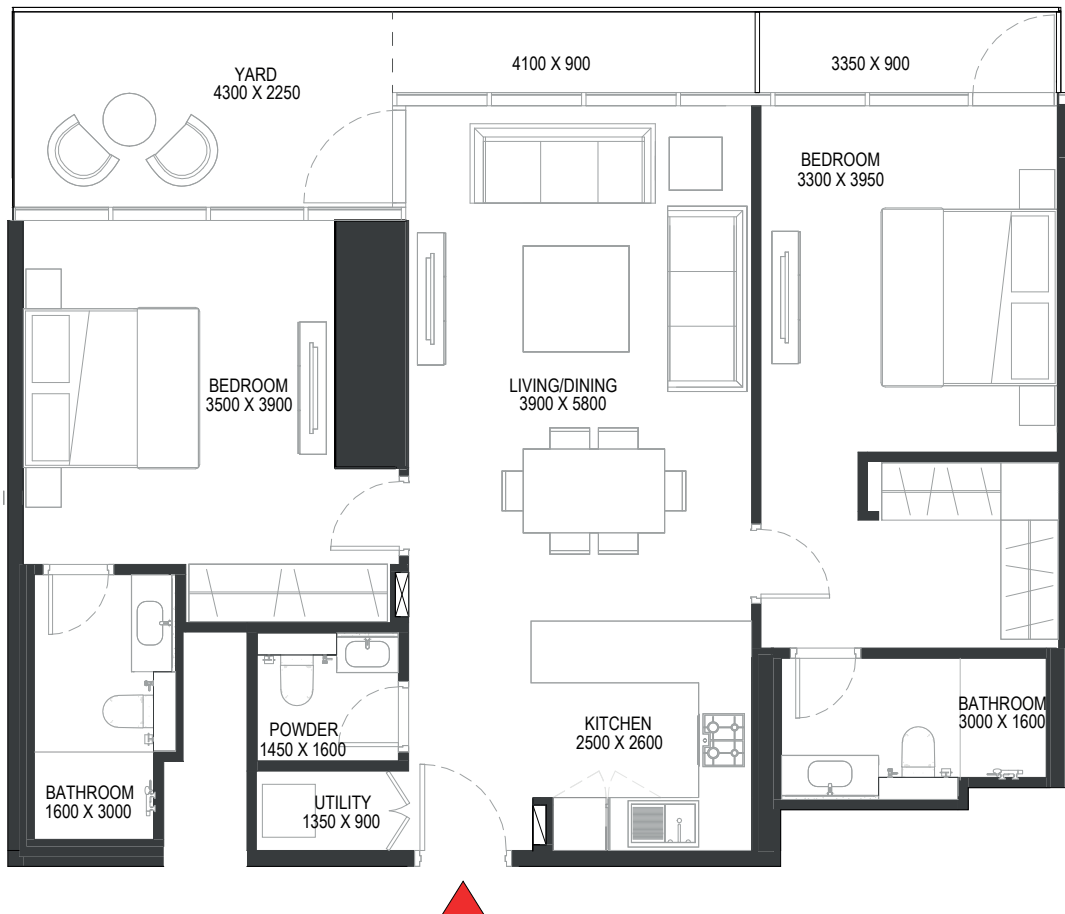
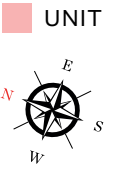
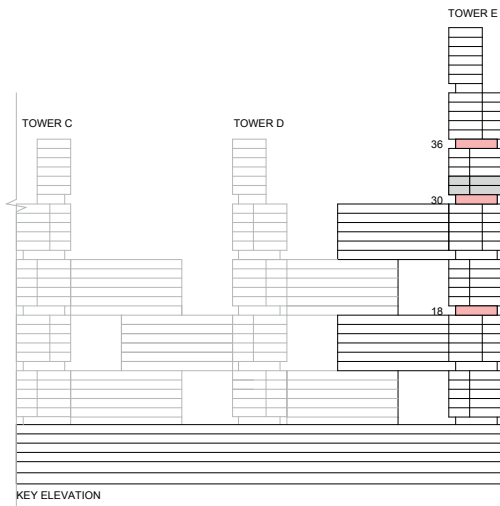

List of unit numbers with this unit plan:

## VIEWS

Creek, Golf Course, Amenities  
E1810

Creek, Golf Course  
E3010, E3610

Disclaimer: 1. All dimensions are in metric, measured to wall finishes. 2. All materials, dimensions & drawings are approximate. 3. Information is subject to change without notice, at developer's absolute discretion. 4. Actual area may vary from the stated area. 5. Drawing are not to scale. 6. All images used are for illustrative purpose only and do not represent the actual size, features, specifications, fittings and furnishings. 7. The developer reserves the right to make revisions/ alterations, at its absolute discretion, without any liability whatsoever.

# 2 BEDROOM APARTMENT

TYPE G (with powder room + yard) VARIANT 2

## TOTAL SALEABLE AREA

SUITE = 1,026.77 SQ.FT.

YARD = 186.86 SQ.FT.

TOTAL = 1,213.63 SQ.FT.

 UNIT

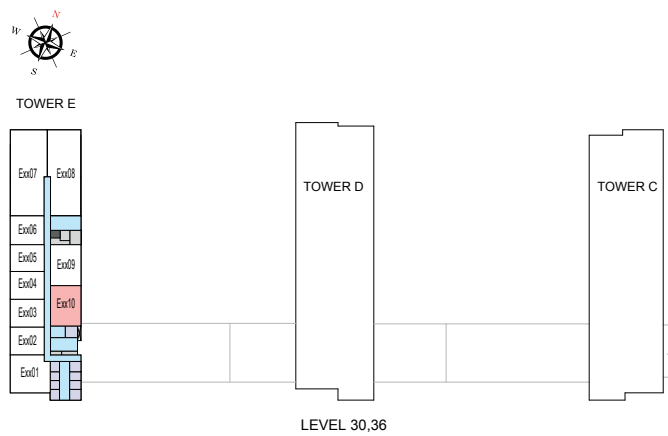
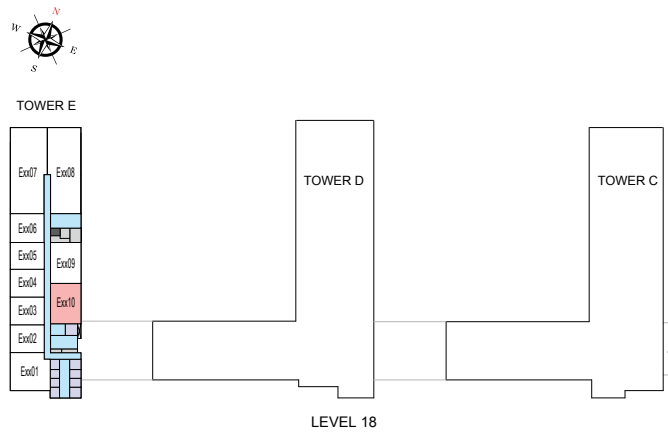

List of unit numbers with this unit plan:

## VIEWS

Creek, Golf Course, Amenities

E1810

Creek, Golf Course

E3010, E3610

Disclaimer: 1. All dimensions are in metric, measured to wall finishes. 2. All materials, dimensions & drawings are approximate. 3. Information is subject to change without notice, at developer's absolute discretion. 4. Actual area may vary from the stated area. 5. Drawing are not to scale. 6. All images used are for illustrative purpose only and do not represent the actual size, features, specifications, fittings and furnishings. 7. The developer reserves the right to make revisions/ alterations, at its absolute discretion, without any liability whatsoever.



# 2 BEDROOM APARTMENT

TYPE G (with powder room + yard) VARIANT 3

**TOTAL SALEABLE AREA**

SUITE = 1,026.77 SQ.FT.

YARD = 186.86 SQ.FT.

TOTAL = 1,213.63 SQ.FT.

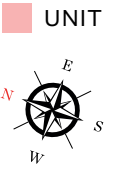
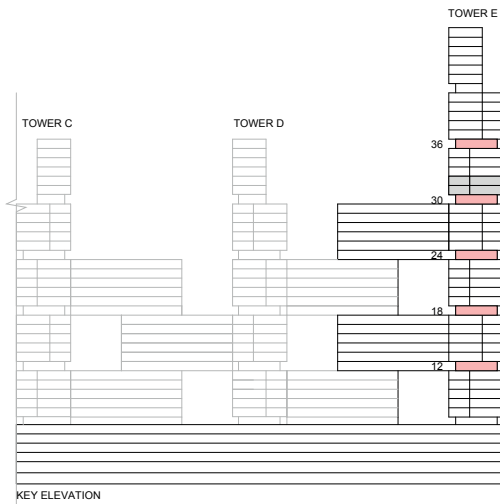

List of unit numbers with this unit plan:

## VIEWS

Creek, Amenities  
E1209

Creek, Golf Course, Amenities  
E1809, E2409

Creek, Golf Course  
E3009, E3609

Disclaimer: 1. All dimensions are in metric, measured to wall finishes. 2. All materials, dimensions & drawings are approximate. 3. Information is subject to change without notice, at developer's absolute discretion. 4. Actual area may vary from the stated area. 5. Drawing are not to scale. 6. All images used are for illustrative purpose only and do not represent the actual size, features, specifications, fittings and furnishings. 7. The developer reserves the right to make revisions/ alterations, at its absolute discretion, without any liability whatsoever.

# 2 BEDROOM APARTMENT

TYPE G (with powder room + yard) VARIANT 3

## TOTAL SALEABLE AREA

SUITE = 1,026.77 SQ.FT.

YARD = 186.86 SQ.FT.

TOTAL = 1,213.63 SQ.FT.

■ UNIT



TOWER E

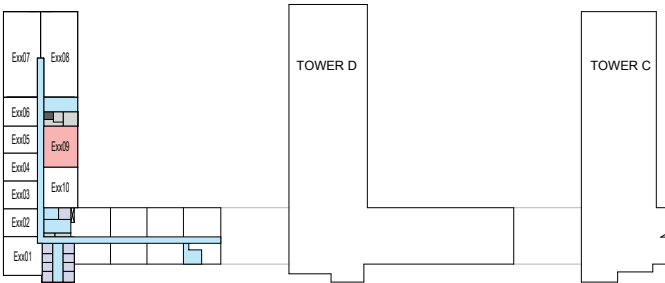

LEVEL 12



TOWER E

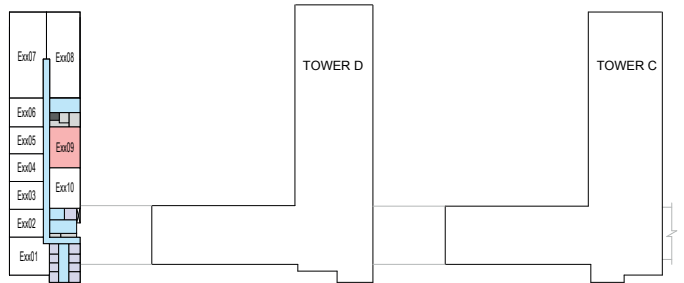

LEVEL 18



TOWER E

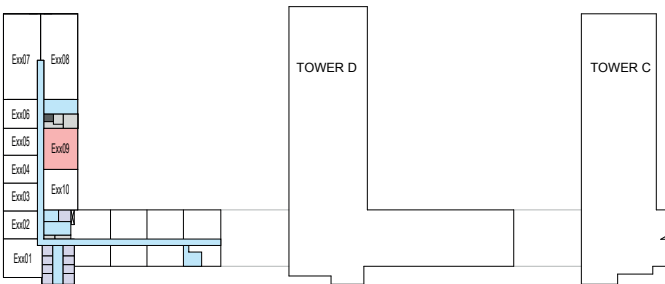

LEVEL 24



TOWER E

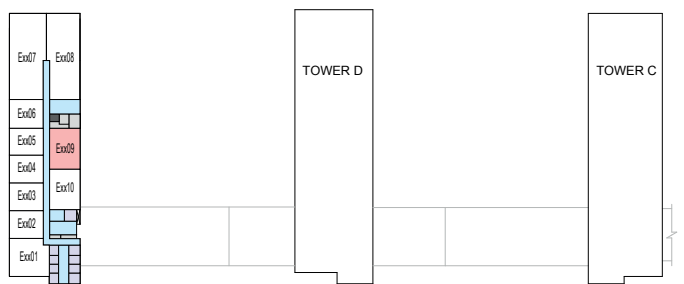

LEVEL 30,36

List of unit numbers with this unit plan:

## VIEWS

**Creek, Amenities**

E1209

**Creek, Golf Course, Amenities**

E1809, E2409

**Creek, Golf Course**

E3009, E3609

Disclaimer: 1. All dimensions are in metric, measured to wall finishes. 2. All materials, dimensions & drawings are approximate. 3. Information is subject to change without notice, at developer's absolute discretion. 4. Actual area may vary from the stated area. 5. Drawing are not to scale. 6. All images used are for illustrative purpose only and do not represent the actual size, features, specifications, fittings and furnishings. 7. The developer reserves the right to make revisions/ alterations, at its absolute discretion, without any liability whatsoever.

# 2 BEDROOM APARTMENT

TYPE P (with powder room + yard) VARIANT 2

## TOTAL SALEABLE AREA

SUITE = 1,035.81 SQ.FT.

YARD = 177.82 SQ.FT.

TOTAL = 1,213.63 SQ.FT.

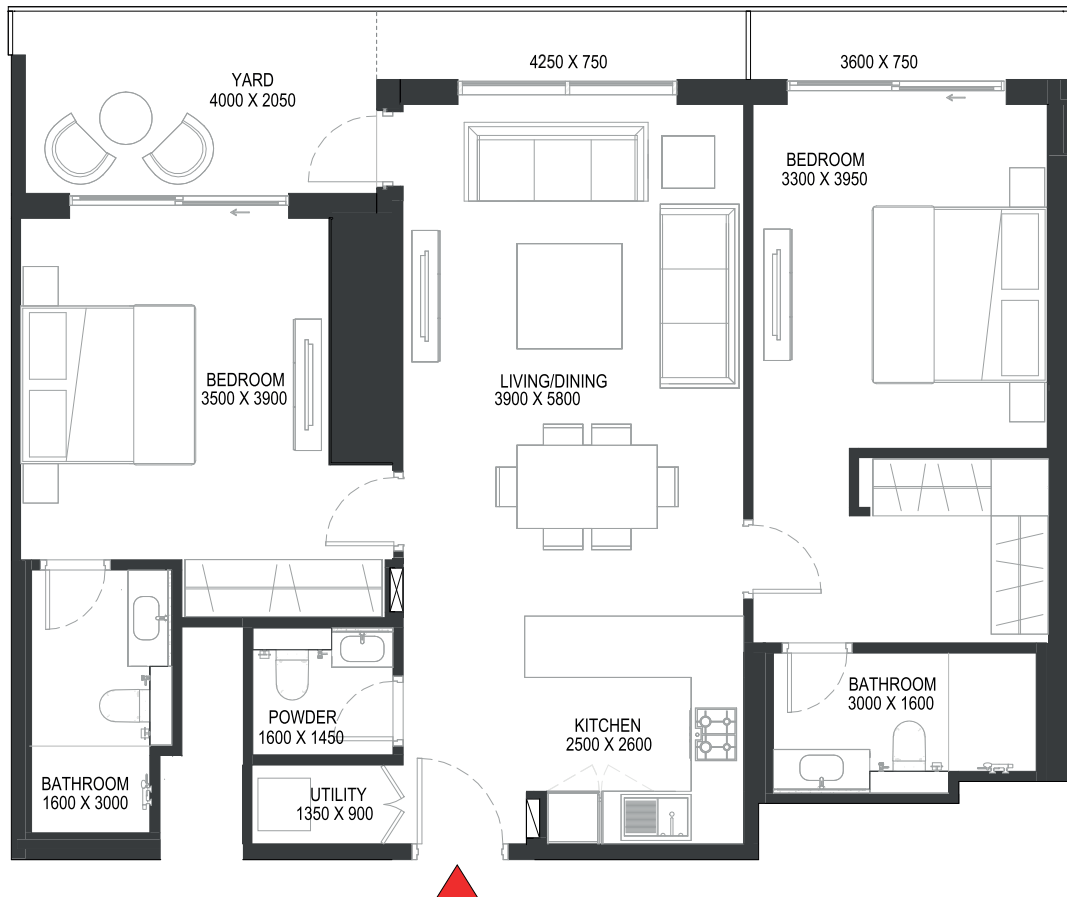
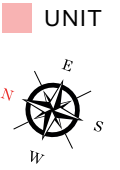
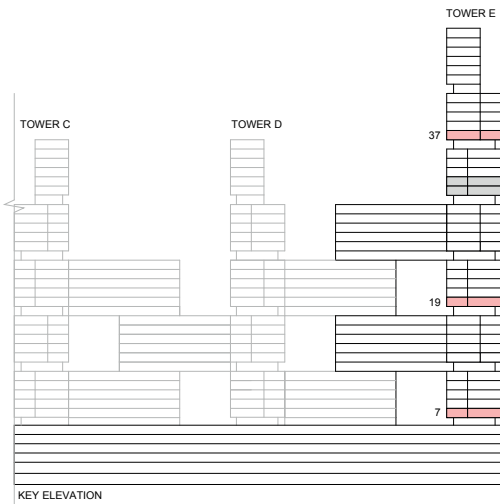

List of unit numbers with this unit plan:

## VIEWS

Creek, Amenities

E710

Creek, Golf Course, Amenities

E1910

Creek, Golf Course

E3710

Disclaimer: 1. All dimensions are in metric, measured to wall finishes. 2. All materials, dimensions & drawings are approximate. 3. Information is subject to change without notice, at developer's absolute discretion. 4. Actual area may vary from the stated area. 5. Drawing are not to scale. 6. All images used are for illustrative purpose only and do not represent the actual size, features, specifications, fittings and furnishings. 7. The developer reserves the right to make revisions/ alterations, at its absolute discretion, without any liability whatsoever.



# 2 BEDROOM APARTMENT

TYPE P (with powder room + yard) VARIANT 2

## TOTAL SALEABLE AREA

SUITE = 1,035.81 SQ.FT.

YARD = 177.82 SQ.FT.

TOTAL = 1,213.63 SQ.FT.

 UNIT

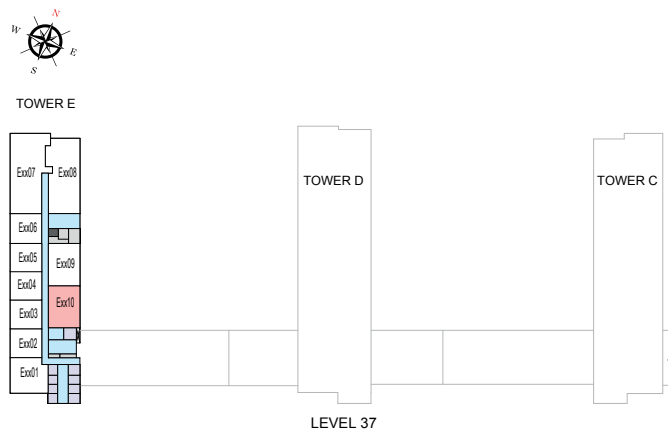
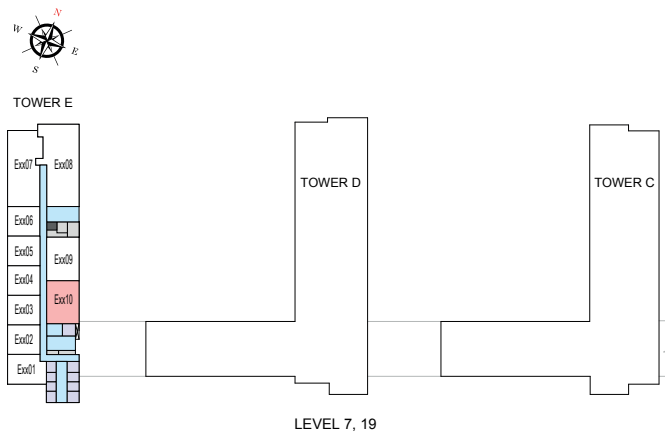

List of unit numbers with this unit plan:

## VIEWS

Creek, Amenities

E710

Creek, Golf Course, Amenities

E1910

Creek, Golf Course

E3710

Disclaimer: 1. All dimensions are in metric, measured to wall finishes. 2. All materials, dimensions & drawings are approximate. 3. Information is subject to change without notice, at developer's absolute discretion. 4. Actual area may vary from the stated area. 5. Drawing are not to scale. 6. All images used are for illustrative purpose only and do not represent the actual size, features, specifications, fittings and furnishings. 7. The developer reserves the right to make revisions/ alterations, at its absolute discretion, without any liability whatsoever.

# 2 BEDROOM APARTMENT

TYPE P (with powder room + yard) VARIANT 3

## TOTAL SALEABLE AREA

SUITE = 1,035.81 SQ.FT.

YARD = 177.82 SQ.FT.

TOTAL = 1,213.63 SQ.FT.

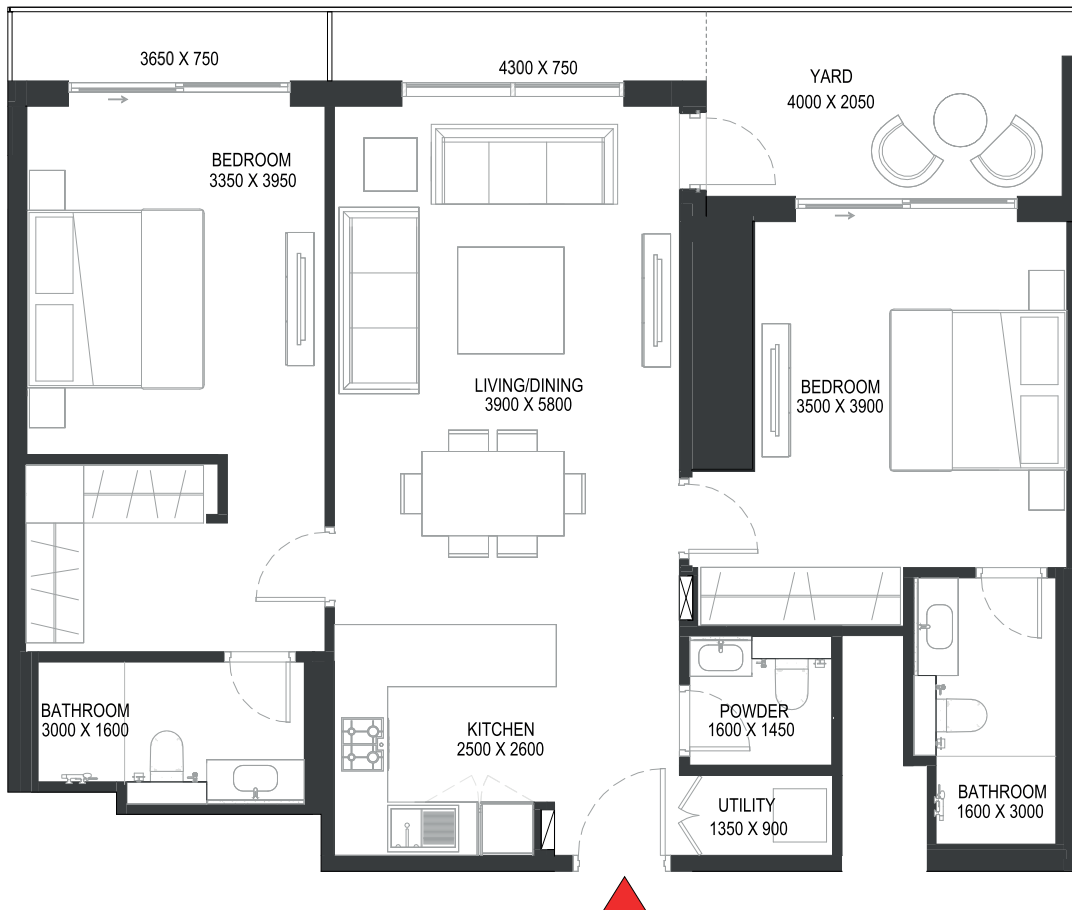
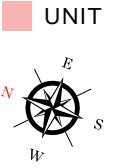
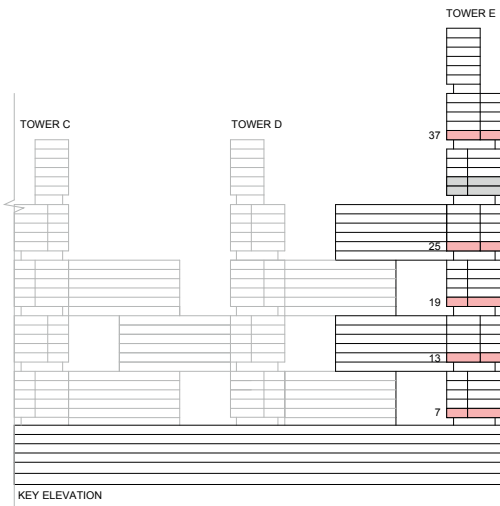

List of unit numbers with this unit plan:

### VIEWS

Creek, Amenities  
E709

Creek, Golf Course, Amenities  
E1309, E1909

Creek, Golf Course  
E2509, E3709

Disclaimer: 1. All dimensions are in metric, measured to wall finishes. 2. All materials, dimensions & drawings are approximate. 3. Information is subject to change without notice, at developer's absolute discretion. 4. Actual area may vary from the stated area. 5. Drawing are not to scale. 6. All images used are for illustrative purpose only and do not represent the actual size, features, specifications, fittings and furnishings. 7. The developer reserves the right to make revisions/ alterations, at its absolute discretion, without any liability whatsoever.

# 2 BEDROOM APARTMENT

TYPE P (with powder room + yard) VARIANT 3

**TOTAL SALEABLE AREA**

SUITE = 1,035.81 SQ.FT.

YARD = 177.82 SQ.FT.

TOTAL = 1,213.63 SQ.FT.

 UNIT

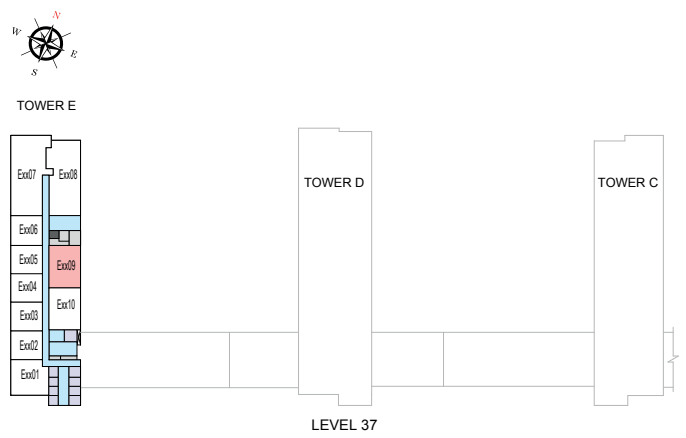
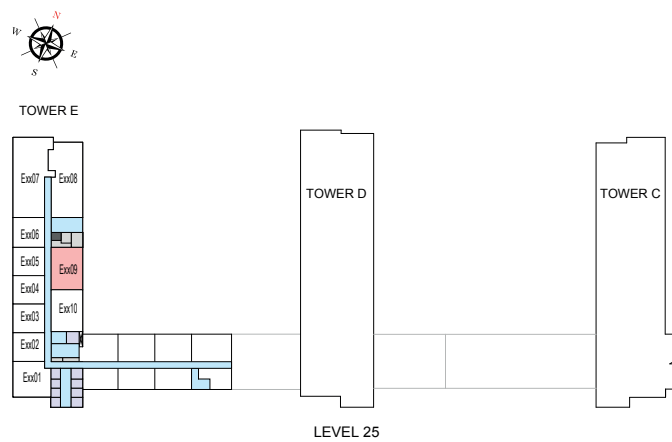
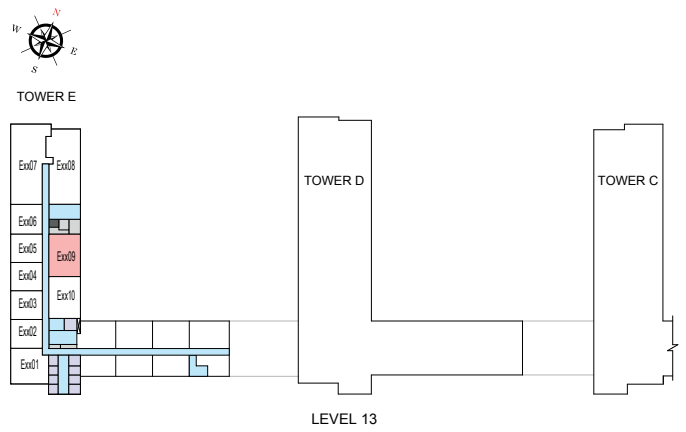
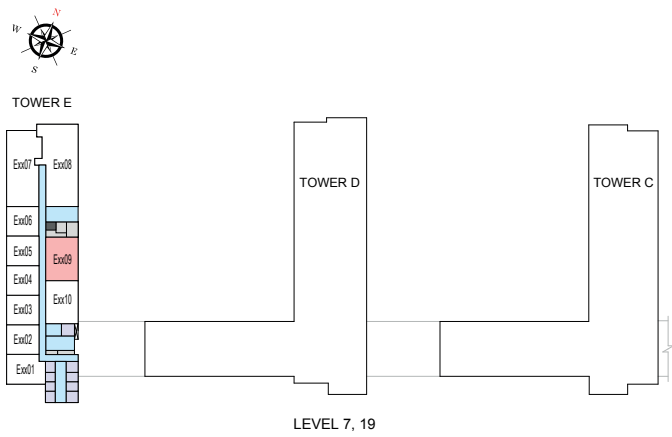

List of unit numbers with this unit plan:

## VIEWS

Creek, Amenities  
E709

Creek, Golf Course, Amenities  
E1309, E1909

Creek, Golf Course  
E2509, E3709

Disclaimer: 1. All dimensions are in metric, measured to wall finishes. 2. All materials, dimensions & drawings are approximate. 3. Information is subject to change without notice, at developer's absolute discretion. 4. Actual area may vary from the stated area. 5. Drawing are not to scale. 6. All images used are for illustrative purpose only and do not represent the actual size, features, specifications, fittings and furnishings. 7. The developer reserves the right to make revisions/ alterations, at its absolute discretion, without any liability whatsoever.



# 3 BEDROOM APARTMENT

TYPE A (with maid room + balcony)

**TOTAL SALEABLE AREA**

SUITE = 1,642.57 SQ.FT.

BALCONY = 274.54 SQ.FT.

TOTAL = 1,917.11 SQ.FT.

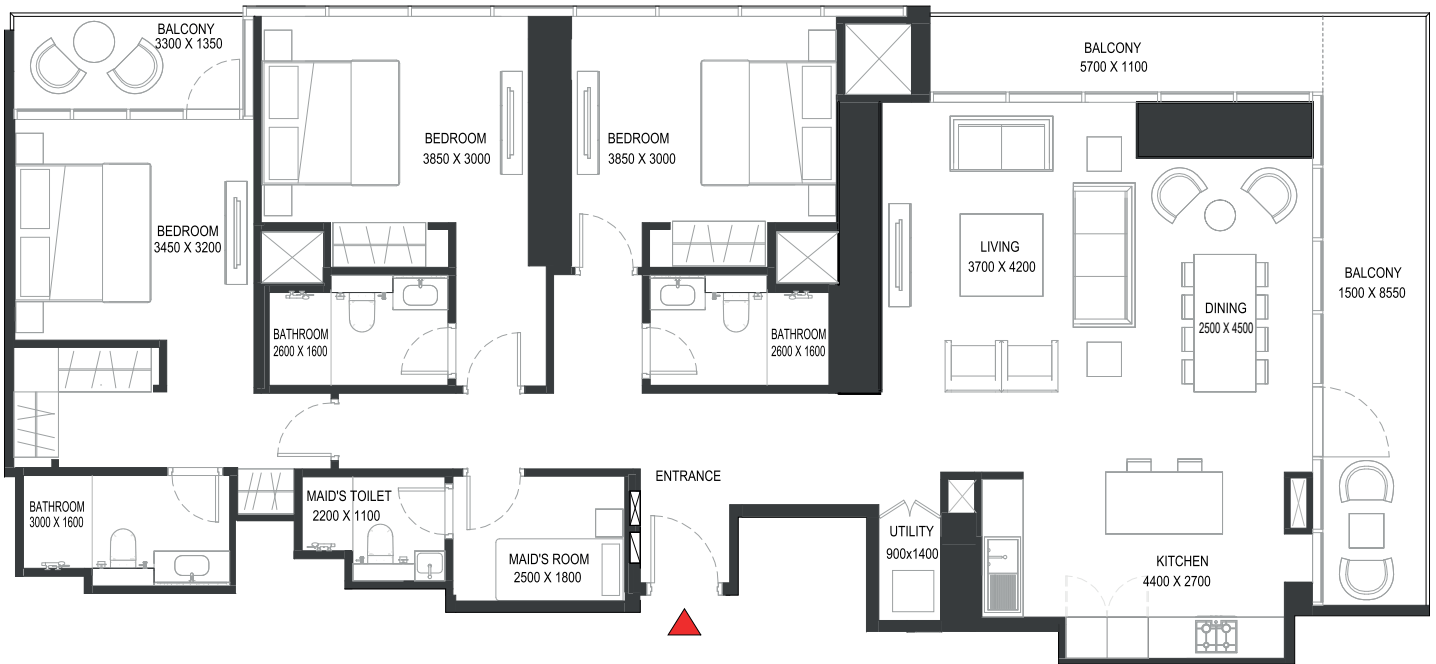
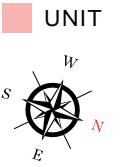
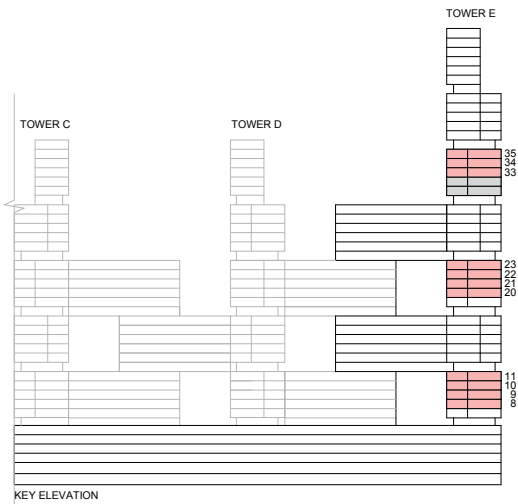

List of unit numbers with this unit plan:

## VIEWS

Downtown, Ras Al Khor, Creek, Golf Course, Water body

E807, E907, E1007, E1107, E2007, E2107, E2207, E2307, E3307, E3407, E3507

Disclaimer: 1. All dimensions are in metric, measured to wall finishes. 2. All materials, dimensions & drawings are approximate. 3. Information is subject to change without notice, at developer's absolute discretion. 4. Actual area may vary from the stated area. 5. Drawing are not to scale. 6. All images used are for illustrative purpose only and do not represent the actual size, features, specifications, fittings and furnishings. 7. The developer reserves the right to make revisions/ alterations, at its absolute discretion, without any liability whatsoever.

# 3 BEDROOM APARTMENT

TYPE A (with maid room + balcony)

## TOTAL SALEABLE AREA

SUITE = 1,642.57 SQ.FT.

BALCONY = 274.54 SQ.FT.

TOTAL = 1,917.11 SQ.FT.

 UNIT

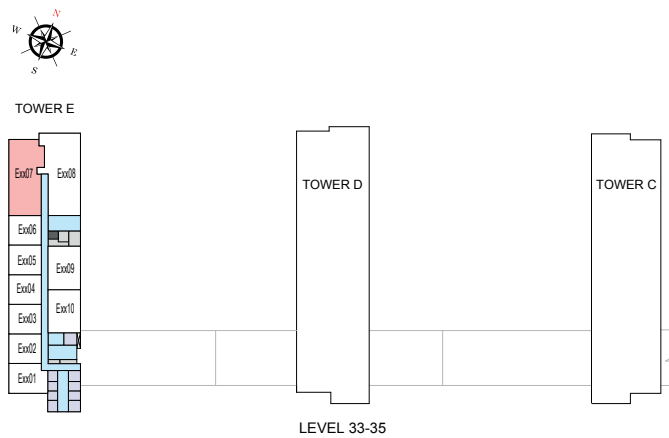
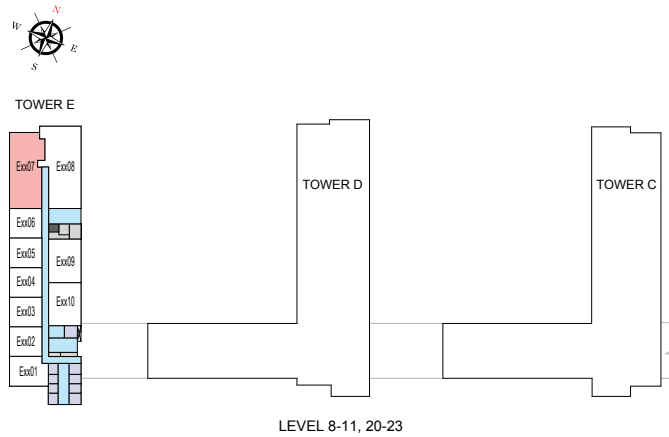

List of unit numbers with this unit plan:

## VIEWS

Downtown, Ras Al Khor, Creek, Golf Course, Water body

E807, E907, E1007, E1107, E2007, E2107, E2207, E2307, E3307, E3407, E3507

Disclaimer: 1. All dimensions are in metric, measured to wall finishes. 2. All materials, dimensions & drawings are approximate. 3. Information is subject to change without notice, at developer's absolute discretion. 4. Actual area may vary from the stated area. 5. Drawing are not to scale. 6. All images used are for illustrative purpose only and do not represent the actual size, features, specifications, fittings and furnishings. 7. The developer reserves the right to make revisions/ alterations, at its absolute discretion, without any liability whatsoever.

# 3 BEDROOM APARTMENT

TYPE A (with maid room + balcony) VARIANT 1

**TOTAL SALEABLE AREA**

SUITE = 1,642.57 SQ.FT.

BALCONY = 274.54 SQ.FT.

TOTAL = 1,917.11 SQ.FT.

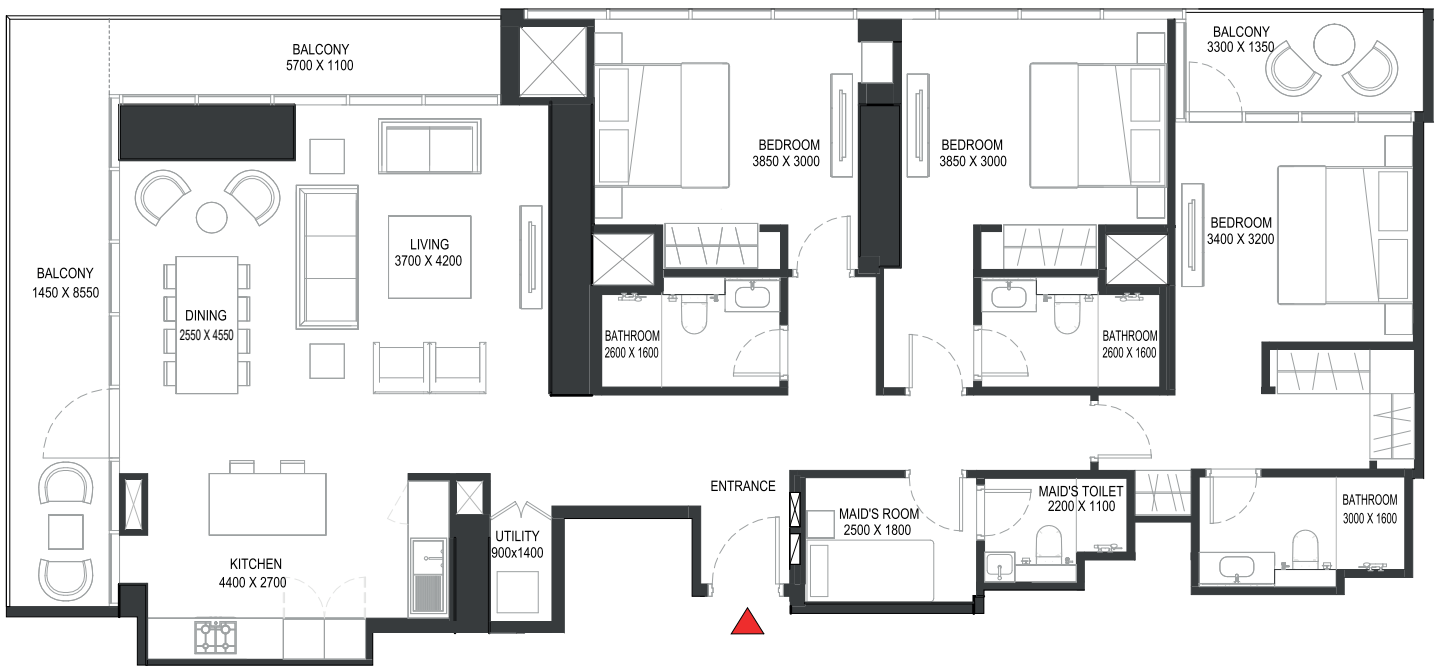
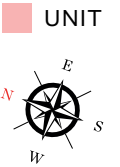
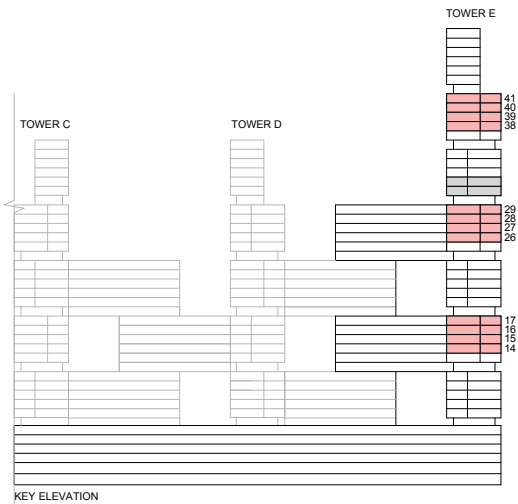

List of unit numbers with this unit plan:

## VIEWS

**Downtown, Ras Al Khor, Creek, Golf Course, Water body, Amenities**

E1408, E1508, E1608, E1708

**Downtown, Ras Al Khor, Creek, Golf Course, Water body**

E2608, E2708, E2808, E2908, E3808, E3908, E4008, E4108

Disclaimer: 1. All dimensions are in metric, measured to wall finishes. 2. All materials, dimensions & drawings are approximate. 3. Information is subject to change without notice, at developer's absolute discretion. 4. Actual area may vary from the stated area. 5. Drawing are not to scale. 6. All images used are for illustrative purpose only and do not represent the actual size, features, specifications, fittings and furnishings. 7. The developer reserves the right to make revisions/ alterations, at its absolute discretion, without any liability whatsoever.



# 3 BEDROOM APARTMENT

TYPE A (with maid room + balcony) VARIANT 1

**TOTAL SALEABLE AREA**

SUITE = 1,642.57 SQ.FT.

BALCONY = 274.54 SQ.FT.

TOTAL = 1,917.11 SQ.FT.

 UNIT

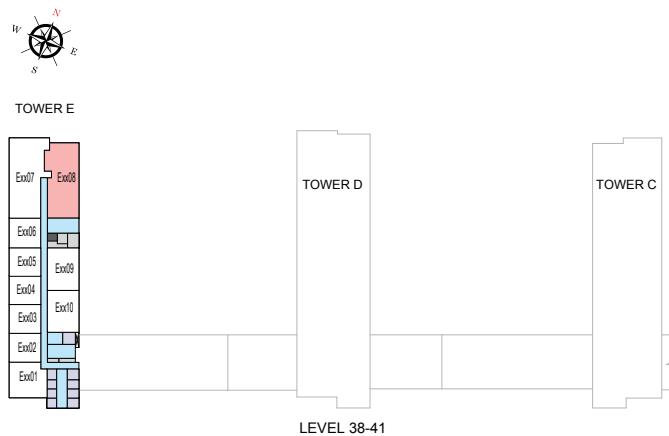
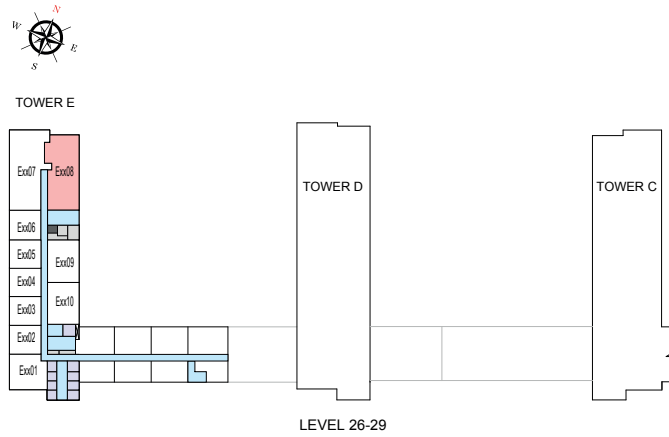
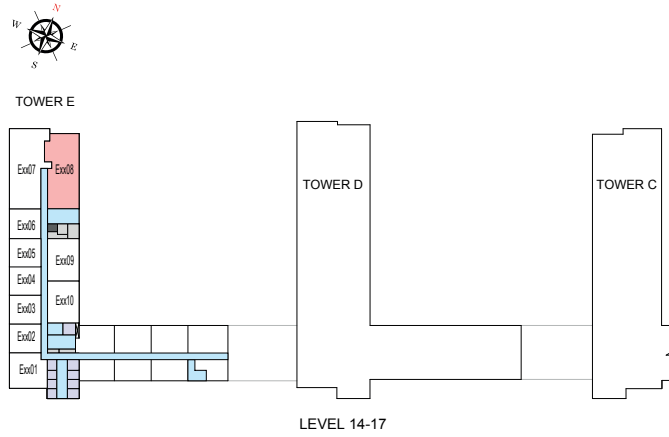

List of unit numbers with this unit plan:

## VIEWS

**Downtown, Ras Al Khor, Creek, Golf Course, Water body, Amenities**

E1408, E1508, E1608, E1708

**Downtown, Ras Al Khor, Creek, Golf Course, Water body**

E2608, E2708, E2808, E2908, E3808, E3908, E4008, E4108

Disclaimer: 1. All dimensions are in metric, measured to wall finishes. 2. All materials, dimensions & drawings are approximate. 3. Information is subject to change without notice, at developer's absolute discretion. 4. Actual area may vary from the stated area. 5. Drawing are not to scale. 6. All images used are for illustrative purpose only and do not represent the actual size, features, specifications, fittings and furnishings. 7. The developer reserves the right to make revisions/ alterations, at its absolute discretion, without any liability whatsoever.

# 4 BEDROOM APARTMENT

TYPE A (with store room, maid room and powder room + balcony)

**TOTAL SALEABLE AREA**

SUITE = 2,080.88 SQ.FT.

BALCONY = 196.34 SQ.FT.

TOTAL = 2,277.22 SQ.FT.

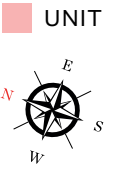
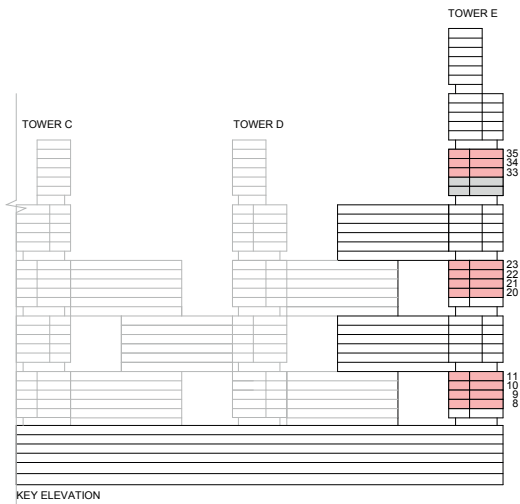

List of unit numbers with this unit plan:

## VIEWS

Downtown, Ras Al Khor, Creek, Golf Course, Water body, Amenities  
E808, E908, E1008, E1108, E2008, E2108, E2208, E2308

Downtown, Ras Al Khor, Creek, Golf Course, Water body  
E3308, E3408, E3508

Disclaimer: 1. All dimensions are in metric, measured to wall finishes. 2. All materials, dimensions & drawings are approximate. 3. Information is subject to change without notice, at developer's absolute discretion. 4. Actual area may vary from the stated area. 5. Drawing are not to scale. 6. All images used are for illustrative purpose only and do not represent the actual size, features, specifications, fittings and furnishings. 7. The developer reserves the right to make revisions/ alterations, at its absolute discretion, without any liability whatsoever.

# 4 BEDROOM APARTMENT

TYPE A (with store room, maid room and powder room + balcony)

## TOTAL SALEABLE AREA

SUITE = 2,080.88 SQ.FT.

BALCONY = 196.34 SQ.FT.

TOTAL = 2,277.22 SQ.FT.

 UNIT



TOWER E

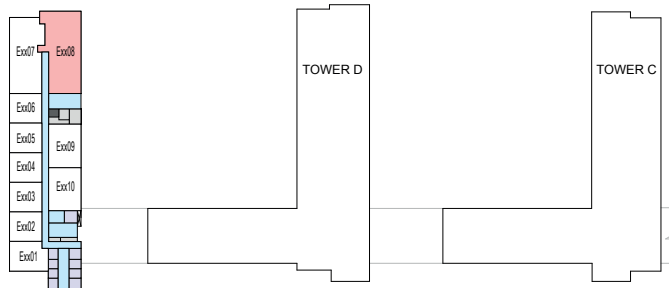

LEVEL 8-11, 20-23



TOWER E

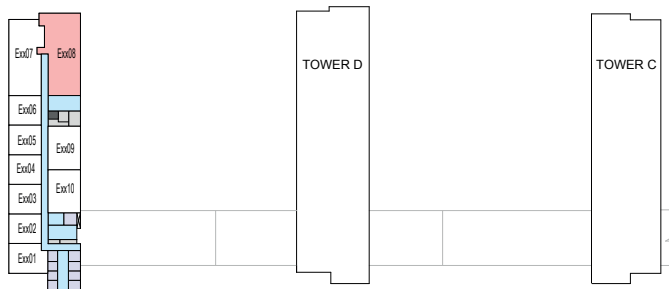

LEVEL 33-35

List of unit numbers with this unit plan:

## VIEWS

Downtown, Ras Al Khor, Creek, Golf Course, Water body, Amenities

E808, E908, E1008, E1108, E2008, E2108, E2208, E2308

Downtown, Ras Al Khor, Creek, Golf Course, Water body

E3308, E3408, E3508

Disclaimer: 1. All dimensions are in metric, measured to wall finishes. 2. All materials, dimensions & drawings are approximate. 3. Information is subject to change without notice, at developer's absolute discretion. 4. Actual area may vary from the stated area. 5. Drawing are not to scale. 6. All images used are for illustrative purpose only and do not represent the actual size, features, specifications, fittings and furnishings. 7. The developer reserves the right to make revisions/ alterations, at its absolute discretion, without any liability whatsoever.



# 4 BEDROOM APARTMENT

TYPE A (with store room, maid room and powder room + balcony) VARIANT 1

**TOTAL SALEABLE AREA**

SUITE = 2,080.88 SQ.FT.

BALCONY = 196.34 SQ.FT.

TOTAL = 2,277.22 SQ.FT.

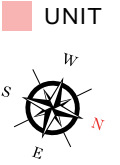
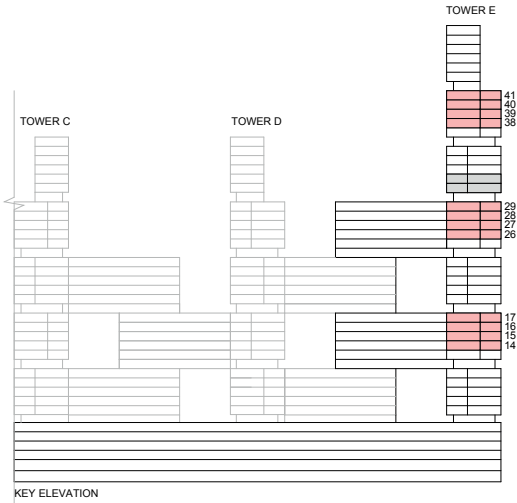

List of unit numbers with this unit plan:

## VIEWS

Downtown, Ras Al Khor, Creek, Golf Course, Water body

E1407, E1507, E1607, E1707, E2607, E2707, E2807, E2907, E3807, E3907, E4007, E4107

Disclaimer: 1. All dimensions are in metric, measured to wall finishes. 2. All materials, dimensions & drawings are approximate. 3. Information is subject to change without notice, at developer's absolute discretion. 4. Actual area may vary from the stated area. 5. Drawing are not to scale. 6. All images used are for illustrative purpose only and do not represent the actual size, features, specifications, fittings and furnishings. 7. The developer reserves the right to make revisions/ alterations, at its absolute discretion, without any liability whatsoever.

# 4 BEDROOM APARTMENT

TYPE A (with store room, maid room and powder room + balcony) VARIANT 1

## TOTAL SALEABLE AREA

SUITE = 2,080.88 SQ.FT.

BALCONY = 196.34 SQ.FT.

TOTAL = 2,277.22 SQ.FT.

■ UNIT

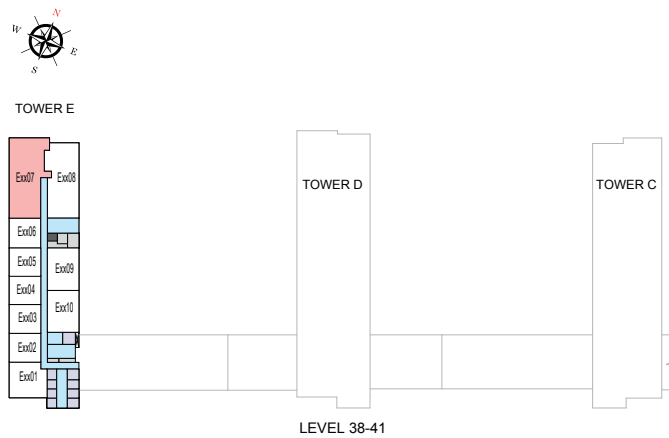
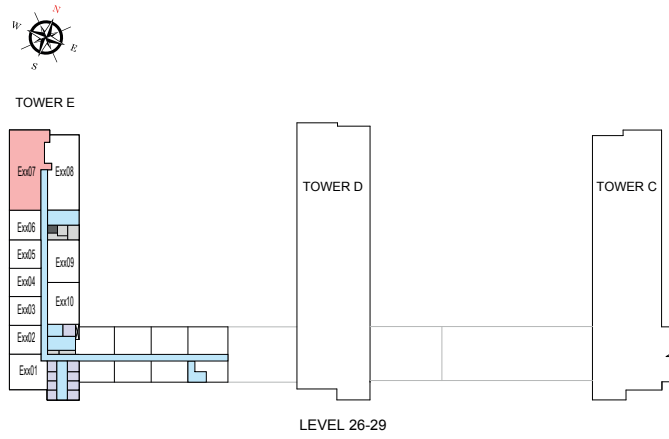
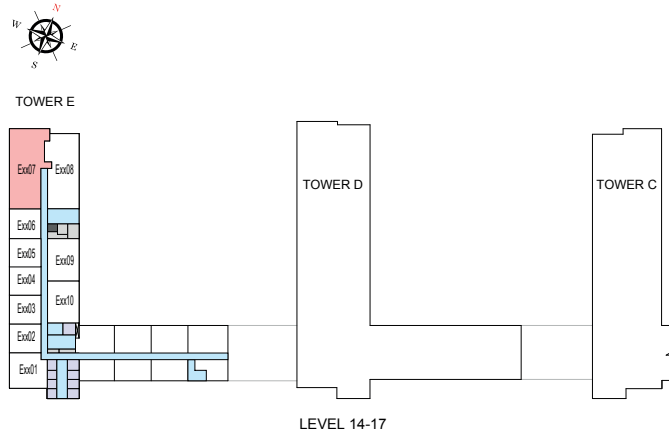

List of unit numbers with this unit plan:

## VIEWS

Downtown, Ras Al Khor, Creek, Golf Course, Water body

E1407, E1507, E1607, E1707, E2607, E2707, E2807, E2907, E3807, E3907, E4007, E4107

Disclaimer: 1. All dimensions are in metric, measured to wall finishes. 2. All materials, dimensions & drawings are approximate. 3. Information is subject to change without notice, at developer's absolute discretion. 4. Actual area may vary from the stated area. 5. Drawing are not to scale. 6. All images used are for illustrative purpose only and do not represent the actual size, features, specifications, fittings and furnishings. 7. The developer reserves the right to make revisions/ alterations, at its absolute discretion, without any liability whatsoever.



SOBHA ONE

SOBHA  
REALTY